

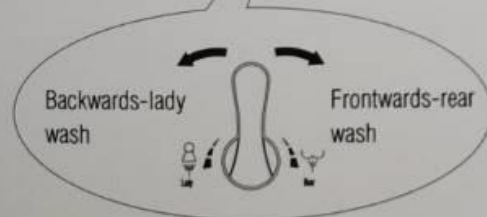

**Weser**

Bidet Seat  
Installation Guide



Backwards-lady  
wash

Frontwards-rear  
wash

Simple knob, simple operation

\*Please refer to printed Installation Manual

\*For BTW &  
Wall Hung WCs

\*For Ordinary WCs



2. Align Fixing Plate with  
the well positioned  
Template

3. Tighten  
screws

1. Align Template with WC





Apply white tape on  
T Shape Joint

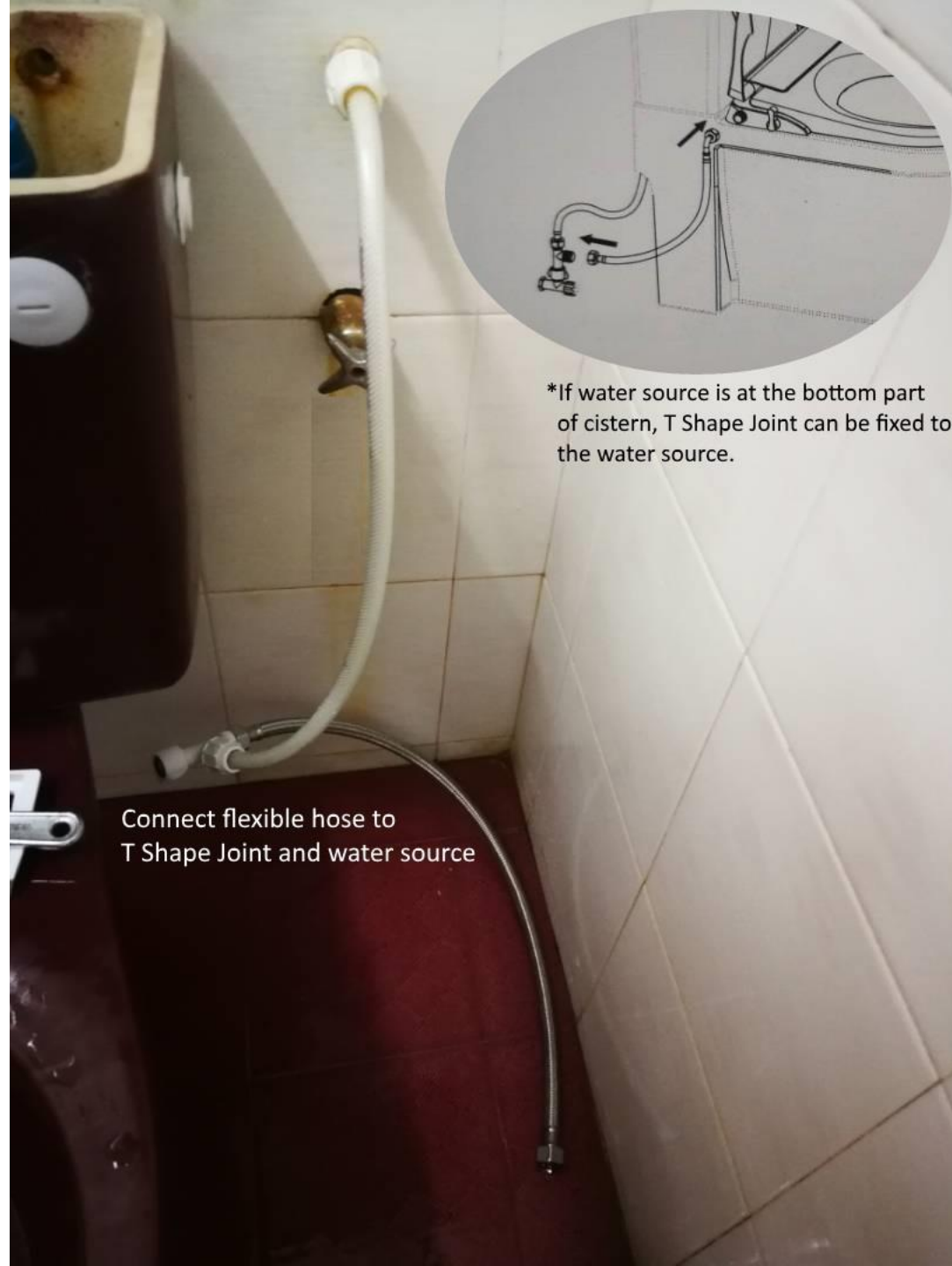

Connect flexible hose to  
T Shape Joint and water source

\*If water source is at the bottom part  
of cistern, T Shape Joint can be fixed to  
the water source.

\*Cistern & WC bottom view

Connect female nut on T Shape  
Joint to Cistern Inlet Valve

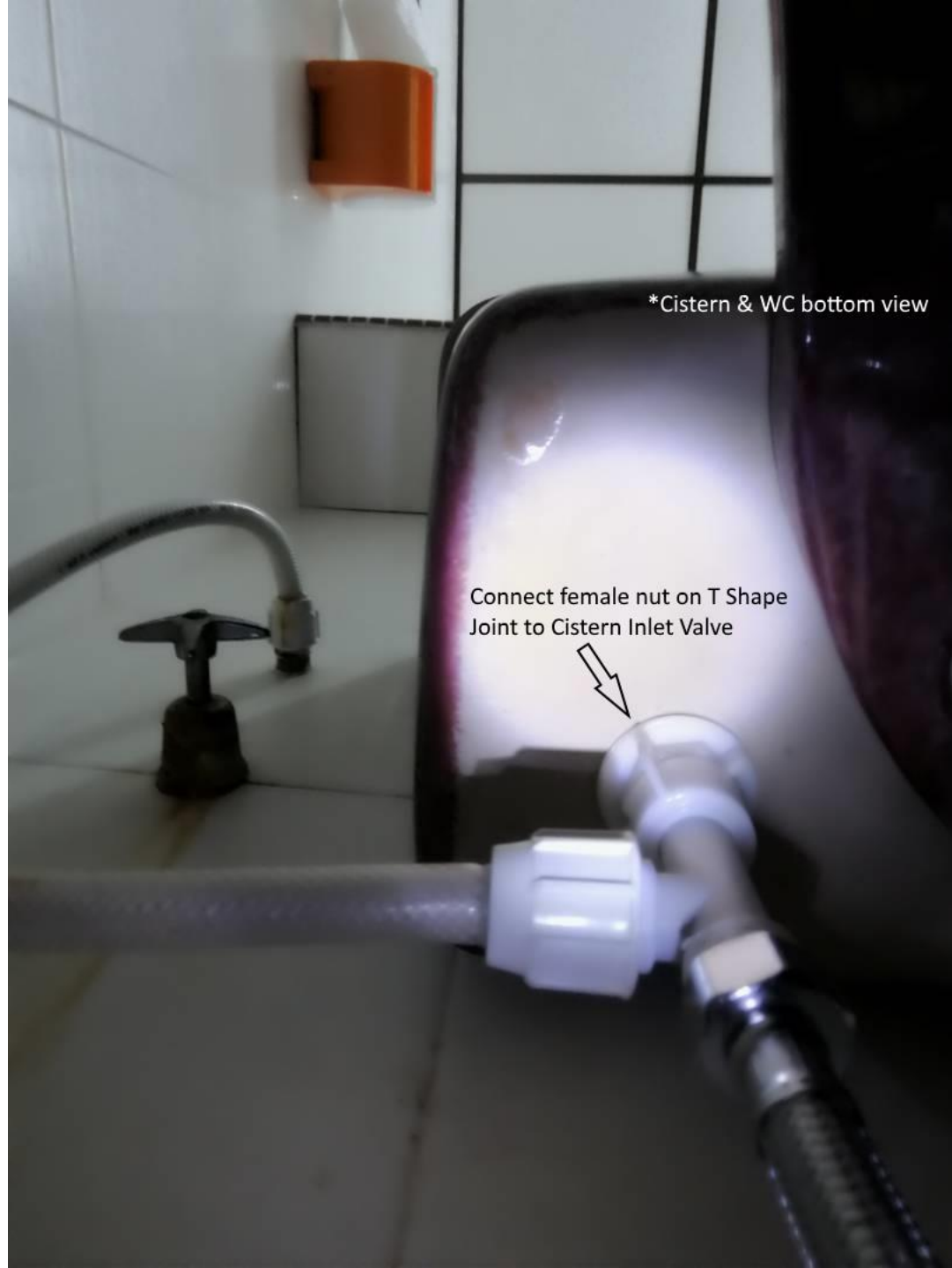



\*Use a small screw driver to remove Regulator or Pressure Reducer if water Pressure is not very strong



Connect flexible hose to Bidet Seat

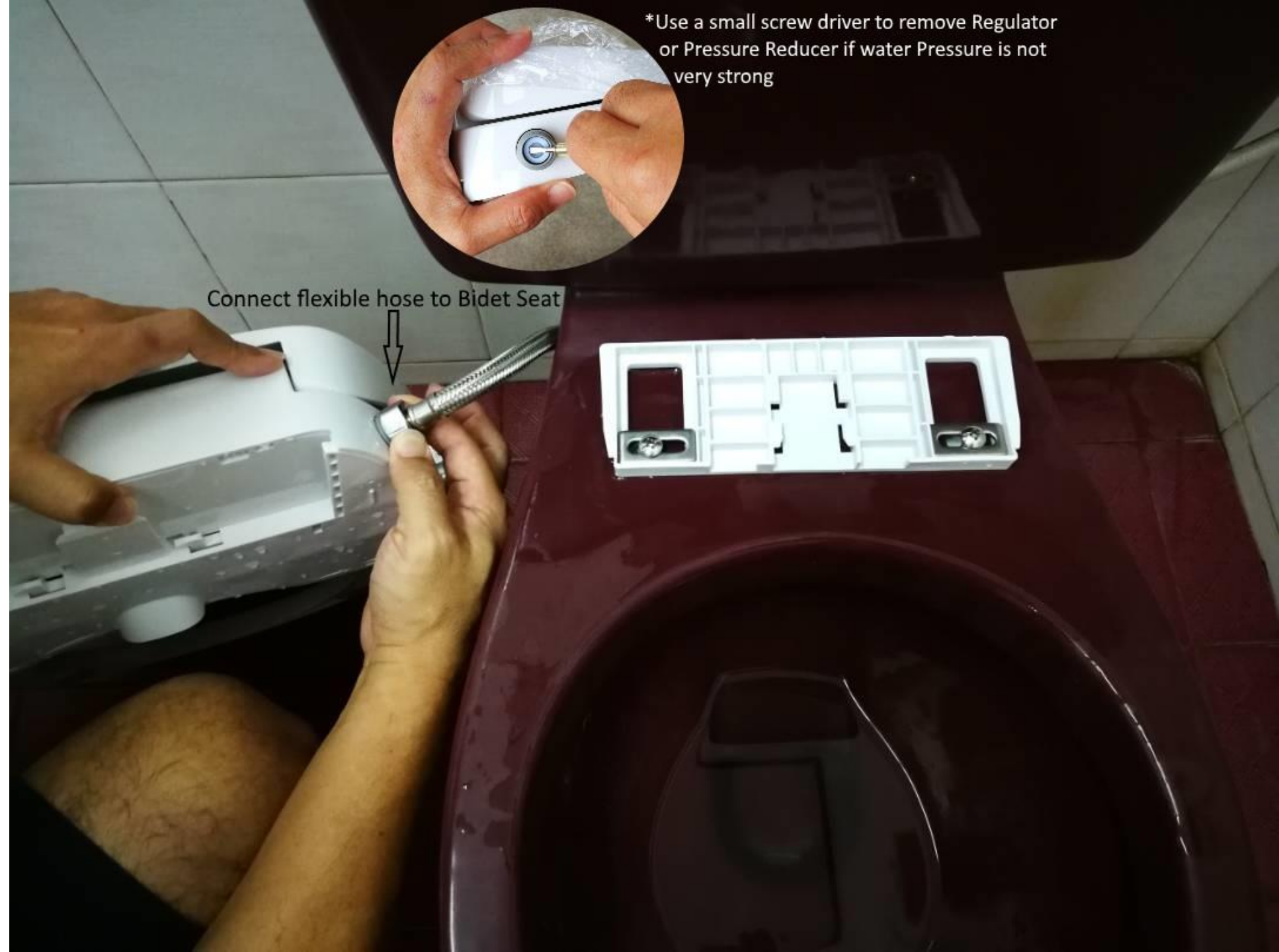

Slide in Bidet Seat to the end. When it's fully fixed you can hear "click" sound.



\*If the surface of WC is not even, sliding in can be difficult. Loosen the screws a little bit should help.



To take out Bidet Seat, press button and pull out gently.



\*For Maintenance & Trouble Shooting,  
kindly refer to printed Installation Manual