



TOOLS@HEIGHT 1/4" DRIVE ENCLOSED HEAD RATCHETS

Sealed Narrow Head Design, Chrome and Black Industrial Finish

Product Code	Description	Length (Inches)	Number of Teeth	Weight (lbs)
M-52EHA-TH	Chrome Finish Enclosed Head Ratchet	5 1/4	36	0.00
MB-52EHA-TH	Black Industrial Finish Enclosed Head Ratchet	5 1/4	36	0.21

Fed. Spec: ANSI B107.10M



Features

- Enclosed head is sealed to prevent dust, dirt, and liquids from entering head, preserving internal lubrication.
- Forged one-piece ratchet provide strength and safety for industrial applications.
- 36 tooth gear with 10 degree of engagement allows engagement in tight working areas.
- Nickel/Chrome plating provides increase protection from rust and corrosion.
- Chrome finish models feature mirror-like exterior that can be easily cleaned after each use.
- Single Pawl ratchet design:
- Designed for tighter tolerances between pawl and gear which reduces metal fatigue and slippage under load.
- Does not require as many working parts, reducing possible breakage and parts to repair.
- Easy access reverse lever allows user to change working direction quickly and easily with only one hand.



TOOLS@HEIGHT 1/4" DRIVE EXTENSIONS

High-Polished Chrome Finish

Product Code	Description	Length (Inches)	Weight (lbs.)
M-102-TH	Extension	2	.06
M-104-TH	Extension	4	.11
M-115-TH	Extension	6	.15
M-140A-TH	U-Joint		.11

Fed. Spec: ANSI B107.10M



Features

- Chrome plating provides increased protection from rust and corrosion.
- Flexible extension is designed for low torque applications in limited access areas.
- Ball and spring socket retention.



TOOLS@HEIGHT 1/4" DRIVE SHALLOW SOCKETS, 12 POINT, SAE

High-Polished Chrome Finish

		A	B	C	D	E	F	
			Drive End Diameter (Inches)	Working End Diameter (Inches)	Broach Depth (Inches)	Bolt Clearance Depth (Inches)	Bolt Clearance Diameter (Inches)	Nose Length (Inches)
Product Code	Size (Inches)	OAL (Inches)						Weight (lbs)
30206-TH	3/16	1	15/32	5/16	9/32	19/32	3/16	0.03
30207-TH	7/32	1	15/32	11/32	5/16	19/32	7/32	0.03
30208-TH	1/4	1	15/32	3/8	5/16	19/32	7/32	0.03
30209-TH	9/32	1	15/32	7/16	5/16	19/32	1/4	0.03
30210-TH	5/16	1	15/32	15/32	5/16	19/32	1/4	-
30211-TH	11/32	1	1/2	1/2	5/16	19/32	11/32	0.04
30212-TH	3/8	1	9/16	9/16	11/32	19/32	3/8	0.04
30214-TH	7/16	1	5/8	5/8	7/16	19/32	7/16	0.05
30216-TH	1/2	1	11/16	11/16	7/16	19/32	1/2	0.06
30218-TH	9/16	1	3/4	3/4	7/16	19/32	17/32	0.07

Fed. Spec: ANSI B107.1

Features

- SUPERTORQUE® lobular openings for greater turning power without deforming the fastener.
- Designed for maximum engagement on both 6 and 12 point fasteners.

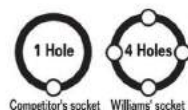

Williams T@H sockets, extensions, and adaptors feature a locking hole on all four sides, not just one. Williams T@H ratchets and drive tools feature a locking pin which mates with the side lock hole for positive retention. This reduces the risk of misaligning the socket that typical competitor's sockets with just one side hole create.

Release pin with WTHPRT - Pin Release Tool for Williams' Square Drive Tools

Do not use quick release tools with locking collars or push button release. These tools can be disengaged inadvertently.

TOOLS@HEIGHT 1/4" DRIVE DEEP SOCKETS, 12 POINT, SAE

High-Polished Chrome Finish

Product Code	Size (Inches)	A OAL (Inches)	B Drive End Diameter (Inches)	C Working End Diameter (Inches)	D Broach Depth (Inches)	E Bolt Clearance Depth (Inches)	F Bolt Clearance Diameter (Inches)	Nose Length (Inches)	Weight (lbs)
30406-TH	3/16	1 3/32	15/32	5/16	5/16	1 5/16	1/8	1 1/32	0.04
30407-TH	7/32	1 3/32	15/32	11/32	3/8	1 5/16	3/16	15/16	0.05
30408-TH	1/4	1 3/32	15/32	7/16	13/16	1 11/32	7/32	1 1/32	0.05
30409-TH	9/32	1 3/32	15/32	7/16	25/32	1 11/32	1/4	31/32	0.05
30410-TH	5/16	1 3/32	15/32	15/32	13/16	1 5/16	9/32	-	0.05
30411-TH	11/32	1 3/32	1/2	1/2	23/32	1 5/16	9/32	-	0.07
30412-TH	3/8	1 3/32	9/16	9/16	7/8	1 11/32	5/16	-	0.09
30414-TH	7/16	1 3/32	5/8	5/8	7/8	1 1/2	13/32	-	0.10
30416-TH	1/2	1 3/32	11/16	11/16	27/32	1 17/32	7/16	-	0.11
30418-TH	9/16	1 3/32	3/4	3/4	29/32	1 5/16	17/32	-	0.14

Fed. Spec: ANSI B107.1

Features

- SUPERTORQUE® lobular openings for greater turning power without deforming the fastener.
- Designed for maximum engagement on 12 point fasteners.



30410-TH 30406-TH

TOOLS@HEIGHT 1/4" DRIVE STANDARD LENGTH HEX BIT SOCKETS, SAE

High-Polished Chrome Finish

Product Code	Size (Inches)	Socket Length (Inches)	Socket Outside Diameter (Inches)	Overall Length (Inches)	Bit Length (Inches)	Weight (lbs)
35000-TH	1/8	13/16	15/32	1 13/32	5/8	0.04
35001-TH	9/32	13/16	15/32	1 13/32	5/8	0.04
35002-TH	3/16	13/16	15/32	1 13/32	5/8	0.04
35003-TH	7/32	13/16	15/32	1 13/32	5/8	0.04
35004-TH	1/4	13/16	15/32	1 13/32	5/8	0.04
35005-TH	5/16	13/16	15/32	1 13/32	5/8	0.04

30902-TH 6 Piece Hex Bit Socket Set on Clip Rail .51 lbs

Contents Include:

Product Code	Size (Inches)	Product Code	Size (Inches)	Product Code	Size (Inches)
35000-TH	1/8	35002-TH	3/16	35004-TH	1/4
35001-TH	9/32	35003-TH	7/32	35005-TH	5/16

Features

- High-polished chrome finish socket cleans easily.



30902-TH

TOOLS@HEIGHT 1/4" DRIVE STANDARD LENGTH HEX BIT SOCKETS, METRIC

High-Polished Chrome Finish

Product Code	Size (MM)	Socket Length (Inches)	Socket Outside Diameter (Inches)	Overall Length (Inches)	Bit Length (Inches)	Weight (lbs)
35070-TH	3	13/16	15/32	1 13/32	5/8	0.04
35071-TH	4	13/16	15/32	1 13/32	5/8	0.04
35072-TH	5	13/16	15/32	1 13/32	5/8	0.04
35073-TH	6	13/16	15/32	1 13/32	5/8	0.04
35074-TH	7	13/16	15/32	1 13/32	5/8	0.04
35075-TH	8	13/16	15/32	1 13/32	5/8	0.04

30904-TH 6 Piece Hex Bit Socket Set on Clip Rail .51 lbs

Contents Include:

Product Code	Size (MM)	Product Code	Size (MM)	Product Code	Size (MM)
35070-TH	3	35072-TH	5	35074-TH	7
35071-TH	4	35073-TH	6	35075-TH	8

Features

- High-polished chrome finish socket cleans easily.



Williams T@H sockets, extensions, and adaptors feature a locking hole on all four sides, not just one. Williams T@H ratchets and drive tools feature a locking pin which mates with the side lock hole for positive retention. This reduces the risk of misaligning the socket that typical competitor's sockets with just one side hole create.

Release pin with WTHPR - Pin Release Tool for William's Square Drive Tools

Do not use quick release tools with locking collars or push button release. These tools can be disengaged inadvertently.



WTHPR

WILLIAMS

TOOLS@HEIGHT
DROP PREVENTION SYSTEM

TOOLS@HEIGHT 3/8" DRIVE ENCLOSED HEAD RATCHETS

Williams® Sealed Narrow Head Design, Chrome and Black Industrial Finish

Product Code	Description	Length (Inches)	Number of Teeth	Weight (lbs)
BB-52EHA-TH	Black Industrial Finish Enclosed Head Ratchet	8	36	.76
B-52EHA-TH	Chrome Finish Enclosed Head Ratchet	8	36	.76
B-52EHLA-TH	Chrome Finish Enclosed Head Ratchet, Long	10 1/4	36	.87

Fed. Spec: ANSI B107.10M



Features

- Enclosed head is sealed to prevent dust, dirt, and liquids from entering head, preserving internal lubrication.
- Forged one-piece ratchet provide strength and safety for industrial applications.
- Smooth comfort-grip handle permits all-day use without gloves.
- 36 tooth gear with 10 degree of engagement allows engagement in tight working areas.
- Nickel/Chrome plating provides increase protection from rust and corrosion.
- Chrome finish models feature mirror-like exterior that can be easily cleaned after each use.
- Single Pawl ratchet design:
 - 1) Designed for tighter tolerances between pawl and gear which reduces metal fatigue and slippage under load.
 - 2) Does not require as many working parts, reducing possible breakage and parts to repair.
- Easy access reverse lever allows user to change working direction quickly and easily with only one hand.

WILLIAMS

TOOLS@HEIGHT
DROP PREVENTION SYSTEM

TOOLS@HEIGHT 3/8" DRIVE EXTENSIONS AND ACCESSORIES

High-Polished Chrome Finish

Product Code	Description	Length (Inches)	Weight (lbs)
B-108-TH	Extension	3	.19
B-110-TH	Extension	6	.34
B-115-TH	Extension	11	.61
B-118-TH	Extension	18	.93
B-140A-TH	Universal Joint	2	.15
B-70-TH	Ratchet Spinner Disk	1 1/4	.14

Fed. Spec: ANSI B107.10M



Features

- Chrome plating provides increased protection from rust and corrosion.
- Flexible extension is designed for low torque applications in limited access areas.
- Ball and spring socket retention.
- Spinner disk is ideal for fast turn down of fasteners.

WILLIAMS

TOOLS@HEIGHT
DROP PREVENTION SYSTEM

TOOLS@HEIGHT 3/8" DRIVE HANDLE

Knurled Handle, High-Polished Chrome Finish

Product Code	Description	Length (Inches)	Weight (lbs)
B-40A-TH	Flex Handle	8 9/16	.67

Fed. Spec: ANSI B107.10M

Features

- Chrome plating provides increased protection from rust and corrosion.
- Drive handles provide extra leverage with greater strength than ratchets.

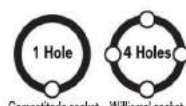

Competitor's socket Williams' socket



Williams T@H sockets, extensions, and adaptors feature a locking hole on all four sides, not just one. Williams T@H ratchets and drive tools feature a locking pin which mates with the side lock hole for positive retention. This reduces the risk of misaligning the socket that typical competitor's sockets with just one side hole create.

Release pin with WTHPRT - Pin Release Tool for Williams' Square Drive Tools

Do not use quick release tools with locking collars or push button release. These tools can be disengaged inadvertently.



WTHPRT

TOOLS@HEIGHT 3/8" DRIVE SHALLOW SOCKETS, 12 POINT, SAE

High-Polished Chrome Finish

Product Code	Size (Inches)	A OAL (Inches)	B Drive End Diameter (Inches)	C Working End Diameter (Inches)	D Broach Depth (Inches)	E Bolt Clearance Depth (Inches)	F Bolt Clearance Diameter (Inches)	Nose Length (Inches)	Weight (lbs.)
31208-TH	1/4	1	11/16	7/16	11/32	9/16	7/32	17/32	0.04
31210-TH	5/16	1	11/16	13/32	3/8	17/32	1/4	17/32	0.05
31212-TH	3/8	1	11/16	9/16	3/8	1/2	9/32	17/32	0.05
31214-TH	7/16	1	11/16	5/8	11/32	17/32	13/32	17/32	0.05
31216-TH	1/2	1	3/4	3/4	13/32	19/32	7/16	-	0.07
31218-TH	5/8	1 1/8	23/32	23/32	17/32	3/4	17/32	-	0.08
31220-TH	3/4	1 1/8	7/8	7/8	19/32	11/16	19/32	-	0.09
31222-TH	11/16	1 1/8	15/16	15/16	1/2	11/16	21/32	-	0.11
31224-TH	3/4	1 3/8	1	1	9/16	23/32	23/32	-	0.15
31226-TH	13/16	1 1/2	1 1/8	1 1/8	5/16	23/32	23/32	-	0.17
31228-TH	7/8	1 7/8	1 3/16	1 3/16	21/32	19/16	27/32	-	0.21
31230-TH	15/16	1 7/8	1 1/4	1 1/4	21/32	19/16	27/32	-	0.23
31232-TH	1	1 3/2	1 3/16	1 3/16	11/16	19/16	31/32	-	0.26

Fed. Spec: ANSI B107.1

Features

- SUPERTORQUE® lobular openings for greater turning power without deforming the fastener.
- Designed for maximum engagement on 12 point fasteners.



31216-TH

31208-TH

TOOLS@HEIGHT 3/8" DRIVE DEEP SOCKETS, 12 POINT, SAE

High-Polished Chrome Finish

Product Code	Size (Inches)	A OAL (Inches)	B Drive End Diameter (Inches)	C Working End Diameter (Inches)	D Broach Depth (Inches)	E Bolt Clearance Depth (Inches)	F Bolt Clearance Diameter (Inches)	Nose Length (Inches)	Weight (lbs.)
31408-TH	1/4	2 1/2	11/16	7/16	11/32	1 11/16	7/32	1 1/16	0.11
31410-TH	5/16	2 1/2	11/16	13/32	3/8	1 11/16	9/16	1 1/16	0.11
31412-TH	3/8	2 1/2	11/16	9/16	3/8	1 11/16	3/8	1 1/16	0.12
31414-TH	7/16	2 1/2	11/16	5/8	11/32	1 11/16	7/16	1 1/16	0.12
31416-TH	1/2	2 1/2	3/4	3/4	13/32	1 1/32	19/32	-	0.15
31418-TH	5/8	2 1/2	23/32	23/32	17/32	1 1/16	17/32	-	0.18
31420-TH	3/4	2 1/2	7/8	7/8	19/32	1 9/16	19/32	-	0.21
31422-TH	11/16	2 1/2	15/16	15/16	1/2	1 11/16	21/32	-	0.25
31424-TH	3/4	2 1/2	1	1	9/16	1 11/16	23/32	-	0.27
31426-TH	13/16	2 1/2	1 1/8	1 1/8	5/16	2 1/32	23/32	-	0.34
31428-TH	7/8	2 1/2	1 3/16	1 3/16	21/32	2 1/32	27/32	-	0.38
31430-TH	15/16	2 1/2	1 1/4	1 1/4	21/32	2 1/32	27/32	-	0.44
31432-TH	1	2 1/2	1 5/16	1 5/16	11/16	2	31/32	-	0.49

Fed. Spec: ANSI B107.1

Features

- SUPERTORQUE® lobular openings for greater turning power without deforming the fastener.
- Designed for quick engagement on both 6 and 12 point fasteners.



Competitor's socket Williams' socket

Williams T@H sockets, extensions, and adaptors feature a locking hole on all four sides, not just one. Williams T@H ratchets and drive tools feature a locking pin which mates with the side lock hole for positive retention. This reduces the risk of misaligning the socket that typical competitor's sockets with just one side hole create.

Release pin with WTHPRT - Pin Release Tool for Williams' Square Drive Tools

Do not use quick release tools with locking collars or push button release. These tools can be disengaged inadvertently.



WTHPRT



31416-TH

31408-TH



TOOLS@HEIGHT 3/8" DRIVE STANDARD LENGTH HEX BIT SOCKETS, SAE



35100-TH

High-Polished Chrome Finish

Product Code	Size (Inches)	Socket Length (Inches)	Socket Outside Diameter (Inches)	Overall Length (Inches)	Bit Length (Inches)	Weight (lbs.)
35100-TH	1/8	1 3/16	3/4	1 27/32	2 1/32	0.09
35101-TH	9/64	1 3/16	3/4	1 27/32	2 1/32	0.09
35102-TH	5/32	1 3/16	3/4	1 27/32	2 1/32	0.10
35103-TH	3/16	1 3/16	3/4	1 27/32	2 1/32	0.09
35104-TH	7/32	1 3/16	3/4	1 27/32	2 1/32	0.10
35105-TH	1/4	1 3/16	3/4	1 27/32	2 1/32	0.09
35106-TH	5/16	1 3/16	3/4	1 31/32	1 13/16	0.11
35107-TH	3/8	1 3/16	3/4	1 31/32	1 13/16	0.12

Features

- High-polished chrome finish socket cleans easily.



TOOLS@HEIGHT 3/8" DRIVE UNIVERSAL SOCKETS, 6 POINT, SAE

High-Polished Chrome Finish



31154-TH

31142-TH

		A	B	C	D	E	F		
Product Code	Size (Inches)	OAL (Inches)	Drive End Diameter (Inches)	Open End Diameter (Inches)	Broach Depth (Inches)	Bolt Clearance Depth (Inches)	Bolt Clearance Diameter (Inches)	Nose Length (Inches)	Weight (lbs.)
31142-TH	3/8	1 53/64	3/4	9/16	3/8	35/64	2 1/64	5/16	0.11
31144-TH	7/16	1 33/64	3/4	5/8	3/8	35/64	2 1/64	5/16	0.11
31146-TH	1/2	1 57/64	3/4	49/64	13/32	37/64	2 1/64	13/32	0.12
31148-TH	9/16	1 57/64	3/4	25/32	7/16	43/64	2 1/64	33/64	0.13
31150-TH	5/8	2	3/4	59/64	7/16	45/64	2 1/64	33/64	0.14
31152-TH	11/16	2 3/64	3/4	19/16	31/64	3/4	2 1/64	17/32	0.15
31154-TH	3/4	2 3/64	3/4	1 1/64	1/2	51/64	2 1/64	17/32	0.16

Fed. Spec: ANSI B107.1

Features

- Ideal for work in confined areas where fastener is inaccessible to standard sockets

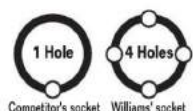

Competitor's socket Williams' socket



Williams T@H sockets, extensions, and adaptors feature a locking hole on all four sides, not just one. Williams T@H ratchets and drive tools feature a locking pin which mates with the side lock hole for positive retention. This reduces the risk of misaligning the socket that typical competitor's sockets with just one side hole create.

Release pin with WTHPRT – Pin Release Tool for William's Square Drive Tools

Do not use quick release tools with locking collars or push button release. These tools can be disengaged inadvertently.



WTHPRT



TOOLS@HEIGHT 1/2" DRIVE SCAFFOLDING RATCHET

Product Code	Description	Product Code	Description
BS-62A	Scaffolding Ratchet with reversed pry bar	BS-63BRK	Repair Kit
BS-62	Scaffolding Ratchet with out pry bar	BS-63BTIP	Hammer Tip
BS-63B	Scaffolding Ratchet with pry bar	BS-63BBAR	Pry Bar

Features

- 1/2" Drive with pinned 7/8" 6-point socket, 2-1/4" length
- 36 tooth gear with 10 degree of engagement allows engagement in tight working areas
- Bronze hammer head reduces rebound
- Pry bar handle provide alignment option
- Socket feature SUPERTORQUE lobular opening for greater turning power without deforming the fastener
- Easy access reversing lever allows user to change working direction quickly and easily with only one hand
- Tethering device attached to handle



BS-62

BS-63B



TOOLS@HEIGHT 1/2" DRIVE ENCLOSED HEAD RATCHETS

Williams® Sealed Narrow Head Design, Chrome and Black Industrial Finish

Product Code	Description	Length (Inches)	Number of Teeth	Weight (lbs)
S-52EHA-TH	Chrome Finish Enclosed Head Ratchet	10 1/4	36	1.61
S-52EHLA-TH	Chrome Finish Enclosed Head Ratchet, Long	15	36	1.94
SB-52EHA-TH	Black Industrial Finish Enclosed Head Ratchet	10 1/4	36	1.61

Fed. Spec: ANSI B107.10M



Features

- Enclosed head is sealed to prevent dust, dirt, and liquids from entering head, preserving internal lubrication.
- Forged one-piece ratchet provide strength and safety for industrial applications.
- Smooth comfort-grip handle permits all-day use without gloves.
- 36 tooth gear with 10 degree of engagement allows engagement in tight working areas.
- Nickel/Chrome plating provides increase protection from rust and corrosion.
- Chrome finish models feature mirror-like exterior that can be easily cleaned after each use.



SB-52EHA-TH



S-52EHA-TH



TOOLS@HEIGHT 1/2" DRIVE HANDLES

Knurled Handle, Chrome and Black Industrial Finish

Product Code	Description	Length (Inches)	Weight (lbs)
S-40AA-TH	Chrome Flex Handle	10 13/16	1.34
S-41AA-TH	Chrome Flex Handle	15 1/2	2.07
BS-41AA-TH	Black Industrial Finish Flex Handle	15 1/2	2.06

Fed. Spec: ANSI B107.10M



Features

- Chrome plating provides increased protection from rust and corrosion.
- Drive handles provide extra leverage with greater strength than ratchets.
- Speeder handle is ideal for fast turn down of fasteners.



BS-41AA-TH



S-40AA-TH



Competitor's socket Williams' socket

Williams T@H sockets, extensions, and adaptors feature a locking hole on all four sides, not just one. Williams T@H ratchets and drive tools feature a locking pin which mates with the side lock hole for positive retention. This reduces the risk of misaligning the socket that typical competitor's sockets with just one side hole create.

Release pin with WTHPRT - Pin Release Tool for William's Square Drive Tools

Do not use quick release tools with locking collars or push button release. These tools can be disengaged inadvertently.



WTHPRT



Be sure to use a lanyard that has more weight capacity than the tool you are attaching because drop forces are greater than actual tool weight.



S-140A-TH



S-121P-TH



32220-TH

32212-TH

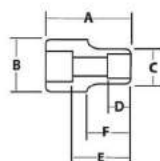

TOOLS@HEIGHT 1/2" DRIVE EXTENSIONS AND ACCESSORIES

High-Polished Chrome Finish

Product Code	Description	Length (Inches)	Weight (lbs.)
S-102P-TH	Extension	2	.38
S-110P-TH	Extension	5	.50
S-115P-TH	Extension	10	.93
S-121P-TH	Extension	20	1.76
S-140A-TH	Universal Joint	2 1/16	.29

Fed. Spec: ANSI B107.10M

Features

- Chrome plating provides increased protection from rust and corrosion.



TOOLS@HEIGHT 1/2" DRIVE SHALLOW 12 POINT SOCKETS, SAE

High-Polished Chrome Finish

Product Code	Size (Inches)	OAL (Inches)	A	B	C	D	E	F	Weight (lbs.)
			Drive End Diameter (Inches)	Working End Diameter (Inches)	Broach Depth (Inches)	Bolt Clearance Depth (Inches)	Bolt Clearance Diameter (Inches)	Nose Length (Inches)	
32212-TH	3/8	1 1/2	7/8	5/8	1/2	27/32	3/16	23/32	0.11
32214-TH	7/16	1 1/2	7/8	11/16	1/2	27/32	13/32	11/16	0.12
32216-TH	1/2	1 1/2	7/8	3/4	17/32	27/32	15/32	23/32	0.12
32218-TH	9/16	1 1/2	7/8	13/16	17/32	27/32	17/32	11/16	0.12
32220-TH	5/8	1 1/2	29/32	29/32	17/32	27/32	9/16	-	0.14
32222-TH	11/16	1 1/2	31/32	31/32	9/16	27/32	21/32	-	0.16
32224-TH	3/4	1 1/2	1	1	3/4	27/32	23/32	-	0.19
32226-TH	13/16	1 1/2	1 1/8	1 1/8	25/32	31/32	25/32	-	0.21
32228-TH	7/8	1 5/8	1 3/16	1 3/16	7/8	1 1/32	7/8	-	0.25
32230-TH	15/16	1 5/8	1 1/4	1 1/4	7/8	1 5/32	29/32	-	0.29
32232-TH	1	1 5/8	1 5/16	1 5/16	7/8	1 3/16	31/32	-	0.32
32234-TH	1 1/16	1 3/4	1 7/16	1 7/16	31/32	1 9/32	1 1/16	-	0.40
32236-TH	1 1/8	1 3/4	1 1/2	1 1/2	31/32	1 9/16	1 3/32	-	0.44
32238-TH	1 3/16	1 3/4	1 9/16	1 9/16	31/32	1 9/16	1 1/4	-	0.50
32240-TH	1 1/4	1 3/4	1 11/16	1 21/32	31/32	1 5/16	1 1/4	-	0.55
32242-TH	1 1/2	1 47/64	1 1/2	1 47/64	59/64	59/64	1 3/16	-	0.56
32244-TH	1 3/8	1 47/64	1 37/64	1 53/64	59/64	59/64	1 17/64	-	0.64
32246-TH	1 7/16	1 31/32	1 27/32	1 37/64	1 1/16	1 1/16	1 11/32	-	0.66
32248-TH	1 1/2	1 31/32	1 11/16	1 31/32	1 1/8	1 1/2	1 1/8	-	0.72

Fed. Spec: ANSI B107.1

Features

- SUPERTORQUE® lobular openings for greater turning power without deforming the fastener.
- Designed for quick engagement on both 6 and 12 point fasteners.



Competitor's socket Williams' socket



Williams T@H sockets, extensions, and adaptors feature a locking hole on all four sides, not just one. Williams T@H ratchets and drive tools feature a locking pin which mates with the side lock hole for positive retention. This reduces the risk of misaligning the socket that typical competitor's sockets with just one side hole create.

Release pin with WTHPRT - Pin Release Tool for William's Square Drive Tools

Do not use quick release tools with locking collars or push button release. These tools can be disengaged inadvertently.



WTHPRT

TOOLS@HEIGHT 1/2" DRIVE DEEP SOCKETS, 12 POINT, SAE

High-Polished Chrome Finish

		A	B	C	D	E		F	
Product Code	Size (Inches)	OAL (Inches)	Drive End Diameter (Inches)	Working End Diameter (Inches)	Broach Depth (Inches)	Bolt Clearance Depth (Inches)	Bolt Clearance Diameter (Inches)	Nose Length (Inches)	Weight (lbs.)
32412-TH	3/8	3	7/8	5/8	1	2 1/32	1 1/32	1 1/32	0.23
32414-TH	7/16	3 1/32	7/8	1 1/16	1 1/8	2 9/32	1 3/32	1 1/32	0.24
32416-TH	1/2	3 1/32	7/8	3/4	3 1/32	2 7/32	7/16	1 1/32	0.24
32418-TH	9/16	3 1/32	7/8	13/16	1 3/32	2 7/32	1/2	1 1/32	0.26
32420-TH	5/8	3 1/32	29/32	29/32	1 3/16	2 3/16	9/16	-	0.27
32422-TH	11/16	3 1/32	15/16	15/16	1 3/8	2 3/8	2 1/32	-	0.27
32424-TH	3/4	3 1/32	1 1/16	1 1/16	1 1/4	2 1 1/32	23/32	-	0.27
32426-TH	13/16	3 1/32	1 1/8	1 1/8	1 13/16	2 3/16	3/4	-	0.41
32428-TH	7/8	3 1/32	1 3/16	1 3/16	1 1 1/32	2 1/4	27/32	-	0.45
32430-TH	15/16	3 1/32	1 1/4	1 1/4	1 1 1/32	2 5/32	29/32	-	0.50
32432-TH	1	3 1/32	1 1 1/32	1 1 1/32	1 1 1/32	2 5/32	15/16	-	0.58
32434-TH	1 1/16	3 1/32	1 13/32	1 13/32	1 3/8	2 1 1/32	1 1/32	-	0.64
32436-TH	1 1/8	3 1/32	1 1/2	1 1/2	1 7/8	2 3/8	1 1/16	-	0.75
32438-TH	1 3/16	3 1/32	1 9/16	1 9/16	1 15/16	2 3/4	1 1/8	-	0.81
32440-TH	1 1/4	3 1/32	1 2 1/32	1 2 1/32	1 7/16	2 3 1/8	1 1/16	-	0.88
32442-TH	1 5/16	3 1/32	1 47/64	1 47/64	1 3/4	2 1 1/4	1 3/16	-	0.98
32444-TH	1 3/8	3 1/32	1 53/64	1 53/64	1 3/8	2 1 1/4	1 17/64	-	1.12
32446-TH	1 7/8	3 1/32	1 57/64	1 57/64	1 3/8	2 1 1/4	1 11/16	-	1.19
32448-TH	1 1/2	3 1/32	1 15/16	1 3/32	1 7/16	2 3 1/8	1 1/16	-	1.38

Fed. Spec: ANSI B107.1

Features

- SUPERTORQUE® lobular openings for greater turning power without deforming the fastener.
- Designed for quick engagement on both 6 and 12 point fasteners.



32420-TH 32412-TH

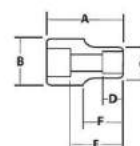

TOOLS@HEIGHT 1/2" DRIVE SHALLOW SOCKETS, 8 POINT, SAE

High-Polished Chrome Finish

		A	B	C	D	E		F	
Product Code	Size (Inches)	OAL (Inches)	Drive End Diameter (Inches)	Working End Diameter (Inches)	Broach Depth (Inches)	Bolt Clearance Depth (Inches)	Bolt Clearance Diameter (Inches)	Nose Length (Inches)	Weight (lbs.)
ST-812	3/8	1 1/2	7/8	27/32	5/16	27/32	5/16	7/8	0.14
ST-814	7/16	1 1/2	7/8	13/16	3/8	27/32	5/16	7/8	0.13
ST-816	1/2	1 1/2	29/32	29/32	13/32	27/32	11/32	-	0.16
ST-818	9/16	1 1/2	31/32	31/32	7/16	27/32	7/16	-	0.18
ST-820	5/8	1 1/2	1 1/16	1 1/16	1/2	27/32	7/16	-	0.24
ST-822	11/16	1 1/2	1 3/16	1 3/16	1/2	27/32	17/32	-	0.37
ST-824	3/4	1 1/2	1 9/32	1 9/32	9/16	27/32	23/32	-	0.37
ST-826	13/16	1 5/8	1 7/16	17/16	5/8	31/32	27/32	-	0.49
ST-828	7/8	1 3/4	1 1/2	1 1/2	5/8	1 1/16	15/16	-	0.53
ST-830	15/16	1 13/16	1 5/8	1 5/8	1 1/16	1 1/8	1 1/32	-	0.63
ST-832	1	1 15/16	1 11/16	1 11/16	1 1/16	1 1/4	1 1/32	-	0.78

Fed. Spec: ANSI B107.1

Features

- SUPERTORQUE® lobular openings for greater turning power without deforming the fastener.
- 8 point sockets are designed for quick engagement on 4 point fasteners.



ST-812

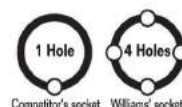
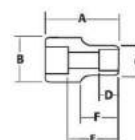

Williams T@H sockets, extensions, and adaptors feature a locking hole on all four sides, not just one. Williams T@H ratchets and drive tools feature a locking pin which mates with the side lock hole for positive retention. This reduces the risk of misaligning the socket that typical competitor's sockets with just one side hole create.

Release pin with WTHPRT - Pin Release Tool for William's Square Drive Tools

Do not use quick release tools with locking collars or push button release. These tools can be disengaged inadvertently.



WTHPRT



TOOLS@HEIGHT 1/2" DRIVE DEEP SOCKETS, 12 POINT, METRIC

High-Polished Chrome Finish



32820-TH

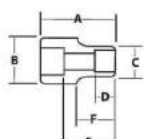

Product Code	Size (MM)	A OAL (Inches)	B Drive End Diameter (Inches)	C Working End Diameter (Inches)	D Broach Depth (Inches)	E Bolt Clearance Depth (Inches)	F Bolt Clearance Diameter (Inches)	Nose Length (Inches)	Weight (lbs)
32809-TH	9	3 1/4	29/32	19/32	5/16	2 15/32	11/32	2 19/32	0.22
32810-TH	10	3 1/4	29/32	19/32	5/16	2 15/32	11/32	2 19/32	0.22
32811-TH	11	3 1/4	29/32	11/16	5/16	2 15/32	13/32	2 19/32	0.22
32812-TH	12	3 1/4	29/32	23/32	13/32	2 15/32	7/16	2 19/32	0.23
32813-TH	13	3 1/4	29/32	29/32	3/8	2 15/32	15/32	2 19/32	0.24
32814-TH	14	3 1/4	29/32	27/32	3/8	2 15/32	15/32	2 19/32	0.24
32815-TH	15	3 1/4	29/32	7/8	3/8	2 11/32	15/32	-	0.24
32816-TH	16	3 1/4	29/32	29/32	9/16	2 11/32	15/32	-	0.27
32817-TH	17	3 1/4	31/32	31/32	9/16	2 11/32	15/32	-	0.31
32818-TH	18	3 1/4	1	1	13/16	2 11/32	15/32	-	0.34
32819-TH	19	3 1/4	1 1/32	1 1/32	13/16	2 5/16	23/32	-	0.37
32820-TH	20	3 1/4	1 1/16	1 1/16	13/16	2 5/16	23/32	-	0.40
32821-TH	21	3 1/4	1 1/8	1 1/8	13/16	2 5/16	3/4	-	0.41
32822-TH	22	3 1/4	1 3/16	1 3/16	13/16	2 5/16	23/32	-	0.46
32823-TH	23	3 1/4	1 1/4	1 1/4	25/32	2 5/16	27/32	-	0.49
32824-TH	24	3 1/4	1 1/2	1 1/2	13/16	2 5/16	3/8	-	0.52
32825-TH	25	3 1/4	1 5/16	1 5/16	13/16	2 1/4	15/16	-	0.55
32826-TH	26	3 1/4	1 3/8	1 3/8	29/32	2 1/4	31/32	-	0.57
32827-TH	27	3 1/4	1 7/16	1 7/16	31/32	2 1/4	1	-	0.66
32828-TH	28	3 1/4	1 1/2	1 1/2	1	2 1/4	1 1/32	-	0.73
32829-TH	29	3 1/4	1 9/16	1 9/16	1 1/32	2 1/4	1 1/16	-	0.78
32830-TH	30	3 1/4	1 5/8	1 5/8	1 1/32	2 1/4	1 3/32	-	0.83
32832-TH	32	3 1/4	1 11/16	1 11/16	1 1/2	2 1/4	1 3/16	-	0.93
32834-TH	34	3 1/4	1 3/4	1 3/4	7/8	2 1/4	1	-	0.93
32836-TH	36	3 1/4	1 15/16	1 15/16	7/8	2 1/4	1 13/32	-	1.16

Fed. Spec: ANSI B107.5

32949-TH - 24 Piece 1/2" Drive Deep 12 Point Socket Set on Clip Rail 12.02 lbs.

Features

- SUPERTORQUE® lobular openings for greater turning power without deforming the fastener.
- Designed for quick engagement on both 6 and 12 point fasteners.



TOOLS@HEIGHT 1/2" DRIVE STANDARD LENGTH HEX BIT SOCKETS, SAE

High-Polished Chrome Finish

Product Code	Size (Inches)	Socket Length (Inches)	Socket Outside Diameter (Inches)	Overall Length (Inches)	Bit Length (Inches)	Weight (lbs)
35208-TH	1/4	1 7/16	29/32	2 13/32	27/32	0.17
35210-TH	5/16	1 7/16	29/32	2 13/32	27/32	0.17
35212-TH	3/8	1 7/16	29/32	2 13/32	27/32	0.19
35214-TH	7/16	1 7/16	29/32	2 13/32	27/32	0.22
35202-TH	1/2	1 19/32	7/8	2 13/32	27/32	0.26
35203-TH	9/16	1 19/32	1	2 13/32	27/32	0.33
35204-TH	5/8	1 19/32	1 1/16	2 13/32	27/32	0.39
35206-TH	3/4	1 19/32	1 3/16	2 13/32	27/32	0.51



TOOLS@HEIGHT 1/2" DRIVE STANDARD LENGTH HEX BIT SOCKETS, METRIC

High-Polished Chrome Finish

Product Code	Size (MM)	Socket Length (Inches)	Socket Outside Diameter (Inches)	Overall Length (Inches)	Bit Length (Inches)	Weight (lbs)
35274-TH	8	1 19/32	23/32	2 13/32	27/32	0.17
35275-TH	10	1 19/32	23/32	2 7/16	27/32	0.19
35276-TH	12	1 19/32	23/32	2 7/16	27/32	0.22
35277-TH	14	1 19/32	1	2 7/16	27/32	0.32
35278-TH	17	1 19/32	1 3/32	2 7/16	27/32	0.43
35279-TH	19	1 19/32	1 3/16	2 7/16	27/32	0.51

Features

- High-polished chrome finish socket cleans easily.



35274-TH



35212-TH

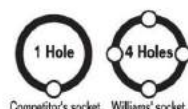

Competitor's socket Williams' socket

Williams T@H sockets, extensions, and adaptors feature a locking hole on all four sides, not just one. Williams T@H ratchets and drive tools feature a locking pin which mates with the side lock hole for positive retention. This reduces the risk of misaligning the socket that typical competitor's sockets with just one side hole create.

Release pin with WTHPRT - Pin Release Tool for William's Square Drive Tools

Do not use quick release tools with locking collars or push button release. These tools can be disengaged inadvertently.



WTHPRT



TOOLS@HEIGHT 3/4" DRIVE INTEGRATED HANDLE RATCHETS

Chrome and Black Industrial Finish

Product Code	Description	Length (Inches)	Number of Teeth	Weight (lbs)
H-51B-TH	Chrome Finish Ratchet	20 1/8	24	6.04
HB-51B-TH	Black Industrial Finish Ratchet	20 1/8	24	6.04

Fed. Spec: ANSI B107.10M

Features

- Forged one-piece ratchet provide strength and safety for industrial applications.
- Smooth comfort-grip handle permits all-day use without gloves.



TOOLS@HEIGHT 3/4" DRIVE EXTENSIONS

Chrome and Black Industrial Finish

Product Code	Description	Length (Inches)	Weight (lbs)
H-104B-TH	Black Industrial Finish Drive Extension	3	0.73
H-110B-TH	Black Industrial Finish Drive Extension	8	1.70
H-110-TH	Chrome Finish Drive Extension	8	1.72
H-115-TH	Chrome Finish Drive Extension	16	3.25

Fed. Spec: ANSI B107.10M

Features

- Chrome plating provides increased protection from rust and corrosion.
- Ball and spring socket retention.



TOOLS@HEIGHT 3/4" DRIVE HANDLE

Chrome and Black Industrial Finish

Product Code	Description	Length (Inches)	Finish
H-41AA-TH	Flex Handle Breaker Bar, Knurled Grip	22 1/8	Chrome

Fed. Spec: ANSI B107.10M

Features

- Chrome plating provides increased protection from rust and corrosion.
- Drive handles provide extra leverage with greater strength than ratchets.
- Square drive slides on T-Handles for versatility.
- Flex handle flex drive swivels 110° in either direction.



Williams T@H sockets, extensions, and adaptors feature a locking hole on all four sides, not just one. Williams T@H ratchets and drive tools feature a locking pin which mates with the side lock hole for positive retention. This reduces the risk of misaligning the socket that typical competitor's sockets with just one side hole create.

Release pin with WTHPRT - Pin Release Tool for Williams's Square Drive Tools

Do not use quick release tools with locking collars or push button release. These tools can be disengaged inadvertently.



WTHPRT



Be sure to use a lanyard that has more weight capacity than the tool you are attaching because drop forces are greater than actual tool weight.



TOOLS@HEIGHT 3/4" DRIVE SHALLOW 12 POINT SOCKETS, SAE

High-Polished Chrome Finish



33244-TH

33228-TH

Product Code	Size (Inches)	A OAL (Inches)	B Drive End Diameter (Inches)	C Working End Diameter (Inches)	F Nose Length (Inches)	Weight (lbs)
33228-TH	7/8	1 15/16	1 7/16	1 1/4	5/8	0.46
33230-TH	15/16	2	1 7/16	1 3/8	5/8	0.49
33232-TH	1	2 1/16	1 7/16	1 7/8	5/8	0.49
33234-TH	1 1/16	2 1/8	1 7/16	1 1/2	7/8	0.49
33236-TH	1 1/8	2 1/8	1 7/16	1 5/8	7/8	0.54
33238-TH	1 3/16	2 3/8	1 7/16	1 11/16	15/16	0.60
33240-TH	1 1/4	2 3/8	1 7/16	1 3/4	15/16	0.64
33242-TH	1 1/2	2 3/8	1 7/16	1 15/16	1	0.69
33244-TH	1 5/8	2 3/4	1 7/8	1 7/8	1	0.83
33246-TH	1 3/4	2 3/4	1 7/8	1 11/16	1 1/16	0.90
33248-TH	1 1/2	2 3/8	1 3/4	2 1/16	1 7/16	1.01
33252-TH	1 5/8	2 1/2	1 3/4	2 3/16	1 9/16	1.17
33256-TH	1 3/4	2 5/8	1 13/16	2 3/16	1 1/4	1.37
33258-TH	1 13/16	2 11/16	1 13/16	2 3/8	1 1/4	1.37
33260-TH	1 7/8	2 3/4	1 7/8	2 1/2	1 11/16	1.57
33264-TH	2	2 13/16	1 7/8	2 11/16	1 11/16	1.64

Fed. Spec: ANSI B107.1



TOOLS@HEIGHT 1" DRIVE HANDLE

Chrome and Black Industrial Finish

Product Code	Description	Length (Inches)	Finish	Weight (lbs)
X-41C-TH	Flex Handle Breaker Bar, Knurled Grip	34 3/16	Chrome	10.93

Fed. Spec: ANSI B107.10M

Features

- Chrome plating provides increased protection from rust and corrosion.
- Drive handles provide extra leverage with greater strength than ratchets.
- Square drive slides on T-Handles for versatility.
- Flex handle flex drive swivels 110° in either direction.
- Spring and plunger socket retention.



X-41C-TH



TOOLS@HEIGHT 1" DRIVE RATCHET

Integrated Handle, Chrome Finish

Product Code	Description	Length (Inches)	Number of Teeth	Weight (lbs)
X-51B-TH	Chrome Ratchet	20 1/8	24	6.25

Fed. Spec: ANSI B107.10M

Features

- Forged one-piece ratchet provide strength and safety for industrial applications.
- Smooth comfort-grip handle permits all-day use without gloves.
- 24 tooth gear with 15 degree of engagement allows engagement in tight working areas.
- Chrome finish with mirror-like exterior can be easily cleaned after each use.

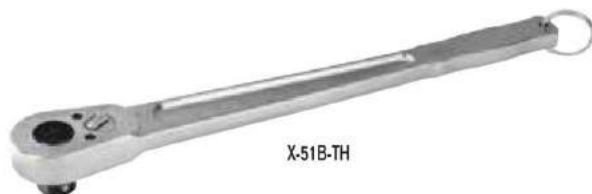

X-51B-TH

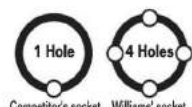

Competitor's socket Williams' socket

Williams T@H sockets, extensions, and adaptors feature a locking hole on all four sides, not just one. Williams T@H ratchets and drive tools feature a locking pin which mates with the side lock hole for positive retention. This reduces the risk of misaligning the socket that typical competitor's sockets with just one side hole create.

Release pin with WTHPRT - Pin Release Tool for William's Square Drive Tools

Do not use quick release tools with locking collars or push button release. These tools can be disengaged inadvertently.



WTHPRT