

STRAIGHT PATTERN BOX END STRIKING WRENCHES

Industrial Black Finish, 12 Point, SAE / Metric

Product Code	Size (Inches)	Size (MM)	A	B	C
			Overall Length (Inches)	Box End Diameter (Inches)	Box End Thickness (Inches)
SFH-1808BW	1 3/16	30	7 9/16	2 3/32	7/8
SFH-1808W	1 1/4	32	7 9/16	2 3/32	7/8
SFH-1808AW	1 5/16	33	7 9/16	2 3/32	7/8
SFH-1808CW	1 3/8	35	7 21/32	2 9/32	31/32
SFH-1809W	1 7/16	-	7 21/32	2 9/32	31/32
SFH-1809BW	-	36	7 21/32	2 9/32	31/32
SFH-1809AW	1 1/2	38	7 21/32	2 9/32	31/32
SFH-1810W	1 5/8	41	7 27/32	2 21/32	1 5/32
SFH-1810AW	1 11/16	43	7 13/16	2 21/32	1 5/32
SFH-1810BW	1 3/4	44	7 15/16	2 13/16	1 1/4
SFH-1811W	1 13/16	46	7 15/16	2 13/16	1 1/4
SFH-1811AW	1 7/8	-	7 15/16	2 13/16	1 1/4
SFH-1812BW	-	50	11 19/32	3 3/16	1 13/32
SFH-1812W	2	51	11 19/32	3 3/16	1 13/32
SFH-1812AW	2 1/16	52	11 19/32	3 3/16	1 13/32
SFH-1813W	2 3/16	55	11 3/4	2 9/16	1 17/32
SFH-1813AW	2 1/4	57	11 3/4	2 9/16	1 17/32
SFH-1814W	2 3/8	60	11 7/8	3 1/4	1 11/16
SFH-1814AW	2 1/2	62	11 7/8	3 3/4	1 11/16
SFH-1814BW	2 1/2	64	11 7/8	3 3/4	1 11/16
SFH-1815W	2 9/16	65	13	4	1 13/16
SFH-1815AW	2 5/8	67	13	4	1 13/16
SFH-1816W	2 3/4	70	14 9/32	4 9/32	1 15/16
SFH-1816AW	2 13/16	71	14 9/32	4 9/32	1 15/16
SFH-1816BW	2 15/16	75	14 15/32	4 17/32	2 1/16
SFH-1817AW	3	76	14 13/32	4 17/32	2 1/16
SFH-1817W	3 1/8	80	17 19/32	4 29/32	2 9/32
SFH-1818AW	3 3/8	85	17 19/32	4 29/32	2 9/32
SFH-1818W	3 1/2	89	17 19/16	5 5/16	2 15/32
SFH-1819BWA	3 3/4	95	17 29/32	5 17/32	2 21/32
SFH-1819WA	3 7/8	98	17 29/32	5 17/32	2 21/32
SFH-1819CWA	4 1/8	105	18 3/32	6 1/32	2 15/16
SFH-1819AWA	4 1/4	108	18 3/32	6 1/32	2 15/16
SFH-1820BWA	4 1/2	114	20 1/32	6 23/32	3 3/16
SFH-1820WA	4 5/8	117	20 1/32	6 23/32	3 3/16

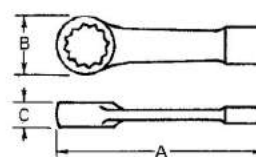

Features

- Striking face wrenches are designed to be struck by a hammer on the anvil area in order to loosen frozen fasteners or to set and tighten fasteners.
- Anvils are proportional to opening sizes. Special heat treating provides maximum durability for long life.
- Straight handle design resists springing while allowing the fastener to turn more easily.
- Williams' expanded line of offset striking face wrenches, up to 4 5/8", provides the most extensive line on the market.
- Specifically engineered to hold up under the most rigorous industrial use.



OFFSET PATTERN BOX END STRIKING WRENCHES

Industrial Black Finish, 12 Point, SAE / Metric

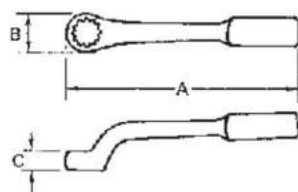

Product Code	Size (Inches)	Size (MM)	A Overall Length (Inches)	B Box End Diameter (Inches)	C Box End Thickness (Inches)
8807W	1 1/16	27	9 3/32	1 21/32	23/32
8807AW	1 1/8	-	10 3/32	1 15/16	3/4
8808BW	1 3/16	30	10 31/32	1 15/16	3/4
8808W	1 1/4	32	10 31/32	1 15/16	3/4
8808AW	1 9/16	33	10 31/32	1 15/16	3/4
8808CW	1 5/8	35	11 1/2	2 5/32	29/32
8809W	1 7/16	-	11 1/2	2 5/32	29/32
8809BW	-	36	11 1/2	2 5/32	29/32
8809AW	1 1/2	38	12	2 7/16	1
8810W	1 5/8	41	12	2 7/16	1
8810AW	1 11/16	43	12 3/16	2 11/16	1 1/8
8811BW	1 3/4	44	12 3/16	2 11/16	1 1/8
8811W	1 13/16	46	12 3/16	2 11/16	1 1/8
8811AW	1 7/8	-	13	2 7/8	1 1/4
8812AW	1 15/16	49	13	2 7/8	1 1/4
8812BW	-	50	13	2 7/8	1 1/4
8812W	2	51	13	2 7/8	1 1/4
8813BW	2 1/8	54	13 3/16	3 1/4	1 13/32
8813W	2 3/16	55	13 3/16	3 1/4	1 13/32
8813AW	2 1/4	57	13 3/16	3 1/4	1 13/32
8814AW	2 9/16	59	13 3/16	3 1/4	1 13/32
8814W	2 3/8	60	14 1/8	3 11/16	1 1/2
8815BW	2 1/2	64	14 1/8	3 11/16	1 1/2
8815W	2 9/16	65	14 1/8	3 11/16	1 1/2
8815AW	2 5/8	67	15	3 15/16	1 5/8
8816W	2 3/4	70	15	3 15/16	1 5/8
8816CW	2 7/8	73	16	4 7/16	1 3/4
8816BW	2 15/16	75	16	4 7/16	1 3/4
8817AW	3	76	16	4 7/16	1 3/4
8817W	3 1/8	80	16	4 7/16	1 3/4
8818AW	3 3/8	85	18 3/32	6	2
8818W	3 1/2	89	18 3/32	6	2
8819BW	3 3/4	95	18 3/32	6	2
8819W	3 7/8	98	18 3/32	6	2
8819CW	4 1/8	105	18 3/32	6	2
8819AW	4 1/4	108	18 3/32	6	2



Features

- Striking face wrenches are designed to be struck by a hammer on the anvil area in order to loosen frozen fasteners or to set and tighten fasteners.
- Anvils are proportional to opening sizes. Special heat treating provides maximum durability for long life.
- Offset handle is close to head to provide clearance in confined areas.
- Williams' expanded line of offset striking face wrenches, up to 4 1/4", provides the most extensive line on the market.
- Specifically engineered to hold up under the most rigorous industrial use.



FRAC PUMP WRENCH

A safer, more durable tool

Product Code	Stud Size
8817AFPW	Frac Pump Wrench



Features

- Specially designed for the oil and gas industry to work on fluid ends of well servicing pumps from all major manufacturers with 3" valve cover retainer nuts
- Offset design with 3" integrated hex driver
- A larger striking surface ensures fewer errant blows
- Offset reduces damage to manifold
- Robust metallurgy ensures a safer tool that is less likely to break



8811BW

STRIKING

WRENCHES



SLUGGING WRENCH RETAINERS

Product Code	Stud Size	Length	C	D
SWR-24	3/8	1 23/32	1 15/16	1 3/4
SWR-28	7/8	2	2 3/16	1 29/32
SWR-32	1	2 1/8	2 1/2	2 1/32
SWR-36	1 1/8	2 1/4	2 1/2	2 9/32
SWR-40	1 1/4	2 3/8	2 7/8	2 5/32
SWR-44	1 3/8	2 15/32	3 1/8	2 3/8
SWR-48	1 1/2	2 3/8	3 1/8	2 1/2
SWR-52	1 5/8	2 3/4	3 5/8	2 21/32
SWR-56	1 3/4	2 7/8	3 7/8	2 3/4
SWR-60	1 7/8	3	4 1/2	2 7/8

SWR-SET 10 Piece Slugging Wrench Retainers Set

Contents Include:

Product Code	Stud Size	Product Code	Stud Size
SWR-24	3/8	SWR-44	1 3/8
SWR-28	7/8	SWR-48	1 1/2
SWR-32	1	SWR-52	1 5/8
SWR-36	1 1/8	SWR-56	1 3/4
SWR-40	1 1/4	SWR-60	1 7/8

Features

- Slugging Wrench Retainers thread onto the end of the stud over the slugging wrench to ensure the wrench stays affixed to the fastener
- A spring loaded plate allows for easy adjustment of the wrench without having to unscrew the retainer.
- Increased productivity and safer operation by eliminating the need for a second worker to hold and slugging wrench in place
- Available in 10 sizes, marked with stud sizes (not hex sizes)
- Configured to work with offset and straight handle slugging wrenches

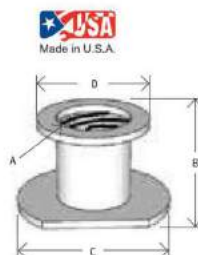

SWR-52

SWR-24



SWR-SET



HAMMER WRENCHES

6 Point

Product Code	Wrench Opening (Nut Size)	Head Dia.	Head Thickness	Overall Length
HW-6034	1 1/16	1 23/32	5/8	9 7/8
HW-6040	1 1/4	2	23/32	10 1/4
HW-6046	1 7/16	2 17/64	7/8	10 9/16
HW-6052	1 3/8	2 31/64	61/64	11
HW-6058	1 13/16	2 21/32	63/64	11 5/16
HW-6064	2	3 1/32	1 1/32	11 11/16
HW-6070	2 3/16	3 1/2	1 1/4	12
HW-6076	2 3/8	3 13/32	1 1/8	12 3/8
HW-6082	2 5/8	3 3/4	1 17/32	12 11/16
HW-6088	2 3/4	4 11/64	1 17/32	13 1/16
HW-6094	2 15/16	4 23/64	1 17/32	13 7/16
HW-6100	3 1/8	4 31/64	1 5/8	13 13/16
HW-6112	3 1/2	4 31/32	1 23/32	14 1/8
HW-6124	3 7/8	5 39/64	1 23/32	14 1/2

Features

- Designed for use in the petrochemical industries where clearance, particularly on flanges, and cored fasteners are often a problem:
- 6 Point Hex is offset 15 degree, and short handle length allows for use in tight spaces
- Straight Handle transfers maximum torque when struck
- Assortment fits Stud Sizes up to 2 1/2"



HW-6034



WS-476



WS-474



WS-483

WILLIAMS®



ADJUSTABLE PIN SPANNER WRENCHES

Industrial Black Finish, SAE

Product Code	Span Diameter (Inches)	Pin Diameter (Inches)	Pin Length (Inches)	Overall Length (Inches)
O-471	3/4 to 2	1/8	1/8	5 3/8
O-471A	3/4 to 2	3/16	3/32	5 3/8
O-472	1 1/4 to 3	3/16	3/16	6 7/8
O-472A	1 1/4 to 3	1/4	7/32	6 7/8
O-474	2 to 4 3/4	1/4	1/4	9 1/2
O-474A	4 1/2 to 6 1/4	3/8	1/4	9 7/8

WS-476 6-Piece Adjustable Pin Spanner Wrench Set, in Pouch

Contents Include:

Product Code	Overall Length (Inches)	Product Code	Overall Length (Inches)
O-471	5 3/8	O-472A	6 7/8
O-471A	5 3/8	O-474	9 1/2
O-472	6 7/8	O-474A	9 7/8

Features

- Ideal for adjusting collars, lock nut rings, and bearings.
- Specifically engineered to hold up under the most rigorous industrial use.



WILLIAMS®



ADJUSTABLE HOOK SPANNER WRENCHES

Industrial Black Finish, SAE

Product Code	Span Diameter (Inches)	Hook Depth (Inches)	Hook Thickness (Inches)	Overall Length (Inches)
471	3/4 to 2	1/8	11/32	5 3/8
472	1 1/4 to 3	5/32	13/32	7 1/4
474	2 to 4 3/4	3/16	15/32	11 1/2
474A	4 1/2 to 6 1/4	1/4	15/32	17 1/2
474B	6 1/8 to 8 3/4	5/16	15/32	18 1/2

WS-474 4-Piece Adjustable Hook Spanner Wrench Set, in Pouch

Product Code	Overall Length (Inches)	Product Code	Overall Length (Inches)
471	5 3/8	474	11 1/2
472	7 1/4	474A	17 1/2

Features

- Ideal for adjusting collars, lock nut rings, and bearings.
- Specifically engineered to hold up under the most rigorous industrial use.



WILLIAMS®



ADJUSTABLE FACE SPANNER WRENCHES

Industrial Black Finish, SAE

Product Code	Span Diameter (Inches)	Pin Diameter (Inches)	Pin Length (Inches)	Overall Length (Inches)
482	2	3/16	1/4	6 1/4
483	3	1/4	1/4	8 1/8
484	4	5/16	1/2	10 3/8

WS-483 3-Piece Adjustable Face Spanner Wrench Set, in Pouch

Contents Include:

Product Code	Overall Length (Inches)	Product Code	Overall Length (Inches)
482	6 1/4	484	10 3/8
483	8 1/8		

Features

- Ideal for adjusting collars, lock nut rings, and bearings.
- Specifically engineered to hold up under the most rigorous industrial use.

