



**STORAGE HUB // E72**



## OUR SIMPLE, STREAMLINED STORAGE SOLUTION

The E72 Storage HUB has been designed to offer market-leading levels of safety and performance in a streamlined model. The innovative, strong case is a key element at the core of the E72 and the E77 Premium HUB. Thanks to the subtle design with rounded corners, shock-absorbing corner bumpers and the new locking system with a round key, you are assured of optimal safety in every working environment. This tool trolley brings together many of our customers' most demanded features and can be customised with side-mounted accessories.





## DRAWER CONFIGURATION

5-DRAWERS



6-DRAWERS



7-DRAWERS



8-DRAWERS



## COLOURS

NO. DRAWERS	5	6	7	8
ORANGE RAL2009	1472K5	1472K6	1472K7	1472K8
RED RAL3001	1472K5RED	1472K6RED	1472K7RED	1472K8RED
BLUE RAL5002	1472K5BLUE	1472K6BLUE	1472K7BLUE	1472K8BLUE
BLACK RAL9005	1472K5BLACK	1472K6BLACK	1472K7BLACK	1472K8BLACK

### More colours?

Design your own storage solution with our BETMS configurator. Ask your dealer for more information.

## SHOCK-PROTECTING CORNER BUMPERS

### Protect against collisions

The Storage HUB E72 is equipped with shock-protecting corner bumpers made of fibre-strengthened plastic so it can easily take a bump.

The rounded design with no sharp edges minimises the chance of injuries and damage to surrounding objects.





### Strong steel top

The one-piece bench top with steel rim strengthens the core of the Storage HUB E72. It also prevents your tools from falling off.

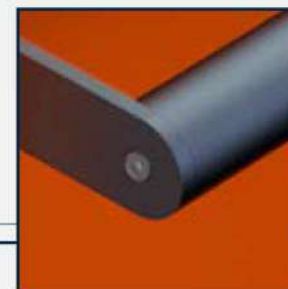

### A solid handle

The Storage HUB E72 has a solid handle in a user-friendly design. Need more control? Then we can attach a second handle to the other side.

FUNCTIONALITY



The logo consists of the letters 'AS' in a bold, white, sans-serif font, set against a red diamond-shaped background.

PERFORMANCE



DRAWER  
CAPACITY UP  
TO 30 KG.



75,000  
CYCLES

BAHCO

**Drawers which can open fully**

Thanks to the sliders with ball-bearings, the drawers glide very smoothly, can open all the way and have a capacity up to 30 kg.



**Rubber wheels for any surface**

The noiseless rubber wheels ensure maximum stability, making the trolley easy to manoeuvre, even on irregular surfaces. The wheels will leave no floor marking, are resistant to most common lubricants and have a static capacity of 600 kg.



The logo for Alliance Supplies (AS) is located in the top left corner, featuring the letters 'AS' in a stylized white font with a red outline, set against a red diamond-shaped background.The BAHCO logo is positioned to the right of the AS logo, consisting of the word 'BAHCO' in a bold, black, sans-serif font above a stylized fish icon, all contained within a white rectangular border with rounded corners.

PERFORMANCE

---

## ANTI-THEFT ROUND LOCKING SYSTEM



---

### Locking with a round key

The round locking system protects the Storage HUB E72 against theft.

A compact key holder with a user-friendly grip is also available, including two keys.





**STORAGE HUB E72**

**COLOUR:** ORANGE RAL2009

**ACCESSORY:** SIDE TOOL PANEL



### PRODUCT DETAILS

SIZE:	26"
WEIGHT:	5 drawers: 50 kg
	6 drawers: 55 kg
	7 drawers: 58 kg
	8 drawers: 61 kg
LOADING CAPACITY:	600 kg
DRAWER CAPACITY:	up to 30 kg
COLOURS:	Orange, Black, Red or Blue
NO. DRAWERS:	5 / 6 / 7 / 8
CUSTOMIZABLE:	Yes (BETMS Configurator)
LOCKING SYSTEM:	Yes

