



TORX®/Heavy-Duty Removal, Chrome (1/4")

#	Stock No.	A	B	C	D
T15	TTXB15E	1-37/64	45/64	11/16	TTXB15E2
T20	TTXB20E	1-37/64	45/64	11/16	TTXB20E2
T25	TTXB25E	1-37/64	45/64	11/16	TTXB25E2

209EFTXBY 9 pc Combination Drive TORX® Bit Heavy-Duty Removal Socket Set

- Includes 1/4" drive TTXB15E–TTXB25E (T15–T25) and 3/8" drive FTXB27E–FTXB50E (T27–T55) in a magnetic storage tray
- Tapered profile provides better engagement on stubborn fasteners
- Nickel-chrome plating helps protect against corrosion and makes it easy to wipe clean
- Manufactured from special alloy steel and treated for optimum strength and durability
- Use of a standard TORX® bit socket on a TORX Plus® fastener may result in a rounded out fastener head or damaged bit socket



TORX Plus®/Chrome (1/4")

TORX Plus® fasteners may be found in almost all vehicles from the 1999 model year to present. Common applications include GM® transmissions bell housing bolts and Ford® seat belt anchors. T27IP size can be used to service Taurus® and Sable® front spring shields. Use of a standard TORX® driver on TORX Plus® fasteners may result in a rounded out fastener head or damaged driver.

#	Stock No.	A	B	C	D	
T8	TTX8TPE	1-37/64	45/64	15/32	TTX8TPE2	•
T10	TTX10TPE	1-37/64	45/64	15/32	TTX10TPE2	•
T15	TTX15TPE	1-37/64	45/64	15/32	TTX15TPE2	•
T20	TTX20TPE	1-37/64	45/64	15/32	TTX20TPE2	•
T25	TTX25TPE	1-37/64	45/64	15/32	TTX25TPE2	•
—	TMX1	5/16	1-1/4	—	—	•

Set shown includes magnetic storage tray.

211EFTXTPY 11 pc Combination Drive TORX Plus® Bit Socket Driver Set

- Includes 1/4" drive (8IP–25IP) and 3/8" drive (27IP–55IP) in a magnetic storage tray
- TORX Plus® fasteners may be found in most vehicles from 1999–present
- Common applications include GM® transmission bell housing bolts, Ford® seat belt anchors, and Ford® Taurus® and Sable® front spring shields
- Use of a standard TORX® driver on TORX Plus® fasteners may result in a rounded-out fastener head or damaged driver



TORX®/Tamper-Resistant, Chrome (1/4")

#	Stock No.	A	B	C	D	
T8	TTXR8E	1-37/64	45/64	15/32	TTXR8E2	•
T10	TTXR10E	1-37/64	45/64	15/32	TTXR10E2	•
T15	TTXR15E	1-37/64	45/64	15/32	TTXR15E2	•
T20	TTXR20E	1-37/64	45/64	15/32	TTXR20E2	•
T25	TTXR25E	1-37/64	45/64	15/32	TTXR25E2	•
TR40	TTXR40E	2-1/8	1-3/4	15/32	TTXR40E2	•
	TMU8B	1/2	1-5/16			•

Sets shown include magnetic storage tray

210EFTXRY 10 pc Combination Drive TORX® Bit Tamper-Resistant Socket Set

- Includes 1/4" drive TTXR8E–TTXR25E (TR8–TR25) and 3/8" drive FTXR27E–FTXR50E (TR27–TR50) in a magnetic storage tray
- Two piece pinless design holds bit securely in socket while facilitating quick bit replacement
- Cold-formed socket delivers a strong, durable tool
- Nickel-chrome alloy finish resists against rust and corrosion



TORX®/Long, Chrome (1/4")

#	Stock No.	A	B	C	D	
T8	TTXL8E	4-1/16	3-13/64	15/32	TTXL8E2	•
T10	TTXL10E	4-1/16	3-13/64	15/32	TTXL10E2	•
T15	TTXL15E	4-1/16	3-13/64	15/32	TTXL15E2	•
T20	TTXL20E	4-1/16	3-13/64	15/32	TTXL20E2	•
T25	TTXL25E	4-1/16	3-13/64	15/32	TTXL25E2	•

Set includes storage tray

210EFTXL 10 pc Combination Drive TORX® Bit Long Socket Set

- Includes 1/4" drive TTXL8E–TTXL25E (T8–T25) and 3/8" drive FTXL27E–FTXL50E (T27–T50) in a storage tray
- Nickel-chrome plating helps protect against corrosion and makes it easy to wipe clean
- Manufactured from special alloy steel and treated for optimum strength and durability
- Use of a standard TORX® bit socket on a TORX Plus® fastener may result in a rounded out fastener head or damaged bit socket



- Do not use chrome or industrial finish hand tools with power drivers or impact drivers.
- Do not use power tools or accessories with impact drivers.
- Read Safety Precautions on pages W1–W4

TORX® BIT SOCKETS



TTXR8TPE



211EFTXRTPY

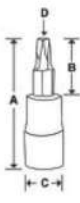

★ TORX Plus®/Tamper-Resistant, Chrome (1/4")

#	Stock No.	A	B	C	D
T8	TTXR8TPE	1-37/64	45/64	15/32	TTXR8TPE2
T10	TTXR10TPE	1-37/64	45/64	15/32	TTXR10TPE2
T15	TTXR15TPE	1-37/64	45/64	15/32	TTXR15TPE2
T20	TTXR20TPE	1-37/64	45/64	15/32	TTXR20TPE2
T25	TTXR25TPE	1-37/64	45/64	15/32	TTXR25TPE2

211EFTXRTPY 11 pc Combination Drive Tamper-Resistant TORX Plus® Socket Driver Set

- Includes 1/4" drive (8IPR–55IPR) and 3/8" Drive (27IPR–55IPR)
- Applications: 2003 Ford® Mustang® transmissions, 2004 Ford® F-150® transfer case, 2004 Porsche® Cayenne® turbo air sensor, Delphi® and Stanadyne® pumps, Cummins® B and C engine injection pumps and John Deere® diesel injector pumps
- Includes magnetic storage tray

METRIC HEX BIT SOCKETS



TMAM6E



106ETMAMY

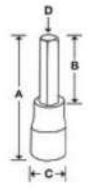

TMAMXS6E

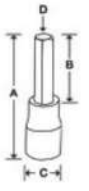

Hex/Standard, mm, Chrome (1/4")

mm		A	B	C	D	
2	TMAM2E	47.1	24.9	12.1	TMAM2E2	•
2.5	TMAM2.5E	47.1	24.9	12.1	TMAM2.5E2	•
3	TMAM3E	47.6	25.4	12.1	TMAM3E2	•
4	TMAM4E	47.6	25.4	12.1	TMAM4E2	•
5	TMAM5E	47.6	25.4	12.1	TMAM5E2	•
6	TMAM6E	47.6	25.4	12.1	TMAM6E2	•

106ETMAMY
Set Contains:

Sets shown include magnetic storage tray

210EFTAMY 10 pc Combination Drive Metric Standard Hex Bit Socket Set

- Includes 1/4" drive TMAM2E–TMAM3E (2–3 mm) and 3/8" drive FAM4E–FAM10E (4–10 mm) in a magnetic storage tray
- Indispensable sockets for a wide variety of applications in automotive (foreign and domestic), aviation and industrial settings
- Sockets are manufactured from special alloy steel that provides long life and great strength
- Nickel-chrome plating helps protect against corrosion and makes it easy to wipe socket clean

Hex/Stubby, mm, Chrome (1/4")

mm		A	B	C	D	
3	TMAMXS3E	26.0	3.8	12.1	TMAMXS3E2	
4	TMAMXS4E	27.1	4.8	12.1	TMAMXS4E2	
5	TMAMXS5E	28.1	5.8	12.1	TMAMXS5E2	
6	TMAMXS6E	29.1	6.9	12.1	TMAMXS6E2	



208EFTAMXS Y

208EFTAMXS Y 8 pc Combination Drive Metric Hex Bit Stubby Socket Driver Set

- Includes 1/4" drive TMAMXS3E–TMAMXS6E (3–6 mm) and 3/8" drive FAMXS7E–FAMXS10E (7–10 mm) in a magnetic storage tray
- Short bit length for use in limited-access spaces
- Sockets are manufactured from special alloy steel that provides long life and great strength
- Nickel-chrome plating helps protect against corrosion and makes it easy to wipe socket clean



TUAM4E

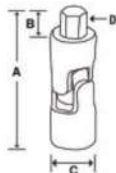

Hex/Stubby Universal, mm, Chrome (1/4")

mm		A	B	C	D
4	TUAM4E	36.6	4.7	12.6	TMAMXS4E2
5	TUAM5E	38.4	6.5	12.6	TUAM5E2
6	TUAM6E	38.4	6.5	12.6	TUAM6E2



TUA6E

Hex/Stubby Universal, Inches, Chrome (1/4")

TUA6E 1/4" Drive 3/16" Stubby Flex Hex Bit Socket

- Precision machined and heat-treated for optimum strength and durability
- Nickel-chrome finish helps protect against corrosion and makes it easy to wipe clean
- Replacement Bit - TMAXS6E2



208EFTABMY



Ball Hex/Standard, mm, Chrome (1/4")

mm		A	B	C	D
3	TMABM3E	47.6	25.4	12.1	TMABM3E2
4	TMABM4E	47.6	25.4	12.1	TMABM4E
5	TMABM5E	47.9	25.7	12.1	TMABM5E2
6	TMABM6E	47.9	25.7	12.1	TMABM6E2

208EFTABMY 8 pc Combination Drive Metric Ball Hex Bit Socket Set

- Includes 1/4" drive TMABM3E–TMABM6E (3–6 mm), 3/8" drive FABM7E–FABM10E (7–10 mm) in a magnetic storage tray
- Ball end of bit makes it easier to insert bit into fastener, especially in blind-access applications
- Sockets are manufactured from special alloy steel that provides long life and great strength
- Nickel-chrome plating helps protect against corrosion and makes it easy to wipe socket clean

Combination Bit Socket Sets

237HEXTORXST 37 pc Combination Drive Socket Driver Set

- Up to 20% stronger than 1 pc bit designs and up to twice ANSI® proof load
- Heat-treated for strength and durability
- Precise fit to fasteners and multiple detents for secure drive attachment

- Set includes:
 - (5) 1/4" Drive Standard TORX® Bit Sockets
 - (7) 3/8" Drive Standard TORX® Bit Sockets
 - (7) 3/8" Drive Stubby TORX® Bit Sockets
 - (3) 3/8" Drive Triple Square Drivers
 - (7) 3/8" Drive Metric Hex Bit Sockets
 - (4) 1/4" Drive Stubby Metric Hex Bit Sockets
 - (4) 3/8" Drive Stubby Metric Hex Bit Sockets



237HEXTORXST



- Do not use chrome or industrial finish hand tools with power drivers or impact drivers.
- Read Safety Precautions on pages W1–W4



HEX BIT SOCKETS

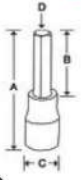

Hex/Standard, Inches, Chrome (1/4")

Set Contains: 110ETMAY

			A	B	C	Bit	Optional Long Bit	Optional Long Bit Length, inches	
1/16	TMA2E	—	1-7/8	1	7/16	TMA2E2	TMAL2E2	6	•
5/64	TMA2.5E	GTMA2.5E	1-7/8	1	15/32	TMA2.5E2	TMAL2.5E2	6	•
3/32	TMA3E	GTMA3E	1-7/8	1	15/32	TMA3E2	TMAL3E2	6	•
7/64	TMA3.5E	—	1-7/8	1	15/32	TMA3.5E2	TMAL3.5E2	6	•
1/8	TMA4E	GTMA4E	1-7/8	1	15/32	TMA4E2	TMAL4E2	6	•
9/64	TMA4.5E	—	1-7/8	1	15/32	TMA4.5E2	TMAL4.5E2	6	•
5/32	TMA5E	GTMA5E	1-7/8	1	15/32	FA5E2	—	—	•
3/16	TMA6E	GTMA6E	1-15/16	1-1/16	15/32	FA6E2	—	—	•
7/32	TMA7E	GTMA7E	1-7/8	1-1/64	15/32	FA7E2	—	—	•
1/4	TMA8E	GTMA8E	1-7/8	1-1/64	15/32	FA8E2	—	—	•

NOTE: Optional long bits are not included in the listed sets.
Sets shown include magnetic storage tray

212EFTAY 12 pc Combination Drive SAE Standard Hex Driver Bit Socket Set

- Includes 1/4" drive TMA2E–TMA3E (1/16–3/32") and 3/8" drive FA4E–FA12E (1/8–3/8") in a magnetic storage tray
- Indispensable sockets for a wide variety of applications in automotive (foreign and domestic), aviation and industrial settings
- Sockets are manufactured from special alloy steel that provides long life and great strength
- Nickel-chrome plating helps protect against corrosion and makes it easy to wipe socket clean

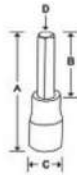

TMAXS6E

208EFTAXSY

Hex/Stubby, Inches, Chrome (1/4")

		A	B	C	D
3/32	TMAXS3E	1-1/32	5/32	15/32	TMAXS3E2
1/8	TMAXS4E	1-1/32	5/32	15/32	TMAXS4E2
9/64	TMAXS4.5E	1-1/16	3/16	15/32	TMAXS4.5E2
5/32	TMAXS5E	1-1/16	3/16	15/32	TMAXS5E2
3/16	TMAXS6E	1-3/32	7/32	15/32	TMAXS6E2

TMAXS3E 1/4" Drive SAE 3/32" Stubby Hex Socket Driver

- For fasteners on Rolls-Royce® commercial aircraft V2500 engines
- A stubby bit socket allows for a positive fit, giving more direct torque when removing or installing these fasteners
- Sockets are manufactured from special alloy steel that provides long life and great strength
- Nickel-chrome plating helps protect against corrosion and makes it easy to wipe socket clean

208EFTAXSY 8 pc Combination Drive SAE Hex Bit Stubby Socket Driver Set

- Includes 1/4" drive TMAXS4E–TMAXS6E (1/8–3/16") and 3/8" drive FAXS8E–FAXS12E (1/4–3/8") in a magnetic storage tray
- Short bit length for use in limited-access spaces

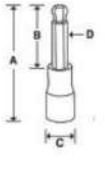

TMAB6E

208EFTABY

Ball Hex/Standard, Inches, Chrome (1/4")

		A	B	C	D
1/8	TMAB4E	1-7/8	1	15/32	TMAB4E2
9/64	TMAB4.5E	1-7/8	1	15/32	TMAB4.5E2
5/32	TMAB5E	1-7/8	1	15/32	FAB5E2
3/16	TMAB6E	1-15/16	1-1/16	15/32	FAB6E2

208EFTABY 8 pc Combination Drive SAE Standard Ball Hex Bit Socket Set

- Includes 1/4" drive TMAB4E–TMAB6E (1/8–3/16") and 3/8" drive FAB7E–FAB12E (7/32–3/8"), in a magnetic storage tray
- Ball end of bit makes it easier to insert bit into fastener, especially in blind access applications
- Sockets are manufactured from special alloy steel that provides long life and great strength
- Nickel-chrome plating helps protect against corrosion and makes it easy to wipe sockets clean

Mortorq®/Super Bits

#	Stock No.	A	B
MTS-4	PTMTS4SE	1-11/16	PTMTS4E2

PTMTS4SE 1/4" Drive MTS-4 Mortorq® Stubby Bit Socket

- **Applications:**
Connects the fuel cell to the electric motors and other systems on Hyundai® Tucson® IX Fuel Cell Vehicles

PTMTS4SE2 MTS-4 Mortorq® Bit

- Replacement bit for PTMTS4SE Mortorq® bit socket



PTMTS4SE

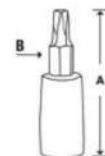

FLAT TIP AND PHILLIPS® TIP BIT SOCKETS

Flat Tip/ Standard, Chrome (1/4")

	Stock No.	A	B	C	D
Short	TM82	55/64	19/64	15/32	TM82-2C
Standard Length	TMC104E	2-29/32	2-1/32	15/32	TMC104E2A
	TMC105E	2-15/16	2-1/16	15/32	TMC105E2A
	TMC106E	2-7/8	2	15/32	TMC106E2A



TMC104E

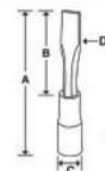

PHILLIPS®/Standard, Chrome (1/4")

	Stock No.	Industrial Stock No.	A	B	C	D
Short	#2 TMP21E	—	1-17/64	25/64	15/32	TMP21E2
	#2 TMP82	—	15/16	9/16	15/32	TMP82-2B
Standard Length	#1 TMP12E	GTMP12E	1-57/64	1	15/32	TMP12E2
	#2 TMP22E	—	1-57/67	1	15/32	TMP22E2
Long	#2 TMP23E	—	3-5/64	2-13/64	15/32	TMP23E2



TMP22E



GTMP12E



TMP23E

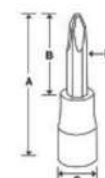

CLUTCH BIT SOCKETS

Clutch/Standard, Chrome (1/4")

Stock No.	A	B
TM27E	3/16	1-3/8
TM30E	1/4	1-3/8
TM31E	5/32	1-3/8



TM27E



IMPACT ACCESSORIES



103ITMX



Extensions (Impact)

- Features snap-ring anvil for excellent socket-to-extension engagement
- Designed for use with most 1/4" cordless electric and air operated impact tools

Set Contains:
103ITMX

Stock No.	Finish	A	B
ITMX20	Industrial Finish	5/16	2
ITMX40	Industrial Finish	5/16	4
ITMX60	Industrial Finish	5/16	6

Set includes storage tray



IPM80B



IPM800B



Swivel Ball Universal Joint (Impact)

Stock No.	Retention Type	A	B
IPM80B	Lock Button	5/8	1-3/8
IPM800B	Friction Ball	5/8	1-3/8



- Do not use chrome or industrial finish hand tools with power drivers.
- Wear safety goggles while using impact drivers.
- Do not hold swivel joint during use.
- Wear safety goggles (user and bystanders).
- Do not use power sockets or accessories with impact drivers.
- Read Safety Precautions on pages W1-W4

IMPACT ACCESSORIES



Locking Extensions (Impact)

- Quick-release locking sleeve provides secure connection and easy socket removal
- Knurled release collar for easy one-hand operation, even with slippery hands
- Female drive end recessed to accommodate new style impact guns
- Positive pin lock retains socket securely
- Heavy-duty shank for high torque applications

Stock No.	A	B	Set Contains:
TMIXL122	11/32	11-7/8	•
TMIXL182	11/32	17-3/4	•
TMIXL242	11/32	23-3/4	•
TMIXL32	11/32	2-7/8	•
TMIXL62	11/32	5-7/8	•

Set includes storage tray

FLANK DRIVE® IMPACT SOCKETS



112IMTMM

Shallow, mm

mm	6	A	B	C	D	E	6	6
4	IMTMM4	7.9	12.7	13.3	22.2	4.0		
4.5	IMTMM4.5	7.9	12.7	13.3	22.2	4.0		
5	IMTMM5	8.7	12.7	13.3	22.2	4.0	•	
5.5	IMTMM5.5	9.5	12.7	13.3	22.2	4.1	•	
6	IMTMM6	10.3	12.7	13.3	22.2	5.6	•	
7	IMTMM7	11.9	12.7	13.3	22.2	5.6	•	
8	IMTMM8	12.7	12.7	13.3	22.2	5.6	•	•
9	IMTMM9	14.3	14.3	13.3	22.2	5.6	•	•
10	IMTMM10	15.9	15.9	13.0	22.2	5.6	•	•
11	IMTMM11	16.7	16.7	12.7	22.2	6.4	•	•
12	IMTMM12	17.5	17.5	12.6	22.2	6.4	•	•
13	IMTMM13	19.1	19.1	12.5	22.2	7.1	•	•
14	IMTMM14	20.6	20.6	13.1	23.0	7.9	•	•
15	IMTMM15	21.4	21.4	13.7	24.6	8.7	•	•

Sets shown include magnetic storage tray ASME®/ANSI® B107.33M



112SIMTMM

Deep, mm

mm	6	A	B	C	D	E	6	6
4	SIMTMM4	7.9	12.7	41.9	50.8	4.0		
4.5	SIMTMM4.5	7.9	12.7	41.9	50.8	4.0		
5	SIMTMM5	8.7	12.7	41.9	50.8	4.0	•	
5.5	SIMTMM5.5	9.5	12.7	41.9	50.8	4.0	•	
6	SIMTMM6	10.3	12.7	41.9	50.8	5.6	•	
7	SIMTMM7	11.9	12.7	41.9	50.8	5.6	•	
8	SIMTMM8	13.5	13.5	35.3	50.8	5.6	•	•
9	SIMTMM9	14.3	14.3	41.9	50.8	5.6	•	•
10	SIMTMM10	15.9	15.9	37.3	50.8	5.6	•	•
11	SIMTMM11	16.7	16.7	37.3	50.8	6.4	•	•
12	SIMTMM12	18.3	18.3	37.2	50.8	6.4	•	•
13	SIMTMM13	19.1	19.1	37.2	50.8	7.1	•	•
14	SIMTMM14	20.6	20.6	37.2	50.8	7.9	•	•
15	SIMTMM15	21.4	21.4	37.2	50.8	8.7	•	•

Sets shown include magnetic storage tray ASME®/ANSI® B107.33M



106IMTM

Shallow, inches

II	6	A	B	C	D	E	6	6
1/4	IMTM8A	7/16	1/2	1/2	7/8	7/32	•	
5/16	IMTM10A	1/2	1/2	1/2	7/8	7/32	•	
3/8	IMTM12A	9/16	9/16	1/2	7/8	7/32	•	
7/16	IMTM14A	21/32	21/32	1/2	7/8	1/4	•	
1/2	IMTM16A	23/32	23/32	15/32	7/8	9/32	•	
9/16	IMTM18A	25/32	25/32	1/2	29/32	11/32	•	

Set shown includes magnetic storage tray. ASME®/ANSI® B107.2



106SIMTM

Deep, inches

II	6	A	B	C	D	E	6	6
1/4	SIMTM8	13/32	1/2	1-5/8	2	7/32	•	
5/16	SIMTM10	17/32	17/32	1-5/8	2	7/32	•	
3/8	SIMTM12	9/16	9/16	1-15/32	2	7/32	•	
7/16	SIMTM14	21/32	21/32	1-5/8	2	1/4	•	
1/2	SIMTM16	23/32	23/32	1-7/16	2	9/32	•	
9/16	SIMTM18	25/32	25/32	1-7/16	2	11/32	•	

Set shown includes magnetic storage tray. ASME®/ANSI® B107.2



106IPTMMA



106IPTMA

Shallow Swivel, mm

Set Contains: 106IPTMMA

mm	6	A	B	C	D	E	6
5.5	IPTMM5.5A	9.5	16.6	7.6	44.8	4.1	
5	IPTMM5A	8.6	16.6	7.7	44.4	4.1	
6	IPTMM6A	10.7	16.6	7.5	45.2	4.1	
7	IPTMM7A	11.5	16.6	8.5	46.4	4.3	
8	IPTMM8A	11.5	16.6	8.5	46.4	4.3	•
9	IPTMM9A	12.8	16.6	9.3	47.5	4.8	
10	IPTMM10A	14.1	16.6	10.0	48.7	5.3	•
11	IPTMM11A	15.5	16.6	10.5	49.9	5.8	
12	IPTMM12A	17.5	18.9	12.8	53.2	6.9	•
13	IPTMM13A	18.9	18.9	13.4	54.4	7.4	•
14	IPTMM14A	20.5	18.9	14.6	56.0	7.9	•
15	IPTMM15A	21.3	18.9	15.0	56.4	7.9	•

Set includes storage tray

Shallow Swivel, inches

Set Contains: 106IPTMA

II	6	A	B	C	D	E	6
1/4	IPTM8A	7/16	21/32	9/32	1-25/32	5/32	•
5/16	IPTM10A	17/32	21/32	11/32	1-7/8	5/32	•
3/8	IPTM12A	9/16	21/32	13/32	1-15/16	3/16	•
7/16	IPTM14A	21/32	24/32	7/16	2-1/32	1/4	•
1/2	IPTM16A	23/32	24/32	9/16	2-5/32	9/32	•
9/16	IPTM18A	13/16	24/32	19/32	2-7/32	5/16	•

Set includes storage tray

SPECIAL APPLICATION IMPACT SOCKETS

Shallow 10-Point, mm

1/4" Drive 10-Point Metric 10 mm Shallow Impact Socket

- Body: Remove/install seat tracks on Honda® Odyssey® and Pilot®
- Forged from tough alloy steel
- Heat-treated to a lower hardness to add impact resistance and ductility

DPTM10 1/4" Drive 10-Point Metric 10 mm Shallow Impact Socket

DPTM8 1/4" Drive 10-Point Metric 8 mm Shallow Impact Socket



DPTM10

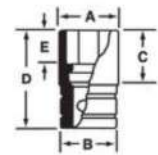

POWER ACCESSORIES

Locking Power Adaptors

- Use with electric/cordless drills and screwdrivers that accept 1/4" shanks
- Manufactured from the highest quality proprietary steel, providing optimum strength and durability
- Knurled sleeve provides easy attachment and removal of sockets even with the greasiest hands
- One handed lock mechanism with ball retention ensures socket retention and allows for faster socket attachment and removal
- Black oxide finish helps protect against corrosion for longer tool life

Set Contains: 103TMLPA

Stock No.	A	B	
TMLPA2	1/4	2	•
TMLPA4	1/4	4	•
TMLPA6	1/4	6	•

Set includes storage tray

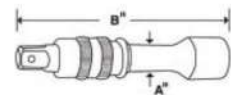

103TMLPA



- Wear safety goggles while using impact drivers.
- Do not hold swivel joint tools during use.
- Do not use power sockets or accessories with impact drivers.
- Read Safety Precautions on pages W1-W4

POWER ACCESSORIES



GM3042A



PTTX20E

TTX20E2

Hex-to-Square Adaptors (Power)

• 1/4" hex size; 1" length of hex

Stock No.	A	B
GM3042A	Lock Button	2
GM3043	Lock Button	4
GM3046	Lock Button	6
GM3048	Lock Button	8

TORX®/Standard (Power), Industrial (1/4")

#	Stock No.	A	B	C	D
T20	PTTX20E	1-37/64	45/64	15/32	TTX20E2
T25	PTTX25E	1-37/64	45/64	15/32	TTX25E2

FLANK DRIVE® MAGNETIC SOCKETS

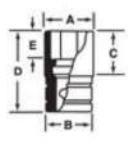

Shallow Magnetic, mm

- Magnetic sockets are perfect for installing and removing a fastener as the magnetic feature will hold the fastener in the socket saving time and frustration
- Square drive side hole works with ball- or pin-type retention
- Flank Drive® wrenching system grips the fastener on the socket flanks (flats) to deliver up to 15–25% more turning power
- MGMM series sockets are not designed to be used with Impact Drivers



110MGMM

mm	6	A	B	D	E	6
5	MGMM5	8.4	12.1	22.8	4.6	•
5.5	MGMM5.5	9.3	12.1	22.8	5.1	•
6	MGMM6	10.2	12.1	22.8	6.1	•
7	MGMM7	11.5	12.1	22.8	6.1	•
8	MGMM8	12.7	12.7	23.8	6.1	•
10	MGMM10	15.2	15.2	23.8	6.1	•
12	MGMM12	17.3	17.3	23.8	6.4	•
13	MGMM13	18.9	18.9	23.8	7.9	•
14	MGMM14	20.5	20.5	23.8	8.6	•
15	MGMM15	21.3	21.3	23.8	8.6	•

Set Contains: 110MGMM

Set shown includes magnetic storage tray

FLANK DRIVE® MAGNETIC POWER SOCKETS



MGM10C



MGMS10A

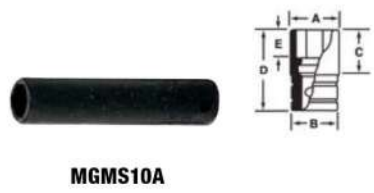

MGMS10A

Shallow Magnetic, inches

Hex	6	A	B	D	E
1/4	MGM8D	7/16	1/2	7/8	3/32
5/16	MGM10C	1/2	1/2	15/16	3/32
3/8	MGM12C	9/16	19/32	15/16	1/8
7/16	MGM14C	11/16	11/16	15/16	1/8

Deep Magnetic/ Spring Loaded, mm

mm	6	A	B	D	E
7	MGMS7A	10.7	12.4	50.8	5.8
8	MGMS8A	11.8	12.4	50.8	5.8
10	MGMS10A	14.1	14.1	50.8	6.4
11	MGMS11B	15.6	15.6	50.8	6.4
12	MGMS12B	17.3	17.3	50.8	7.1
13	MGMS13A	18.1	18.1	50.8	7.6

Deep Magnetic/ Spring Loaded, inches

Hex	6	A	B	D	E
5/16	MGMS10A	3/8	15/32	2	5/16
1/4	MGMS8A	3/8	7/16	2	3/32

General Service Foam Sets (1/4")

195GSS01FR* 95 pc 1/4" Drive General Service Foam Set

195GSS02FR* 95 pc 1/4" Drive Soft Grip General Service Foam Set

- Includes (81) SAE/metric shallow, semi-deep and deep sockets, (6) extensions, (1) adaptor, (1) universal joint, (3) soft grip flex-head and (3) soft grip standard ratchets in modular foam organizers
- Includes (5) individual modular foam sets that can be reconfigured in-drawer to accommodate new tools sets
- Designed for maximum tool concentration on smallest possible footprint
- Flexible and expandable as tool collection evolves
- Closed cell cross-linked foam for superior performance and durability resists oils, solvents and fuels—easy to clean
- Contrasting colors provide visual control which eliminates time searching for missing tools
- Protects your investment and increases productivity

145RTMLEFR 45 pc 1/4" Drive Dual 80® Technology Low-Profile Ratchet/Flank Drive® Socket Master Set

- Low-profile sockets, combined with an Internal Hex Drive Ratchet, work great in the tightest of areas
- Includes (26) low-profile sockets (5–13 mm, 3/16–9/16", E4–E8), (17) Stubby Bits (5 TORX® bits, (5) hex bits, (5) metric hex bits, (1) flat tip bit and (1) #2 PHILLIPS® bit, (1) low-profile ratchet and (1) low-profile magnetic bit holder
- Dual 80® Technology requires less arc to engage the next gear tooth to provide extra access in confined areas
- 72 gear teeth requires minimal movement in tight areas with eight teeth in contact with gear to provide strength and durability
- Thin handle cross section allows for greater accessibility in tight quarters and low-profile easy-action reverse lever won't get in your way
- Foam organizer provides in-drawer reconfiguration for new tools and is precision-fit for ultimate tool protection
- Contrasting colors provide visual control and closed cell cross-linked foam resists oils, solvents and fuels
- Organizer includes pockets for miscellaneous tools



195GSS01FR



195GSS02FR



145RTMLEFR

Colors Available



Red Orange Green

* O G

ADD SUFFIX TO STOCK NUMBER FOR SPECIAL COLORS.

1/8" DRIVE GENERAL SERVICE SET

1605TA General Service Set

Five piece set includes:

- 1/8" drive sockets are ideal for tight clearance and low torque applications

	Stock No.	Description
3/32	T6	1/8" Drive 6-Point SAE 3/32" Socket
1/8	T8	1/8" Drive 6-Point SAE 1/8" Socket
5/32	T10	1/8" Drive 6-Point SAE 5/32" Socket
3/16	T12	1/8" Drive 6-Point SAE 3/16" Socket
--	T40A	1/8" Drive Handle



1605TA



- Do not use chrome or industrial finish hand tools with power drivers or impact drivers.
- Do not use power sockets or accessories with impact drivers.
- Read Safety Precautions on pages W1–W4

GENERAL SERVICE SETS

Expandable Sets

Seven Tools Includes:

Stock No.	Description
SGT4BR**	1/4" Drive 6-13/16" Instinct® Soft Grip Standard Shank Driver
T72*	Standard Handle
TMU8B	1/4" Drive Universal Joint
TMXK2*	1/4" Drive 2" Knurled Extension
TMXK4	1/4" Drive 4" Knurled Extension
TMXK60*	1/4" Drive 6" Knurled Extension
TM10G*	1/4" Drive 6" Breaker Bar

*ASME®/ANSI® B107.10

**SGTL4B features a locking pin for better socket retention.

107ATMPB Expandable General Service Set and Additions

- Start with the 107ATMPB General Service Set and add any of the suggested socket sets below to custom build exactly the 1/4" drive set you need
- The storage case has a large enough cavity to accommodate two rows of sockets—standard, semi-deep, deep, universal or any combination of these in SAE or metric sizes



107ATMPB

Set (Add-on):

Suggested Additions Not Included in Set:	Stock No.	Description
	110TMY	10 pc 1/4" Drive 6-Point SAE Flank Drive® Shallow Socket Set
	110STMY	10 pc 1/4" Drive 6-Point SAE Flank Drive® Deep Socket Set
	111TMMDY	11 pc 1/4" Drive 12-Point Metric Flank Drive® Shallow Socket Set
	111STMMDY	11 pc 1/4" Drive 12-Point Metric Flank Drive® Deep Socket Set
	106ETMAMY	6 pc 1/4" Drive Metric Standard Hex Bit Socket Set



131TMPB

131TMPB 31 pc 1/4" Drive 6-Point Metric Shallow General Service Socket Set

31 Tools, Includes:

mm	6-Point Shallow Sockets	6-Point Deep Sockets
4	TMM4*	
5	TMM5*	STMM5*
5.5	TMM5.5*	STMM5.5*
6	TMM6	STMM6
7	TMM7	STMM7
8	TMM8	STMM8
9	TMM9	STMM9
10	TMM10	STMM10
11	TMM11	STMM11
12	TMM12	STMM12
13	TMM13	STMM13
14	TMM14	STMM14
15	TMM15	STMM15

ASME® B107.5m
*Conventional hex

Also Includes	Stock No.	Description
	TMXK60**	1/4" Drive 6" Knurled Extension
	TMXK2**	1/4" Drive 2" Knurled Extension
	T72**	Standard Handle
	TM10G**	1/4" Drive 6" Breaker Bar
	TMU8B	1/4" Drive Universal Joint
	SSDMR4B	8-3/4" Ratcheting Standard Screwdriver
	GMB3041***	1/4" Drive 1" Long 1/4" Hex-To-1/4" Square Adaptor

ASME®/ANSI® B107.5
***Insert Bit Style, non-impact



117TMM

117TMM 17 pc 1/4" Drive 6-Point Metric Starter Set

17 Tools, Includes:

mm	6-Point Shallow Sockets
4	TMM4*
5	TMM5*
5.5	TMM5.5*
6	TMM6
7	TMM7
8	TMM8
9	TMM9
10	TMM10
11	TMM11
12	TMM12
13	TMM13
14	TMM14
15	TMM15

ASME® B107.5m
*Conventional hex

Also Includes	Stock No.	Description
	T72**	Standard Handle
	TMU8B	1/4" Drive Universal Joint
	TMXK2**	1/4" Drive 2" Knurled Extension
	TMXK4	1/4" Drive 4" Knurled Extension

**ASME®/ANSI® B107.5

Colors Available



* R O G
ADD SUFFIX TO STOCK NUMBER FOR SPECIAL COLORS.

144TMPBFR 44 pc 1/4" Drive 6-Point Metric/SAE General Service Foam Set
144TMPBFR

mm	6-Point Shallow Sockets		6-Point Shallow Sockets	mm	6-Point Deep Sockets		6-Point Deep Sockets
5.5	TMM5.5	3/16	TM6*	5.5	STMM5.5	3/16	STM6*
6	TMM6	7/32	TM7*	6	STMM6	7/32	STM7*
7	TMM7	1/4	TM8	7	STMM7	1/4	STM8
8	TMM8	9/32	TM9	8	STMM8	9/32	STM9
9	TMM9	5/16	TM10	9	STMM9	5/16	STM10
10	TMM10	11/32	TM11	10	STMM10	11/32	STM11
11	TMM11	3/8	TM12	11	STMM11	3/8	STM12
12	TMM12	7/16	TM14	12	STMM12	7/16	STM14
13	TMM13	1/2	TM16	13	STMM13	1/2	STM16
14	TMM14	9/16	TM18	14	STMM14	9/16	STM18

 ASME® B107.1
 *Conventional hex

Also Includes	Stock No.	Description
	T72**	Standard Handle
	TMU8B	1/4" Drive 1-1/8" Friction Ball Universal Joint
	TMXK2**	1/4" Drive 2" Knurled Extension
	TMXK60**	1/4" Drive 6" Knurled Extension

**ASME®/ANSI® B107.10

144YTMPBFR 44 pc 1/4" Drive 6-Point Metric/SAE Flank Drive® Xtra General Service Foam Set
44 Tools, Includes:
144YTMPBFR

mm	6-Point Shallow Sockets		6-Point Shallow Sockets	mm	6-Point Deep Sockets		6-Point Deep Sockets
5.5	YTMM5.5	3/16	YTM6	5.5	YSTMM5.5	3/16	YSTM6
6	YTMM6	7/32	YTM7	6	YSTMM6	7/32	YSTM7
7	YTMM7	1/4	YTM8	7	YSTMM7	1/4	YSTM8
8	YTMM8	9/32	YTM9	8	YSTMM8	9/32	YSTM9
9	YTMM9	5/16	YTM10	9	YSTMM9	5/16	YSTM10
10	YTMM10	11/32	YTM11	10	YSTMM10	11/32	YSTM11
11	YTMM11	3/8	YTM12	11	YSTMM11	3/8	YSTM12
12	YTMM12	7/16	YTM14	12	YSTMM12	7/16	YSTM14
13	YTMM13	1/2	YTM16	13	YSTMM13	1/2	YSTM16
14	YTMM14	9/16	YTM18	14	YSTMM14	9/16	YSTM18

Also Includes	Stock No.	Description
	T72**	Standard Handle
	TMU8B	1/4" Drive 1-1/8" Friction Ball Universal Joint
	TMXK2**	1/4" Drive 2" Knurled Extension
	TMXK60**	1/4" Drive 6" Knurled Extension

**ASME®/ANSI® B107.10

- Do not use "cheater bars" on handles. Pull, do not push on handle.
- Do not immerse sealed ratchet in fluids.
- Do not replace worn parts individually; use entire contents of the service kit.
- Do not use chrome or industrial finish hand tools with power drivers or impact drivers.
- Do not use screwdrivers as prybars, chisels or punches.
- Read Safety Precautions on pages W1-W4





GENERAL SERVICE SETS



134ATMP

134ATMP 34 pc 1/4" Drive 6-Point SAE Shallow/Deep General Service Socket Set

34 Tools, Includes:

	6-Point Shallow Sockets		6-Point Deep Sockets
3/16	TM6*	3/16	STM6*
7/32	TM7*	7/32	STM7*
1/4	TM8	1/4	STM8
9/32	TM9	9/32	STM9
5/16	TM10	5/16	STM10
11/32	TM11	11/32	STM11
3/8	TM12	3/8	STM12
7/16	TM14	7/16	STM14
1/2	TM16	1/2	STM16
9/16	TM18	9/16	STM18

ASME® B107.1
*Conventional hex

Also Includes	Stock No.	Description
	T72**	Standard Handle
	TMU8B	1/4" Drive 1-1/8" Friction Ball Universal Joint
	TMXK2**	1/4" Drive 2" Knurled Extension
	TMXK4	1/4" Drive 4" Knurled Extension
	TMXK60**	1/4" Drive 6" Knurled Extension
	SGT4BR***	1/4" Drive 6-13/16" Instinct® Soft Grip Standard Shank Driver
	TM10G**	1/4" Drive 6" Breaker Bar
	TM61A**	1/4" Drive 6" Flexible Extension
	TM77**	1/4" Drive 20-Tooth Ratchet Adaptor
	TM82	1/4" Drive 1/4" Flat Tip Short Bit Socket
	TM408	1/4" Drive 8-Point 1/4" Double Square Socket
	TM410	1/4" Drive 8-Point 5/16" Double Square Socket
	TM412	1/4" Drive 8-Point 3/8" Double Square Socket
	TMS70A**	1/4" Drive Spinner Ratchet

**ASME®/ANSI® B107.10
***SGTL4B features a locking pin for better socket retention.



114ATMP

114ATMP 14 pc 1/4" Drive 6-Point SAE Shallow General Service Socket Set

14 Tools, Includes:

	Stock No.
3/16	TM6*
7/32	TM7*
1/4	TM8
9/32	TM9
5/16	TM10
11/32	TM11
3/8	TM12
7/16	TM14
1/2	TM16
9/16	TM18

ASME® B107.1
*Conventional hex

Also Includes	Stock No.	Description
	T72**	Standard Handle
	TMU8B	1/4" Drive 1-1/8" Friction Ball Universal Joint
	TMXK2**	1/4" Drive 2" Knurled Extension
	TMXK4	1/4" Drive 4" Knurled Extension

**ASME®/ANSI® B107.10



120DTMPB

120DTMPB 20 pc 1/4" Drive 6-Point SAE Shallow General Service Socket Set

20 Tools, Includes:

$\frac{1}{4}$ "	Stock No.
3/16	TM6*
7/32	TM7*
1/4	TM8
9/32	TM9
5/16	TM10
11/32	TM11
3/8	TM12
7/16	TM14
1/2	TM16
9/16	TM18

ASME® B107.1
*Conventional hex

Also Includes	Stock No.	Description
	TM4CSA	1/4" Drive 6" Standard Shank Driver
	TM10G**	1/4" Drive 6" Breaker Bar
	TM408	1/4" Drive 8-Point 1/4" Double Square Socket
	TM410	1/4" Drive 8-Point 5/16" Double Square Socket
	TM412	1/4" Drive 8-Point 3/8" Double Square Socket
	T72**	Standard Handle
	TMU8B	1/4" Drive 1-1/8" Friction Ball Universal Joint
	TMXK2**	1/4" Drive 2" Knurled Extension
	TMXK4**	1/4" Drive 4" Knurled Extension
	TMXK60**	1/4" Drive 6" Knurled Extension

**ASME®/ANSI® B107.10

RATCHETS, HANDLES AND ACCESSORIES (Blue-Point®)

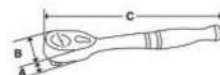

Quick-Release Ratchets (Blue-Point®) (1/4")

Stock No.	Description	Gear Teeth	Gear Action	A	B	C	Ratchet Service Kit
BPRTR936	1/4" Drive Standard Handle Quick-Release Ratchet (Blue-Point®)	36	10°	15/32	31/32	5-5/8	RKRBPRTR936
BPRTR936SG	1/4" Drive Soft Grip Handle Quick-Release Ratchet (Blue-Point®)	36	10°	15/32	31/32	5-5/8	RKRBPRTR936

Set includes storage tray

BPR703 3 pc Standard Handle Quick-Release Ratchet Set (Blue-Point®)

- Includes 1/4" Drive BPRTR936, 3/8" Drive BPRFR938 and 1/2" Drive BPRSR940 Ratchets (3 pc) in a storage tray
- Features quick-release button for rapid socket/accessory changes, even with greasy or oily hands
- Contoured handle for comfort and control
- Chrome finish for easy cleanup
- All ratchets in series meet or exceed ANSI® B107-10M-1996 specifications

BPRTR936SG 1/4" Drive Soft Grip Handle Quick-Release Ratchet (Blue-Point®)

- Quick-release button for rapid socket/accessory changes, even with greasy or oily hands
- Corrosion-resistant bi-mold cushion grips for improved comfort and performance

- Do not use chrome or industrial finish hand tools with power drivers or impact drivers.
- Do not use "cheater bars" on handles. Pull, do not push on handle.
- Do not immerse sealed ratchet in fluids.
- Frequently inspect, clean, and lubricate all nonsealed ratchet mechanisms with light oil.
- Do not replace worn parts individually; use entire contents of the service kit.
- Wear safety goggles (user and bystanders).
- Read Safety Precautions on pages W1-W4



RATCHETS, HANDLES AND ACCESSORIES (Blue-Point®)

1/4" DRIVE TOOLS



Ratchet Spinners (Blue-Point®) (1/4")

Stock No.	Square Drive, inches	Description	A	B
FSDR [‡]	1/4 Male to 1/4 Female	1/4" External Drive/1/4" Internal Square Drive Finger Ratchet (Blue-Point®)	1-1/8	1-7/16
FSD14 [‡]	3/8 Male to 1/4 Female	3/8" Drive Male to 1/4" Drive Female Spinner Adaptor (Blue-Point®)	1	1-1/2
FSD38 [‡]	1/4 Male to 3/8 Female	1/4" Drive Male to 3/8" Drive Female Spinner Adaptor (Blue-Point®)	1	1-1/2
FSDR1 ^{‡*}	3/8 Male to 1/4 Female	3/8" External Drive/1/4" Internal Square Drive Finger Ratchet (Blue-Point®)	1-1/8	1-7/16
BLPSD14	3/8 Male to 1/4 Female	3 pc Spinner Adaptor Set (Blue-Point®)	7/8	27/32

*ASME®/ANSI® B107.10

FSD3KT[‡] 3 pc Spinner Adaptor Set (Blue-Point®)

• Includes FSD14 (3/8 male to 1/4 female), FSD38 (1/4 male to 3/8 female) and FSD1 (3/8 male to 3/8 male)

FSDR[‡] 1/4" External Drive/1/4" Internal Square Drive Finger Ratchet (Blue-Point®)

- Reversible finger ratchet; small size works great for extremely tight areas
- Aluminum knurled outer ring for sure grip
- 1/4" drive on one side and 1/4" hex drive on other side



Breaker Bars (Blue-Point®) (1/4")

Stock No.	Description	A	B	C
BLPBB146	1/4" Drive 6" Breaker Bar	5/8	6	3/8



BLPCGHD146

Handled Drivers (Blue-Point®)

Stock No.	Length, inches	Blade Length, inches (mm)	Shank Dia., inches	Square Drive, inches
BLPCGHD146	6	2-1/2 (64)	5/16	1/4



BLPEXTF146

Flexible Extensions (Blue-Point®)

Stock No.	A	B	C
BLPEXTF146	5/16	3-5/8 (92)	6



BLPTXK1.5

Knurled Extensions (Blue-Point®)

Stock No.	B
BLPTXK1.5	1-9/16
BLPTXK2	2-3/32
BLPTXK3	2-15/16
BLPTXK4	4
BLPTXK6	6



103TMXLBP

Locking Extensions, Chrome (Blue-Point®)

Stock No.	B	Set Contains:
TMXLBP4	4	•
TMXLBP6	6	•
TMXLBP10	10	•

Set includes storage tray

Extra-Long Locking Extensions (Blue-Point®) 1/4" Drive 12" Extra-Long Locking Extension (Blue-Point®)

- Smooth, durable chrome finish
- Made from tough 6130 steel
- Secure socket retention
- Do not use with power or impact tools



BLPEXTL1412

BLPEXTL1418

BLPEXTL1424

Stock No.	Length, inches	Square Drive, inches
BLPEXTL1412	12	1/4
BLPEXTL1418	18	1/4
BLPEXTL1424	24	1/4



Set Screw Locking Extensions (Blue-Point®)

Stock No.	Finish	A	B
YA515A	Chrome	1/2	1-11/16

YA515A 1/4" Drive 1-11/16" Set Screw Locking Extension (Blue-Point®)

- Allows easy and secure tool stacking
- Securely connects breaker bar, extensions and ratchets to socket and socket drivers for overhead work
- Sliding sleeve for easy removal



Turbo T-Handle Speed Drivers (Blue-Point®)

Stock No.	Description	Handle Type
T9TURBO	1/4" Square Drive	Turbo T-Handle
TH10TURBO	1/4" Hex	Turbo T-Handle

TURBOT103 3 pc 1/4" Drive Turbo T-Handle Set (Blue-Point®)

- T9TURBO (1/4" drive), TH10TURBO (1/4" hex) and F11TURBO (3/8" drive)



BLPUJ14

Universal Joints, Chrome (Blue-Point®)

Stock No.	A	B
BLPUJ14	5/8	1-1/2



BLPAFM3814

BLPAFM1438

Square Drive Adaptors (Blue-Point®)

Stock No.	Description	A	B
BLPAFM3814	3/8" Drive Square Drive Adaptor (Blue-Point®)	3/8	1/4
BLPAFM1438	1/4" Drive Square Drive Adaptor (Blue-Point®)	1/4	3/8



BLPSM145

BLPSM149

BLPSM1412

Shallow, mm, Chrome (Blue-Point®)

mm	6	A	B	C
4	BLPSM144	24.8	11.9	6.8
4.5	BLPSM144.5	24.8	11.9	7.4
5	BLPSM145	24.8	11.9	8.1
5.5	BLPSM145.5	24.8	11.9	8.7
6	BLPSM146	24.8	11.9	9.3
7	BLPSM147	24.8	11.9	10.8
8	BLPSM148	24.8	11.9	11.9
9	BLPSM149	24.8	13.3	13.3
10	BLPSM1410	24.8	14.5	14.5
11	BLPSM1411	24.8	15.9	15.9
12	BLPSM1412	24.8	16.9	16.9
13	BLPSM1413	24.8	18	18
14	BLPSM1414	24.8	19.6	19.6



BLPS1414

BLPS14716

Shallow, Inches, Chrome (Blue-Point®)

II	6	A	B	C
3/16	BLPS14316	31/32	15/32	5/16
7/32	BLPS14732	31/32	15/32	23/64
1/4	BLPS1414	31/32	15/32	3/8
9/32	BLPS14932	31/32	15/32	7/16
5/16	BLPS14516	31/32	15/32	15/32
11/32	BLPS141132	31/32	1/2	33/64
3/8	BLPS1438	31/32	9/16	9/16
7/16	BLPS14716	31/32	5/8	5/8
1/2	BLPS1412	31/32	11/16	11/16
9/16	BLPS14916	31/32	3/4	3/4
5/8	BLPS1458	31/32	55/64	55/64

- Do not use "cheater bars" on handles.
- Do not push on handle.
- Do not use chrome or industrial finish hand tools with power drivers or impact drivers.
- These products can expose you to chemicals which are known to the state of California to cause cancer and reproductive harm. See pages P1-P2 for details.
- Read Safety Precautions on pages W1-W4.





SOCKETS (Blue-Point®)



BLPLSM145



BLPLSM1412

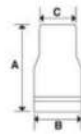

BLPLS1414



BLPLS1412

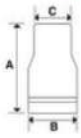

Deep, mm, Chrome (Blue-Point®)

mm	6	A	B	C
4	BLPLSM144	50	11.9	6.8
5	BLPLSM145	50	11.9	8.1
6	BLPLSM146	50	11.9	9.3
7	BLPLSM147	50	11.9	10.8
8	BLPLSM148	50	11.9	11.9
9	BLPLSM149	50	13.3	13.3
10	BLPLSM1410	50	14.5	14.5
11	BLPLSM1411	50	15.9	15.9
12	BLPLSM1412	50	16.9	16.9
13	BLPLSM1413	50	18	18
14	BLPLSM1414	50	19.6	19.6

Deep, Inches, Chrome (Blue-Point®)

II	6	A	B	C
3/16	BLPLS14316	1-43/64	15/32	5/16
7/32	BLPLS14732	1-43/64	15/32	23/64
1/4	BLPLS1414	1-43/64	15/32	3/8
9/32	BLPLS14932	1-43/64	15/32	7/16
5/16	BLPLS14516	1-43/64	15/32	15/32
11/32	BLPLS141132	1-43/64	1/2	33/64
3/8	BLPLS1438	1-43/64	9/16	9/16
7/16	BLPLS14716	1-43/64	5/8	5/8
1/2	BLPLS1412	1-43/64	11/16	11/16
5/8	BLPLS1458	1-31/32	55/64	55/64
9/16	BLPLS14916	1-43/64	3/4	3/4

8-Point, Inches, Chrome (Blue-Point®)



BLPS81414

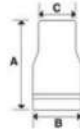

II	Stock No.	A	B	C
1/4	BLPS81414	31/32	15/32	15/32
3/8	BLPS81438	31/32	5/8	5/8
5/16	BLPS814516	31/32	9/16	9/16



122TSTY

Twist Impact, inches/mm

- Removes slotted and Phillips® screws as well as nuts, bolts that are too tight for traditional screwdrivers

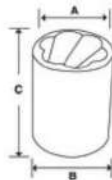

TSTY70

Set Contains: 122TSTY

#	Stock No.	A	B	C	
4.50 mm	TSTY45	0.29 (7.4)	0.50 (12.7)	1 (25.4)	•
4.75 mm (3/16")	TSTY47	0.31 (7.9)	0.50 (12.7)	1 (25.4)	•
5.00 mm	TSTY50	0.32 (8.1)	0.50 (12.7)	1 (25.4)	•
5.25 mm	TSTY52	0.33 (8.4)	0.50 (12.7)	1 (25.4)	•
5.50 mm	TSTY55	0.34 (8.6)	0.50 (12.7)	1 (25.4)	•
5.75 mm	TSTY57	0.35 (8.9)	0.50 (12.7)	1 (25.4)	•
6.00 mm	TSTY60	0.37 (9.4)	0.50 (12.7)	1 (25.4)	•
6.25 mm (1/4")	TSTY62	0.38 (9.7)	0.50 (12.7)	1 (25.4)	•
6.50 mm	TSTY65	0.39 (9.9)	0.50 (12.7)	1 (25.4)	•
6.75 mm	TSTY67	0.40 (10.2)	0.50 (12.7)	1 (25.4)	•
7.00 mm	TSTY70	0.41 (10.4)	0.50 (12.7)	1 (25.4)	•
7.25 mm (9/32")	TSTY72	0.42 (10.7)	0.50 (12.7)	1 (25.4)	•
7.50 mm	TSTY75	0.44 (11.2)	0.50 (12.7)	1 (25.4)	•
7.75 mm	TSTY77	0.45 (11.5)	0.50 (12.7)	1 (25.4)	•
8.00 mm (5/16")	TSTY80	0.47 (11.8)	0.50 (12.7)	1 (25.4)	•
8.25 mm	TSTY82	0.48 (12.2)	0.50 (12.7)	1 (25.4)	•
8.50 mm	TSTY85	0.49 (12.6)	0.50 (12.7)	1 (25.4)	•
8.75 mm (11/32")	TSTY87	0.51 (12.9)	0.50 (12.7)	1 (25.4)	•
9.00 mm	TSTY90	0.52 (13.2)	0.50 (12.7)	1 (25.4)	•
9.25 mm	TSTY92	0.54 (13.6)	0.50 (12.7)	1 (25.4)	•
9.50 mm (3/8")	TSTY95	0.55 (14.0)	0.50 (12.7)	1 (25.4)	•
10.00 mm	TSTY100	0.57 (14.5)	0.50 (12.7)	1 (25.4)	•

Includes socket rail and clips

TORX®/External, Chrome (Blue-Point®)

#	Stock No.	A	B	C
E4	BLPTE144	1	15/32	7/32
E5	BLPTE145	1	15/32	17/64
E6	BLPTE146	1	15/32	5/16
E7	BLPTE147	1	15/32	21/34
E8	BLPTE148	1	15/32	3/8



BLPTE144

TORX® BIT SOCKETS (Blue-Point®)

TORX®/Standard (Blue-Point®)



BLPT1410

#	Stock No.	A	B	C
T6	BLPT146	1-13/32	15/32	7/16
T7	BLPT147	1-13/32	15/32	7/16
T8	BLPT148	1-13/32	15/32	7/16
T9	BLPT149	1-13/32	15/32	7/16
T10	BLPT1410	1-13/32	15/32	7/16
T15	BLPT1415	1-13/32	15/32	7/16
T20	BLPT1420	1-13/32	15/32	7/16
T25	BLPT1425	1-13/32	15/32	7/16
T27	BLPT1427	1-13/32	15/32	7/16
T30	BLPT1430	1-13/32	15/32	7/16

TORX®/Long (Blue-Point®)



BLPTL1410

#	Stock No.	A	B	C
T6	BLPTL146	3-15/16	15/32	7/16
T7	BLPTL147	3-15/16	15/32	7/16
T8	BLPTL148	3-15/16	15/32	7/16
T9	BLPTL149	3-15/16	15/32	7/16
T10	BLPTL1410	3-15/16	15/32	7/16
T15	BLPTL1415	3-15/16	15/32	7/16
T20	BLPTL1420	3-15/16	15/32	7/16
T25	BLPTL1425	3-15/16	15/32	7/16
T27	BLPTL1427	3-15/16	15/32	7/16
T30	BLPTL1430	3-15/16	15/32	7/16



BLPTORX1410

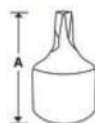

BLPTORX1410

TORX®/Stubby, Chrome (Blue-Point®) (1/4")

Set Contains:

#	Stock No.	A	
T10	BLPTS1410	3/4 (19)	•
T15	BLPTS1415	3/4 (19)	•
T20	BLPTS1420	3/4 (19)	•
T25	BLPTS1425	3/4 (19)	•
T27	BLPTS1427	3/4 (19)	•
T30	BLPTS1430	3/4 (19)	•
T40	BLPTS1440	3/4 (19)	•
T45	BLPTS1445	3/4 (19)	•
T47*	BLPTS1447	3/4 (19)	•
T50	BLPTS1450	3/4 (19)	•

*T47 is not a TORX® licensed product.



BLPTS1410TP

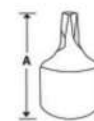

TORX®/Tamper-Resistant, Stubby (Blue-Point®) (1/4")

#	Stock No.	A
TP8	BLPTS148TP	3/4 (19)
TP10	BLPTS1410TP	3/4 (19)
TP15	BLPTS1415TP	3/4 (19)
TP20	BLPTS1420TP	3/4 (19)
TP25	BLPTS1425TP	3/4 (19)
TP27	BLPTS1427TP	3/4 (19)
TP30	BLPTS1430TP	3/4 (19)
TP40	BLPTS1440TP	3/4 (19)
TP45	BLPTS1445TP	3/4 (19)
TP50	BLPTS1450TP	3/4 (19)



• Do not use chrome or industrial finish hand tools with power drivers or impact drivers.
• Read Safety Precautions on pages W1-W4



TORX® BIT SOCKETS (Blue-Point®)



BLPT1410TP

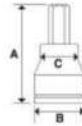

BLPTL1410TP

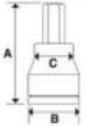

★ TORX®/Tamper-Resistant, Standard (Blue-Point®) (1/4")

#	Stock No.	A	B	C
T6	BLPT146TP	1-13/32	15/32	7/16
T7	BLPT147TP	1-13/32	15/32	7/16
T8	BLPT148TP	1-13/32	15/32	7/16
T9	BLPT149TP	1-13/32	15/32	7/16
T10	BLPT1410TP	1-13/32	15/32	7/16
T10	BLPT1440TP	1-13/32	15/32	7/16
T15	BLPT1415TP	1-13/32	15/32	7/16
T20	BLPT1420TP	1-13/32	15/32	7/16
T25	BLPT1425TP	1-13/32	15/32	7/16
T27	BLPT1427TP	1-13/32	15/32	7/16
T30	BLPT1430TP	1-13/32	15/32	7/16

★ TORX®/Tamper-Resistant, Long, Chrome (Blue-Point®) (1/4")

#	Stock No.	A	B	C
T6	BLPTL146TP	3-15/16	15/32	7/16
T7	BLPTL147TP	3-15/16	15/32	7/16
T8	BLPTL148TP	3-15/16	15/32	7/16
T9	BLPTL149TP	3-15/16	15/32	7/16
T10	BLPTL1410TP	3-15/16	15/32	7/16
T15	BLPTL1415TP	3-15/16	15/32	7/16
T20	BLPTL1420TP	3-15/16	15/32	7/16
T25	BLPTL1425TP	3-15/16	15/32	7/16
T27	BLPTL1427TP	3-15/16	15/32	7/16
T30	BLPTL1430TP	3-15/16	15/32	7/16

METRIC HEX BIT SOCKETS (Blue-Point®)



BLPHEXS1418

Hex/Stubby, mm, Chrome (Blue-Point®) (1/4")

mm		Length, mm
2	BLPHSM142	19.05
2.5	BLPHSM1425	19.05
3	BLPHSM143	19.05
4	BLPHSM144	19.05
5	BLPHSM145	19.05
6	BLPHSM146	19.05
7	BLPHSM147	19.05
8	BLPHSM148	19.05
9	BLPHSM149	19.05
10	BLPHSM1410	19.05

BLPHEXS1418 18 pc 1/4" Drive SAE/Metric Stubby Hex Bit Socket Set (Blue-Point®)

- Includes (9) SAE Stubby Hex Bit Sockets (3/32–3/8") and (9) Metric Stubby Hex Bit Sockets (2–10 mm)
- Includes storage tray



BLPH124

Hex/Standard, mm, Chrome (Blue-Point®) (1/4")

mm		A	B	C
2.5	BLPH1425	36	12	11
3	BLPH123	36	12	11
4	BLPH124	36	12	11
5	BLPH125	36	12	11
6	BLPH126	36	12	11
7	BLPH127	36	12	12
8	BLPH128	36	12	12



BLPHL144

Hex/Long, mm (Blue-Point®)

mm		A	B	C
4	BLPHL144	100	12	11
5	BLPHL145	100	12	11
6	BLPHL146	100	12	11



BLPH1414

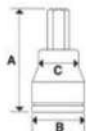

Hex/Standard, Inches, Chrome (Blue-Point®) (1/4")

Hex Size	Stock No.	A	B	C
1/8	BLPH1418	1-13/32	15/32	7/16
9/64	BLPH14964	1-13/32	15/32	7/16
5/32	BLPH14532	1-13/32	15/32	7/16
3/16	BLPH14316	1-13/32	15/32	7/16
7/32	BLPH14732	1-13/32	15/32	7/16
1/4	BLPH1414	1-13/32	15/32	7/16
5/16	BLPH14516	1-13/32	15/32	15/32



BLPHS1414



Hex/Stubby, Inches, Chrome (Blue-Point®) (1/4")

Hex Size	Stock No.	Length, inches (mm)
5/64	BLPHS14564	3/4 (19)
3/32	BLPHS14332	3/4 (19)
7/64	BLPHS14764	3/4 (19)
1/8	BLPHS1418	3/4 (19)
5/32	BLPHS14532	3/4 (19)
3/16	BLPHS14316	3/4 (19)
7/32	BLPHS14732	3/4 (19)
1/4	BLPHS1414	3/4 (19)
5/16	BLPHS14516	3/4 (19)
3/8	BLPHS1438	3/4 (19)



BPHL14532

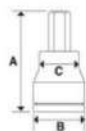

Hex/Long, inches (Blue-Point®)

Hex Size	Stock No.	A	B	C
1/8	BLPHL1418	3-15/16	15/32	7/16
3/16	BLPHL14316	3-15/16	15/32	7/16
5/32	BLPHL14532	3-15/16	15/32	7/16

TRIPLE SQUARE BIT SOCKETS (Blue-Point®)

● Triple Square/Stubby, XZN, Chrome (Blue-Point®) (1/4")

mm	Stock No.	Dimension A, Length, inches
4	BLPXZN144	1-1/16
5	BLPXZN145	1-1/16
6	BLPXZN146	1-1/16
8	BLPXZN148	1-1/16
10	BLPXZN1410	1-1/16
12	BLPXZN1412	1-1/16



BLPXZN146



POZIDRIV® BIT SOCKETS (Blue-Point®)

Pozidriv®/Standard, Chrome (Blue-Point®) (1/4")

BLPPD140 1/4" Drive Pozidriv® #0 Standard Socket Driver (Blue-Point®)

- Manufactured from high-grade steel alloy
- Features a lifetime warranty and exceeds ANSI® standards
- All Blue-Point® socket drivers are fully warrantied; no need to replace bits

Size	Stock No.	A	B	C
#0	BLPPD140	1-13/32	15/32	7/16
#1	BLPPD141	1-13/32	15/32	7/16
#2	BLPPD142	1-13/32	15/32	7/16
#3	BLPPD143	1-13/32	15/32	7/16



BLPPD140

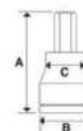

- Do not use chrome or industrial finish hand tools with power drivers or impact drivers.
- Read Safety Precautions on pages W1-W4

FLAT TIP BIT SOCKETS (Blue-Point®)



— Flat Tip/ Standard, Chrome (Blue-Point®) (1/4")

			Stock No.	A	B	C
Short	1/4	—	BLPFS1414	3/4"	—	—
	3/8	—	BLPFS1438	3/4"	—	—
Standard Length	5/32	—	BLPFT14532	1-13/32"	15/32"	7/16"
	7/32	—	BLPFT14732	1-13/32"	15/32"	7/16"
	9/32	—	BLPFT14932	1-13/32"	15/32"	7/16"
	—	4	BLPFT144	1-13/32"	12 mm	11 mm
	—	5.5	BLPFT145.5	1-13/32"	12 mm	11 mm
	—	6.5	BLPFT146.5	1-13/32"	12 mm	11 mm
—	7	BLPFT147	1-13/32"	12 mm	12 mm	

PHILLIPS® TIP BIT SOCKETS



+ PHILLIPS®/Standard, Chrome (Blue-Point®) (1/4")

		Stock No.	A	B	C
Stubby	#1	BLPPS141	3/4"	—	—
	#2	BLPPS142	3/4"	—	—
Standard Length	#0	BLPP140	1-13/32"	15/32"	7/16"
	#1	BLPP141	1-13/32"	15/32"	7/16"
	#2	BLPP142	1-13/32"	15/32"	7/16"
	#0	BLPP143	1-13/32"	15/32"	7/16"

HEX BIT SOCKETS



BLPTHS1414

Hex/Stubby, Tamper-Resistant, SAE, Chrome (Blue-Point®) (1/4")

- All drivers have a hole in the driver tip for tamper proof hex fasteners
- Stubby one-piece impact quality drivers
- Satin chrome plated with bold marking for easy identification
- Heavy-gauge vacuum-formed plastic tray
- All stubby hex drivers are 3/4" long with 1/4" square drive
- S2 alloy steel—the strongest, hardest drivers available
- Heat treated to 58-62 RC
- Limited lifetime warranty

1/4	BLPTHS1414
1/8	BLPTHS1418
3/16	BLPTHS14316
3/32	BLPTHS14332
3/8	BLPTHS1438
5/16	BLPTHS14516
7/32	BLPTHS14732
7/64	BLPTHS14764



BLPTHSM1410

Hex/Stubby, Tamper-Resistant, mm, Chrome (Blue-Point®) (1/4")

- All drivers have a hole in the driver tip for tamper-proof hex fasteners
- Stubby one-piece impact quality drivers
- Satin chrome plated with bold marking for easy identification
- Heavy-gauge vacuum-formed plastic tray
- All stubby hex drivers are 3/4" long with 1/4" square drive
- S2 alloy steel—the strongest, hardest drivers available
- Heat treated to 58-62 RC
- Limited lifetime warranty

	Stock No.
2	BLPTHSM142
2.5	BLPTHSM1425
3	BLPTHSM143
8	BLPTHSM148
10	BLPTHSM1410