

## Double Square, Inches, Chrome

	Stock No.	A	B	C	D	E
1/4	F308	1/2	21/32	3/8	27/32	7/32
5/16	F310	9/16	21/32	3/8	27/32	1/4
3/8	F312	21/32	11/16	15/32	15/16	9/32
7/16	F314	25/32	11/16	17/32	1	5/16
1/2	F316	7/8	25/32	17/32	1	5/16
9/16	F318	1	29/32	19/32	1-1/8	7/16
5/8	F320	1-1/16	31/32	19/32	1-1/8	7/16

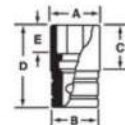

F308



FRXM10

210FRXM

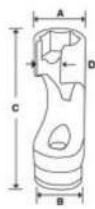

Set Contains:

210FRXM

## Flank Drive® Flare Nut Sockets, mm

	Stock No.	A	B	C	D	
10	FRXM10	16.9	18.3	53.3	7.2	•
11	FRXM11	18.1	18.7	53.3	8.3	•
12	FRXM12	19.3	18.3	53.3	8.8	•
13	FRXM13	20.4	19.1	62.5	9.4	•
14	FRXM14	22.0	20.5	62.5	10.4	•
15	FRXM15	22.6	21.0	71.6	11.2	•
16	FRXM16	23.5	21.9	71.6	11.7	•
17	FRXM17	25.1	23.5	78.0	12.7	•
18	FRXM18	25.9	24.3	83.8	13.5	•
19	FRXM19	26.7	25.1	89.9	14.2	•
21	FRXM21	29.89	29.13	89.92	13.46	•

Set shown includes magnetic storage tray.



207FRX

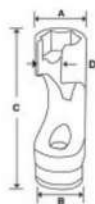

207FRX

## Flank Drive® Flare Nut Sockets, inches

	Stock No.	A	B	C	D	
3/8	FRX121	5/8	3/4	2-3/32	9/32	•
7/16	FRX141	23/32	3/4	2-3/32	11/32	•
1/2	FRX161	13/16	3/4	2-1/8	3/8	•
9/16	FRX181	7/8	13/16	2-15/32	13/32	•
5/8	FRX201	15/16	7/8	2-27/32	15/32	•
11/16	FRX221	1	15/16	3-7/32	1/2	•
3/4	FRX241	1-1/16	1	3-11/32	9/16	•
7/8	FRX281	1-1/4	1-7/32	3-7/32	21/32	•

Set shown includes magnetic storage tray.



PMM406A

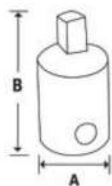

## Pipe Plug, mm, Chrome

	External Stock No.	A	B	Internal Stock No.	A	B
6	PMM406A	16.4	31.0	PMP406A	17.2	25.8
8	PMM408A	17.2	31.0	—	—	—
10	PMM410A	17.2	28.4	PMP410A	18.8	25.4



GF22

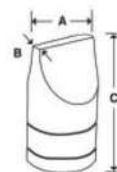

## Drag Link, Industrial

Applications include use on the engine oil fill cap on Kawasaki® UN1500, UN1600 and UN2000 motorcycles.

Stock No.	A	B	C
GF22	11/16 (17)	7/64	1-1/4



FD120

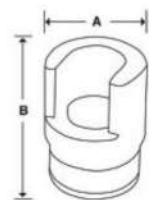

## WEATHERHead® Fittings

	Stock No.	A	B
3/8	FD120	11/16	1-1/4
7/16	FD140	13/16	1-1/4
15/32	FD150	7/8	1-1/4
1/2	FD160	15/16	1-1/4
17/32	FD170	1	1-1/4
9/16	FD180	1-1/16	1-1/4
19/32	FD190	1-1/16	1-1/4
21/32	FD210	1-3/16	1-3/8
11/16	FD220	1-3/16	1-3/8
3/4	FD240	1-1/4	1-3/8
25/32	FD250	1-1/4	1-3/8



• Do not use chrome and industrial finish hand tools with power drivers or impact drivers.  
• Read Safety Precautions on pages W1-W4

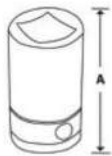

211PPMY

## Pipe Plug, Inches, Chrome

	External Stock No.	A	Internal Stock No.	A
3/16	PPM406A	1-1/8		
1/4	PPM408A	1-1/8	PP408A	1
9/32	PPM409A	1-1/8	PP409A	1
5/16	PPM410A	1-1/8	PP410A	1
11/32	PPM411A	1-1/8	PP411A	1
3/8	PPM412A	1-1/8	PP412A	1

Set shown includes magnetic storage tray.

### 211PPMY 11 pc 3/8" Drive SAE Internal/External Pipe Plug Socket Set

- Includes PPM406A–PPM412A (3/16–3/8") external sockets and PP408A–PP412A (1/4–3/8") internal sockets in a magnetic storage tray
- Manufactured from special alloy steel
- Precision forged and heat treated for optimum strength and durability
- Nickel-chrome plating helps protect against corrosion and makes it easy to wipe clean

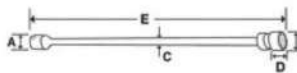

206PFSXM

## Swivel Ball Extension Sockets, mm, Industrial

Set Contains:

	mm	6	12	A	B	C	D	E	6
	8	PFSXM908B	—	19.1	11.4	9.5	6.3	243.4	
	10	PFSXM910B	—	19.1	14.4	9.5	5.6	243.4	•
	11	PFSXM911B	—	19.1	15.6	9.5	6.3	243.8	•
	12	PFSXM912B	—	19.1	16.9	9.5	6.8	244.6	•
	13	PFSXM913B	PFLXM13B	19.1	18.4	12.4	7.6	245.9	•
	14	PFSXM914B	—	19.1	19.8	12.4	9.1	247.9	•
	15	PFSXM915B	—	19.1	20.4	12.4	9.1	247.4	•
	17	PFSXM917B	—	19.2	24.4	13.4	13.2	241.3	

Set includes storage tray

### 206PFSXM 6 pc 3/8" Drive 6-Point Metric Swivel Ball Extension Socket Set

- Includes PFSXM910B–PFSXM915B (10–15 mm)
- Applications include transmission pan bolts on Toyota® and Lexus® vehicles; faster and easier intake removal on Volvo® vehicles; several underdash applications
- Great for difficult access where the use of one tool works better than three (socket, swivel and extension)
- Flank Drive® wrenching configuration where the socket grips the fastener on the flanks/flats increasing torque by 15–20%
- Machined from tough alloy steel

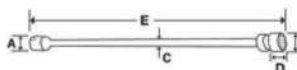

## TORX® Swivel Ball Extension Sockets, Industrial

Set Contains:

Size	Stock No.	A	B	C	D	E
E8	PFSXE908B	3/4	7/16	3/8	1/4	9-1/2
E10	PFSXE910B	3/4	1/2	3/8	1/4	9-1/2
E12	PFSXE912B	3/4	5/8	1/2	3/8	9-1/2
E14	PFSXE914B	3/4	5/8	1/2	3/8	9-5/8

### 204PFSXE8R 4 pc 3/8" Drive External TORX® Power Swivel Extension Socket Foam Set

- Great for difficult access where the use of one tool works better than three (socket, swivel and extension)
- 30° uninterrupted swivel action means greater accessibility in tight quarters, allowing for easier, faster removal of stubborn fasteners, thus saving time
- Laser-welded pivot pin allows smooth, full 30° swivel action for efficient power transfer at any angle with no loss in torque output, prolonging the life of the socket
- Spring-loaded adjustable swivel pre-positions the socket for quick accessibility
- Socket end is manufactured to exact tolerances with a shallow lead-in countersink which ensures a tight fit to regular height and low profile fasteners reducing the chance of slippage or damage
- Manufactured from special alloy steel and heat-treated for optimum strength and durability
- Industrial finish helps protect against corrosion
- Modular foam organizer is designed for maximum tool concentration on the smallest possible footprint and can be reconfigured in the drawer to accommodate new tool sets



204PFSXE8R

## Standard, mm

mm	6	12	Stock No.				Rubber Insert
14 mm	S9714MKL	—	S9714MKL	16.0	19.6	149.2	S9714MK-2
14 mm	S9714MKS	—	S9714MKS	16.0	19.6	66.0	S9714MK-2
18 mm	S9711KA	—	S9711KA	11/16	24.3	66.9	S9706KARI
14 mm	—	S9714MK	S9714MK	16.0	19.6	66.0	S9714MK-2
14 mm	—	S9714MKDEU	S9714MKDEU	16.0	19.6	66.0	S9714MK-2
14 mm	—	S9714MKDL	S9714MKDL	16.0	19.6	149.2	S9714MK-2
16 mm	—	S9716MKDL	S9716MKDL	5/8	20.4	101.6	S9706KARI

ANSI® B107.34M

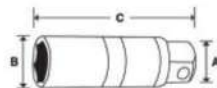

## Ball Joint Swivel

	6	A	C	Rubber Insert
13/16	S9709KB	3/8	3-25/32	S9705A2
5/8	S9710KC	3/8	3-25/32	S9706KARI



## Universal

#	6	12	A	B	C	Rubber Insert
13/16"	S9704KFUA	—	3/8	13/16	3-9/16	S9705A2
5/8"	S9706KFUA	—	3/8	5/8	3-23/32	S9706KARI
9/16"	S9716KFUA	—	3/8	3/4	2-15/16	S9714MK-2
14 mm	S9714MKFUA	—	3/8	25/32	3-1/8	S9714MK-2
14	—	S9714MKDFUA	3/8	25/32	3-1/8 (79.5)	S9714MK-2
5/8	S9706KFUAMAG	—	3/8	27/32	3-3/4	S9706KARI



## TORQUE ADAPTORS



208FRDHM

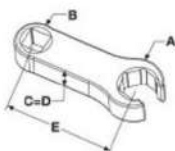

208FRDHM



208FRDH

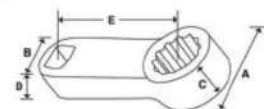

208FRDH

## Standard, mm, Chrome (3/8")

Set Contains:

Working Torque, in-lb	mm	12	A	B	C	D	E	12
212	8	FRDHM8	12.1	19.1	6.2	10.9	50.8	
420	10	FRDHM10	17.1	18.8	7.8	11.0	50.8	•
690	12	FRDHM12	18.8	18.8	8.2	11.0	50.8	•
720	13	FRDHM13	21.0	18.8	7.8	11.0	50.8	•
1,050	14	FRDHM14	21.0	18.8	9.4	11.0	50.8	•
1,200	15	FRDHM15	25.1	18.8	7.8	11.0	50.8	•
1,400	16	FRDHM16	22.6	18.8	11.0	11.0	50.8	•
804	17	FRDHM17	25.1	18.8	12.4	10.9	50.8	
1,400	18	FRDHM18	22.4	18.8	13.3	11.0	50.8	•
1,400	19	FRDHM19	27.4	18.8	13.3	11.0	50.8	•
2,000	21	FRDHM21	30.9	18.8	10.9	10.9	50.8	
2,000	22	FRDHM22	32.7	18.8	11.0	11.0	50.800	

## Standard, Inches, Chrome (3/8")

Set Contains:

Working Torque, in-lb		12	A	B	C	D	E	12
190	5/16	FRDH101	0.475	.750	1/4	7/16	2	•
420	3/8	FRDH121	0.570	.750	5/16	7/16	2	•
500	7/16	FRDH141	0.655	.750	11/32	7/16	2	•
710	1/2	FRDH161	0.740	.750	11/32	7/16	2	•
1,050	9/16	FRDH181	0.825	.750	3/8	7/16	2	•
1,400	5/8	FRDH201	0.890	.750	7/16	7/16	2	•
1,400	11/16	FRDH221	0.989	.750	1/2	7/16	2	•
1,400	3/4	FRDH241	1.080	.750	1/2	7/16	2	•
2,000	7/8	FRDH281	1.28	3/4	7/16	7/16	2.0	
2,706	15/16	FRDH301	1.374	.750	7/16	7/16	2	



• Do not use chrome or industrial finish hand tools with power drivers or impact drivers.  
• Read Safety Precautions on pages W1-W4

## TORQUE ADAPTORS

### Flare Nut, mm, Chrome (3/8")

- Flare nut torque adaptor geometry allows for simplified access and better engagement on line nuts
- Square drive geometry and consistent two inch center-to-center distance allows for reliable torque application with the use of a torque wrench
- Nickel-chrome finish helps protect against corrosion and makes it easy to wipe clean
- Heat treated for optimum strength and durability

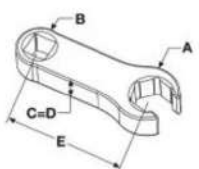

206FRHLM1015



206FRHLM1621

Set Contains:  
206FRHLM1015  
206FRHLM1621

Working Torque, in-lb	mm	Stock No.	A	B	C	D	E		
320	10	FRHLM10	19.736	18.796	9.144	9.144	50.800	•	
400	11	FRHLM11	21.031	18.796	9.144	9.144	50.800	•	
480	12	FRHLM12	22.352	18.796	9.144	9.144	50.800	•	
560	13	FRHLM13	23.673	18.796	9.144	9.144	50.800	•	
640	14	FRHLM14	25.0	18.796	11.430	11.430	50.800	•	
720	15	FRHLM15	26.314	18.796	11.430	11.430	50.800	•	
800	16	FRHLM16	27.610	18.796	11.430	11.430	50.800		•
880	17	FRHLM17	28.931	18.796	12.192	12.192	50.800		•
960	18	FRHLM18	30.251	18.796	12.192	12.192	50.800		•
1,040	19	FRHLM19	31.623	18.796	12.192	12.192	50.800		•
1,120	20	FRHLM20	32.664	18.796	14.478	14.478	50.800		•
1,200	21	FRHLM21	33.706	18.796	14.478	14.478	50.800		•



FTA35

### Torque Adaptor

- FTA35 3/8" Drive Female/Male Torque Adaptor**
- 3.5" center-to-center

## SPLINE TORQUE ADAPTORS

### Spline, Low-Profile, inches

- Precision crafted from special alloy steel and heat treated for optimum strength and durability
- Nickel-chrome finish helps protect against corrosion and makes it easy to wipe clean
- Unique spline wrenching configuration can be used on ordinary 6- and 12-point fasteners
- Ideal for use with torque wrenches
- Will save time and avoid clearance issues when working on propeller assemblies
- Works on a wide variety of Lycoming® and Continental® engines used in Piper®, Cessna® and Mooney® aircraft

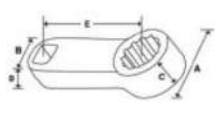

FRESL24

Working Torque, in-lb		Stock No.	A	B	C	D	E
224	7/16	FRESL14	3/4 (19.05)	3/4 (19.05)	3/16 (4.76)	7/16 (11.11)	2 (50.8)
312	1/2	FRESL16	25/32 (19.84)	3/4 (19.05)	3/16 (4.76)	7/16 (11.11)	2 (50.8)
360	9/16	FRESL18	13/16 (20.64)	3/4 (19.05)	3/16 (4.76)	7/16 (11.11)	2 (50.8)
480	5/8	FRESL20	29/32 (22.8)	47/64 (18.8)	3/16 (4.7)	7/16 (10.9)	2 (50.8)
556	11/16	FRESL22	1 (25.1)	47/64 (18.8)	3/16 (4.7)	7/16 (10.9)	2 (50.8)
465	3/4	FRESL24	1-5/64 (50.2)	3/4 (19.05)	7/16 (11.11)	3/16 (4.76)	2 (50.8)
605	7/8	FRESL28	1-1/4 (31.75)	3/4 (19.05)	7/16 (11.11)	3/16 (4.76)	2 (50.8)
888	15/16	FRESL30	1-5/16 (33.9)	47/64 (18.8)	3/16 (4.7)	7/16 (10.9)	2 (50.8)

### Spline, Inches, Chrome (3/8")

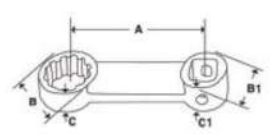

FRES10

Working Torque, in-lb		Stock No.	A	B-B1	C-C1
140	7/32	FRES7	2	.375-.750	1/4-7/16
195	1/4	FRES8	2	.400-.750	1/4-7/16
220	9/32	FRES9	2	.445-.750	1/4-7/16
250	5/16	FRES10	2	.490-.750	1/4-7/16
515	3/8	FRES12	2	.590-.750	5/16-7/16
875	7/16	FRES14	2	.680-.750	5/16-7/16
1,575	1/2	FRES16	2	.745-.750	5/16-7/16
1,750	9/16	FRES18	2	.825-.750	3/8-7/16
1,750	5/8	FRES20	2	.895-.750	3/8-7/16
1,750	11/16	FRES22	2	.997-.750	1/2-7/16
1,750	3/4	FRES24	2	1.08-.750	9/16-7/16

**TORX®/Standard, Industrial (3/8")**

Set Contains:

**207EFTXY**

#	Chrome Stock No.	Industrial Stock No.	A	B	C	D	
T27	FTX27E	GFTX27E	1-3/4	45/64	11/16	FTX27E2	•
T30	FTX30E	GFTX30E	1-3/4	45/64	11/16	FTX30E2	•
T40	FTX40E	GFTX40E	1-3/4	45/64	11/16	FTX40E2	•
T45	FTX45E	GFTX45E	2-1/16	1	11/16	FTX45E2	•
T47	FTX47E	—	2-1/16	1	11/16	FTX47E2	•
T50	FTX50E	GFTX50E	2-1/16	1	11/16	FTX50E2	•
T55	FTX55E	GFTX55E	2-1/16	1	45/64	FTX55E2	•
T60	FTX60E	—	2-7/32	1-17/64	15/16	FTX60E2	

 Set includes storage tray  
 \*T47 is not a TORX® licensed product.

**207EFTXY**

**212EFTXY**
**207EFTXY 7 pc 3/8" Drive TORX® Bit Standard Socket Set**

- Includes (7) sockets (FTX27E–FTX55E TORX® sockets) plus FTX47E GM® Style Driver (T27–T55 plus GM® style T47) in a storage tray

**212EFTXY 12 pc Combination Drive TORX® Bit Standard Socket Set**

- Includes (5) 1/4" drive TORX® drivers (TTX8E–TTX25E), plus (6) 3/8" drive TORX® drivers (FTX27E–FTX55E) and (1) 3/8" drive FTX47E GM®-style driver (T47) in a magnetic storage tray
- High-grade steel for strength and reliability
- Nickel-chrome plating helps protect against corrosion and makes it easy to wipe clean
- Use of a standard TORX® bit socket on a TORX Plus® fastener may result in a rounded out fastener head or damaged bit socket

**TORX®/Long, Chrome (3/8")**

#	Stock No.	A	B	C	D
T27	FTXL27E	4-1/4	3-13/64	11/16	FTXL27E2
T30	FTXL30E	4-1/4	3-13/64	11/16	FTXL30E2
T40	FTXL40E	4-1/4	3-13/64	11/16	FTXL40E2
T45	FTXL45E	4-1/4	3-13/64	11/16	FTXL45E2
T50	FTXL50E	4-1/4	3-13/64	11/16	FTXL50E2

**FTXL27E**
**210EFTXL 10 pc Combination Drive TORX® Bit Long Socket Set**

- Includes 1/4" drive TTXL8E–TTXL25E (T8–T25) and 3/8" drive FTXL27E–FTXL50E (T27–T50) in a storage tray
- Nickel-chrome plating helps protect against corrosion and makes it easy to wipe clean
- Manufactured from special alloy steel and treated for optimum strength and durability
- Use of a standard TORX® bit socket on a TORX Plus® fastener may result in a rounded out fastener head or damaged bit socket

**TORX®/Tamper-Resistant, Chrome (3/8")**

#	Stock No.	A	B	C	D
T27	FTXR27E	1-49/64	45/64	11/16	FTXR27E2
T30	FTXR30E	1-49/64	45/64	11/16	FTXR30E2
T40	FTXR40E	1-49/64	45/64	11/16	FTXR40E2
T45	FTXR45E	2-1/16	1	11/16	FTXR45E2
T50	FTXR50E	2-1/16	1	11/16	FTXR50E2

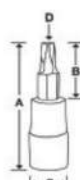
**FTXR27E**
**210EFTXRY 10 pc Combination Drive TORX® Bit Tamper-Resistant Socket Set**

- Includes 1/4" drive TTXR8E–TTXR25E (TR8–TR25) and 3/8" drive FTXR27E–FTXR50E (TR27–TR50) in a magnetic storage tray
- Two piece pinless design holds bit securely in socket while facilitating quick bit replacement
- Cold-formed socket delivers a strong, durable tool
- Nickel-chrome alloy finish resists against rust and corrosion



**210EFTXRY**

- Do not use chrome or industrial finish hand tools with power drivers or impact drivers.
- Read Safety Precautions on pages W1–W4

# TORX® BIT SOCKETS

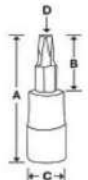

207EFTXYSE



FTXB27E



## ★ TORX®/Stubby, Chrome (3/8")

Set Contains: 207EFTXYSE

#	Stock No.	A	B	C	D	
T27	FTX27SE	1-13/32	11/32	11/16	FTX27SE2	•
T30	FTX30SE	1-13/32	11/32	11/16	FTX30SE2	•
T40	FTX40SE	1-13/32	11/32	11/16	FTX40SE2	•
T45	FTX45SE	1-13/32	11/32	11/16	FTX45SE2	•
T47	FTX47SE*	1-13/32	11/32	11/16	FTX47SE2	•
T50	FTX50SE	1-13/32	11/32	11/16	FTX50SE2	•
T55	FTX55SE	1-29/64	25/64	45/64	FTX55SE2	•

Set shown includes magnetic storage tray.  
\*T47 is not a TORX® licensed product.

## ★ TORX®/Heavy-Duty Removal, Chrome (3/8")

#	Stock No.	A	B	C	D
T27	FTXB27E	1-49/64	45/64	11/16	FTXB27E2
T30	FTXB30E	1-49/64	45/64	11/16	FTXB30E2
T40	FTXB40E	1-49/64	45/64	11/16	FTXB40E2
T45	FTXB45E	2-1/16	1	11/16	FTXB45E2
T50	FTXB50E	2-1/16	1	11/16	FTXB50E2
T55	FTXB55E	2-1/32	31/32	45/64	FTXB55E2

### 209EFTXBY 9 pc Combination Drive TORX® Bit Heavy-Duty Removal Socket Set

- Includes 1/4" drive TTXB15E–TTXB25E (T15–T25) and 3/8" drive FTXB27E–FTXB50E (T27–T55) in a magnetic storage tray
- Tapered profile provides better engagement on stubborn fasteners
- Nickel-chrome plating helps protect against corrosion and makes it easy to wipe clean
- Manufactured from special alloy steel and treated for optimum strength and durability
- Use of a standard TORX® bit socket on a TORX Plus® fastener may result in a rounded out fastener head or damaged bit socket



211EFTXRTPY



## ★ TORX Plus®/Tamper-Resistant, Chrome (3/8")

#	Stock No.	A	B	C	D
T27	FTXR27TPE	1-49/64	45/64	11/16	FTXR27TPE2
T30	FTXR30TPE	1-49/64	45/64	11/16	FTXR30TPE2
T40	FTXR40TPE	1-49/64	45/64	11/16	FTXR40TPE2
T45	FTXR45TPE	2-1/32	31/32	11/16	FTXR45TPE2
T50	FTXR50TPE	2-9/64	1-5/64	45/64	FTXR50TPE2
T55	FTXR55TPE	2-11/32	1-9/32	15/16	FTXR55TPE2

### FTXR40TPE 3/8" Drive TORX Plus® 40IPR Tamper-Resistant Bit Socket Driver

- Quickly removes and replaces the reverse idler shaft on 2001/2002 Ford® Mustang® GT® vehicles using the TREMEC3650 manual transmission
- Also use on the camshaft bolts on 2008 Toyota® Tundra® with the 5.7 L engine
- Five-lobe configuration
- 2 pc pinless design holds bit securely in socket while facilitating quick bit replacement
- Cold-formed socket delivers a strong, durable tool
- Chrome plating resists corrosion and clean easily
- For sale to authorized technicians only

### 211EFTXRTPY 11 pc Combination Drive Tamper-Resistant TORX Plus® Socket Driver Set

- Includes 1/4" drive (8IPR–55IPR) and 3/8" Drive (27IPR–55IPR)
- Applications: 2003 Ford® Mustang® transmissions, 2004 Ford® F-150® transfer case, 2004 Porsche® Cayenne® turbo air sensor, Delphi® and Stanadyne® pumps, Cummins® B and C engine injection pumps and John Deere® diesel injector pumps
- Includes magnetic storage tray

**Combination Bit Socket Sets**
**237HEXTORXST 37 pc Combination Drive Socket Driver Set**

- Up to 20% stronger than 1 pc bit designs and up to twice ANSI® proof load
- Heat-treated for strength and durability
- Precise fit to fasteners and multiple detents for secure drive attachment
- Includes:

- (5) 1/4" Drive Standard TORX® Bit Sockets
- (7) 3/8" Drive Standard TORX® Bit Sockets
- (7) 3/8" Drive Stubby TORX® Bit Sockets
- (3) 3/8" Drive Triple Square Drivers
- (7) 3/8" Drive Metric Hex Bit Sockets
- (4) 1/4" Drive Stubby Metric Hex Bit Sockets
- (4) 3/8" Drive Stubby Metric Hex Bit Sockets

**237HEXTORXST**

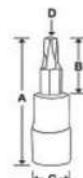
**GFTX500E**

**TORX®/Special Application, Chrome (3/8")**

#	Stock No.	Description	A	B	C	D
T40	<b>FTXEL40E</b>	3/8" Drive TORX® T40 Extra-Long Bit Socket Driver	7-1/2	6-7/16	11/16	<b>FTXEL40E2</b>
T45	<b>FTXEL45E</b>	3/8" Drive TORX® T45 Extra-Long Bit Socket Driver	7-11/16	6-5/8	11/16	<b>FTXEL45E2</b>
T40	<b>FTXR40TPE</b>	3/8" Drive TORX Plus® 40IPR Tamper-Resistant Bit Socket Driver	1-49/64	45/64	11/16	<b>FTXR40TPE2</b>
T30	<b>FTXEL30TPE</b>	3/8" Drive TORX Plus® T30 Extra-Long Bit Socket Driver	5	3-15/16	11/16	<b>FTXEL30TPE2</b>

**FTXEL30TPE 3/8" Drive TORX Plus® T30 Extra-Long Bit Socket Driver**

- For removing the engine harness from the firewall on 2007 and newer
- For Volvo® trucks with D16, MPT 8 and MPT 10 engines, Cummins® ISX fuel timing and metering actuators

**FTXEL40E 3/8" Drive TORX® T40 Extra-Long Bit Socket Driver**

- Applications include service on intake manifold bolts on Ford® 5.0 L engines with fuel injection, model years 1985–1990

**FTXEL45E 3/8" Drive TORX® T45 Extra-Long Bit Socket Driver**

- Quickly and easily access intake bolts on Cummins® N14 diesel engines without removing the air pump
- Can also be used on older Cummins® NH Big Cam 4 diesel engines
- 3/8" square drive
- Various applications on European vehicles

**GFTX500E 3/8" Drive T47 GM®-Style Bit Socket Driver**

- For use on GM® door strikers and seat belt bolts

**TORX Plus®/Chrome (3/8")**

#	Stock No.	A	B	C	D
T27	<b>FTX27TPE</b>	1-49/64	45/64	11/16	<b>FTX27TPE2</b>
T30	<b>FTX30TPE</b>	1-49/64	45/64	11/16	<b>FTX30TPE2</b>
T40	<b>FTX40TPE</b>	1-49/64	45/64	11/16	<b>FTX40TPE2</b>
T45	<b>FTX45TPE</b>	2-9/64	1-5/64	11/16	<b>FTX45TPE2</b>
T50	<b>FTX50TPE</b>	2-9/64	1-5/64	45/64	<b>FTX50TPE2</b>
T55	<b>FTX55TPE</b>	2-27/64	1-23/64	15/16	<b>FTX55TPE2</b>

**FTX27TPE**

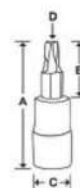
**211EFTXTPY**

**211EFTXTPY 11 pc Combination Drive TORX Plus® Bit Socket Driver Set**

- Includes 1/4" drive (8IP–25IP) and 3/8" drive (27IP–55IP) in a magnetic storage tray
- TORX Plus® fasteners may be found in most vehicles from 1999–present

- Common applications include GM® transmission bell housing bolts, Ford® seat belt anchors, and Ford® Taurus® and Sable® front spring shields
- Use of a standard TORX® driver on TORX Plus® fasteners may result in a rounded-out fastener head or damaged driver



- Do not use chrome or industrial finish hand tools with power drivers or impact drivers.
- Read Safety Precautions on pages W1–W4

# METRIC HEX BIT SOCKETS



211EFAMY

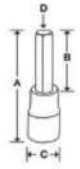

Hex/Standard, mm,  
Chrome (3/8")

Set  
Contains:  
211EFAMY  
207EFAMY

mm	Hex	A	B	C	D	Hex	Hex
2	FAM2E	51.1	24.1	17.2	FAM2E2		
2.5	FAM2.5E	51.1	24.1	17.2	FAM2.5E2		
3	FAM3E	51.1	24.1	17.2	FAM3E2		
4	FAM4E	52.3	25.4	17.2	FAM4E2	•	•
5	FAM5E	52.3	25.4	17.2	FAM5E2	•	•
6	FAM6E	52.6	25.4	17.2	FAM6E2	•	•
7	FAM7E	52.6	25.7	17.2	FAM7E2	•	•
8	FAM8E	52.3	25.4	17.2	FAM8E2	•	•
9	FAM9E	52.6	25.7	17.2	FAM9E2	•	•
10	FAM10E	52.6	25.7	17.2	FAM10E2	•	•
11	FAM11E	66.2	39.2	17.2	FAM11E2	•	•
12	FAM12E	66.7	39.8	20.2	FAM12E2	•	•
13	FAM13E	67.7	40.8	20.2	FAM13E2	•	•
14	FAM14E	67.7	40.8	24	FAM14E2	•	•

Sets shown include magnetic storage tray

## 210EFTAMY 10 pc Combination Drive Metric Standard Hex Bit Socket Set

- Includes 1/4" drive TMAM2E–TMAM3E (2–3 mm) and 3/8" drive FAM4E–FAM10E (4–10 mm) in a magnetic storage tray



FAMXS10E

208EFTAMXSY



Hex/Stubby, mm, Chrome (3/8")

mm	Hex	A	B	C	D
7	FAMXS7E	34.8	7.9	17.2	FAMXS7E2
8	FAMXS8E	35.8	8.9	17.2	FAMXS8E2
9	FAMXS9E	36.8	9.9	17.2	FAMXS9E2
10	FAMXS10E	37.8	10.9	17.2	FAMXS10E2

## 208EFTAMXSY 8 pc Combination Drive Metric Hex Bit Stubby Socket Driver Set

- Includes 1/4" drive TMAMXS3E–TMAMXS6E (3–6 mm) and 3/8" drive FAMXS7E–FAMXS10E (7–10 mm) in a magnetic storage tray
- Short bit length for use in limited-access spaces
- Sockets are manufactured from special alloy steel that provides long life and great strength
- Nickel-chrome plating helps protect against corrosion and makes it easy to wipe socket clean



206EFAML

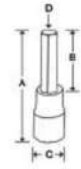

Hex/Long, mm, Chrome (3/8")

Set  
Contains:  
206EFAML

mm	Hex	A	B	C	D	Hex
4	FAML4E	153.9	127.0	17.2	FAML4E2	•
5	FAML5E	153.9	127.0	17.2	FAML5E2	•
6	FAML6E	154.2	127.3	17.2	FAML6E2	•
7	FAML7E	154.2	127.3	17.2	FAML7E2	•
8	FAML8E	153.9	127.0	17.2	FAML8E2	•
10	FAML10E	153.9	127.0	17.2	FAML10E2	•



FABM10E

208EFTABMY

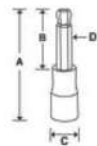

Ball Hex/Standard, mm, Chrome (3/8")

mm	Ball Hex	A	B	C	D
7	FABM7E	52.6	25.7	17.2	FABM7E2
8	FABM8E	52.6	25.7	17.2	FABM8E2
9	FABM9E	52.6	25.7	17.2	FABM9E2
10	FABM10E	52.6	25.7	17.2	FABM10E2

## 208EFTABMY 8 pc Combination Drive Metric Ball Hex Bit Socket Set

- Includes 1/4" drive TMABM3E–TMABM6E (3–6 mm), 3/8" drive FABM7E–FABM10E (7–10 mm) in a magnetic storage tray
- Ball end of bit makes it easier to insert bit into fastener, especially in blind-access applications
- Sockets are manufactured from special alloy steel that provides long life and great strength
- Nickel-chrome plating helps protect against corrosion and makes it easy to wipe socket clean





206EFABL M

Set Contains: 206EFABL M

## Ball Hex/Long, mm, Chrome (3/8")

mm	Icon	A	B	C	Icon	
4	FABLM4E	128.5	101.6	17.2	FABLM4E2	•
5	FABLM5E	128.5	101.6	17.2	FABLM5E2	•
6	FABLM6E	128.5	101.6	17.2	FABLM6E2	•
7	FABLM7E	128.5	101.6	17.2	FABLM7E2	•
8	FABLM8E	128.5	101.6	17.2	FABLM8E2	•
10	FABLM10E	128.5	101.6	17.2	FABLM10E2	•

Set includes storage tray

### 206EFABL M 6 pc 3/8" Drive Metric Long Ball Hex Bit Socket Set

- Includes FABLM4E–FABLM10E (4–10 mm) in a plastic storage tray
- Extra-long bit length provides increased reach in limited-access spaces
- Ball-end of bit makes it easier to insert bit into fastener, especially in blind access application
- Sockets are manufactured from special alloy steel that provides long life and great strength
- Nickel-chrome plating helps protect against corrosion and makes it easy to wipe socket clean



FADM8E



## Double Hex/Standard, mm, Chrome (3/8")

- Double Hex Socket Drivers and Triple Square Socket Drivers cannot be interchanged between applications
- Triple square hex sockets have 90° corners and double hex bit sockets have 120° corners
- Using a Triple Square tool in a Double Hex application will strip the bolt head
- In general, Triple Square tools are used on European vehicles and Double Hex tools are used on Asian vehicles

mm	Icon	A	B	C	Icon
8	FADM8E	74.6	24.3	17.2	FADM8E2
8	FADM8LE	121.9	95	18	FADM8LE2

# HEX BIT SOCKETS



GFA10E



208EFAY



Set Contains: 208EFAY

## Hex/Standard, inches (3/8")

Icon	Hex	Hex	A	B	C	D	Fits These Cap Screws	Fits These Set Screws	Hex	Hex
1/8	FA4E	GFA4E	2-1/16	1	11/16	TMA4E2	—	1/4"	•	•
9/64	FA4.5E	GFA4.5E	2-1/16	9/64	11/16	TMA4.5E2	#8	—	•	•
5/32	FA5E	GFA5E	2-1/16	1	11/16	FA5E2	#10	5/16"	•	•
3/16	FA6E	GFA6E	2-1/16	1	11/16	FA6E2	1/4"	3/8"	•	•
7/32	FA7E	GFA7E	2-1/16	1-1/64	11/16	FA7E2	—	7/16"	•	•
1/4	FA8E	GFA8E	2-1/16	1-1/64	11/16	FA8E2	5/16"	1/2"	•	•
5/16	FA10E	GFA10E	2-1/16	1	11/16	FA10E2	3/8"	5/8"	•	•
3/8	FA12E	GFA12E	2-3/32	1-1/32	11/16	SA12E2	7/16" and 1/2"	3/4"	•	•

Sockets include storage tray

### 212EFTAY 12 pc Combination Drive SAE Standard Hex Driver Bit Socket Set

- Includes 1/4" drive TMA2E–TMA3E (1/16–3/32") and 3/8" drive FA4E–FA12E (1/8–3/8") in a magnetic storage tray
- Indispensable sockets for a wide variety of applications in automotive (foreign and domestic), aviation and industrial settings
- Sockets are manufactured from special alloy steel that provides long life and great strength
- Nickel-chrome plating helps protect against corrosion and makes it easy to wipe socket clean

### 208EFTAXSY 8 pc Combination Drive SAE Hex Bit Stubby Socket Driver Set

- Includes 1/4" drive TMAXS4E–TMAXS6E (1/8–3/16") and 3/8" drive FAXS8E–FAXS12E (1/4–3/8") in a magnetic storage tray
- Short bit length for use in limited-access spaces
- Sockets are manufactured from special alloy steel that provides long life and great strength
- Nickel-chrome plating helps protect against corrosion and makes it easy to wipe socket clean



FAXS10E



208EFTAXSY



## Hex/Stubby, Inches, Chrome (3/8")

Icon	Hex	A	B	C	D
7/32	FAXS7E	1-5/16	1/4	11/16	FAXS7E2
1/4	FAXS8E	1-11/32	9/32	11/16	FAXS8E2
5/16	FAXS10E	1-13/32	11/32	11/16	FAXS10E2
3/8	FAXS12E	1-15/32	13/32	11/16	FAXS12E2



- Do not use chrome or industrial finish hand tools with power drivers or impact drivers.
- Read Safety Precautions on pages W1–W4

# HEX BIT SOCKETS

3/8" DRIVE TOOLS



206EFAL

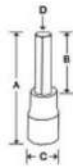

## Hex/Long, Inches, Chrome (3/8")

Set Contains:

Hex Size	Part No.	A	B	C	Vehicle Icon	Fits These Cap Screws	Fits These Set Screws	Hex Icon
5/32	FA5LE	6-1/16	5	11/16		#10	5/16"	•
3/16	FA6LE	6-9/64	5-5/64	11/16		1/4"	3/8"	•
7/32	FA7LE	6-9/64	5-5/64	11/16		—	7/16"	•
1/4	FA8LE	6-9/64	5-5/64	11/16		5/16"	1/2"	•
5/16	FA10LE	6-1/16	5	11/16		3/8"	5/8"	•
3/8	FA12LE	6-3/32	5-1/32	11/16		1/4"	3/4"	•

Set includes storage tray



206EFABL

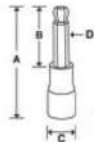

## Ball Hex/Long, Inches, Chrome (3/8")

Set Contains:

Hex Size	Part No.	A	B	C	Vehicle Icon	Ball Hex Icon
5/32	FABL5E	5-1/16	4	11/16		•
3/16	FABL6E	5-1/64	3-61/64	11/16		•
7/32	FABL7E	5-1/16	1-1/16	11/16		•
1/4	FABL8E	5-1/16	1-1/16	11/16		•
5/16	FABL10E	5-1/16	1-1/16	11/16		•
3/8	FABL12E	5-1/16	1-1/16	11/16		•

Set includes storage tray



FAB10E



208EFTABY

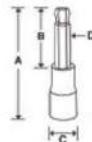

## Ball Hex/Standard, Inches, Chrome (3/8")

Hex Size	Part No.	A	B	C	Vehicle Icon
7/32	FAB7E	2-1/16	1-1/64	11/16	
1/4	FAB8E	2-1/16	1-1/64	11/16	
5/16	FAB10E	2-3/32	1-1/32	11/16	
3/8	FAB12E	2-3/32	1-1/32	11/16	

### 208EFTABY 8 pc Combination Drive SAE Standard Ball Hex Bit Socket Set

- Includes 1/4" drive TMAB4E–TMAB6E (1/8–3/16") and 3/8" drive FAB7E–FAB12E (7/32–3/8"), in a magnetic storage tray
- Ball end of bit makes it easier to insert bit into fastener, especially in blind access applications
- Sockets are manufactured from special alloy steel that provides long life and great strength
- Nickel-chrome plating helps protect against corrosion and makes it easy to wipe sockets clean

# TRIPLE SQUARE BIT SOCKETS



FTSM8LE



## ● Triple Square/Standard, mm, Chrome (3/8")

- Double hex sockets and triple square sockets cannot be interchanged between applications
- Using a triple square tool in a double hex application will strip the bolt head
- In general, triple square tools are used on European vehicles and double hex tools are used on Asian vehicles

Type	mm	Stock No.	A	B	C	Vehicle Icon
Standard Length	4	FTSM4E	48.6	21.6	17.2	
	5	FTSM5E	48.6	21.6	17.2	
	6	FTSM6E	48.6	21.6	17.2	
	8	FTSM8E	58.1	31.2	17.2	
	10	FTSM10E	68.1	41.2	17.2	
Long	8	FTSM8LE	101.6	74.7	17.2	
	10	FTSM10LE	101.6	74.7	17.2	

Set includes storage tray

### TSS7KIT 7 pc Combination Drive Metric Standard Triple Square Socket Driver Set

- Includes 3/8" drive FTSM6E–FTSM10E (6–10 mm) and STSM12E–STSM18E (12–18 mm) in a storage tray
- Manufactured from special alloy steel, precision forged and heat-treated for optimum strength and durability
- Nickel-chrome alloy finish resists against rust and corrosion

### FTSM6E 3/8" Drive Metric 6 mm Standard Triple Square Bit Socket

- Use to remove seat hold-down nuts on 1999 and later GM® full-size pickup trucks; also for use on VW® disc brake calipers

### FTSM8E 3/8" Drive Metric 8 mm Standard Triple Square Bit Socket

- Remove and install head and accessory bolts on Mercedes-Benz® and axle shaft bolts on VW® and Audi® vehicles

### FTSM10E 3/8" Drive Metric 10 mm Standard Triple Square Bit Socket

- Used for cylinder head bolts and drive shaft bolts on Mercedes-Benz® and remove and install axle shaft bolts on VW® and Audi® vehicles

## Mortorq®/Standard, Industrial (3/8")

#	Stock No.	A	B	C	D
MTS-0	PFMTS0E	1-49/64	45/64	11/16	PFMTS0E2
MTS-1	PFMTS1E	1-49/64	45/64	11/16	PFMTS1E2
MTS-2	PFMTS2E	1-15/16	7/8	11/16	PFMTS2E2
MTS-3	PFMTS3E	2-7/64	1-1/32	11/16	PFMTS3E2
MTS-4	PFMTS4E	2-7/65	1-1/33	11/16	PFMTS4E2



PFMTS2E



PFMTS4E



### PFMTS4E 3/8" Drive Mortorq® MTS-4 Pinless Bit Socket Driver

- Use to remove/install the bolts that secure the bell housing to the transmission on GM® 4L60 transmissions
- Manufactured from special alloy steel and heat treated for optimum strength
- Snap-on® bits are designed with precise fit and tight tolerance to prevent slippage and disengagement
- Industrial, black-oxide, finish helps protect against corrosion

### PFMTS1E 3/8" Drive Mortorq® MTS-1 Pinless Bit Socket Driver

- Applications: For seat tracks on 2009 Mazda® 6
- Other seat applications: Cadillac® CTS®, Nissan® Maxima® and Altima®

## Ribe® Bit Sockets

Size	Stock No.	A	B	C	D
R5	F5RBE	0.679	1	2.07	F5RBE2
R6	F6RBE	0.679	1	2.07	F6RBE2
R8	F8RBE	0.679	1	2.07	F8RBE2
R10	F10RBE	0.706	1	2.07	F10RBE2



F10RBE

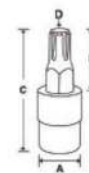

## FLAT TIP BIT SOCKETS

### — Flat Tip (3/8")

	Stock No.	Industrial Stock No.	A	B	C	D	
Standard Length	1/4 x 1/32	F23E	—	3	1-15/16	11/16	F23E2A
	5/16 x 3/64	F25E	GF25E	3	1-15/16	11/16	F25E2A
	3/8 x 1/16	F31E	GF31E	3-7/16	2-3/8	11/16	F31E2A
Short	1/4 x 1/32	F42E	—	1-53/64	49/64	11/16	F42E2
	5/16 x 1/16	F52E	—	1-13/16	3/4	11/16	F52E2
	3/8 x 1/16	F62E	GF62E	1-7/8	13/16	11/16	F62E2



F23E



F42E



GF25E

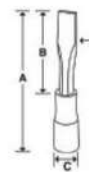

## PHILLIPS® TIP BIT SOCKETS

### + PHILLIPS® (3/8")

	Stock No.	Industrial Stock No.	A	B	C	D	
Standard Length	#2	FP22E	GFP22E	2-1/16	1	11/16	FP22E2
	#3	FP32E	—	2-21/64	1-1/4	11/16	FP32E2
	#4	FP41E	—	1-11/16	5/8	11/16	FP41E2
Short	#3	FPS32E	—	1-29/32	27/32	11/16	SP32E2
Long	#2	FP24E	—	4-3/64	3	11/16	FP24E2
	#3	FP34E	—	4-3/64	3	11/16	FP34E2
	#4	FP42E	—	2-9/16	1-1/2	11/16	FP42E2



FP22E



GFP22E



FPS32E



FP34E

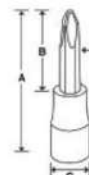

## POZIDRIV® AND CLUTCH BIT SOCKETS

### ✦ Pozidriv®/Standard, Chrome (3/8")



FPD32E



#	Stock No.	A	B	C	D
#2	FPD22E	2-1/16	1	15/32	FPD22E2
#3	FPD32E	2	15/16	15/32	FPD32E2

### ✦ Clutch/Standard, Chrome (3/8")



F29E



	Stock No.	A	B
3/8	F29E	3/8	1-3/4
5/16	F30E	19/64	1-3/4



- Do not use chrome or industrial finish hand tools with power drivers or impact drivers.
- Read Safety Precautions on pages W1-W4

# IMPACT DRIVERS AND SETS

3/8" DRIVE TOOLS



PIT2230E



234EPIT

## Impact Drivers (3/8")

Set Contains:

PIT2230E  
234EPIT

Stock No.	Description		
PIT120	3/8" Drive Impact Driver	•	•
F42E	3/8" Drive 1/4" Flat Tip Short Bit Socket Driver	•	
F42E2	1/4" Short Flat Tip Driver Bit	•	
F52E	3/8" Drive 5/16" Flat Tip Short Bit Socket Driver	•	
F52E2	5/16" Short Flat Tip Driver Bit	•	
F62E	3/8" Drive 3/8" Flat Tip Short Bit Socket Driver	•	
F62E2	3/8" Short Flat Tip Driver Bit	•	•
FA6E	3/8" Drive SAE 3/16" Standard Hex Bit Socket Driver	•	
FA6E2	3/16" Standard Hex Driver Bit	•	
FA7E	3/8" Drive SAE 7/32" Standard Hex Bit Socket Driver	•	
FA7E2	7/32" Standard Hex Driver Bit	•	
FA8E	3/8" Drive SAE 1/4" Standard Hex Bit Socket Driver	•	•
FA8E2	1/4" Standard Hex Driver Bit	•	•
FA10E	3/8" Drive SAE 5/16" Standard Hex Bit Socket Driver	•	•
FA10E2	5/16" Standard Hex Driver Bit	•	
FA12E	3/8" Drive SAE 3/8" Standard Hex Bit Socket Driver	•	•
FA12E2	3/8" Standard Hex Driver Bit	•	•
FAM7E	3/8" Drive Metric 7 mm Standard Hex Bit Socket Driver	•	
FAM8E	3/8" Drive Metric 8 mm Standard Hex Bit Socket Driver	•	
FAM8E2	8 mm Standard Hex Driver Bit	•	
FAM9E	3/8" Drive Metric 9 mm Standard Hex Bit Socket Driver	•	
FAM10E	3/8" Drive Metric 10 mm Standard Hex Bit Socket Driver	•	
FAM10E2	10 mm Standard Hex Driver Bit	•	
FTXB30E	3/8" Drive TORX® T30 Heavy-Duty Removal Bit Socket Driver	•	•
FTXB40E	3/8" Drive TORX® T40 Heavy-Duty Removal Bit Socket Driver	•	•
FTXB45E	3/8" Drive TORX® T45 Heavy-Duty Removal Bit Socket Driver	•	•
FTXB50E	3/8" Drive TORX® T50 Heavy-Duty Removal Bit Socket Driver	•	•
FTXB55E	3/8" Drive TORX® T55 Heavy-Duty Removal Bit Socket Driver	•	•
FTXB55E2	T55 TORX® Heavy-Duty Removal Driver Bit		
FTXB30E2	T30 TORX® Heavy-Duty Removal Driver Bit		•
FTXB40E2	T40 TORX® Heavy-Duty Removal Driver Bit		•
FTXB50E2	T50 TORX® Heavy-Duty Removal Driver Bit		•
FP22E	3/8" Drive #2 PHILLIPS® Standard Bit Socket Driver	•	•
FP22E2	#2 PHILLIPS® Standard Driver Bit	•	•

Sets include storage case

### PIT2230E 36 pc 3/8" Drive Impact Driver Set

- Includes PIT120 Impact Driver plus all sockets, screwdrivers and replacement bits conveniently displayed in a storage tray that fits in the KRA142 metal box

### 234EPIT 34 pc 3/8" Drive Impact Driver Set

- Delivers cam action impact when struck with a hammer for loosening or tightening fasteners
- Snap-on® impact sockets are heat treated to optimize impact service life with a lower hardness than hand sockets and are able to withstand repeated cycling loads of impact wrenches

[Snapon.com](http://Snapon.com) 1.877.762.7664

Stock No.	Description		
FP32E	3/8" Drive #3 PHILLIPS® Standard Bit Socket Driver	•	•
FP32E2	#3 PHILLIPS® Standard Driver Bit	•	•
FPS32E	3/8" Drive #3 PHILLIPS® Short Socket Driver		•
FP41E	3/8" Drive #4 PHILLIPS® Standard Bit Socket Driver	•	
FP41E2	#4 PHILLIPS® Standard Driver Bit	•	•
FP42E	3/8" Drive #4 PHILLIPS® Socket Driver	•	
FP42E2	#4 PHILLIPS® Long Driver Bit	•	
F29E	3/8" Drive SAE 3/8" Clutch Bit Socket Driver	•	
F30E	3/8" Drive SAE 5/16" Clutch Socket Driver	•	
FPD22E	3/8" Drive #2 Pozidriv® Tip Bit Socket Driver	•	
IMF120A	3/8" Drive 6-Point SAE 3/8" Flank Drive® Shallow Impact Socket	•	
IMF140A	3/8" Drive 6-Point SAE 7/16" Flank Drive® Shallow Impact Socket	•	
IMF160	3/8" Drive 6-Point SAE 1/2" Flank Drive® Shallow Impact Socket	•	
IMF180	3/8" Drive 6-Point SAE 9/16" Flank Drive® Shallow Impact Socket	•	
IMF200	3/8" Drive 6-Point SAE 5/8" Flank Drive® Shallow Impact Socket	•	
IMF220	3/8" Drive 6-Point SAE 11/16" Flank Drive® Shallow Impact Socket	•	
IMF240	3/8" Drive 6-Point SAE 3/4" Flank Drive® Shallow Impact Socket	•	
IMFA16	3/8" Drive SAE 1/2" Impact Rated Hex Driver		
IMFA18	3/8" Drive SAE 9/16" Impact Rated Hex Driver		
IMFAM12	3/8" Drive Metric 12 mm Impact Rated Hex Driver		
IMFAM14	3/8" Drive Metric 14 mm Impact Rated Hex Driver		
IMFM12	3/8" Drive 6-Point Metric 12 mm Flank Drive® Shallow Impact Socket		•
IMFM13	3/8" Drive 6-Point Metric 13 mm Flank Drive® Shallow Impact Socket		•
IMFM14	3/8" Drive 6-Point Metric 14 mm Flank Drive® Shallow Impact Socket		•
IMFM15	3/8" Drive 6-Point Metric 15 mm Flank Drive® Shallow Impact Socket		•
IMFM17	3/8" Drive 6-Point Metric 17 mm Flank Drive® Shallow Impact Socket		•
IMFM18	3/8" Drive 6-Point Metric 18 mm Flank Drive® Shallow Impact Socket		•
IMFM10A	3/8" Drive 6-Point Metric 10 mm Flank Drive® Shallow Impact Socket		•
GF22	3/8" Drive 11/16" Blade Width Drag Link Socket	•	
KRA142B	Metal Storage Case		
SAM10E2	10 mm Standard Hex Driver Bit		•
SP32E2	#3 PHILLIPS® Short Driver Bit		•
PAKPB070	Plastic Storage Box for 234EPIT		•

- Flank Drive® wrenching system delivers up to 20% more turning power without slipping or rounding while exceeding ANSI® performance standards
- Snap-on uses a proprietary blend of special alloy socket steel that provides long life and great strength
- Bit sockets bits are made from a high-grade steel for strength and reliability
- Includes PIT120 impact driver plus all sockets, screwdrivers and replacement bits (34 pc) in a storage case
- Bit sockets bits are made from a high-grade steel for strength and reliability

## Impact Drivers (3/8")

Set Contains:

208EPIT

Stock No.	Description	
PIT120	3/8" Drive Impact Driver	•
F42E	3/8" Drive 1/4" Flat Tip Short Bit Socket Driver	•
F52E	3/8" Drive 5/16" Flat Tip Short Bit Socket Driver	•
F62E	3/8" Drive 3/8" Flat Tip Short Bit Socket Driver	•
FP22E	3/8" Drive #2 PHILLIPS® Standard Bit Socket Driver	•
FP32E	3/8" Drive #3 PHILLIPS® Standard Bit Socket Driver	•
FP42E	3/8" Drive #4 PHILLIPS® Long Socket Driver	•
FPD22E	3/8" Drive #2 Pozidriv® Tip Bit Socket Driver	•

Sets include storage case



PIT120

208EPIT

### PIT120 3/8" Drive Impact Driver

- Delivers cam action impact when struck with a hammer for loosening or tightening fasteners
- Industrial finish

## IMPACT ACCESSORIES



204IMXA



IMXL111

## Extensions/Impact

Set Contains:

204IMXA

Stock No.	A	B	
IMX11	1/2	1-3/4	•
IMX31	1/2	3	•
IMX61	1/2	6	•
IMX111	1/2	11	•

Set includes storage tray

### Locking Extensions

- Quick-release locking sleeve provides a secure connection plus easy socket removal
- Knurled release collar for easy one-hand operation, even with slippery hands

Stock No.	A	B
IMXL31	1/2	3
IMXL61	1/2	6
IMXL111	1/2	12



202IPFX

### Swivel Extensions

- Laser-welded pivot pin allows smooth, full 30° swivel action for efficient power transfer
- Manufactured from special alloy steel and heat treated for optimum strength and durability
- Provides versatility for the technician to use any size shallow, semi-deep, deep, 6-point, 12-point, metric or SAE impact socket

Set Contains:

202IPFX

Stock No.	A	B	
IPFX6	9/16	6	•
IPFX9	9/16	9	•

Set shown includes magnetic storage tray.

## Universal Joints (Impact)

Stock No.	A	B	Retention Type
IPF80B	1	2-1/8	Pin Type
IPF800B	1	2-1/8	Ball Type



IPF80B



IPF800B



**WARNING**



- Wear safety goggles while using impact drivers.
- Do not hold swivel joint during use.
- Read Safety Precautions on pages W1-W4

# FLANK DRIVE® IMPACT SOCKETS

3/8" DRIVE TOOLS



IMDFM14



214IMFMYA

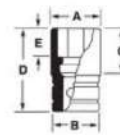

Shallow, mm

Set Contains: 214IMFMYA 207IMDFMYA

mm	6	12	A	B	C	D	E	6	12
6	IMFM6	IMDFM6	10.3	17.5	11.1	23.0	5.6		
7	IMFM7	IMDFM7	11.9	17.5	11.1	23.0	5.6		
8	IMFM8A	IMDFM8A	13.5	17.5	14.2	26.2	6.4	•	
9	IMFM9A	IMDFM9	15.1	17.5	14.2	26.2	6.4	•	
10	IMFM10A	IMDFM10A	16.7	17.5	14.2	26.2	6.4	•	•
11	IMFM11A	IMDFM11A	17.5	17.5	14.5	27.0	6.4	•	
12	IMFM12	IMDFM12	18.3	18.3	14.9	27.0	6.4	•	•
13	IMFM13	IMDFM13	19.8	19.8	15.1	27.8	7.1	•	•
14	IMFM14	IMDFM14	20.6	20.6	14.9	27.8	8.7	•	•
15	IMFM15	IMDFM15	21.4	21.4	15.2	27.8	8.7	•	•
16	IMFM16	IMDFM16	23.0	23.0	15.6	28.6	10.3	•	
17	IMFM17	IMDFM17	24.6	24.6	16.0	29.4	9.5	•	•
18	IMFM18	IMDFM18	25.4	25.4	16.5	30.2	10.3	•	•
19	IMFM19	IMDFM19	27.0	27.0	17.0	31.0	11.1	•	
20	IMFM20	IMDFM20	28.6	28.6	17.5	31.8	11.9		
21	IMFM21	IMDFM21	29.4	29.4	17.9	31.8	11.9	•	
22	IMFM22	IMDFM22	30.2	30.2	18.9	32.5	12.7		
23	IMFM23	—	31.8	31.8	19.7	33.3	12.7		
24	IMFM24	—	33.3	33.3	20.3	34.9	14.3	•	

Set includes magnetic storage tray  
ASME®/ANSI® B107.5



IMF120A



212IMFYA

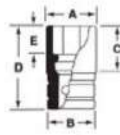

Shallow, inches

Set Contains: 212IMFYA 207IMDFY

11	6	12	A	B	C	D	E	6	12
1/4	IMF080	—	7/16	11/16	13/32	29/32	7/32		
5/16	IMF100A	—	17/32	11/16	17/32	1-1/32	1/4	•	
3/8	IMF120A	IMDF120A	5/8	11/16	17/32	1-1/32	1/4	•	•
7/16	IMF140A	IMDF140A	11/16	11/16	9/16	1-1/16	1/4	•	•
1/2	IMF160	IMDF160	3/4	3/4	19/32	1-3/32	9/32	•	•
9/16	IMF180	IMDF180	13/16	13/16	9/16	1-3/32	5/16	•	•
5/8	IMF200	IMDF200	29/32	29/32	19/32	1-1/8	11/32	•	•
11/16	IMF220	IMDF220	31/32	31/32	19/32	1-5/32	3/8	•	•
3/4	IMF240	IMDF240	1-1/16	1-1/16	21/32	1-7/32	13/32	•	•
13/16	IMF260	—	1-1/8	1-1/8	11/16	1-1/4	15/32	•	
7/8	IMF280	—	1-3/16	1-3/16	23/32	1-9/32	15/32	•	
15/16	IMF300	—	1-9/32	1-9/32	3/4	1-5/16	17/32	•	
1	IMF320	—	1-11/32	1-11/32	3/4	1-5/16	17/32	•	

Sets shown include magnetic storage tray  
ASME®/ANSI® B107.1



IMFMS12



212IMFMSYA

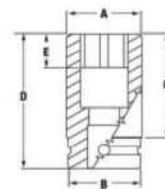

212IMFMSYA  
Set Contains:

## Semi-Deep, mm

mm	6	A	B	C	D	E	6
6	IMFMS6	10.3	17.5	28.6	41.3	5.6	
7	IMFMS7	11.9	17.5	28.6	41.3	6.4	
8	IMFMS8A	12.8	17.2	29.3	41.3	6.4	•
9	IMFMS9A	14.0	17.2	29.3	41.3	7.1	•
10	IMFMS10A	15.1	17.2	29.3	41.3	9.7	•
11	IMFMS11A	17.2	17.2	29.3	41.3	9.7	•
12	IMFMS12	18.0	18.0	29.3	41.3	9.7	•
13	IMFMS13	19.6	19.6	29.3	41.3	10.4	•
14	IMFMS14	20.4	20.4	29.3	41.3	10.4	•
15	IMFMS15	21.2	21.2	29.3	41.3	10.4	•
16	IMFMS16	22.7	22.7	29.3	41.3	10.4	•
17	IMFMS17	24.3	24.3	29.3	41.3	11.2	•
18	IMFMS18	25.1	25.1	29.3	41.3	11.2	•
19	IMFMS19	26.7	26.7	29.3	41.3	11.7	•
20	IMFMS20	28.6	28.6	22.2	41.3	11.9	
21	IMFMS21	29.2	25.1	29.3	65.7	12.4	

Sets shown include magnetic storage tray  
ASME®/ANSI® B107.33m



IMFS16



210IMFSYA

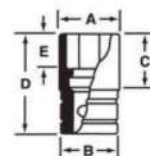

210IMFSYA  
Set Contains:

## Semi-Deep, inches

	6	A	B	C	D	E	6
1/4	IMFS8	13/32	13/32	1-1/4	1-5/8	7/32	
5/16	IMFS10A	1/2	1/2	1-5/32	1-5/8	1/4	•
3/8	IMFS12A	9/16	9/16	1-5/32	1-5/8	9/32	•
7/16	IMFS14A	21/32	21/32	1-5/32	1-5/8	11/32	•
1/2	IMFS16	3/4	3/4	1-5/32	1-5/8	13/32	•
9/16	IMFS18	13/16	13/16	1-5/32	1-5/8	13/32	•
5/8	IMFS20	29/32	29/32	1-5/32	1-5/8	13/32	•
11/16	IMFS22	31/32	31/32	1-5/32	1-5/8	7/16	•
3/4	IMFS24	1-1/16	1-1/16	1-5/32	1-5/8	15/32	•
13/16	IMFS26	1-1/8	1-1/8	1-5/32	1-5/8	1/2	•
7/8	IMFS28	1-3/16	1-3/16	1-5/32	1-5/8	17/32	•
15/16	IMFS30	1-9/32	1-9/32	1	1-3/4	9/16	
1	IMFS32	1-5/16	1-5/16	1	1-3/4	5/8	

Sets shown include magnetic storage tray  
ASME®/ANSI® B107.2



• Read Safety Precautions on pages W1-W4

# FLANK DRIVE® IMPACT SOCKETS

3/8" DRIVE TOOLS



SIMDFM14



214SIMDFMYA

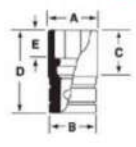

214SIMFMYA  
Set Contains:

214SIMDFMYA

Deep, mm

mm	6	12	A	B	C	D	E	6	12
6	SIMFM6	SIMDFM6	11.1	17.5	42.0	54.0	5.6		
7	SIMFM7	SIMDFM7	11.9	17.5	42.0	54.0	6.4		
8	SIMFM8A	SIMDFM8A	13.5	17.5	42.0	54.0	6.4	•	•
9	SIMFM9A	SIMDFM9A	14.3	17.5	42.0	54.0	6.4	•	•
10	SIMFM10A	SIMDFM10A	15.9	17.5	42.0	54.0	6.4	•	•
11	SIMFM11A	SIMDFM11A	16.7	17.5	42.0	54.0	7.9	•	•
12	SIMFM12	SIMDFM12	18.3	18.3	42.0	54.0	9.5	•	•
13	SIMFM13	SIMDFM13	19.8	19.8	42.0	54.0	10.3	•	•
14	SIMFM14	SIMDFM14	20.6	20.6	42.6	60.3	10.3	•	•
15	SIMFM15	SIMDFM15	21.4	21.4	42.6	60.3	10.3	•	•
16	SIMFM16	SIMDFM16	23.0	23.0	42.6	60.3	10.3	•	•
17	SIMFM17	SIMDFM17	24.6	24.6	48.8	66.7	11.1	•	•
18	SIMFM18	SIMDFM18	25.4	25.4	48.7	66.7	11.1	•	•
19	SIMFM19	SIMDFM19	27.0	27.0	48.5	66.7	13.5	•	•
20	SIMFM20	SIMDFM20	28.6	28.6	48.1	66.7	11.9		
21	SIMFM21	SIMDFM21	29.4	29.4	48.1	66.7	11.9	•	•
22	SIMFM22	—	30.2	30.2	54.2	73.0	12.7		
23	SIMFM23	—	31.8	31.8	54.2	73.0	12.7		
24	SIMFM24	SIMDFM24	33.3	33.3	54.2	73.0	14.3	•	•

Set includes magnetic storage tray  
ASME®/ANSI® B107.33M



SIMF260



212SIMFYA



212SIMFYA  
Set Contains:

Deep, inches

II	6	12	A	B	C	D	E	6
1/4	SIMF080	—	7/16	11/16	1-5/8	2-1/8	7/32	
5/16	SIMF100A	—	17/32	11/16	1-5/8	2-1/8	1/4	•
3/8	SIMF120A	SIMDF120A	5/8	11/16	1-5/8	2-1/8	1/4	•
7/16	SIMF140A	SIMDF140A	21/32	11/16	1-5/8	2-1/8	5/16	•
1/2	SIMF160	SIMDF160	3/4	3/4	1-5/8	2-1/8	3/8	•
9/16	SIMF180	SIMDF180	13/16	13/16	1-21/32	2-3/8	13/32	•
5/8	SIMF200	SIMDF200	29/32	29/32	1-21/32	2-3/8	15/32	•
11/16	SIMF220	SIMDF220	31/32	31/32	1-29/32	2-5/8	1/2	•
3/4	SIMF240	SIMDF240	1-1/16	1-1/16	1-29/32	2-5/8	17/32	•
13/16	SIMF260	—	1-1/8	1-1/8	2-1/4	2-3/4	17/32	•
7/8	SIMF280	—	1-3/16	1-3/16	2-1/4	2-3/4	9/16	•
15/16	SIMF300	—	1-9/32	1-9/32	2-1/4	2-3/4	9/16	•
1	SIMF320	—	1-11/32	1-11/32	2-1/4	2-3/4	5/8	•

Set includes magnetic storage tray  
ASME®/ANSI® B107.2



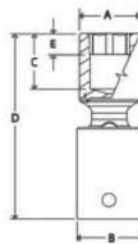

## Shallow, mm

mm	Set Contains:							212IPFM			207IPFM			207IPDFM		
	6	12	A	B	C	D	E	6	6	12	6	6	12	6	6	12
8	IPFM8C	—	12.8	26.0	10.4	51.6	6.4	•								
9	IPFM9C	—	14.1	26.0	10.9	52.6	6.4									
10	IPFM10C	IPDFM10A	15.5	26.0	11.4	53.6	7.1	•	•	•						
11	IPFM11C	—	16.6	26.0	11.9	54.9	7.1	•								
12	IPFM12C	IPDFM12A	17.1	26.0	12.5	55.9	7.1	•	•	•						
13	IPFM13C	IPDFM13A	19.7	26.0	12.5	56.9	7.9	•	•	•						
14	IPFM14C	IPDFM14A	20.5	26.0	13.0	58.2	7.9	•	•	•						
15	IPFM15C	IPDFM15A	21.3	26.0	13.5	59.2	7.9	•	•	•						
16	IPFM16C	IPDFM16A	23.0	26.0	14.2	60.2	8.6	•	•	•						
17	IPFM17C	—	24.4	26.0	16.8	62.3	8.6	•	•							
17	—	IPDFM17A	24.4	26.0	17.8	62.3	8.6									•
18	IPFM18C	—	25.3	26.0	16.5	62.3	9.7	•	•							
18	—	IPDFM18A	25.3	26.0	18.5	62.3	9.7									•
19	IPFM19C	—	26.5	26.0	19.1	64.3	10.4	•								
21	IPFM21C	—	29.2	26.0	19.6	66.0	12.4	•								
22	IPFM22C	—	30.0	26.0	21.6	67.9	13.0									

Sets include storage tray

## Shallow, inches

mm	Set Contains:							205IPF		
	6	12	A	B	C	D	E	6	6	12
3/8	IPF12C	IPDF12A	9/16	1-1/32	13/32	2-3/32	1/4			
7/16	IPF14C	IPDF14	21/32	1-1/32	15/32	2-5/32	1/4	•		
1/2	IPF16C	IPDF16	3/4	1-1/32	1/2	2-1/4	9/32	•		
9/16	IPF18C	IPDF18	13/16	1-1/32	1/2	2-9/32	9/32	•		
5/8	IPF20C	IPDF20	29/32	1-1/32	5/8	2-3/8	5/16	•		
11/16	IPF22C	IPDF22	31/32	1-1/32	11/16	2-15/32	13/32	•		
3/4	IPF24C	IPDF24	1-1/16	1-1/32	23/32	2-17/32	7/16	•		

Set includes storage tray

## Semi-Deep, mm

mm	Set Contains:							207IPFSM		
	6	A	B	C	D	E	6	6	12	
8	IPFSM8A	17.1	26.0	20.8	65.3	6.4				
10	IPFSM10A	17.1	26.0	22.4	66.8	9.7	•			
11	IPFSM11A	16.6	26.0	25.9	68.3	9.7				
12	IPFSM12A	17.1	26.0	26.2	69.8	9.7	•			
13	IPFSM13A	19.7	26.0	26.4	70.9	10.4	•			
14	IPFSM14A	20.5	26.0	27.4	71.9	10.4	•			
15	IPFSM15A	21.3	26.0	30.0	73.4	10.4	•			
16	IPFSM16A	23.0	26.0	29.0	73.4	10.4	•			
17	IPFSM17A	24.4	26.0	30.0	74.9	11.2	•			
18	IPFSM18A	25.3	26.0	30.0	76.5	11.2	•			
19	IPFSM19A	26.5	26.0	31.8	78.0	14.2				
21	IPFSM21A	29.2	26.0	31.8	78.0	12.4				

Set shown includes magnetic storage tray.  
ASME®/ANSI® B107.5m

## Low-Profile, mm

mm	Set Contains:						207RIPFM		
	Stock No.	A	B	C	D	E	6	6	12
8	RIPFM8C	12.8	25.9	4.7	43.6	3.7			
10	RIPFM10C	15.5	25.9	5.2	47.4	4.4	•		
11	RIPFM11C	16.6	25.9	6.0	45.8	5.0			
12	RIPFM12C	17.1	25.9	6.1	48.9	5.3	•		
13	RIPFM13C	19.7	25.9	6.6	50.1	5.8	•		
14	RIPFM14C	20.5	25.9	7.0	50.8	6.2	•		
15	RIPFM15C	21.3	26.8	7.5	52.4	6.7	•		
16	RIPFM16C	23	26.8	8.1	50.5	7.1			
17	RIPFM17C	24.4	26.8	8.6	53.9	7.6	•		
18	RIPFM18C	25.3	26.8	9.0	54.5	8.0	•		
19	RIPFM19C	26.5	26.8	9.5	52.7	8.5			
20	RIPFM20C	26.8	26.8	9.3	52.1	8.3			
21	RIPFM21C	29.2	26.8	9.0	52.7	8.0			

## Low-Profile, inches

mm	Set Contains:						205RIPF		
	Stock No.	A	B	C	D	E	6	6	12
3/8	RIPF12C	9/16	1-1/32	7/32	1-25/32	3/16			
7/16	RIPF14C	21/32	1-1/32	3/16	1-7/8	5/32	•		
1/2	RIPF16C	3/4	1-1/32	1/4	1-31/32	3/16	•		
9/16	RIPF18C	13/16	1-1/32	9/32	2-1/32	1/4	•		
5/8	RIPF20C	29/32	1-1/16	5/16	2-1/16	9/32	•		
11/16	RIPF22C	31/32	1-1/16	3/8	2-1/16	5/16	•		
3/4	RIPF24C	1 1/16	1-1/16	3/8	2-3/16	5/16	•		



• Do not hold swivel joint during use.  
• Read Safety Precautions on pages W1-W4



# FLANK DRIVE® IMPACT SWIVEL SOCKETS



Deep, mm

207IPLFM  
Set Contains:

mm	6	A	B	C	D	E	6
8	IPLFM8B	17.1	26.0	30.5	73.4	9.1	
10	IPLFM10B	17.1	26.0	30.5	73.4	9.1	•
11	IPLFM11B	16.6	26.0	30.7	73.7	9.7	
12	IPLFM12B	17.1	26.0	30.7	73.7	9.7	•
13	IPLFM13A	19.7	26.0	38.4	82.8	10.4	•
14	IPLFM14A	20.5	26.0	40.4	84.3	10.4	•
15	IPLFM15A	21.3	26.0	41.2	85.8	10.4	•
16	IPLFM16A	23.0	26.0	40.6	86.1	10.4	
17	IPLFM17A	24.4	26.0	40.9	86.9	10.2	•
18	IPLFM18A	25.3	26.0	42.2	88.6	10.7	•
19	IPLFM19A	26.5	26.0	43.7	90.2	14.2	
21	IPLFM21A	29.2	26.0	45.2	92.2	12.4	

Set includes storage tray



Deep, inches

205IPLF  
Set Contains:

II	6	A	B	C	D	E	6
3/8	IPLF12B	21/32	1-1/32	1-3/16	2-29/32	1/4	•
7/16	IPLF14B	21/32	1-1/32	1-7/32	2-29/32	1/4	•
1/2	IPLF16B	3/4	1-1/32	1-5/32	2-29/32	9/32	•
9/16	IPLF18B	13/16	1-1/32	1-17/32	3-9/32	9/32	•
5/8	IPLF20B	29/32	1-1/32	1-9/16	3-3/8	5/16	•

Set includes storage tray



## Universal Joints (Impact)

### 202IP 2 pc Combination Drive Impact Universal Joint Set

- Includes IPF800B 3/8" Drive Friction Ball Swivel Ball Impact Universal Joint and IP80D 1/2" Drive Swivel Ball Lock Button Impact Universal Joint in a storage tray

## SPECIAL APPLICATION SOCKETS



WNS1

### Wing Nut Sockets

#### WNS1 3/8" Drive Wing Nut Socket

- Works on any wing nut up to 3/8"
- Two differently sized slots fit multiple wing nut sizes
- 7/8" external hex allows access to wing nuts on a long stud
- Counterbore in the bottom is sized so that when engaging the fastener the socket does not touch the material the wing nut is holding down, preventing scratching and damage when the wing nut is spun off



207IMFLE

### Shallow TORX® Impact

- Various applications on heavy duty trucks with Mercedes-Benz® engines
- Use E18 size for F-550® brake rotor.
- Use E20 size for rear brake caliper bolts on BMW® X5.



207IMFLE  
Set Contains:

#	Stock No.	A	B	C	
E8	IMFLE80A	15/32	11/16	1-5/32	•
E10	IMFLE100A	1/2	11/16	1-5/32	•
E12	IMFLE120A	19/32	11/16	1-5/32	•
E14	IMFLE140A	5/8	11/16	1-5/32	•
E16	IMFLE160A	3/4	3/4	1-1/4	•
E18	IMFLE180A	25/32	25/32	1-5/16	•
E20	IMSLE200	15/16	15/16	1-1/2	•

Set shown includes magnetic storage tray

## Mortorq® Super Socket

- Manufactured from special alloy steel and heat treated for optimum strength and durability
- Industrial finish helps protect against corrosion

Size	Stock No.	A	B	C	D	E
MTS-X10	<b>IMTSX100</b>	29/64	11/16	1-1/8	1-5/8	15/64
MTS-X12	<b>IMTSX120</b>	9/16	11/16	1-1/8	1-5/8	17/64
MTS-X14	<b>IMTSX140</b>	11/16	11/16	1-1/8	1-1/2	5/16
MTS-X8	<b>IMTSX80</b>	25/64	11/16	1-1/8	1-5/8	11/64

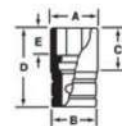

**IMTSX100**

## Twist, Shallow, inches/mm (Blue-Point®)

- Twist sockets remove rounded/damaged fasteners
- Shallow design allows better access in confined working areas
- Made in USA

Set Contains: 209TFSMYA 213TFSYA

			A	B	C		
3/8		<b>TFSY121A</b>	11/16 (17.5)	9/16 (14.3)	1-1/4 (31.8)		•
7/16		<b>TFSY141A</b>	11/16 (17.5)	21/32 (16.7)	1-1/4 (31.8)	•	•
1/2		<b>TFSY161A</b>	3/4 (19.1)	3/4 (19.1)	1-1/4 (31.8)		•
9/16		<b>TFSY181A</b>	13/16 (20.6)	13/16 (20.6)	1-1/4 (31.8)		•
5/8		<b>TFSY201A</b>	29/32 (23.0)	29/32 (23.0)	1-1/4 (31.8)	•	•
31/32		<b>TFSY221A</b>	31/32 (24.6)	31/32 (24.6)	1-3/8 (35.0)		•
3/4		<b>TFSY241A</b>	1-1/16 (27.0)	1-1/16 (27.0)	1-3/8 (35.0)	•	•
10		<b>TFSY10A</b>	11/16 (17.5)	19/32 (15.1)	1-1/4 (31.8)	•	•
12		<b>TFSY12A</b>	11/16 (17.5)	11/16 (17.5)	1-1/4 (31.8)	•	•
13		<b>TFSY13A</b>	3/4 (19.1)	3/4 (19.1)	1-1/4 (31.8)	•	•
14		<b>TFSY14A</b>	13/16 (20.6)	13/16 (20.6)	1-1/4 (31.8)	•	•
15		<b>TFSY15A</b>	13/16 (20.6)	27/32 (21.4)	1-1/4 (31.8)	•	•
17		<b>TFSY17A</b>	31/32 (24.6)	31/32 (24.6)	1-3/8 (35.0)	•	•

Sets include storage tray



**209TFSMYA**

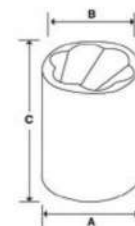

**209TFSMYA**

## Twist, Deep, inches/mm (Blue-Point®)

Set Contains: 213TFSYA

			A	B	C	
3/8		<b>TSFSY121A</b>	11/16 (17.5)	9/16 (14.3)	2-1/8 (54)	•
7/16		<b>TSFSY141A</b>	11/16 (17.5)	21/32 (16.7)	2-1/8 (54.0)	•
1/2		<b>TSFSY161A</b>	3/4 (19.1)	3/4 (19.1)	2-1/8 (54.0)	•
9/16		<b>TSFSY181A</b>	13/16 (20.6)	13/16 (20.6)	2-3/8 (60.3)	•
5/8		<b>TSFSY201A</b>	29/32 (23.0)	29/32 (23.0)	2-3/8 (60.3)	•
11/16		<b>TSFSY221A</b>	31/32 (24.6)	31/32 (24.6)	2-5/8 (66.7)	•
3/4		<b>TSFSY241A</b>	1-1/16 (27.0)	1-1/16 (27.0)	2-5/8 (66.7)	•
10		<b>TSFSY10A</b>	11/16 (17.5)	19/32 (15.1)	2-1/8 (54.0)	•
12		<b>TSFSY12A</b>	11/16 (17.5)	11/16 (17.5)	2-1/8 (54.0)	•
13		<b>TSFSY13A</b>	3/4 (19.1)	3/4 (19.1)	2-1/8 (54.0)	•
14		<b>TSFSY14A</b>	13/16 (20.6)	13/16 (20.6)	2-3/8 (60.3)	•
15		<b>TSFSY15A</b>	13/16 (20.6)	27/32 (21.4)	2-3/8 (60.3)	•
17		<b>TSFSY17A</b>	31/32 (24.6)	31/32 (24.6)	2-5/8 (66.7)	•

Set includes storage tray



**213TFSYA**

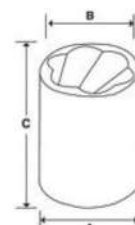

**213TFSYA**

## Shallow, 10 pt

		A	B	D	E
12	<b>DPFM12</b>	18.3	18.3	26.9	7.1

### DPFM12 3/8" Drive 10-Point Metric 12 mm Shallow Impact Socket

- The DPFM12 is for clutch pressure plate bolts found on the flywheel assembly on Mitsubishi® Eclipse® and Dodge® Stratus® vehicles
- Formed from tough alloy steel
- Heat-treated to a lower hardness to add impact resistance and ductility



**DPFM12**

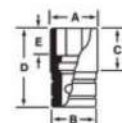

- Do not hold swivel joint during use.
- Read Safety Precautions on pages W1-W4