



1/2" DRIVE TOOLS

Dual 80® Technology, Chrome (1/2")

Stop, Turn and Listen. A smoother, stronger ratchet. Try them to believe them.

Dual 80® Technology Ratchets Feature:

- 80-tooth gear
- Seven teeth in contact with gear to provide strength and durability
- Up to 25% less ratcheting arc to engage the next gear tooth
- Sealed head keeps dirt and other contaminants out of the head mechanism

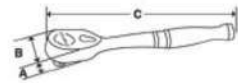

Set Contains:

303RT01FR[†]
303RT02FR[†]

Stock No.	Description	Gear Teeth	Swing Arc, °	A	B	C		
S80A	Standard Handle Ratchet	80	4.5	3/4	1-5/8	10-5/16	•	
GS80A	Standard Handle Industrial Ratchet	80	4.5	3/4	1-5/8	10-5/16		
SH80A††	Red Soft-Grip Ratchet	80	4.5	3/4	1-5/8	12		
SL80A	Long Handle	80	4.5	3/4	1-5/8	15	•	
GSL80A†	Standard Long Handle Industrial Ratchet	80	4.5	3/4	1-5/8	15		
SHL80A††	Red Soft-Grip Long-Handle Ratchet	80	4.5	3/4	1-5/8	16-3/4		
SLL80A	Extra-Long Handle	80	4.5	3/4	1-5/8	23-3/16	•	
SHLL80A	Red Soft-Grip Extra-Long-Handle Ratchet	80	4.5	3/4	1-5/8	24-7/8		
SKF80A*†	Stubby Handle Flex-Head Ratchet	80	4.5	3/4	1-5/8	7-1/2		•
SF80A	Standard Handle Flex-Head	80	4.5	3/4	1-5/8	17-11/18		•
SHF80A††	Soft-Grip Standard Flex-Head Ratchet	80	4.5	3/4	1-5/8	17-5/8		
SLF80A	Long Handle, Flex-Head	80	4.5	3/4	1-5/8	24-13/16		•
SHLF80A††	Soft-Grip Long Handle Flex-Head	80	4.5	3/4	1-5/8	25-5/8		
SBF80A	Bent Handle Flex-Head	80	4.5	3/4	1-5/8	16-1/2		
SX80B	Standard Handle Locking Flex-Head Ratchet	80	4.5	3/4	1-5/8	17-5/8		
SHX80B**††	Red Soft-Grip Locking Flex-Head Ratchet	80	4.5	3/4	1-5/8	18-1/2		
SLX80A	Long Handle, Locking Flex-Head	80	4.5	3/4	1-5/8	24-13/16		
SHLX80A**††	Red Soft-Grip Locking Flex-Head Ratchet	80	4.5	3/4	1-5/8	25-3/4		

[†]Sets shown include foam organizer

^{††}Uses RKRSX936JT Flex Joint Repair Kit

^{**}Uses RKRSX80AJT Flex Joint Repair Kit and RKRSX80ALM Locking Mechanism Repair Kit

[†]ASME®/ANSI® B107.10 with exception of the length ASME®/ANSI® B107.10

Colors Available



†† O G

ADD SUFFIX TO STOCK NUMBER FOR SPECIAL COLORS.



- Do not immerse sealed ratchet in fluids.
- Do not replace worn parts individually; use entire contents of the service kit.
- Read Safety Precautions on pages W1-W4

RATCHETS



Quick-Release Ratchet (1/2")

Stock No.	Description (Chart)	Gear Teeth	Swing Arc	SW	SW	SW
SR80A	Standard Handle, Quick-Release	80	4.5	3/4	1-5/8	10-5/16
SHR80A	Soft-Grip Quick-Release	80	4.5	3/4	1-5/8	12
SRL80A*	Long Handle, Quick-Release	80	4.5	3/4	1-5/8	15
SHRLF80A**	Soft Grip Long Handle Quick-Release Flex Head	80	4.5	3/4	1-5/8	25-5/8
SHRX80B**	Standard Soft Grip Handle, Quick-Release Locking Flex-Head	80	4.5	3/4	1-5/8	18-1/2
SRX80B**	Standard Handle, Quick-Release Locking Flex-Head	80	4.5	3/4	1-5/8	17-5/8

ASME®/ANSI® B107.10
 *Uses RKRSX80AJT Flex Joint Repair Kit and RKRSY80ALM Locking Mechanism Repair Kit
 **Uses RKRSX936JT Flex Joint Repair Kit and 1936-12 Soft Grip Replacement Handle

Colors Available



† ADD SUFFIX TO STOCK NUMBER FOR SPECIAL COLORS.

FOD Ratchets (Foreign Object Damage) (1/2")

- Dual pawls and an 80 tooth gear provide more power in less lateral space
- Seven teeth in contact with gear to provide strength and durability
- Up to 25% less ratcheting arc to engage the next gear tooth
- Sealed head helps keep dirt and other contaminants out of the head mechanism
- Meets FOD and FME program conformance
- Designed to have the lowest profile and work with the shortest swing arc, providing better access to restricted areas
- FOD ratchets are designed to help prevent foreign object damage in sensitive work environments
- Cover plate and reverse lever are permanently affixed to ratchet head with rivets to prevent possible sources of debris



Stock No.	Description	Gear Teeth	Swing Arc	SW	SW	SW
S80AFOD	Foreign Object Damage Standard Handle	80	4.5	3/4	1-5/8	10-5/16
GS80AFOD	Foreign Object Damage Industrial Handle	80	4.5	3/4	1-5/8	10-5/16
GSL80AFOD	Foreign Object Damage Industrial Long Handle	80	4.5	3/4	1-5/8	15

ASME®/ANSI® B107.10



Scaffold/Spud Ratchets (1/2")

Stock No.	Description	Gear Teeth	Swing Arc	SW	SW	SW
GSP936	Spud Ratchet	36	10	3/4	1-5/8	15-5/8
SA936A	Scaffold Ratchet	36	10	4-3/16	1-5/8	10-5/16

ASME®/ANSI® B107.10

GSP936 1/2" Drive Spud Ratchet

- The "spud" ratchet is ideal for lining up holes in scaffolding and other construction jobs
- A long reverse lever provides easy reversing while wearing heavy work gloves
- Locking button retention
- Taper diameter is 3/16-7/8"
- Taper length is 8"

Ratchet Adaptor, Chrome (1/2")

Stock No.	Description	Gear Teeth	Swing Arc	EW	EP	ES
S77A	Ratchet Adaptor	20	18	1-5/8	3	3

ASME®/ANSI® B107.10

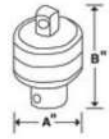
S77A

Ratchet Spinner (1/2")

Stock No.	Description	EW	ES
LRS70A	1/2" Drive Ratchet Spinner	1-3/4	1-5/8

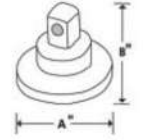
ASME®/ANSI® B107.10

LRS70A

BREAKER BARS

Breaker Bars (1/2")

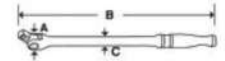
Stock No.	Description	EW	EP	ES
SN15B	1/2" Drive 15" Standard Handle Breaker Bar	1-1/8	15	11/16
SN18B	1/2" Drive 18" Standard Handle Breaker Bar	1-1/8	18	11/16
GSN18B	1/2" Drive 18" Standard Handle Industrial Finish Breaker Bar	1-1/8	18	11/16
SN24C	1/2" Drive 24" Standard Handle Breaker Bar	1-1/8	24	11/16
SHBB24*	1/2" Drive 24" Soft Grip Handle Breaker Bar	1-1/8	24	11/16
SN25A	1/2" Drive 24" 45° Offset Square Breaker Bar	1-1/8	24	11/16
SN36	1/2" Drive 36" Standard Handle Breaker Bar	1-1/4	36	3/4
SHN36*	1/2" Drive 36" Soft Grip Handle Breaker Bar	1-1/4	36-5/8	3/4

Colors Available

* ADD SUFFIX TO STOCK NUMBER FOR SPECIAL COLORS.

ASME®/ANSI® B107.10

SH936-12 Soft Grip Replacement Handle

ID80A12 Hard Grip Replacement Handle (add color code suffix)

DRIVE HANDLES

Speeders, Chrome

Stock No.	EW	EP	ES	ES
S4	1/2	7	4-3/8	18-7/8
SN4B	5/8	6-3/8	3	17-1/4
SL4	1/2	7-3/8	4-7/16	19-1/8
N8323	1/2	18-1/16	8-1/2	32-7/8

ASME®/ANSI® B107.10

SL4 1/2" Drive 19-1/8" Locking Speeder Drive Handle

- Sliding collar and locking pin for better socket retention

- Do not disassemble FOD ratchet in workplace.
- Do not use "cheater bars" on handles.
- Do not push on handle.
- Frequently inspect, clean, and lubricate all nonsealed ratchet mechanisms with light oil.
- Do not replace worn parts individually; use entire contents of the service kit.
- Read Safety Precautions on pages W1-W4



DRIVE HANDLES

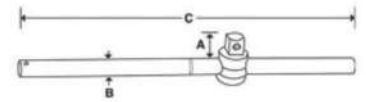

Sliding T-Handle, Chrome

Stock No.			
S12L	1-11/16	5/8	12

ASME®/ANSI® B107.10

EXTENSIONS



Knurled Extensions

Stock No.	Industrial Stock No.			
SX2*	—	5/8	2-1/8	•
SXK3	GSXK3	5/8	3-1/2	•
SXK5	GSXK5	5/8	5	•
SXK8	—	5/8	8	•
SXK10	—	5/8	10	
SXK11	GSXK11	5/8	11	•
SX15	—	5/8	15	
SX20	—	5/8	20	
SX24	—	5/8	24	
SX36	—	5/8	36	

Set includes storage tray. ASME®/ANSI® B107.10M Not knurled

Extensions/Wobble

- Provides 16° of additional accessibility
- Knurled shanks for easy fingertip turning

Stock No.	Industrial Stock No.			
SXW2*	GSXW2	5/8	2	•
SXWK3	—	5/8	3-1/2	•
SXWK5	—	5/8	5	•
SXWK8	—	5/8	8	•
SXWK11	GSXWK11	5/8	11	•

Set includes storage tray. ASME®/ANSI® B107.10M Not knurled



Foam Combination Sets (1/2")

309ASXFR 9 pc 1/2" Drive Knurled Extension Accessory Foam Set

- Includes (6) extensions (2, 3-1/2, 5, 8, 11, and 24"), (1) 1/2" internal drive x 3/8" external drive adaptor, (1) 1/2" internal drive x 3/4" external drive adaptor and (1) 1/2" Drive Friction Ball Universal Joint in a foam organizer

Colors Available



Red Orange Green
R O G

ADD SUFFIX TO STOCK NUMBER FOR SPECIAL COLORS.



Quick-Release Locking Extensions

Stock No.	EP	EP
SXKL3	21/32	3
SXKL5	21/32	5
SXKL10	21/32	10

ASME®/ANSI® B107.10M



Extensions/Wobble Plus, Chrome

- Provides 16° of additional accessibility
- Usable in wobble and rigid functionality
- Knurled shanks for easy fingertip turning

Stock No.	EP	EP	Set Contains:
SXWP2*	5/8	2	•
SXWP3	5/8	3	•
SXWP5	5/8	5	•
SXWP8	5/8	8	•
SXWP11	5/8	11	•

Set includes storage tray
ASME®/ANSI® B107.10

305SXWP

303SXWKL

Extensions/Locking Wobble, Chrome

- Provides 16° of additional accessibility
- Quick-release locking sleeve provides secure connection and easy socket removal
- Knurled release collar for easy one-hand operation, even with slippery hands

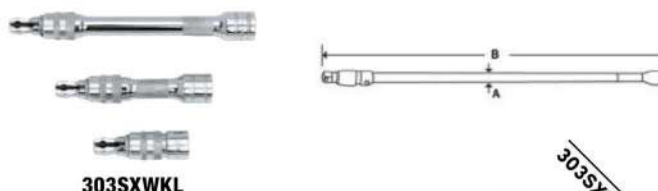

Stock No.	EP	EP	Set Contains:
SXWKL3	21/32	3	•
SXWKL5	21/32	5	•
SXWKL8	21/32	8	•

Set includes storage tray

Locking Adaptor, Industrial

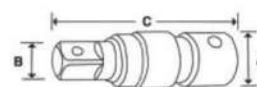

Stock No.	Description	EP	EP	EP
GALX3	1/2" Drive 3" Locking Extension (Blue-Point®)	1/2	1/2	3-1/8

ASME®/ANSI® B107.10

SOCKET/RATCHET ACCESSORIES



A2A



GSAF1F

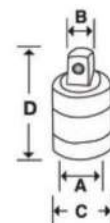

Square Drive Adaptors

Stock No.	EP	EP	EP	EP
GSAF1F	1/2	3/8	31/32	1-13/16
A2A	3/8	1/2	47/64	1-5/16
GAF2A	3/8	1/2	—	1-5/16
GLA12B	1/2	3/4	1-1/8	1-7/8
GLAS1F	3/4	1/2	1-7/16	2-7/16

ASME®/ANSI® B107.10

- Do not use chrome or industrial finish hand tools with power drivers or impact drivers.
- Do not use power sockets or accessories with impact drivers.
- Do not use adaptors with impact drivers.
- Do not exceed torque stamped on adaptor.
- Read Safety Precautions on pages W1-W4



SOCKET/RATCHET ACCESSORIES



Extension Adaptors, Industrial

Stock No.	Retention Type			
GAX5	Ball Type	1/2	3/8	5
GAX12	Ball Type	1/2	3/8	12
GAX24	Ball Type	1/2	3/8	23-1/4
GAX36	Ball Type	1/2	3/8	36

ASME®/ANSI® B107.10



Universal Joints

Stock No.	Industrial Stock No.		
S8	GU8	15/16	2-11/16



103UFTS 3 pc Combination Drive Universal Joint Set

- Includes (1) 1/4" Drive Universal Joint, (1) 3/8" Drive Universal Joint and (1) 1/2" Drive Universal Joint in storage tray

FLANK DRIVE® XTRA SOCKETS

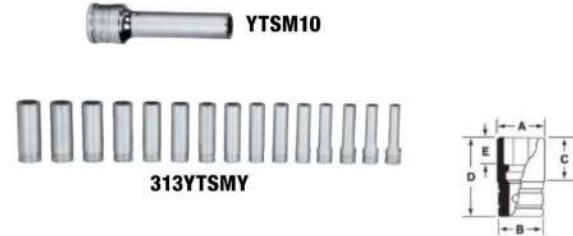
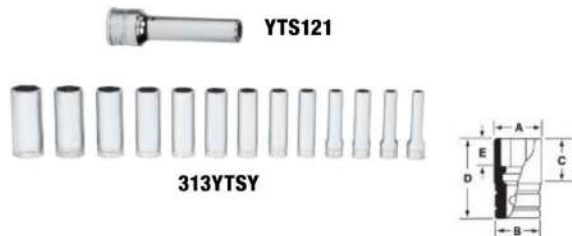

Deep, inches, chrome

Set Contains: **313YTSY**

	6-Point	A	B	C	D	E	
3/8	YTS121	19/32	29/32	2-9/16	3-1/4	9/32	•
7/16	YTS141	11/16	29/32	2-9/16	3-1/4	5/16	•
1/2	YTS161	25/32	29/32	2-9/16	3-1/4	3/8	•
9/16	YTS181	27/32	29/32	2-9/16	3-1/4	13/32	•
5/8	YTS201	29/32	29/32	2-9/16	3-1/4	15/32	•
11/16	YTS221	31/32	31/32	2-9/32	3-1/4	1/2	•
3/4	YTS241	1-1/16	1-1/16	2-9/32	3-1/4	19/32	•
13/16	YTS261	1-1/8	1-1/8	2-1/4	3-1/4	21/32	•
7/8	YTS281	1-3/16	1-3/16	2-1/4	3-1/4	23/32	•
15/16	YTS301	1-9/32	1-9/32	2-1/4	3-1/4	23/32	•
1	YTS321	1-11/32	1-11/32	2-7/32	3-1/4	3/4	•
1-1/16	YTS341	1-7/16	1-7/16	2-7/32	3-1/4	3/4	•
1-1/8	YTS361	1-1/2	1-1/2	2-7/32	3-1/4	25/32	•

Deep, mm, chrome

Set Contains: **313YTSMY**

	6-Point	A	B	C	D	E	
10	YTSM10	15.1	23.0	65.8	82.6	7.1	
11	YTSM11	17.5	23.0	65.8	82.6	7.1	
12	YTSM12	18.3	23.0	65.8	82.6	8.7	•
13	YTSM13	19.8	23.0	65.8	82.6	9.5	•
14	YTSM14	21.4	23.0	65.8	82.6	10.3	•
15	YTSM15	22.2	23.0	65.8	82.6	10.3	•
16	YTSM16	23.0	23.0	65.8	82.6	11.9	•
17	YTSM17	24.6	24.6	58.6	82.6	12.7	•
18	YTSM18	25.4	25.4	58.5	82.6	13.5	•
19	YTSM19	27.0	27.0	58.3	82.6	13.5	•
20	YTSM20	27.0	27.0	57.9	82.6	13.5	•
21	YTSM21	28.6	28.6	57.9	82.6	16.7	•
22	YTSM22	30.2	30.2	57.6	82.6	18.3	•
23	YTSM23	31.8	31.8	57.6	82.6	18.3	•
24	YTSM24	32.5	32.5	57.6	82.6	18.3	•



YTWM10



313YTWMY

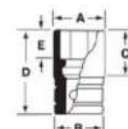

313YTWMY

Shallow, inches, chrome

Set Contains:

6-Point	A	B	C	D	E		
3/8	YTWM121	19/32	29/32	13/16	1-1/2	1/4	•
7/16	YTWM141	11/16	29/32	13/16	1-1/2	9/32	•
1/2	YTWM161	25/32	29/32	13/16	1-1/2	3/8	•
9/16	YTWM181	27/32	29/32	13/16	1-1/2	13/32	•
5/8	YTWM201	29/32	7/8	13/16	1-1/2	15/32	•
11/16	YTWM221	31/32	15/16	13/16	1-1/2	15/32	•
3/4	YTWM241	1-1/16	1-1/32	13/16	1-1/2	17/32	•
13/16	YTWM261	1-1/8	1-3/32	13/16	1-1/2	17/32	•
7/8	YTWM281	1-3/16	1-5/32	13/16	1-1/2	23/32	•
15/16	YTWM301	1-9/32	1-1/4	13/16	1-17/32	23/32	•
1	YTWM321	1-11/32	1-5/16	27/32	1-19/32	3/4	•
1-1/16	YTWM341	1-7/16	1-13/32	31/32	1-23/32	3/4	•
1-1/8	YTWM361	1-1/2	1-15/32	1-1/32	1-3/4	25/32	•



YTWM10



313YTWMY

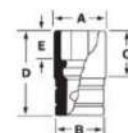

313YTWMY

Shallow, mm, chrome

Set Contains:

mm	A	B	C	D	E		
10	YTWM10	15.1	23	21.3	38.1	6.4	
11	YTWM11	17.5	23	21.3	38.1	7.1	
12	YTWM12	18.3	23	21.3	38.1	8.7	•
13	YTWM13	19.8	23	21.3	38.1	9.5	•
14	YTWM14	21.4	23	21.3	38.1	10.3	•
15	YTWM15	22.2	23	21.3	38.1	9.5	•
16	YTWM16	23	22.2	21.3	38.1	11.9	•
17	YTWM17	24.6	23.8	13.5	38.1	12.7	•
18	YTWM18	25.4	24.6	21.4	38.1	13.5	•
19	YTWM19	27	26.2	21.2	38.1	13.5	•
20	YTWM20	27	26.2	21.1	38.1	13.5	•
21	YTWM21	28.6	27.8	21	38.1	13.5	•
22	YTWM22	30.2	29.4	20.8	38.1	13.5	•
23	YTWM23	31.8	31	20.7	38.1	14.3	•
24	YTWM24	32.5	31.8	21.3	38.9	15.1	•



- Do not use chrome or industrial finish hand tools with power drivers or impact drivers.
- Read Safety Precautions on pages W1-W4

FLANK DRIVE® SOCKETS

1/2" DRIVE TOOLS



SW241



313SWYA

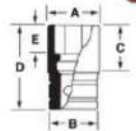

Shallow, inches

Set Contains:

II	Set Contains:			A	B	C	D	E	Set Contains:			
	6	12	6						12	6	6	12
3/8	TW121A	SW121A	GTW121A	GSW121A	19/32	29/32	13/16	1-1/2	1/4	•	•	•
7/16	TW141A	SW141A	GTW141A	GSW141A	11/16	29/32	13/16	1-1/2	9/32	•	•	•
1/2	TW161A	SW161A	GTW161A	GSW161A	25/32	29/32	13/16	1-1/2	3/8	•	•	•
9/16	TW181A	SW181A	GTW181A	GSW181A	27/32	29/32	13/16	1-1/2	13/32	•	•	•
5/8	TW201	SW201	GTW201	GSW201	29/32	7/8	13/16	1-1/2	15/32	•	•	•
11/16	TW221	SW221	GTW221	GSW221	31/32	15/16	13/16	1-1/2	15/32	•	•	•
3/4	TW241	SW241	GTW241	GSW241	1-1/16	1-1/32	13/16	1-1/2	17/32	•	•	•
13/16	TW261	SW261	GTW261	GSW261	1-1/8	1-3/32	13/16	1-1/2	17/32	•	•	•
7/8	TW281	SW281	GTW281	GSW281	1-3/16	1-5/32	13/16	1-1/2	23/32	•	•	•
15/16	TW301	SW301	GTW301	GSW301	1-9/32	1-1/4	13/16	1-1/2	23/32	•	•	•
1	TW321	SW321	GTW321	GSW321	1-11/32	1-5/16	27/32	1-9/16	3/4	•	•	•
1-1/16	TW341	SW341	GTW341	GSW341	1-7/16	1-13/32	31/32	1-11/16	3/4	•	•	•
1-1/8	TW361	SW361	GTW361	GSW361	1-1/2	1-15/32	1-1/32	1-3/4	25/32	•	•	•
1-3/16	TW381	SW381	—	GSW381	1-5/8	1-19/32	1	1-3/4	3/4			
1-1/4	TW401	SW401	GTW401	GSW401	1-11/16	1-21/32	1-1/8	1-7/8	3/4		•	
1-5/16	TW421	SW421	—	—	1-3/4	1-23/32	1-1/8	1-7/8	1			
1-3/8	TW441	SW441	—	—	1-13/16	1-25/32	1-9/32	2-1/32	1			
1-7/16	TW461	SW461	—	—	—	—	1-5/8	2-1/4	—			
1-1/2	TW481	SW481	—	—	—	—	1-5/8	2-1/4	—			

•s include storage tray.

ASME®/ANSI® B107.1



SWM101A



310TWMYA

Shallow, mm, Chrome

Set Contains:

mm	Set Contains:							Set Contains:						
	6	12	A	B	C	D	E	6	6	6	6	12	12	12
10	TWM10A	SWM101A	15.0	23.2	22.2	38.1	7.9		•		•	•		•
11	TWM11A	SWM111A	16.6	23.2	22.2	38.1	8.7		•		•	•		•
12	TWM12A	SWM121A	18.2	23.2	22.2	38.1	9.5		•	•	•	•	•	•
13	TWM13A	SWM131A	19.0	23.2	22.2	38.1	10.3		•	•	•	•	•	•
14	TWM14A	SWM141A	20.6	23.2	22.2	38.1	10.3		•	•	•	•	•	•
15	TWM15A	SWM151A	22.2	22.2	22.2	38.1	10.3		•	•	•	•	•	•
16	TWM16	SWM161	23.8	22.2	22.2	38.1	11.9		•	•	•	•	•	•
17	TWM17	SWM171	24.6	23.2	22.2	38.1	12.7		•	•	•	•	•	•
18	TWM18	SWM181	25.4	23.8	21.4	38.1	14.2		•	•	•	•	•	•
19	TWM19	SWM191	26.3	24.8	21.3	38.1	13.9		•	•	•	•	•	•
20	TWM20	SWM201	26.7	26.1	21.2	38.1	14.0	•		•	•		•	•
21	TWM21	SWM211	28.3	27.5	21.1	38.1	14.0	•		•	•		•	•
22	TWM22	SWM221	29.9	28.6	20.9	38.1	14.2	•		•	•		•	•
23	TWM23	SWM231	31.2	29.9	20.8	38.1	14.5	•		•	•		•	•
24	TWM24	SWM241	32.5	30.9	22.2	38.8	15.8	•		•	•		•	•
25	TWM25	SWM251	33.3	31.7	22.2	38.8	15.8	•		•	•		•	•
26	TWM26	SWM261	34.9	33.3	23.8	41.2	15.8			•	•		•	•
27	TWM27	SWM271	36.5	34.9	25.4	42.8	17.4			•	•		•	•
28	TWM28	SWM281	38.1	36.5	26.9	44.4	17.4			•	•		•	•
29	TWM29	SWM291	39.3	38.0	26.1	44.5	17.8			•	•		•	•
30	TWM30	SWM301	41.0	39.6	26.1	44.5	18.5			•	•		•	•
31	TWM31	SWM311	42.5	41.2	29.1	47.6	19.1			•	•		•	•
32	TWM32	SWM321	42.5	41.2	28.9	47.6	19.8			•	•		•	•

Set includes storage tray.

ASME®/ANSI® B107.5



GTS201



S241



313SYA

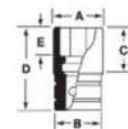

Deep, inches

II	Set Contains:				313GTSYA		313TSA		313SYA			
	6	12	6	12	A	B	C	D	E	6	6	12
3/8	TS121A	S121A	GTS121A	—	19/32	29/32	2-9/16	3-1/4	9/32	•	•	•
7/16	TS141A	S141A	GTS141A	—	11/16	29/32	2-9/16	3-1/4	5/16	•	•	•
1/2	TS161A	S161A	GTS161A	GS161A	25/32	29/32	2-9/16	3-1/4	3/8	•	•	•
9/16	TS181A	S181A	GTS181A	GS181A	27/32	29/32	2-9/16	3-1/4	13/32	•	•	•
5/8	TS201	S201	GTS201	GS201	29/32	7/8	2-9/16	3-1/4	15/32	•	•	•
11/16	TS221	S221	GTS221	GS221	31/32	15/16	2-9/32	3-1/4	1/2	•	•	•
3/4	TS241	S241	GTS241	GS241	1-1/16	1-1/32	2-9/32	3-1/4	19/32	•	•	•
25/32	—	S251	—	—	1-1/16	1-1/32	2-9/16	3-1/4	5/8			
13/16	TS261	S261	GTS261	GS261	1-1/8	1-3/32	2-1/4	3-1/4	21/32	•	•	•
7/8	TS281	S281	GTS281	GS281	1-3/16	1-5/32	2-1/4	3-1/4	23/32	•	•	•
15/16	TS301	S301	GTS301	GS301	1-9/32	1-1/4	2-1/4	3-1/4	23/32	•	•	•
1	TS321	S321	GTS321	GS321	1-11/32	1-5/16	2-7/32	3-1/4	3/4	•	•	•
1-1/16	TS341	S341	GTS341	GS341	1-7/16	1-13/32	2-7/32	3-1/4	3/4	•	•	•
1-1/8	TS361	S361	GTS361	GS361	1-1/2	1-15/32	2-7/32	3-1/4	25/32	•	•	•
1-3/16	TS381	S381	GTS381	GS381	1-9/16	1-17/32	2-7/32	3-1/4	25/32			
1-1/4	TS401	S401	GTS401	GS401	1-11/16	1-21/32	2-7/32	3-1/4	1			
1-5/16	TS421	S421	—	—	1-3/4	—	2-7/32	3-1/4	1			
1-3/8	TS441	S441	—	—	1-13/16	1-25/32	2-7/32	3-1/4	1			
1-7/16	TS461	S461	—	—	1-15/16	1-7/8	2-5/8	3-1/4	1			
1-1/2	TS481	S481	—	—	2	1-15/16	2-5/8	3-1/4	1-1/16			

Sets include storage tray

ASME®/ANSI® B107.1



TWM14A



TSM24



Cummins® B and C Series

mm	6-Point	Dimension A				
14	TWM14A	20.6	23.2	22.2	38.1	10.3
24	TSM24	32.5	31.8	57.6	82.6	18.3



- Do not use chrome or industrial finish hand tools with power drivers or impact drivers.
- Read Safety Precautions on pages W1-W4

FLANK DRIVE® SOCKETS



TSM20



313SMYA

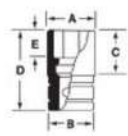

Deep, mm, Chrome

mm	Set Contains:		A	B	C	D	E	313TSMYA	310TSM	313SMYA
	6	12						6	6	12
10	TSM10A	SM10A	15.1	23.0	65.8	82.6	7.1		•	
11	TSM11	SM11A	17.5	23.0	65.8	82.6	7.1			
12	TSM12A	SM12B	18.3	23.0	65.8	82.6	8.7	•	•	•
13	TSM13A	SM13A	19.8	23.0	65.8	82.6	9.5	•	•	•
14	TSM14A	SM14A	21.4	23.0	65.8	82.6	10.3	•	•	•
15	TSM15A	SM15A	22.2	23.0	65.8	82.6	10.3	•	•	•
16	TSM16	SM16	23.0	22.2	65.8	82.6	11.9	•	•	•
17	TSM17	SM17	24.6	23.8	58.6	82.6	12.7	•	•	•
18	TSM18	SM18	25.4	24.6	58.5	82.6	13.5	•	•	•
19	TSM19	SM19	27.0	26.2	58.3	82.6	13.5	•	•	•
20	TSM20	SM20	27.0	26.2	57.9	82.6	13.5	•	•	•
21	TSM21	SM21	28.6	27.8	57.9	82.6	16.7	•		•
22	TSM22	SM22	30.2	29.4	57.6	82.6	18.3	•		•
23	TSM23	SM23	31.8	31.0	57.6	82.6	18.3	•		•
24	TSM24	SM24	32.5	31.8	57.6	82.6	18.3	•		•
25	TSM25	SM25	33.3	32.5	57.0	82.6	15.1			
26	TSM26	SM26	34.9	34.1	57.0	82.6	19.1			
27	TSM27	SM27	36.5	35.7	57.0	82.6	19.1			
28	TSM28	SM28	38.1	37.3	57.0	82.6	19.1			
29	TSM29	SM29	39.7	38.9	57.0	82.6	19.8			
30	TSM30	SM30	41.3	40.5	57.0	82.6	19.8			
31	TSM31	SM31	42.9	42.1	57.0	82.6	19.8			
32	TSM32	SM32	42.9	42.1	57.0	82.6	25.4			

Sets include storage tray

ASME®/ANSI® B107.5



320TSWMB

Shallow/Deep Sets, mm, Chrome
320TSWMB 20 pc 1/2" Drive 6-Point Metric Flank Drive® Shallow/Deep Socket Set
 • Includes (20) Shallow and Deep Sockets (10–20 mm)



FOAM COMBINATION SETS

1/2" DRIVE TOOLS



338TSWYAFR



346TSWMFR

Foam Combination Sets (1/2")

- Snap-on® sockets using the Flank Drive® wrenching system grip the fastener on the flanks/flats which deliver 15–25% more turning power
- 6-point configuration and Flank Drive® wrenching system
- Nickel-chrome alloy finish resists rust and corrosion
- Manufactured from the highest quality proprietary steel, providing optimum strength and durability

Foam Organizer:

- Closed cell cross-linked foam for superior performance and durability resists oils, solvents and fuels—easy to clean
- Foam organizer's modular design provides in-drawer reconfiguration for new tools and designed for maximum tool concentration on the smallest possible footprint

- Each tool is precision-fit, providing ultimate tool protection
- Contrasting colors provide visual control and closed cell cross-linked foam resist oils, solvents and fuels

338TSWYAFR 38 pc 1/2" Drive 6-Point SAE Flank Drive® Shallow/Deep Combination Socket Foam Set

- Includes (19) shallow sockets and (19) deep sockets (3/8–1-1/2") in a foam organizer

346TSWMFR 46 pc 1/2" Drive 6-Point Metric Flank Drive® Shallow/Deep Combination Socket Foam Set

- Includes (23) shallow sockets and (23) deep sockets (10–32 mm) in a foam organizer

Colors Available



ADD SUFFIX TO STOCK NUMBER FOR SPECIAL COLORS.

FLANK DRIVE® SOCKETS



SDH201



Aerospace, inches

	12	A	B	C	D	E
3/8	SDH121	19/32	7/8	13/16	1-1/2	9/32
7/16	SDH141	11/16	29/32	13/16	1-1/2	11/32
1/2	SDH161	3/4	29/32	13/16	1-1/2	3/8
9/16	SDH181	27/32	29/32	13/16	1-1/2	13/32
5/8	SDH201	29/32	7/8	13/16	1-1/2	15/32
11/16	SDH221	31/32	15/16	1-1/16	1-3/4	1/2
3/4	SDH241	1-1/16	1-1/32	1-1/16	1-3/4	19/32
25/32	SDH251	1-1/32	1-1/64	1-3/32	1-3/4	5/8
13/16	SDH261	1-1/8	1-3/32	1-1/16	1-3/4	21/32
7/8	SDH281	1-3/16	1-5/32	1-1/8	1-3/4	23/32
15/16	SDH301	1-9/32	1-1/8	1-5/32	1-13/16	23/32
1	SDH321	1-11/32	1-5/16	1-7/32	1-7/8	3/4
1-1/16	SDH341	1-7/16	1-13/32	1-7/32	1-15/16	3/4
1-1/8	SDH361	1-1/2	1-15/32	1-1/4	1-31/32	25/32
1-3/16	SDH381	1-9/16	1-17/32	1-5/16	2	25/32
1-1/4	SDH401	1-9/16	1-17/32	1-9/32	2-1/32	13/16
1-5/16	SDH421	1-21/32	1-5/8	1-5/16	2-1/32	27/32

Meets AS954 Aerospace standard



- Do not use chrome or industrial finish hand tools with power drivers or impact drivers.
- Read Safety Precautions on pages W1–W4.



FLANK DRIVE® SOCKETS



SU24

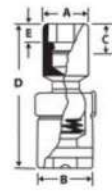

Shallow Universal, Inches, Chrome

Set Contains: 3075UY

#		A	B	C	D	E	
9/16	SU18	27/32	15/16	1-19/64	2-7/16	11/32	•
5/8	SU20	15/16	15/16	1-21/64	2-15/32	3/8	•
11/16	SU22	1-1/16	1-1/16	1-15/32	2-9/16	7/16	•
3/4	SU24	1-1/8	1-1/8	1-43/64	2-7/8	1/2	•
13/16	SU26	1-3/16	1-1/8	1-3/4	2-15/16	9/16	•
7/8	SU28	1-1/4	1-1/8	1-3/4	2-15/16	9/16	•
15/16	SU30	1-5/16	1-1/8	1-13/16	3	9/16	•

ASME®/ANSI® B107.10M

Set includes storage tray.

TORX® SOCKETS



SLEPL200



GSLEPL200

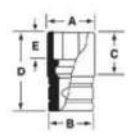
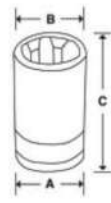

213AFLEY

★ TORX Plus® with Countersink

- SLEPL Series of TORX Plus® Sockets with shallow countersink are designed for use on external TORX Plus® low-profile head fasteners to fully engage the fastener head
- Manufactured from special alloy steel
- Precision forged and heat treated for optimum strength and durability

#	Stock No.	Industrial Stock No.	A	B	C
18EP	SLEPL180		29/32	15/16	1-1/2
20EPL	SLEPL200	GSLEPL200	15/16	11/16	1-1/2
22EPL	SLEPL220		15/16	11/16	1-1/2
24EPL	SLEPL240		15/16	11/16	1-1/2

SLEPL200 1/2" Drive 20EPL TORX Plus® with Countersink Socket

- For removal and installation of low-profile drive plate and flywheel bolts on QR25 Nissan® motors with automatic transmissions
- Similar to the J-45816 Nissan® specialty tool
- For flywheel bolts on Nissan® QR25 motors with manual transmissions use the FTX50TPE 3/8" Drive T50 TORX Plus® Male Socket

★ Shallow TORX®, Chrome

#	Stock No.	A	B	C	D	E
E14	SLE140	11/16	29/32	1/16	1-1/2	3/8
E16	SLE160A	23/32	29/32	1/16	1-1/2	7/16
E18	SLE180A	27/32	29/32	1/16	1-1/2	15/32
E20	SLE200A	15/16	29/32	1/16	1-1/2	17/32
E24	SLE240	1-1/16	1-1/32	1/16	1-1/2	17/32

213AFLEY 13 pc Combination Drive TORX® Shallow Socket Set

- Includes (6) 1/4" drive (E4–E10), (3) 3/8" drive (E11–E14) and (4) 1/2" drive (E16–E24) TORX® shallow sockets in a magnetic storage tray
- Nickel-chrome plating helps protect against corrosion and makes it easy to wipe clean
- Manufactured from special alloy steel and treated for optimum strength and durability
- Use of a standard TORX® bit socket on a TORX Plus® fastener may result in a rounded out fastener head or damaged bit socket

Snap-on® spline wrenching tools have been developed to service high-tensile strength spline nuts and bolts widely used on both military and commercial aircraft. Precise, radial spline teeth engage the fastener teeth over a wider area to minimize stress, and allow application of high torque to reduce risk of damage to the fastener or to the tool.

Chrome tools comply with Military Spec. MS-33787 and MIL-W-8982. The unique spline wrenching configuration can also be used on ordinary 6- and 12-point fasteners with an advantage similar to the Snap-on® Flank Drive® wrenching system



SES161B

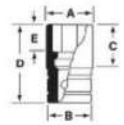

Shallow, Inches, Chrome (1/2")

		Stock No.	A	B	C	D	E
#16	1/2	SES161B	3/4	7/8	5/8	1-9/32	7/16
#18	9/16	SES181B	27/32	7/8	5/8	1-9/32	7/16
#20	5/8	SES201B	29/32	29/32	29/32	1-9/16	17/32
#22	11/16	SES221B	1	1	29/32	1-9/16	9/16
#24	3/4	SES241B	1-1/16	31/32	13/16	1-9/16	9/16
#26	13/16	SES261B	1-1/8	1-1/16	29/32	1-9/16	9/16
#28	7/8	SES281B	1-3/16	1-1/8	13/16	1-9/16	9/16
#30	15/16	SES301B	1-9/32	1-7/32	13/16	1-9/16	9/16

SPECIAL APPLICATION SOCKETS



SW412

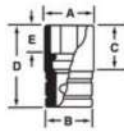

Double Square, Inches, Chrome

	Stock No.	A	B	C	D	E
3/8	SW412	23/32	7/8	7/8	1-1/2	5/16
7/16	SW414	51/64	7/8	7/8	1-1/2	3/8
1/2	SW416	29/32	7/8	7/8	1-1/2	13/32
9/16	SW418	31/32	29/32	7/8	1-1/2	7/16
5/8	SW420	1-1/16	1	7/8	1-1/2	1/2
11/16	SW422	1-3/16	1-1/8	7/8	1-1/2	1/2
3/4	SW424	1-9/32	1-3/16	7/8	1-1/2	9/16
13/16	SW426	1-7/16	1-3/8	1	1-5/8	5/8
7/8	SW428	1-1/2	1-7/16	1-1/8	1-3/4	5/8
15/16	SW430	1-5/8	1-9/16	1-1/8	1-13/16	11/16
1	SW432	1-11/16	1-5/8	1-1/4	1-7/8	11/16



WH280

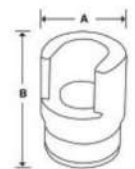

Weatherhead® Fittings, Inches, Chrome

	Stock No.	A	B
7/8	WH280	1-3/8	1-13/16
29/32	WH290	1-7/16	1-13/16
15/16	WH300	1-1/2	1-13/16



A26A

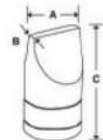

Drag Link, Industrial

Stock No.	A	B	C
A15A	1-3/16	.150	1-11/16
A17A	15/16	.150	1-11/16
A26A	3/4	.109	1-11/16

PPM516A

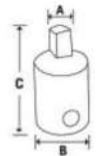

Pipe Plug, Inches, Chrome

Stock No.	A	B	C
PPM516A	1/2	15/16	1-7/16

TORQUE ADAPTORS



SRDH321

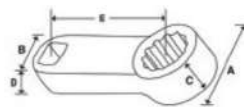

STA35

Standard, inches

- Manufactured from special alloy steel
- Precision forged and heat treated for optimum strength and durability
- Double hex (12-point) configuration allows socket to engage single hex fastener every 30° rather than every 60°, allowing for better access in restricted areas

Working Torque, in-lb			A	B	C	D	E
4,400	1	SRDH321	1.458	1.040	19/32	19/32	3
4,800	1-1/16	SRDH341	1.563	1.032	19/32	19/32	2
5,280	1-1/8	SRDH361	1.641	1.040	19/32	19/32	3
5,600	1-1/4	SRDH401	1.823	1.040	19/32	19/32	3
5,600	1-3/8	SRDH441	2.00	1.040	19/32	19/32	3

Torque Adaptor STA35 1/2" Drive Female/Male Torque Adaptor

- 3.5" length measured center to center
- Used with a socket and torque wrench to reach and properly torque fasteners in hard-to-access areas



• Do not use chrome or industrial finish hand tools with power drivers or impact drivers.
• Read Safety Precautions on pages W1-W4

SPLINE TORQUE ADAPTORS

Spline, Inches, Chrome (1/2")

- Snap-on® spline wrenching tools have been developed to service high-tensile strength spline nuts and bolts widely used on both military and commercial aircrafts
- Precise radial spline teeth engage the fastener teeth over a wider area to minimize stress and allow application of high-torque to reduce risk of damage to the fastener or the tool
- Chrome tools comply with Military Spec MS-33787 and MIL-W-89823

- The unique spline wrenching configuration can also be used on ordinary six and 12-point fasteners with an advantage similar to the Snap-on® Flank Drive® wrenching system

Set Contains: **SRES306**

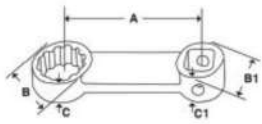

Working Torque, in-lb	#	Hex Size	Stock No.	A	B-B1	C-C1	
2,275	#18 (9/16")	9/16	SRES18	3	.818-1.04	13/32-1/2	•
2,450	#20 (5/8")	5/8	SRES20	3	.900-1.04	1/2-1/2	•
2,975	#22 (11/16")	11/16	SRES22	3	.989-1.04	1/2-1/2	•
3,500	#24 (3/4")	3/4	SRES24	3	1.08-1.04	1/2-1/2	•
4,410	#26 (13/16")	13/16	SRES26	3	1.16-1.04	1/2-1/2	•
4,900	#28 (7/8")	7/8	SRES28	3	1.26-1.04	1/2-1/2	•
6,000	#30 (15/16")	15/16	SRES30A	3	1.26-1.04	37/64-37/64	

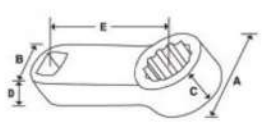

Double Hex, mm, Chrome (1/2")

Stock No.	A	B	C	D	E
SRDHM30	9.5	11.9	6.6	6.6	25.4

TORX® BIT SOCKETS



STX70E

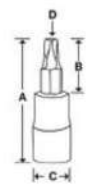

STXL55E



K1820A



★ TORX®/Standard, Chrome (1/2")

#	Stock No.	A	B	C	D
T55	STX55E	2-25/64	57/64	29/32	FTX55E2
T60	STX60E	3-9/32	1-23/64	1-11/64	STX60E2
T70	STX70E	3-17/32	1-49/64	1-11/64	STX70E2

★ TORX®/Long, Chrome (1/2")

#	Stock No.	A	B	C	D
T45	STXL45E	4-37/64	3-5/64	29/32	STXL45E2
T50	STXL50E	4-37/64	3-5/64	29/32	STXL50E2
T55	STXL55E	4-37/64	3-5/64	15/16	STXL55E2
T60	STXL60E	4-39/64	2-27/32	1-7/32	STXL60E2
T70	K1820A	5-17/64	3-1/2	1-7/32	K1820A2
T80	STXL80E	4-51/64	3	1-13/32	STXL80E2



STX60TPE



★ TORX Plus®, Chrome (1/2")

#	Stock No.	A	B	C	D
T45	STX45TPE	2-9/16	1-1/16	29/32	FTX45TPE2
T50	STX50TPE	2-43/64	1-11/64	15/16	STX50TPE2
T55	STX55TPE	2-49/64	1-7/32	1-1/32	FTX55TPE2
T60	STX60TPE	3-9/32	1-1/2	1-7/32	STX60TPE2

Hex/Standard, mm, Chrome (1/2")

Set Contains:

307ESAMY

mm		A	B	C	D	
6	SAM6E	64.1	26	22.9	FAM6E2	•
8	SAM8E	61.8	23.7	22.9	FAM8E2	•
10	SAM10E	63.6	25.5	22.9	SAM10E2	•
12	SAM12E	79.6	41.5	23.1	SAM12E2	•
14	SAM14E	81.9	42.4	26.1	SAM14E2	•
16	SAM16E	94.5	49.5	30.7	SAM16E2	•
17	SAM17E	94.5	49.5	29.9	SAM17E2	•
19	SAM19E	102.6	56.6	34.9	SAM17E2	•



307ESAMY

Set shown includes magnetic storage tray.

Ball Hex/Long, mm, Chrome (1/2")

mm		A	B
12	SABLM12E	137.1	SABLM12E2

- Use to remove and reassemble the hydraulic split flange connector bolts on Case®, Hitachi®, Komatsu®, Caterpillar®, John Deere® and Volvo® excavators and bulldozers



SABLM12E

Double Hex/Standard, mm, Chrome (1/2")

Double Hex Socket Drivers and Triple Square Socket Drivers cannot be interchanged between applications. Triple Square Socket Drivers have 90° corners. Double Hex Socket Drivers have 120° corners. Using a Triple Square tool in a Double Hex application will strip the bolt head. In general, Triple Square tools are used on European vehicles and Double Hex tools are used on Asian vehicles

mm		A	B	C	D
10	SADM10E	100	61.9	24.4	SADM10E2

SADM10E 1/2" Drive Metric 10 mm Lexus®/Toyota® Double Hex Socket Driver

- Applications include removal/installation of head bolts on Toyota® Highlander®, 4Runner®, Camry®, Matrix®, Corolla® and Lexus® IS300®, GS300®, SC300 vehicles



SADM10E

Hex/Long, mm, Chrome (1/2")

mm		A	B	C	D
10	SAM10LE	152.4	114.3	22.9	SAM10LE2
12	SAM12LE	98.0	59.9	23.1	SAM12LE2
13	SAM13LE	101.6	63.5	23.5	SAM13LE2

SAM13LE 1/2" Drive Metric 13 mm Long Hex Bit Socket Driver

- Snap-on® bits are designed with a precise fit and tight tolerances to prevent slippage and disengagement
- Outperforms one-piece design models; our two-piece design makes replacement economical and convenient
- Manufactured from special alloy steel and heat-treated for optimum strength and durability
- 1/2" drive provides the high-torque needed on the engine bolt
- 4" length allows technician to clear the valve and valve cover sealing surface



SAM12LE

HEX BIT SOCKETS

Hex/Standard, inches (1/2")

Set Contains:

307ESAY

			A	B	C	D	
5/16	SA10E	GSA10E	2-29/64	61/64	29/32	FA10E2	•
3/8	SA12E	GSA12E	2-21/32	1-9/64	29/32	SA12E2	•
7/16	SA14E	GSA14E	2-13/16	1-5/16	29/32	SA14E2	•
1/2	SA16E	GSA16E	3-1/8	1-5/8	29/32	SA16E2	•
9/16	SA18E	GSA18E	3-15/64	1-21/32	1-1/32	SA18E2	•
5/8	SA20E	GSA20E	3-13/32	1-41/64	1-11/64	LAW120E2	•
3/4	SA24E	GSA24E	4-3/64	2-15/64	1-3/8	LAW124E2	•



307ESAY

Set shown includes magnetic storage tray.



- Do not use chrome or industrial finish hand tools with power drivers or impact drivers.
- Do not use power sockets or accessories with impact drivers.
- Read Safety Precautions on pages W1-W4



IMPACT DRIVERS AND SETS

Impact Rated Hex Drivers (1/2")

- Manufactured from special alloy steel and heat treated for optimum strength and durability
- Snap-on® bits are designed with a precise fit and tight tolerances to prevent slippage and disengagement
- Outperform one-piece design models; two-piece design makes replacement economical and convenient
- Bits can be easily replaced by hand—no need to put them in a vice and punch them out with a hammer
- 3/8" drive sizes: 12 and 14 mm, 1/2 and 9/16"
- 1/2" drive sizes: 5/8, 11/16, 3/4 and 7/8"
- Optional retaining ring ensures positive attachment to anvil for added protection—RR37575 for 3/8" models and RR50130 for 1/2" models
- Designed for use with pneumatic or cordless impact guns



Size, inches	Stock No.	A	B	Optional Ret Ring
5/8	IMSA20	3-1/2	IMSA20-2	RR50130
11/16	IMSA22	3-1/2	IMSA22-2	RR50130
3/4	IMSA24	3-1/2	IMSA24-2	RR50130
7/8	IMSA28	3-1/2	IMSA28-2	RR50130

TRIPLE SQUARE BIT SOCKETS



Triple Square/Standard, mm, Chrome (1/2")

Set Contains: TSS7KIT

mm	Stock No.	A	B	C	D	
Standard Length	16	STSM16E	107.7	63.6	29.9	STSM16E2
	18	STSM18E	98.3	52.2	34.9	STSM18E2
	10	STSM10E	89.4	51.3	23.1	STSM10E2
	12	STSM12E	107.7	64.8	23.5	STSM12E2
	14	STSM14E	109.5	63.4	26.9	STSM14E2
Long	10	STSM10LE	156.5	118.4	23.5	STSM10LE2
	12	STSM12LE	145.8	107.7	23.5	STSM12LE2

Set includes storage tray Triple Square tools are used on European vehicles and Double Hex tools are used on Asian vehicles. Using a Triple Square tool in a Double Hex application will strip the bolt head

STSM10E 1/2" Drive Metric 10 mm Standard Triple Square Bit Socket Driver

- Double hex bit sockets and triple square bit sockets cannot be interchanged between applications
- Triple square bit sockets have 90° corners and double hex bit sockets have 120° corners
- Using a triple square bit socket in a double hex bit application will strip the bolt head
- In general, triple square bit sockets are used on European vehicles
- Pinless bits (no roll pin) provide a solid fit, are easily replaced, and have no hole to collect dirt and grit
- Bits feature natural oil coat finish to protect against corrosion

STSM12E 1/2" Drive Metric 12 mm Standard Triple Square Bit Socket Driver

- Applications include removal/installation of cylinder head bolts on Mercedes-Benz®, rear toe adjustment on 1999 and newer Audi® A6® and axle shaft bolts on new VW® vehicles

STSM14E 1/2" Drive Metric 14 mm Standard Triple Square Bit Socket Driver

- Applications include 2003 and later VW® Touareg® front axle bolts, 2003 and later Porsche® Cayenne® front axle bolts, various Audi®/VW® axle bolts and Audi® TT® differential mount bolts and transmission drain plugs

STSM16E 1/2" Drive Metric 16 mm Standard Triple Square Bit Socket Driver

- Applications include Audi® TT® clutch and belly pan, various VW®/Audi® transmission drain plugs (tamper-resistant), 2003 and later VW® Touareg® front and rear brake caliper bolts, 2003 and later Porsche® Cayenne® brake caliper bolts, Detroit Diesel® flywheel bolts and front crank pulley on 900 and 4000 engines and head bolts on 900 engines

STSM18E 1/2" Drive Metric 18 mm Standard Triple Square Bit Socket Driver

- Applications include removal/installation of rear axle bolts of 2006 VW® Jetta® and Golf® vehicles



305STSMSE

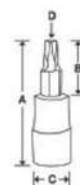

Triple Square/Stubby, mm, Chrome (1/2")

- Pinless bits (no roll pin) provide a solid fit, are easily replaced, and have no hole to collect dirt and grit
- Bit sockets are chrome plated
- Bits feature natural oil coat finish to protect against corrosion
- Double Hex socket drivers and Triple Square socket drivers cannot be interchanged between applications
- Using a Triple Square tool in a Double Hex application will strip the bolt head
- In general, Triple Square tools are used on European vehicles and Double Hex tools are used on Asian vehicles

Set Contains:

mm	Stock No.	A	B	C	D	
10	STSM10SE	59.4	21.3	23.7	STSM10E2	•
12	STSM12SE	59.4	21.3	23.7	STSM12E2	•
14	STSM14SE	63.2	23.7	26.1	STSM14E2	•
16	STSM16SE	68.1	23.1	30.9	STSM16E2	•
18	STSM18SE	69.8	23.8	35.6	STSM18E2	•

Set shown includes magnetic storage tray.

STSM10SE 1/2" Drive Metric 10 mm Triple Square Bit Socket Driver

- Applications include removal/installation of cylinder head bolts, drive shaft bolts and various other applications on VW®, Audi® and Mercedes-Benz® vehicles

STSM12SE 1/2" Drive Metric 12 mm Triple Square Bit Socket Driver

- Applications include removal/installation of head bolts and axle shaft bolts on VW®, Audi® and Mercedes® vehicles

STSM14SE 1/2" Drive Metric 14 mm Triple Square Bit Socket Driver

- Applications include removal/installation of brake caliper bolts on VW® Jetta®, Rabbit®, Passat®, EOS® and Tiguan®; there is limited room due to the control arm in the way when backing out the fastener

STSM16SE 1/2" Drive Metric 16 mm Triple Square Bit Socket Driver

- Pinless bits (no roll pin) provide a solid fit, are easily replaced and have no hole to collect dirt and grit

STSM18SE 1/2" Drive Metric 18 mm Triple Square Bit Socket Driver

- Rear axle bolts on Volkswagen® Jetta® and Golf®

SPECIAL APPLICATION BIT SOCKETS



SPDL10E



PolyDrive Head Bolts, mm (1/2")

mm	Stock No.	Description	A	B	C	D
10	SPDL10E	1/2" Drive Metric 10 mm VW®/Audi® Polydrive Head Bolt Bit Socket Driver	158.7	120.6	23.0	SPDL10E2

SPDL10E 1/2" Drive Metric 10 mm VW®/Audi® Polydrive Head Bolt Bit Socket Driver

- Applications include removal/installation of #10 PolyDrive cylinder head bolts on 1998 and later VW®/Audi® vehicles with 5-valve motors



- Do not use chrome or industrial finish hand tools with power drivers or impact drivers.
- Read Safety Precautions on pages W1-W4