

RATCHET HEAD/HANDLES



Ratchet Heads, Sealed (3/4")

Stock No.	Description	Gear Teeth	Swing Arc	A	B	C
L872	Sealed Ratchet Head	32	11°	1-1/4	2-1/2	5-15/16
GL872	Sealed Ratchet Head	32	11°	1-1/4	2-1/2	5-15/16

ASME®/ANSI® B107.10

Handles, Chrome (3/4")

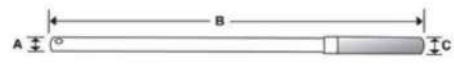

Stock No.	Description	A	B	C
L872RM	Long 36" Handle (lock button end/knurled end)	15/16	36	1-1/8
L872RJ	Short 19-1/4" Handle (lock button end/knurled end)	15/16	19-1/4	1-1/8
L872H	Short 19-1/4" Handle (lock button both ends)	13/16	19-1/4	15/16

ASME®/ANSI® B107.10



Head and Handle Combinations (3/4")

	Heads Using 13/16" (small) diameter handle holes		Heads Using 15/16" (large) diameter handle holes	
	L52B Sliding Head	L872 Sealed Ratchet Head	L8112A Breaker Bar Head	L872H
Short 19-1/4" Handle (lock button end/knurled end)	L872H	—	L872H	
Short 19-1/4" Handle (lock button both ends)	—	L872RJ	L872RJ	
Long 36" Handle (lock button end/knurled end)	—	L872RM	L872RM	

DRIVE HANDLES



L8112A

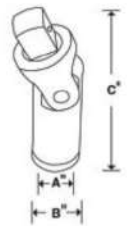

L52B

Breaker Bar, Chrome (3/4")

Stock No.	A	B	B	Use with Handle
L8112A	15/16	1-9/16	3-11/16	L872RM or L872RJ

ASME®/ANSI® B107.10

Sliding T-Handle, Chrome (3/4")

Stock No.	A	B
L52B	1-1/2	2-5/16

ASME®/ANSI® B107.10

L52B 3/4" Drive 2-5/16" Head Depth Sliding T-Handle Head

- Designed for heavier applications
- Can be used as a T-handle or as an offset wrench
- Spring-and-friction ball holds head in position
- Use with L872H handle

SOCKET/RATCHET ACCESSORIES



L32

GL42

Extensions/Lock Button (3/4")

Stock No.	Industrial Stock No.	A	B
L32	GL32	15/16	3
L42	GL42	15/16	5
L62	GL62	15/16	8
L122	GL122	15/16	16



L82A



Universal Joint, Chrome

Stock No.	A	B
L82A	1-9/16	3-7/8

Square Drive Adaptors, Industrial (3/4")

Stock No.	A	B	C	D
GLA12B	1/2	3/4	1-1/8	1-7/8
GLAS1F	3/4	1/2	1-7/16	2-7/16
GLA72A	3/4	1	1-7/16	2-5/8
GLA124A	1	3/4	1-13/16	2-3/4

ASME®/ANSI® B107.10



GLAS1F



Ratchet Adaptor, Chrome (3/4")

Stock No.	Description	Gear Teeth	Gear Action	A	B
L672B	Ratchet Adaptor	44	8.2°	2-1/2	3-15/16

ASME®/ANSI® B107.10



L672B



FLANK DRIVE® SOCKETS



411LDH

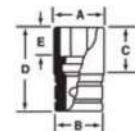

Shallow, Inches, Chrome

3/4	12	A	B	C	D	E	12	12
3/4	LDH242	1-1/8	1-7/16	1-9/32	2-9/32	39/64		•
13/16	LDH262	1-7/32	1-7/16	1-9/32	2-9/32	21/32		
7/8	LDH282	1-5/16	1-7/16	1-9/32	2-9/32	23/32		•
15/16	LDH302	1-3/8	1-7/16	1-9/32	2-9/32	47/64		•
31/32	LDH312	1-25/64	1-7/16	1-9/32	2-9/32	43/64		•
1	LDH322	1-1/2	1-7/16	1-9/32	2-9/32	3/4		•
1-1/16	LDH342	1-9/16	1-1/2	1-11/32	2-9/32	49/64		•
1-1/8	LDH362	1-5/8	1-37/64	1-9/32	2-9/32	51/64		•
1-3/16	LDH382	1-11/16	1-41/64	1-9/32	2-9/32	27/32		•
1-1/4	LDH402	1-3/4	1-45/64	1-1/4	2-9/32	27/32		•
1-5/16	LDH422A	1-7/8	1-27/32	1-9/32	2-3/8	55/64		•
1-5/16	LDH442	1-61/64	1-3/4	1-9/16	2-1/2	29/32		•
1-7/16	LDH462	2-1/8	1-3/4	1-9/16	2-1/2	31/32		•
1-1/2	LDH482	2-1/8	1-3/4	1-9/16	2-1/2	1-1/64		•
1-9/16	LDH502	2-3/16	1-3/4	1-9/16	2-1/2	1-5/32	•	
1-5/8	LDH522	2-1/4	1-3/4	1-19/32	2-1/2	1-5/32	•	
1-11/16	LDH542	2-25/64	1-3/4	1-13/16	2-3/4	1-3/16	•	
1-3/4	LDH562	2-7/16	1-3/4	1-13/16	2-3/4	1-7/32	•	
1-13/16	LDH582	2-1/2	1-3/4	1-13/16	2-3/4	1-1/4	•	
1-7/8	LDH602	2-9/16	1-3/4	2-1/16	3	1-19/64	•	
2	LDH642	2-3/4	1-3/4	2-5/16	3-1/4	1-19/64	•	
2-1/16	LDH662	2-3/4	1-3/4	2-1/16	3	1-3/8		
2-1/8	LDH682	2-61/64	1-3/4	2-5/16	3-1/4	1-7/16		
2-3/16	LDH702	2-15/16	1-3/4	2-5/16	3-1/4	1-1/2		
2-1/4	LDH722	3-1/8	1-3/4	2-9/16	3-1/2	1-1/2		
2-3/8	LDH762	3-1/4	1-3/4	2-13/16	3-3/4	1-3/4		

Sets include storage tray

ASME®/ANSI® B107.1



- Do not use "cheater bars" on handles.
- Do not use sockets with impact drivers. Do not exceed torque stamped on adaptor.
- Do not use chrome or industrial finish hand tools with power drivers or impact drivers.
- Read Safety Precautions on pages W1-W4

FLANK DRIVE® SOCKETS



LDHM222

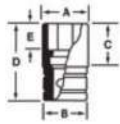

Shallow, mm, Chrome

mm	12	A	B	C	D	E
22	LDHM222	31.1	34.6	30.2	50.8	17.1
24	LDHM242	33.4	34.6	31.8	50.8	17.9
27	LDHM272	37.3	39.5	31.8	54.0	19.9
30	LDHM302	41.0	39.8	34.0	57.2	21.8
36	LDHM362	49.3	41.2	35.1	58.7	22.1

ASME®/ANSI® B107.5



LS342

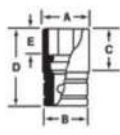

Deep, Inches, Chrome

1-1/16	6	A	B	C	D	E
1-1/16	LS342	1-9/16	1-1/2	2-3/4	3-1/2	1

SPLINE SOCKETS

Snap-on® spline wrenching tools have been developed to service high-tensile strength spline nuts and bolts widely used on both military and commercial aircraft. Precise radial spline teeth engage the fastener teeth over a wider area to minimize stress, and allow application of high torque to reduce risk of damage to the fastener or to the tool.

Chrome tools comply with Military Spec. MS-33787 and MIL-W-8982. The unique spline wrenching configuration can also be used on ordinary 6- and 12-point fasteners with an advantage similar to the Snap-on® Flank Drive® wrenching system.



LES242B

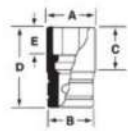

3/4" Drive Shallow, Inches, Chrome

	II	Stock No.	A	B	C	D	E
#24	3/4	LES242B	1-1/16	1-3/8	1-25/32	1-25/32	5/8
#26	13/16	LES262B	1-5/32	1-3/8	13/16	1-25/32	21/32
#28	7/8	LES282B*	1-9/32	1-3/8	7/8	1-27/32	23/32
#30	15/16	LES302B*	1-3/8	1-3/8	15/16	1-29/32	25/32
#32	1	LES322B	1-15/32	1-15/32	1	1-31/32	13/16
#34	1-1/16	LES342B*	1-9/16	1-9/16	1-1/16	2-1/32	7/8
#36	1-1/8	LES362B	1-21/32	1-1/2	1-3/16	2-3/16	15/16

*Not AS954 Compliant

SPECIAL APPLICATION SOCKETS



GLD138

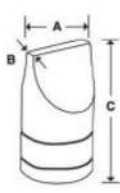

Drag Link Sockets, Industrial

Stock No.	B x A	A	B	C
GLD138	13/64 x 1-3/8	1-3/8 (35)	13/64	2-3/16
GLD139	1/4 x 1-11/16	1-11/16 (43)	1/4	2-3/16

TORX®/Standard, Industrial (3/4")

#	Stock No.	A	B	C
T60	T602E	4-31/32	2-13/16	1-5/8
T80	T802E	4-3/8	2-13/64	1-5/8
T90	T902E	4-3/8	2-13/64	1-5/8

T602E

Hex/Standard (Impact), mm (3/4")

mm		A	B	C
17	LAWM17E	104.9	49.5	41.1
19	LAWM19E	112	56.6	41.1

LAWM17E

Hex/Standard (Impact), inches (3/4")

		A	B	C
5/8	LAW120E	3-3/4	1-39/64	1-5/8
3/4	LAW124E	4-3/8	2-7/32	1-5/8

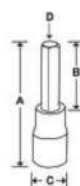
LAW120E

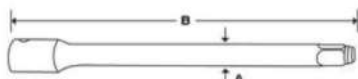
IMPACT ACCESSORIES

IM122B

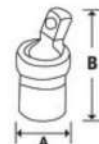
Extensions (Impact)

Stock No.	A	B
IM132A	1	3
IM62B	1	7
IM92B	1	10
IM122B	1	13

IP82

Swivel Ball Universal Joint (Impact)

- Maximum accessibility design
- No internal spring used

Stock No.	A	B
IP82	1-3/4	3-5/32

IM124B

Square Drive Adaptors (Impact)

Stock No.	A	B	C	D
IM72	3/4	1 with Pin Hole	1-5/8	2-9/16
IM124B	1	3/4 with Pin Hole	2-3/8	2-13/16

IM243P
3/4" Drive Locking Rings and Pins

Stock No.	Description	Use with
IM182R	Rubber Locking Ring	All 3/4" Drive Sockets/Accessories
IM182P	Steel Locking Pin	All 3/4" Drive Sockets/Accessories
IMR2	Socket Retainer	All 3/4" Drive Sockets/Accessories
IM243R	Synthetic Rubber Locking Ring	1" Drive Sockets/Accessories up to 1-3/8" (35 mm) Plus IM124 Adaptor
Use the following for the IM124B Adaptor:		
IM243P	Steel Locking Pin	1" Drive Sockets/Accessories up to 1-3/8" (35 mm)

For use on SIM, IM, IMM and SIMM sockets and other accessories.



- Wear safety goggles while using impact drivers.
- Do not hold swivel joint during use.
- Do not use chrome or industrial finish hand tools with power drivers.
- Read Safety Precautions on pages W1-W4

FLANK DRIVE® IMPACT SOCKETS



IMM302



Shallow, mm

Set Contains: **425IMM**

mm	6	12	A	B	C	D	E	6
17	IMM172A	—	29.2	41.1	27.2	50.8	13.7	•
18	IMM182A	—	31.6	41.1	27.2	50.8	12.7	•
19	IMM192A	IMMD192A	31.8	41.1	27.2	50.8	13.7	•
20	IMM202A	IMMD202B	35.1	41.1	27.2	50.8	14.0	•
21	IMM212A	IMMD212	34.9	41.1	27.2	50.8	15.2	•
22	IMM222A	IMMD222A	38.1	41.1	27.2	50.8	15.2	•
23	IMM232A	IMMD232	36.3	41.1	27.2	50.8	16.5	•
24	IMM242A	IMMD242A	39.5	41.1	26.4	50.8	16.5	•
25	IMM252A	IMMD252	39.6	41.1	26.4	50.8	16.3	•
26	IMM262A	IMMD262	39.6	41.1	26.4	50.8	17.5	•
27	IMM272A	IMMD272A	42.6	41.1	26.4	50.8	19.0	•
28	IMM282A	IMMD282	44.7	41.1	32.8	57.2	17.5	•
29	IMM292	IMMD292	46.0	41.1	32.8	57.2	18.0	•
30	IMM302	IMMD302A	47.0	44.5	32.8	57.2	19.1	•
31	IMM312	IMMD312A	49.2	44.5	32.8	57.2	19.1	•
32	IMM322	IMMD322A	50.8	44.5	32.8	57.2	20.6	•
33	IMM332A	IMMD332	50.8	44.5	32.8	57.2	20.3	•
34	IMM342	IMMD342	50.8	44.5	32.8	57.2	22.4	•
35	IMM352	IMMD352	54.0	44.5	32.8	57.2	22.4	•
36	IMM362	IMMD362	54.0	44.5	32.8	57.2	22.4	•
38	IMM382	IMMD382	57.2	44.5	32.8	57.2	23.9	•
40	IMM402	IMMD402	59.7	44.5	45.5	69.9	28.4	•
41	IMM412	IMMD412	60.5	44.5	33.5	57.2	26.2	•
42	IMM422A	IMMD422	63.1	44.5	46.9	66.9	28.6	•
46	IMM462	IMMD462	66.7	44.5	45.5	69.9	29.0	•
50	IMM502	IMMD502	71.4	44.5	52.6	76.2	31.0	•

Set comes with clips and rails.
ASME®/ANSI® 107.33M

IMMD202B 3/4" Drive 12-Point Metric 20 mm Flank Drive® Shallow Impact Socket

- Specific applications include removing the head bolts on Caterpillar® C7, C8, C9 and C10 engines



IM402



IMD302A

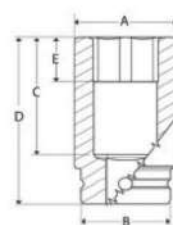

Shallow, inches

11	6	12	A	B	C	D	E	Set Contains:					
								429IM	417IM	418IM	429IMD	417IMD	418IMD
11	6	12						6	6	6	12	12	12
9/16	IM182A	IMD182A	1	1-5/8	1	1-3/4	7/16	•			•		
5/8	IM202A	IMD202A*	1-3/32	1-5/8	1	1-3/4	1/2	•			•		
11/16	IM222A	IMD222A	1-5/32	1-5/8	1	1-3/4	9/16	•			•		
3/4	IM242A	IMD242A	1-1/4	1-5/8	1	1-3/4	9/16	•	•		•	•	
13/16	IM262A	IMD262A	1-3/8	1-5/8	1-1/8	1-7/8	5/8	•	•		•	•	
7/8	IM282A	IMD282A	1-1/2	1-5/8	1-1/8	1-7/8	5/8	•	•		•	•	
15/16	IM302A	IMD302A*	1-9/16	1-5/8	1-1/8	1-7/8	3/4	•	•		•	•	
1	IM322A	IMD322A*	1-5/8	1-5/8	1-1/4	2	3/4	•	•		•	•	
1-1/16	IM342A	IMD342A	1-11/16	1-5/8	1-1/4	2	3/4	•	•		•	•	
1-1/8	IM362	IMD362A	1-7/8	1-5/8	1-3/8	2-1/8	3/4	•	•		•	•	
1-3/16	IM382	IMD382	1-7/8	1-5/8	1-5/16	2-1/8	3/4	•	•		•	•	
1-1/4	IM402	IMD402	2	1-3/4	1-3/8	2-1/8	13/16	•	•	•	•	•	•
1-5/16	IM422	IMD422	2-1/8	1-3/4	1-1/2	2-1/4	7/8	•	•	•	•	•	•
1-3/8	IM442	IMD442	2-1/8	1-3/4	1-1/2	2-1/4	7/8	•	•	•	•	•	•
1-7/16	IM462	IMD462	2-1/4	1-3/4	1-1/2	2-1/4	7/8	•	•	•	•	•	•
1-1/2	IM482	IMD482	2-1/4	1-3/4	1-1/2	2-1/4	15/16	•	•	•	•	•	•
1-9/16	IM502	IMD502	2-7/16	1-3/4	1-9/16	2-3/8	15/16	•	•	•	•	•	•
1-5/8	IM522	IMD522	2-7/16	1-3/4	1-5/8	2-3/8	7/8	•	•	•	•	•	•
1-11/16	IM542	IMD542	2-1/2	1-3/4	1-13/16	2-9/16	1	•	•	•	•	•	•
1-3/4	IM562	IMD562	2-1/2	1-3/4	1-13/16	2-9/16	1	•	•	•	•	•	•
1-13/16	IM582	IMD582	2-5/8	1-3/4	1-5/8	2-5/8	1-1/4	•		•	•	•	•
1-7/8	IM602	IMD602	2-5/8	1-3/4	1-3/4	2-3/4	1-1/8	•		•	•	•	•
1-15/16	IM622A	IMD622	2-3/4	1-3/4	1-9/16	2-27/32	1-3/32	•		•	•	•	•
2	IM642A	IMD642	2-7/8	1-3/4	1-15/16	2-7/8	1-1/8	•		•	•	•	•
2-1/16	IM662A	IMD662	3	1-3/4	1-7/8	2-7/8	1-3/16	•		•	•	•	•
2-1/8	IM682A	IMD682	3	1-3/4	1-3/4	3	1-1/4	•		•	•	•	•
2-3/16	IM702A	IMD702	3-1/4	1-3/4	2-3/16	3-3/16	1-5/16	•		•	•	•	•
2-1/4	IM722A	IMD722	3-1/4	1-3/4	2-3/16	3-3/16	1-3/8	•		•	•	•	•
2-3/8	IM762A	IMD762	3-1/2	1-3/4	2-3/8	3-1/2	1-7/16	•		•	•	•	•

*Applications include repair of heavy-duty trucks and off-road equipment, most diesel engines including Caterpillar® and Cummins® plus head bolts and bearing cap bolts. Set comes with clips and rails. ASME®/ANSI® 107.2

IMD242A 3/4" Drive 12-Point SAE 3/4" Flank Drive® Shallow Impact Socket

- Applications include most Caterpillar® head bolts, Detroit Diesel® main bearing cap bolts, K19 Cummins® head bolts

Shallow, 8-Point, inches

11	8	A	B	C	D	E
13/16	IMDS626	1-15/32	1-5/8	1-1/64	2-1/4	17/32
7/8	IMDS628	1-9/16	1-5/8	1-1/64	2-1/4	37/64
15/16	IMDS630	1-43/64	1-5/8	1-9/16	2-1/4	39/64
1	IMDS632	1-49/64	1-5/8	1-1/2	2-1/4	41/64
1-1/16	IMDS634	1-55/64	1-3/4	1-13/16	2-1/2	11/16
1-1/8	IMDS636	1-15/16	1-3/4	1-13/16	2-1/2	23/32
1-3/16	IMDS638	2-1/32	1-3/4	1-13/16	2-1/2	3/4
1-1/4	IMDS640	2-1/8	1-3/4	1-13/16	2-1/2	51/64
1-5/16	IMDS642	2-7/32	1-3/4	2-1/16	2-3/4	57/64
1-7/16	IMDS646	2-3/8	1-3/4	2-1/16	2-3/4	1-9/64



IMDS636

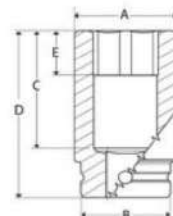

• Read Safety Precautions on pages W1-W4

FLANK DRIVE® IMPACT SOCKETS

3/4" DRIVE TOOLS

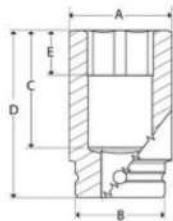

Deep, mm

mm	6	A	B	C	D	E
17	SIMM172	28.9	41.1	52.6	76.2	12.7
18	SIMM182	31.7	41.3	76.2	101.6	12.7
19	SIMM192	32.4	41.1	51.8	76.2	14.2
20	SIMM202	33.5	41.1	19.1	76.2	14.2
21	SIMM212	34.2	41.1	37.4	76.2	14.2
22	SIMM222	35.8	41.1	37.4	76.2	14.2
23	SIMM232	35.8	41.1	37.2	76.2	16.3
24	SIMM242	37.7	41.1	37.0	76.2	16.5
25	SIMM252	34.6	41.1	19.1	76.2	16.3
26	SIMM262	39.6	41.1	36.7	76.2	16.3
27	SIMM272	42.8	41.1	38.4	76.2	19.1
30	SIMM302	46.8	41.1	58.2	82.6	18.5
31	SIMM312	46.0	41.1	64.3	82.6	19.1
32	SIMM322	50.8	44.5	58.9	82.6	19.1
33	SIMM332	52.4	44.5	57.4	82.6	22.4
35	SIMM352	52.7	44.5	57.2	82.6	21.6
36	SIMM362	54.0	44.5	62.5	88.9	22.9
38	SIMM382	57.2	44.5	65.3	88.9	23.8
41	SIMM412	55.1	44.5	74.9	100.1	26.7
41	SIMM432	63.5	44.5	70.0	89	26.7
46	SIMM462	76.7	44.5	72.4	101.6	29.1
46	SIMM462A	65.9	44.5	73.9	95.3	28.4



SIMM212



SIMDM212

*Applications include usage on stud piloted, budd style wheels.

ASME®/ANSI® B107.33M

SIMDM212 3/4" Drive 12-Point Metric 21 mm Flank Drive® Deep Impact Socket

- Applications include flywheel bolts on Cummins® ISX engines



423SIM

Set Contains:

423SIM

Deep, inches

II	6	A	B	C	D	E	6
9/16	SIM182	1	1-5/8	2-1/16	3	9/16	•
5/8	SIM202	1-1/16	1-5/8	2-1/16	3	9/16	•
11/16	SIM222	1-1/8	1-5/8	2-1/16	3	9/16	•
3/4	SIM242	1-1/4	1-5/8	2	3	9/16	•
13/16	SIM262	1-3/8	1-5/8	2	3	5/8	•
7/8	SIM282	1-1/2	1-5/8	2	3	5/8	•
15/16	SIM302	1-5/8	1-5/8	2	3	5/8	•
1	SIM322	1-5/8	1-5/8	2	3	11/16	•
1-1/16	SIM342	1-3/4	1-5/8	2	3	11/16	•
1-1/8	SIM362	1-3/4	1-5/8	2	3	3/4	•
1-3/16	SIM382	2	1-3/4	2-1/4	3-1/4	3/4	•
1-1/4	SIM402	2	1-3/4	2-1/4	3-1/4	7/8	•
1-5/16	SIM422	2-1/8	1-3/4	2-9/16	3-1/4	7/8	•
1-3/8	SIM442	2-1/8	1-3/4	2-1/4	3-1/4	7/8	•
1-7/16	SIM462	2-3/16	1-3/4	2-1/2	3-1/2	7/8	•
1-1/2	SIM482	2-1/4	1-3/4	2-1/2	3-1/2	15/16	•
1-9/16	SIM502	2-5/16	1-3/4	2-1/2	3-1/2	15/16	•
1-5/8	SIM522	2-7/16	1-3/4	2-1/2	3-1/2	15/16	•
1-11/16	SIM542	2-1/2	1-3/4	2-1/2	3-1/2	1	•
1-3/4	SIM562	2-1/2	1-3/4	2-1/2	3-1/2	1	•
1-13/16	SIM582	2-5/8	1-3/4	2-3/4	3-3/4	1-1/16	•
1-7/8	SIM602	2-11/16	1-3/4	2-3/4	3-3/4	1-1/8	•
2	SIM642A	2-13/16	1-3/4	2-3/4	3-3/4	1-1/8	•

Set comes with clips and rails.
Larger sizes available on special order.

ASME®/ANSI® B107.2

SIMD242 3/4" Drive 12-Point SAE 3/4" Flank Drive® Deep Impact Socket

SIMD342 3/4" Drive 12-Point SAE 1-1/16" Flank Drive® Deep Impact Socket

- Snap-on® impact sockets are heat-treated to optimize impact service life with a lower hardness than hand sockets and are able to withstand repeated cycling loads of impact wrenches
- Snap-on uses a proprietary blend of special alloy socket steel that provides long life and great strength
- Flank Drive® wrenching system delivers up to 20% more turning power without slipping or rounding while exceeding ANSI® performance standards

Shallow Thin Wall, mm

mm	6	A	B	C	D	E
50	IMM503TW	65	57.2	49	82.6	34.8



IMM503TW

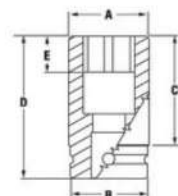

Shallow/Thin Wall, inches

1 1/2	6	A	B	C	D	E
1-1/2	IMFS482A	54	44.4	36.6	63.5	24.1

ASME®/ANSI® B107.5m



IMFS482A

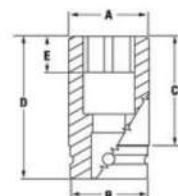

Deep/Thin Wall, inches

3/4	12	A	B	C	D	E
3/4	IMFDL242	1-3/8	1-5/8	4-3/4	5-3/4	1/2

ASME®/ANSI® B107.5m



IMFDL242

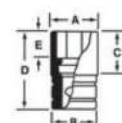

IMFDL242 3/4" Drive 12-Point SAE 3/4" Flank Drive® Deep Thin Wall Impact Socket

- Designed to remove the head bolts on Caterpillar® C12, C15, C16 and 3406E where the front two and back two head bolts are positioned under the valve covers
- Applications on certain Caterpillar® head bolts require a thin walled socket of a certain length
- Additional applications include Detroit Diesel® main bearing cap bolts and 19 mm head bolts on Mercedes-Benz® MBE904/MBE906 EGR engines (2007-later)
- Snap-on® impact sockets are heat-treated to optimize impact service life with a lower hardness than hand sockets and are able to withstand repeated cycling loads of impact wrenches
- Flank Drive® wrenching system delivers up to 20% more turning power without slipping or rounding, while exceeding ANSI® performance standards

Inverted TORX®



IMSLE242A

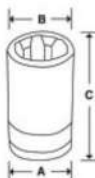

#	Stock No.	A	B	C
E24	IMSLE242A	1-5/8	1-5/8	3-3/4

IMSLE242A 3/4" Drive E24 Inverted TORX® Impact Socket

- Applications include removal and installation of head bolts on MaxxForce® 11 and 13 engines found on D15 International® (2010-current)

Double Hex, mm



SIMDML202

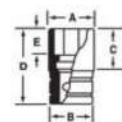

mm	Stock No.	A	B	C	D	E
20	SIMDML202	35	38.1	120.6	146	13.9

SIMDML202 3/4" Drive 20 mm Double Hex Impact Socket

- For use on CAT® C7 cylinder head bolts, found mostly in CAT® earth moving machinery

Pipe Plug, inches

PPM624 3/4" Drive SAE 3/4" Internal Final Drive Pipe Plug Socket

- Designed for final drive drain plugs on Caterpillar® D8 dozers as well as Komatsu® WA500 wheel loaders and 275, 375 and 475 dozers



PPM624

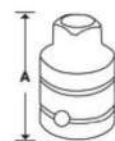

• Read Safety Precautions on pages W1-W4

GENERAL SERVICE SETS

3/4" DRIVE TOOLS



434HDC



414AHD

**SAE General Service Set
434HDC 35 pc 3/4" Drive 12-Point**
• 35 Tools

	12-Point Shallow Socket
3/4	LDH242
13/16	LDH262
7/8	LDH282
15/16	LDH302
31/32	LDH312
1	LDH322
1-1/16	LDH342
1-1/8	LDH362
1-3/16	LDH382
1-1/4	LDH402
1-5/16	LDH422A
1-5/16	LDH442
1-7/16	LDH462
1-1/2	LDH482
1-9/16	LDH502
1-5/8	LDH522
1-11/16	LDH542
1-3/4	LDH562
1-13/16	LDH582
1-7/8	LDH602
2	LDH642
2-1/16	LDH662
2-1/8	LDH682
2-3/16	LDH702
2-1/4	LDH722
2-3/8	LDH762

ASME®/ANSI® B107.1

Also Includes:	Stock No.	Description
	L32	3/4" Drive 3" Locking Button Extension
	L62	3/4" Drive 8" Locking Button Extension
	L122	3/4" Drive 16" Locking Button Extension
	L52B	3/4" Drive 2-5/16" Head Depth Sliding T-Handle Head
	L872	3/4" Drive Sealed Head Ratchet
	L82A	3/4" Drive 3-7/8" Friction Ball Universal Joint
	L8112A	3/4" Drive 15/16" Breaker Bar Head
	L672B	3/4" Drive Ratchet Adaptor
	L872H	3/4" Drive 19-1/4" Plain Locking Button Handle
	PB434HD	Storage Case with Foam

ASME®/ANSI® B107.10

**SAE Shallow General Service Socket Set
414AHD 15 pc 3/4" Drive 12-Point**

	12-Point Shallow Socket
1-1/16	LDH342
1-1/8	LDH362
1-1/4	LDH402
1-5/16	LDH422A
1-5/16	LDH442
1-7/16	LDH462
1-1/2	LDH482
1-5/8	LDH522
1-3/4	LDH562
1-7/8	LDH602

Also Includes:	Stock No.	Description
	L32	3/4" Drive 3" Locking Button Extension
	L122	3/4" Drive 16" Locking Button Extension
	L872	3/4" Drive Sealed Head Ratchet
	L872RJ	3/4" Drive 19-1/4" Knurled Locking Button Handle
	L8112A	3/4" Drive 15/16" Breaker Bar Head

ASME®/ANSI® B107.10