



Torque Wrench



Mechanical Torque Wrench

85-86



G-series Big Spec. Torque Wrench

86



G-series Industrial Torque Wrench

88



Electronic Torque Wrench

87



Torque Multiplier

91-93

Torque Wrench

Torque Tester



- Reading accuracy of +/-1%, with two decimal places and one decimal place for 96473 and 96474 respectively
- Mini USB charger (with 5V/1A charger as standard configuration) for use along or with a computer for good portability and suitable for daily rapid detection of two-way communication between WiFi and USB serial port in workshop and production line
- Communication standard of WiFi module of 2.4G 802.11 b/g/n, with maximum WiFi transmission distance of 30m
- Computer software (Windows system) provided for writing the device setting value and other information and reading the torque value of the device
- Test report to be exported with one click, suitable for calibration in laboratory/measuring room
- Preset torque value and qualified accuracy percentage of torque set through the software interface or buttons at the back of the device (factory default is 3%)
- Capable of tracking and capturing peak torque (the first peak), and automatically determining whether it is OK or not (LED lamp in green if OK, otherwise in red with beeping sound)

No.	Spec. N-m	Reading Accuracy	Edge-to-Edge Size of Active Tip			
96473	2-50	+/-1%	11mm	-	4	16.3
96474	9-320	+/-1%	19mm	-	4	16.3

▲ Product with warranty of 12 months and accessories with warranty of 6 months.

96211 1/4" Dr. Adjustable Torque Wrench 1-5N-m



- New drop-shaped ratchet for operation with one hand
- Positive accuracy +/-3%
- Aluminum alloy knurled handle, effectively prevent skidding
- Pull-down locking structure, facilitating torque adjustment

No.	Torsion Range(Nm)	Driving Head	L(mm)	Indexing (N-m)			
96211	1-5	1/4"	224	0.1	-	10	9.8

▲ Note: When the torque exceeds the specified range, the measured torque can only be used for reference, and the forward +/-3% accuracy cannot be guaranteed. The torque wrench is a precision instrument and is not covered by SATA lifetime warranty. Please refer to the instructions for detailed instructions on how to use the products and services.

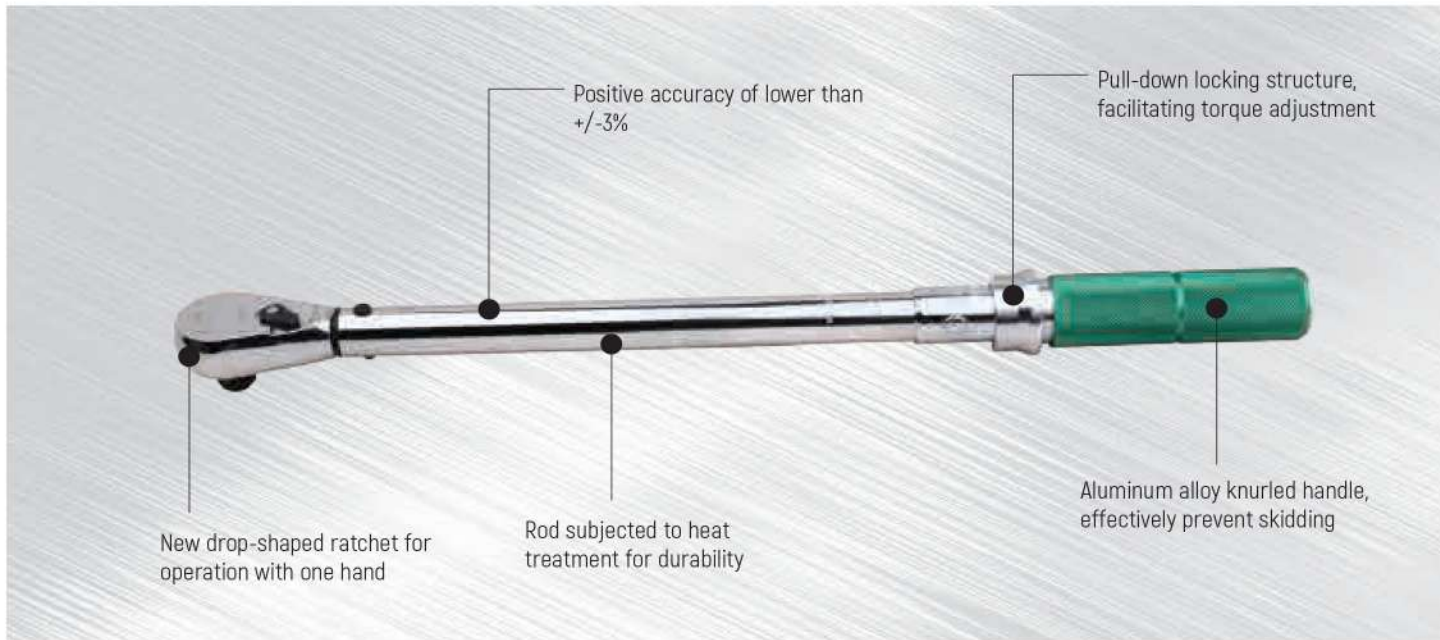

Warranty for torsion wrenches

- Warranty of 90 days (180 days for G series) from the purchase date (as per invoice date). Parts can be repaired or replaced free of charge due to damage caused by materials and processes.
- The premise of free repair or replacement of parts is: The part is within the warranty of 90 days from the purchase date (based on the invoice date) (180 days for G series) with operation times of less than 5000 and accuracy exceeding +/-3% tested by the third-party torque testing instrument;
- Parts are not covered by the warranty if they are damaged or their accuracy exceed +/-3% due to misuse, abuse, accident or non-normal use without following precautions;
- Products are not covered by the warranty if they are repaired by any maintenance agency not authorized by SATA.



3/8" Dr. Adjustable Torque Wrench

3/4" Dr. Adjustable Torque Wrench



96212



96310



96411



96412

- New drop-shaped ratchet for operation with one hand
- Positive accuracy +/-3%
- Aluminum alloy knurled handle, effectively prevent skidding
- Pull-down locking structure, facilitating torque adjustment

- Product subjected to adjustment and test before delivery +/-3% clockwise accuracy guaranteed

No.	Torsion Range(Nm)	Driving Head	L(mm)	Indexing (N-m)			
96212	5-25	3/8"	268	0.1	-	6	10.2
96310	10-50	3/8"	426	0.5	-	10	17.2

No.	Torsion Range(Nm)	Driving Head	L(mm)	Indexing(N-m)			
96411	110-550	3/4"	864	2.5	-	1	6.7
96412	160-800	3/4"	1075	2.5	-	1	7.3

▲ Note: When the torque exceeds the specified range, the measured torque can only be used for reference, and the forward +/-3% accuracy cannot be guaranteed. The torque wrench is a precision instrument and is not covered by SATA lifetime warranty. Please refer to the instructions for detailed instructions on how to use the products and services.

▲ Note: When the torque exceeds the specified range, the measured torque can only be used for reference, and the forward +/-3% accuracy cannot be guaranteed. The torque wrench is a precision instrument and is not covered by SATA lifetime warranty. Please refer to the instructions for detailed instructions on how to use the products and services.

1/2" Dr. Adjustable Torque Wrench

1" Dr. Adjustable Torque Wrench



96311



96312



96313



96431

96433

- New drop-shaped ratchet for operation with one hand
- Positive accuracy +/-3%
- Aluminum alloy knurled handle, effectively prevent skidding
- Pull-down locking structure, facilitating torque adjustment

- Imported with original packaging from Italy
- Driving head can be pushed up for reverse operation
- Handle with open-welded structure, facilitating adjustment, calibration and maintenance
- Torque accuracy +/-4%
- Applicable for large equipment installation and maintenance in such fields as machinery manufacturing, rail transit, petrochemical, metallurgy and other industries

No.	Torsion Range(Nm)	Driving Head	L(mm)	Indexing(N-m)			
96311	20-100	1/2"	473	0.5	-	10	17.2
96312	40-200	1/2"	555	1	-	10	18.9
96313	68-340	1/2"	616	2	-	10	21.8

No.	Driving Head (in.)	Torsion Range (N.m)	Torsion Range (lbf.ft)	Total Length (mm)	Indexing (N-m)	Weight (kg)			
96431	1"	200-1000	150-750	1030	25	9.7	-	1	13.8
96433	1"	500-2000	350-1500	1400	50	18	-	1	22.8

▲ Note: When the torque exceeds the specified range, the measured torque can only be used for reference, and the forward +/-3% accuracy cannot be guaranteed. The torque wrench is a precision instrument and is not covered by SATA lifetime warranty. Please refer to the instructions for detailed instructions on how to use the products and services.

Preset Torque Wrench

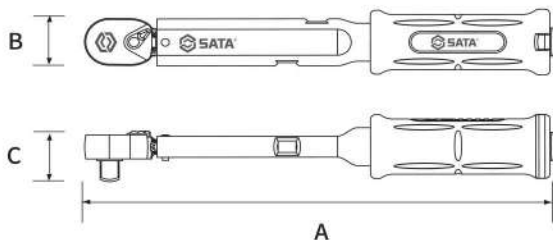

- No torque value scale and adjustment mechanism are provided for the Pre-Set Torque Wrench. Only special tools can be used to set and change the torque value of the product.
- Internal tripping mechanism with imported high-precision spring for accuracy and durability
- When reaching the torque set value, the internal device sends out the sound of 'click' with vibration. At this time, stop operation immediately to prevent overtightening.
- It can be used in both directions, but only in the forward (clockwise) direction can the torque value be set.
- Ratchet with 36 teeth with operating angle for each tooth of 10°, suitable for use in narrow space
- Meeting ISO 6789-2004 standard

Torque adjustment tools:

- T15 Torx® wrenches with tamper for 96241, 96242 and 96243
- T25 Torx® wrenches with tamper for 96244 and 96245

No.	Torsion Adjustment Range(N.m)	Driving Head(M) Spec.	Total Length A(mm)	Tip Height B(mm)	Tip Height C(mm)	Weight (kg)			
96241	1-5	1/4"	190	25	21	0.2	-	10	4.5
96242	5-25	3/8"	215	25	25	0.22	-	10	4.8
96243	10-50	3/8"	235	25	25	0.37	-	10	6.2
96244	20-100	1/2"	315	32	34	0.63	-	10	9.6
96245	40-200	1/2"	463	32	34	1.15	-	10	16.2

- ▲ 1. Default torque of the fixed torque wrench is 0 N.m.
 2. Torque can be set according to user's requirement, but the delivery date will be extended. [For details, please contact the local sales staff or call SATA service hotline for consultation.]

Electronic Torque Wrench



- Output torque accuracy up to +/-1.5% (forward) and +/-2% (reverse)
- Three types of prompts available: indicator light, buzzer and vibrator
- Available torque units: n-m/bf-ft/lbf-in/kgf-m/kgf-cm

No.	Driving Head (in.)	Torsion Range (N.m)	Torsion Range (lbf.ft)	Total Length (mm)	Indexing (N-m)	Weight (g)			
96525	3/8	27-135	19.9-99.6	400	0.1	980	-	8	11.5
96526	1/2	40-200	29.5-147	550	0.1	1080	-	6	10
96527	1/2	68-340	50-250.9	628	0.1	1380	-	6	12
96528	3/4	120-600	88.5-443	1248	0.1	5940	-	1	8.7
96529	3/4	160-800	118-590	1248	0.1	5940	-	1	8.7
96530	3/4	200-1000	147.5-738	1248	1	5940	-	1	8.7
96531	11	300-1500	221.2-1106	1248	1	6100	-	1	8.9
96532	3/4	400-2000	295-1475	2000	1	12000	-	1	17.4

- ▲ This product is a precision instrument with warranty of 12 months /10000 times.

Interchangeable Torque Wrench



- Forged from quality Cr-V square joint with chrome-plated surface
- Rod subjected to heat treatment for durability and anti-deformation
- Pull-down clasp for torque adjustment for efficiency and convenience
- Anodized and knurled handle made of aluminum alloy, being artistic and elegant
- Applicable to square socket wrench heads with 9*12mm and 14*18mm interfaces below

No.	Connector Size (mm)	Torsion Range (N.m)	Total Length (mm)	Indexing (N-m)	Accuracy	Weight (g)			
96221	9*12	1-5	210	0.1	3%	300	-	16	8.8
96222	9*12	5-25	250	0.1	3%	330	-	16	9.4
96321	9*12	20-100	424	0.5	3%	1020	-	10	14.3
96322	14*18	40-200	530	1	3%	1390	-	10	16.8
96323	14*18	68-340	591	2	3%	1460	-	10	19.7

- ▲ This product is a precision instrument with warranty of 90 days /5000 times.



G Series Adjustable Torque Wrench

G Series Interchangeable Torque Wrench



No.	Driving Head (in.)	Torsion Range (N.m)	Torsion Range (lbf.ft)	Total Length (mm)	Indexing (N-m)	Weight (g)			
96421	1/4	1-5	0.75-3.7	220	0.025	300	-	1	0.4
96422	1/4	5-25	3.7-18	285	0.1	450	-	1	0.6
96423	3/8	10-50	7.4-37	335	0.25	540	-	1	0.8
96424	1/2	20-100	15-75	395	0.5	900	-	1	1.2
96425	1/2	40-200	30-150	485	1	1100	-	1	1.5
96426	1/2	60-300	45-220	575	1	1400	-	1	1.6
96427	1/2	80-400	59-300	665	1	2000	-	1	2.1
96428	3/4	110-550	81-405	960	1	3800	-	1	4.1
96429	3/4	150-750	111-550	1240	1	4800	-	1	5.4
96430	3/4	250-850	184-630	1390	1	4700	-	1	5.8

▲ Excluded from lifetime warranty terms.

• Select wrench head according to the depth

No.	Tip Diameter (mm)	Adaptation Depth (mm)	Torsion Range (N-m)	Torsion Range (lbf.ft)	Total Length (mm)	Indexing (N-m)	Weight (g)			
96442	16	32	5-25	3.7-18	278.0	0.1	300	-	1	0.5
96443	16	32	10-50	7.4-37	328.0	0.25	450	-	1	0.6
96444	16	32	20-100	15-75	376.5	0.5	600	-	1	0.9
96445	16	32	40-200	30-150	467.5	1	800	-	1	1.1
96446	16	32	60-300	45-220	558.5	1	1200	-	1	1.4
96447	16	32	80-400	59-300	648.5	1	1500	-	1	1.9
96448	22	56	110-550	81-400	917.0	1	3800	-	1	3.5
96449	22	56	150-750	111-550	1198.0	1	4450	-	1	4.7

▲ Excluded from lifetime warranty terms.

Solid square drive torque wrench with ratchet for two-way operation



Heat-treated steel pipe for firmness and strength, sand-blasted surface subjected to chrome plating for corrosion resistance, with mature and stable mechanical structure

Chrome-plated one-way ratchet head for stability, long service life, reverse operation by just pulling it out

Magnified window presetting display for easy operation, with forward accuracy +/-3% and dual scale

Dual force prompt with "click" sound when force applied in noisy environment

Fine tuning window for more precise settings

Dial with readable double scale (N.m/lbf.ft) protected by lenses that function as magnifying glasses Torque settings read from the dial and more detailed dials read in conjunction with the dial ring

Locking button to avoid misoperation

Ergonomic and anti-skidding handle with rotary compression spring for lightness and labor-saving

Torque Wrench Open End Fitting

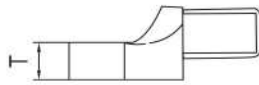
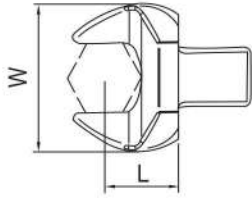

- Torque wrench head easy to change, suitable for narrow space with tight bolt connection
- Made of hot-forged Cr-V with chrome-plated surface
- Capable of bolt tripping

No.	Spec. (mm)	Connector (mm)	L(mm)	T(mm)	W(mm)	Weight (g)			
96621K	7	9×12	17.5	5.7	20.7	40	12	-	-
96622K	8	9×12	17.5	5.7	22.0	39	12	-	-
96623K	9	9×12	17.5	5.7	23.5	38	12	-	-
96624K	10	9×12	17.5	5.7	24.8	42	12	-	-
96625K	11	9×12	17.5	5.7	26.0	41	12	-	-
96626K	12	9×12	17.5	5.7	27.5	43	12	-	-
96627K	13	9×12	17.5	5.7	28.8	48	12	-	-
96628K	14	9×12	17.5	7.7	31.5	52	12	-	-
96629K	15	9×12	17.5	7.7	33.5	51	12	-	-
96630K	16	9×12	17.5	7.7	36.0	58	12	-	-
96631K	17	9×12	17.5	7.7	37.7	60	12	-	-
96632K	18	9×12	17.5	7.7	39.0	71	12	-	-
96633K	19	9×12	17.5	7.7	41.6	74	12	-	-
96655K	17	14×18	25	9	37.0	136	6	-	-
96656K	18	14×18	25	9	39.0	147	6	-	-
96657K	19	14×18	25	9	40.6	147	6	-	-
96659K	21	14×18	25	11	45.5	171	6	-	-
96660K	22	14×18	25	11	47.3	165	6	-	-
96662K	24	14×18	25	11	50.8	167	6	-	-
96665K	27	14×18	25	13.8	58.4	219	6	-	-
96668K	30	14×18	25	13.8	62.5	245	6	-	-
96670K	32	14×18	25	13.8	65.0	246	6	-	-

Torque Wrench Box End Fitting

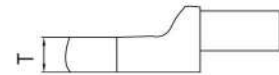
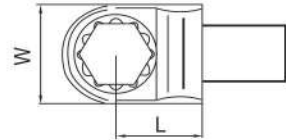

- Torque wrench head easy to change, suitable for narrow space with tight bolt connection
- Made of hot-forged Cr-V with chrome-plated surface
- Capable of bolt tripping

No.	Spec. (mm)	Connector (mm)	L(mm)	T(mm)	W(mm)	Weight (g)			
96621M	7	9×12	17.5	8	19.8	37	12	-	-
96622M	8	9×12	17.5	8	19.8	40	12	-	-
96623M	9	9×12	17.5	8	19.8	44	12	-	-
96624M	10	9×12	17.5	8	20	44	12	-	-
96625M	11	9×12	17.5	8	20	41	12	-	-
96626M	12	9×12	17.5	12	20.2	49	12	-	-
96627M	13	9×12	17.5	12	22.2	56	12	-	-
96628M	14	9×12	17.5	12	23.5	52	12	-	-
96629M	15	9×12	17.5	12	24.6	52	12	-	-
96630M	16	9×12	17.5	13	26.4	54	12	-	-
96631M	17	9×12	17.5	13	27.3	59	12	-	-
96632M	18	9×12	17.5	13	29	56	12	-	-
96633M	19	9×12	17.5	13	31	65	12	-	-
96635M	21	9×12	17.5	14.7	33.4	71	12	-	-
96636M	22	9×12	17.5	14.7	35	74	12	-	-
96655M	17	14×18	25	12.5	30.5	135	6	-	-
96656M	18	14×18	25	12.5	30.5	134	6	-	-
96657M	19	14×18	25	12.5	31	138	6	-	-
96659M	21	14×18	25	15	33.4	144	6	-	-
96660M	22	14×18	25	15	35.2	145	6	-	-
96662M	24	14×18	25	15	37.4	153	6	-	-
96665M	27	14×18	25	17.5	41.7	162	6	-	-
96668M	30	14×18	25	17.5	45.3	182	6	-	-
96670M	32	14×18	25	17.5	47.8	181	6	-	-



Torque Wrench Open Box End Fitting

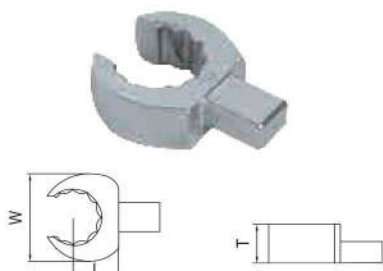

- Torque wrench head easy to change, suitable for narrow space with tight bolt connection
- Made of hot-forged Cr-V with chrome-plated surface
- Capable of bolt tripping

No.	Spec. (mm)	Connector (mm)	L(mm)	T(mm)	W(mm)	Weight (g)			
96710K	10	9×12	17.5	12	21.2	57	12	-	-
96711K	11	9×12	17.5	12	22.6	55	12	-	-
96712K	12	9×12	17.5	12	24.1	59	12	-	-
96713K	13	9×12	17.5	12	25.2	55	12	-	-
96714K	14	9×12	17.5	13	27.3	60	12	-	-
96716K	16	9×12	17.5	13	30.1	65	12	-	-
96717K	17	9×12	17.5	13	31.6	64	12	-	-
96718K	18	9×12	17.5	15	33.3	74	12	-	-
96719K	19	9×12	17.5	15	34.6	80	12	-	-
96721K	21	9×12	17.5	15	37.7	88	12	-	-
96722K	22	9×12	17.5	15	39.3	92	12	-	-

Torque Wrench Ratcheting Head

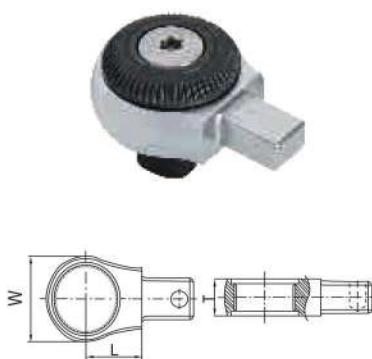

- Torque wrench head easy to change, suitable for narrow space with tight bolt connection
- Made of hot-forged Cr-V with chrome-plated surface
- Capable of bolt tripping

No.	Driving Head	Spec. (mm)	Connector (mm)	L (mm)	T (mm)	W (mm)	Weight (g)			
96572	1/4"	12	9×12	17.5	23	25	69	12	-	-
96573	3/8"	12	9×12	17.5	33	34	143	12	-	-
96574	1/2"	12	9×12	17.5	38	34	154	12	-	-
96575	1/2"	18	14×18	25	43	41	300	6	-	-

Torque Wrench Open End Fitting

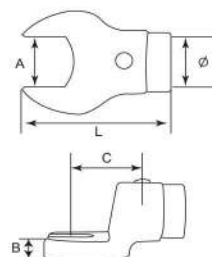

- Torque wrench head easy to change, suitable for narrow space with tight bolt connection
- Made of hot-forged Cr-V with chrome-plated surface
- Capable of bolt tripping

No.	Active Tip Width A(mm)	Active Tip Depth B(mm)	Depth C(mm)	Connector Φ(mm)	L (mm)	Weight (kg)			
96521K	7	5	32	16	54	0.08	1	-	-
96522K	8	5	32	16	54	0.08	1	-	-
96523K	9	5	32	16	58	0.08	1	-	-
96524K	10	7	32	16	58	0.09	1	-	-
96525K	11	7	32	16	58	0.09	1	-	-
96526K	12	7	32	16	55	0.09	1	-	-
96527K	13	8	32	16	58	0.12	1	-	-
96528K	14	8	32	16	58	0.12	1	-	-
96529K	15	8	32	16	58	0.12	1	-	-
96530K	16	9	32	16	58	0.16	1	-	-
96531K	17	9	32	16	58	0.16	1	-	-
96532K	18	9	32	16	58	0.16	1	-	-
96533K	19	10	32	16	63	0.18	1	-	-
96534K	20	10	32	16	63	0.18	1	-	-
96535K	21	10	32	16	63	0.18	1	-	-
96536K	22	11	32	16	63	0.22	1	-	-
96537K	24	11	32	16	64	0.22	1	-	-
96538K	27	12	32	16	66	0.26	1	-	-
96539K	30	12	32	16	66	0.3	1	-	-
96540K	32	12	32	16	66	0.3	1	-	-
96541K	36	12	32	16	65	0.3	1	-	-
96551K	22	11	56	22	90	0.33	1	-	-
96552K	24	11	56	22	90	0.32	1	-	-
96553K	27	12	56	22	93	0.38	1	-	-
96554K	30	12	56	22	93	0.37	1	-	-
96555K	32	12	56	22	98	0.45	1	-	-
96556K	34	12	56	22	98	0.43	1	-	-
96557K	36	12	56	22	96	0.43	1	-	-
96558K	41	12	56	22	103	0.58	1	-	-
96559K	46	12	56	22	103	0.53	1	-	-

▲ Excluded from lifetime warranty terms.

Torque Wrench Open End Fitting

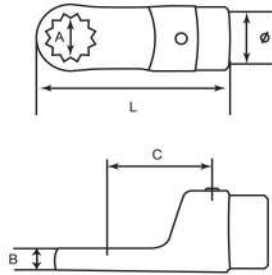

- Torque wrench head easy to change, suitable for narrow space with tight bolt connection
- Made of hot-forged Cr-V with chrome-plated surface
- Capable of bolt tripping

No.	Active Tip Width A(mm)	Active Tip Depth B(mm)	Depth C(mm)	Connector Φ(mm)	L (mm)	Weight (kg)			
96521M	7	8	32	16	58	0.09	1	-	-
96522M	8	8	32	16	58	0.09	1	-	-
96523M	9	8	32	16	58	0.09	1	-	-
96524M	10	10	32	16	58	0.1	1	-	-
96525M	11	10	32	16	60	0.1	1	-	-
96526M	12	10	32	16	60	0.1	1	-	-
96527M	13	12	32	16	62	0.14	1	-	-
96528M	14	12	32	16	62	0.14	1	-	-
96529M	15	12	32	16	62	0.14	1	-	-
96530M	16	13	32	16	65	0.18	1	-	-
96531M	17	13	32	16	65	0.18	1	-	-
96532M	18	13	32	16	65	0.18	1	-	-
96533M	19	14	32	16	65	0.21	1	-	-
96534M	20	14	32	16	65	0.21	1	-	-
96535M	21	14	32	16	66	0.21	1	-	-
96536M	22	15	32	16	66	0.26	1	-	-
96537M	24	15	32	16	70	0.26	1	-	-
96538M	27	16	32	16	70	0.3	1	-	-
96551M	22	15	56	22	70	0.35	1	-	-
96552M	24	15	56	22	93	0.33	1	-	-
96553M	27	17	56	22	93	0.37	1	-	-
96554M	30	17	56	22	101	0.35	1	-	-
96555M	32	20	56	22	101	0.42	1	-	-
96556M	34	20	56	22	105	0.42	1	-	-
96557M	36	20	56	22	105	0.39	1	-	-
96558M	41	22	56	22	112	0.56	1	-	-
96559M	46	22	56	22	112	0.52	1	-	-

▲ Excluded from lifetime warranty terms.

Torque Wrench Ratcheting Head

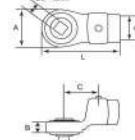

96562

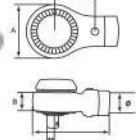

96563

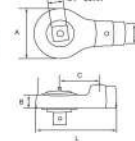

96564

- Torque wrench head easy to change, suitable for narrow space with tight bolt connection
- Made of hot-forged Cr-V with chrome-plated surface
- Capable of bolt tripping

No.	Driving Head	Active Tip Width A(mm)	Active Tip Depth B(mm)	Depth C (mm)	Connector Φ(mm)	L (mm)	Weight (kg)			
96562	3/8"	35	15	32	16	70	0.17	1	-	-
96563	1/2"	44	35	32	16	70	0.27	1	-	-
96564	3/4"	69	30	56	22	70	0.95	1	-	-

▲ Excluded from lifetime warranty terms.

Torque Multiplier



96493

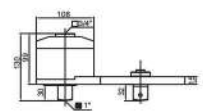

96492

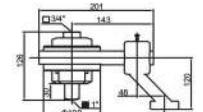

96494

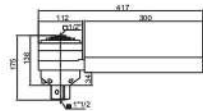

Note: the conversion ratio in the table is for selection reference only. The actual ratio is subject to the certificate attached to each product.

No.	Maximum Input Torque (Nm)	Maximum Output Torque (Nm)	Gear Ratio	Input Terminal Square Drive Size	Output Terminal Square Drive Size	L (mm)	Diameter (mm)	H (mm)	Weight (kg)			
96491	280	1500	1:6	1/2"	3/4"	128	100	105	4.9	-	1	6.2
96492	500	2300	1:5.4	3/4"	1"	221	100	126	6.4	-	1	7.9
96493	777	3100	1:4.5	3/4"	1"	264	108	130	7.3	-	1	9.8
96494	225	4000	1:20	1/2"	1-1/2"	312	120	204	8.3	-	1	16.7
96495	230	5300	1:26	1/2"	1-1/2"	333	130	216	15.7	-	1	21.5

▲ Excluded from lifetime warranty terms.



Gear made of quality alloy steel with special processing and heat treatment for high bearing capacity



Used to replace large torsion wrench without using lengthened handle for easy operation

Product subjected to verification before leaving the factory with torque ratio accuracy of up to $\pm 4\%$ (the actual torque ratio is subject to the torque ratio on the factory certificate attached to the product)



High-strength shockproof suitcase facilitating carrying and field operation

High-strength military toolkit

Made from special material for small size, high strength, light weight and easy carrying

Mechanical safety gear broke first in case of overload to protect the machine

Product subjected to verification before leaving the factory with torque ratio accuracy of up to $\pm 4\%$ (the actual torque ratio is subject to the torque ratio on the factory certificate attached to the product)



Super Lightweight Torque Multiplier

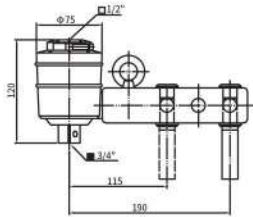

Note: the conversion ratio in the table is for selection reference only. The actual ratio is subject to the certificate attached to each product

No.	Maximum Input Torque (N.m)	Maximum Output Torque (N.m)	Gear Ratio	Input Terminal Square Drive Size	Output Terminal Square Drive Size	Diameter (mm)	H (mm)	Weight (kg)			
96496	80	1000	1:12.5	1/2"	3/4"	75	120	3.2	-	1	5.5
96497	182	2000	1:12.5	1/2"	1"	75	124	3.4	-	1	5.5

▲ Excluded from lifetime warranty terms.

Portable Lightweight Torque Multiplier

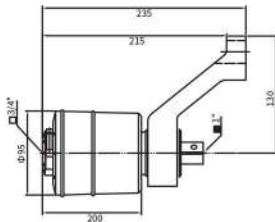

Note: the conversion ratio in the table is for selection reference only. The actual ratio is subject to the certificate attached to each product

No.	Maximum Input Torque (N.m)	Maximum Output Torque (N.m)	Gear Ratio	Input Terminal Square Drive Size	Output Terminal Square Drive Size	Diameter (mm)	H (mm)	Weight (kg)			
96498	215	2800	1:13	1/2"	1"	95	200	5.2	-	1	10.7
96499	292	3800	1:13	3/4"	1"	95	200	5.2	-	1	4

▲ Excluded from lifetime warranty terms.

Gearbox Element

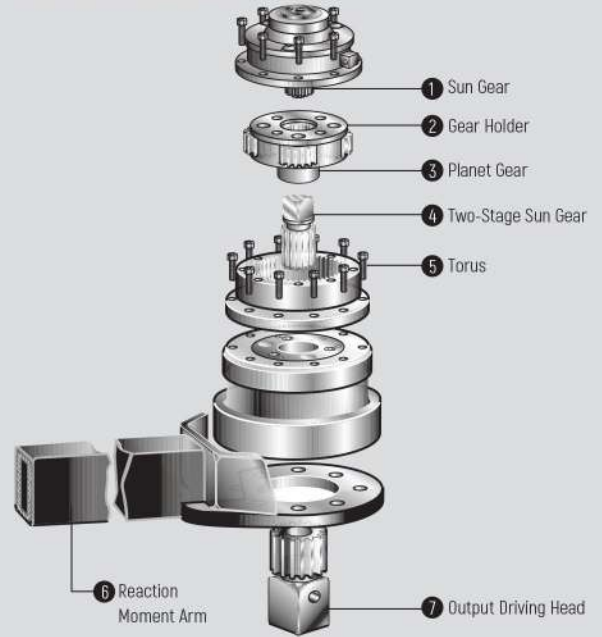

Operating Principle

Torque Rate

Apply the torque with a 100N-m (Newton-meter) torsion wrench



Safe operation

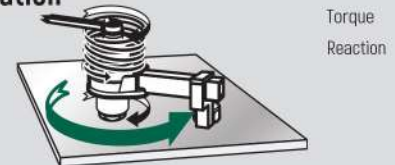

Gearbox and torque increase force, with the same principle as a spring!

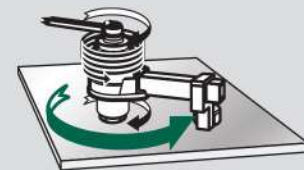

The multiplier produces maximum torque only when the spring is at its tightest.