

Measuring Tool



Tape Measure

205-206



Feeler Gauge

207-208



Level

208



Ruler/Angle Ruler

209



Vernier Caliper

210-212



Micrometer

213-214



Laser Distance Meter

215

Measuring Tool

Tape Measure



No.	Ruler Length (m)	Tape Width L (mm)			
91311A	2	13	12	120	8.6
91312A	3	16	12	120	13.6
91314A	5	19	12	120	23.3
91315A	5	25	12	120	30.5
91316A	7.5	25	6	60	22.3
91317A	10	25	6	60	28.6

▲ Excluded from lifetime warranty terms.

Tape Measure



- TPE cover, not easy to damage when dropped
- Ruler tape double-sided printing
- Strong springs for longer life

No.	Ruler Length (m)	Tape Width L (mm)			
91333A	3.5	16	12	-	-
91334A	5	19	12	-	-
91335A	5.5	25	6	-	-
91336A	7.5	25	6	-	-

▲ Excluded from lifetime warranty terms.

Grade-1 Precision Tape



- High precision up to JIS1
- Durable matte paint for easy reading in bright light
- Double-sided printing for easy reading on both sides
- Double-sided crochet hook with automatic resetting to ensure that both internal and external measurements starting from zero
- Climbing hook provided for easy carrying

No.	Ruler Length (m)	Tape Width L (mm)			
91311B	2	13	12	-	-
91312B	3	16	12	-	-
91314B	5	19	12	-	-
91315B	5	25	12	-	-
91316B	7.5	25	6	-	-
91317B	10	25	6	-	-
91322B	5M/16Ft.	19	12	-	-

▲ Excluded from lifetime warranty terms.



*Nylon-coated steel ruler tape can be used in inclement weather or environment and can be scrubbed repeatedly



*Nylon-covered steel ruler tape can be washed



Tape Measure



- TPE cover, not easy to damage when dropped
- Ruler tape double-sided printing
- Strong springs for longer life

No.	Ruler Length (m)	Tape Width L (mm)			
91341A	3.5	16	12	-	-
91342A	5	19	12	-	-
91343A	5.5	25	6	-	-
91344A	7.5	25	6	-	-

▲ Excluded from lifetime warranty terms.

Fiberglass Tape Measure



- Measuring range 0-20 meters
- ABS high-strength engineering plastics: strong and durable, good impact resistance Back hand-held design: easy to carry
- Fiberglass ruler tape: rustproof and insulated

No.	Ruler Length (m)	Tape Width L (mm)			
91361B	20	13	20	-	-
91362B	30	13	20	-	-
91363B	50	13	20	-	-

▲ Excluded from lifetime warranty terms.

Steel Tape Measure



- Return quickly
- ABS/TPR Cover, soft and shatter-proof
- Metal tailhook for easy handling

No.	Ruler Length (m)	Tape Width L (mm)			
91351B	15	10	20	-	-
91353B	30	10	20	-	-

▲ Excluded from lifetime warranty terms.

Nylon coating and wear-proof treatment technology

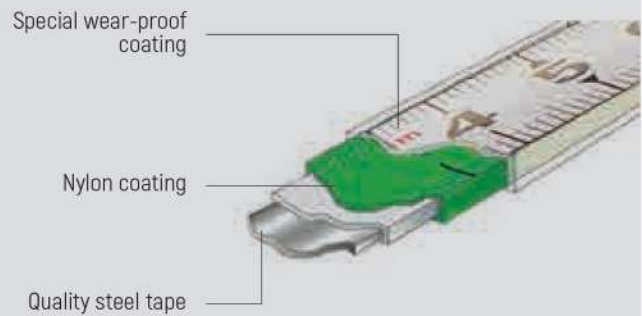

SATA tapes are nylon-coated



09401 14Pc. Feeler Gauge Set 0.05-1.00mm

• Made of Mn steel, with polished surface

Specification

• Feeler Gauge: 0.05mm, 0.10mm, 0.15mm, 0.20mm, 0.25mm, 0.30mm, 0.40mm, 0.50mm, 0.60mm, 0.70mm, 0.80mm, 0.90mm, 1.00mm
 • Ruler: 2'

No.			
09401	-	24	1.8

▲ Excluded from lifetime warranty terms.

09405 23Pc. Feeler Gauge Set 0.02-1.00mm, Metric & SAE

• Made of Mn steel, with polished surface

Specification

• Feeler Gauge: 0.02mm, 0.03mm, 0.04mm, 0.05mm, 0.10mm, 0.15mm, 0.20mm, 0.25mm, 0.30mm, 0.35mm, 0.40mm, 0.45mm, 0.50mm, 0.55mm, 0.60mm, 0.65mm, 0.70mm, 0.75mm, 0.80mm, 0.85mm, 0.90mm, 0.95mm, 1.00mm

No.			
09405	-	36	3.7

▲ Excluded from lifetime warranty terms.

09402 16Pc. Feeler Gauge Set 0.05-1.00mm

• Made of Mn steel, with polished surface

Specification

• Feeler Gauge: 0.05mm, 0.10mm, 0.15mm, 0.20mm, 0.25mm, 0.30mm, 0.35mm, 0.40mm, 0.50mm, 0.55mm, 0.60mm, 0.70mm, 0.75mm, 0.80mm, 0.90mm, 1.00mm

No.			
09402	-	12	1.3

▲ Excluded from lifetime warranty terms.

09407 32Pc. Feeler Gauge Set 0.02-1.00mm, Metric & SAE

• Made of 65Mn steel, with polished surface

Specification

• Feeler Gauge: 0.02mm, 0.03mm, 0.04mm, 0.05mm, 0.06mm, 0.07mm, 0.08mm, 0.09mm, 0.10mm, 0.13mm, 0.15mm, 0.18mm, 0.20mm, 0.23mm, 0.25mm, 0.28mm, 0.30mm, 0.33mm, 0.38mm, 0.40mm, 0.45mm, 0.50mm, 0.55mm, 0.60mm, 0.63mm, 0.65mm, 0.70mm, 0.75mm, 0.80mm, 0.85mm, 0.90mm, 1.00mm

No.			
09407	-	24	3.1

▲ Excluded from lifetime warranty terms.

09415 23 Pc. Metric High Precision Feeler Set



- Body made of Mn steel with surface polished
- Ruler 4" long

Specification

- 0.02, 0.03, 0.04, 0.05, 0.10, 0.15, 0.20, 0.25, 0.30, 0.35, 0.40, 0.45, 0.50, 0.55, 0.60, 0.65, 0.70, 0.75, 0.80, 0.85, 0.90, 0.95, 1.00MM

No.			
09415	-	-	-

▲ Excluded from lifetime warranty terms.

09416 32 Pc. Metric and Inch High Precision Feeler Set



- Body made of Mn steel with surface polished
- Ruler 3.5" long
- Metric-inch system

Specification

- 0.02, 0.03, 0.04, 0.05, 0.06, 0.07, 0.08, 0.09, 0.10, 0.13, 0.15, 0.18, 0.20, 0.23, 0.25, 0.28, 0.30, 0.33, 0.38, 0.40, 0.45, 0.50, 0.55, 0.60, 0.63, 0.65, 0.70, 0.75, 0.80, 0.85, 0.90, 1.00MM

No.			
09416	-	-	-

▲ Excluded from lifetime warranty terms.

Level



- High precision within error 0.5mm/m
- Bubble tube being anti-UV and impact resistance, not easy to break
- Highly elastic material of end cap, and the drop performance is good

No.	L(mm)			
91601A	300	6	-	-
91602A	450	6	-	-
91603A	600	6	-	-
91604A	750	6	-	-
91605A	900	6	-	-
91606A	1200	6	-	-

▲ Excluded from lifetime warranty terms.

Magnetic Level



- With Magnet, easy to operate.
- High precision within error 0.5mm/m
- Bubble tube being anti-UV and impact resistance, not easy to break
- Highly elastic material of end cap, and the drop performance is good

No.	L(mm)			
91611A	300	6	30	-
91612A	450	6	30	-
91613A	600	6	30	-
91614A	750	6	30	-
91615A	900	6	30	-
91616A	1200	6	30	-

▲ Excluded from lifetime warranty terms.



Steel Rules



91401



91402

- Made of stainless steel
- Clear calibration and wear-resistance

No.	Spec.			
91401	150	12	144	4
91402	300	12	108	7.8
91403	500	10	90	12
91404	1000	10	40	12.3

▲ Excluded from lifetime warranty terms.

Carpenter's Squares



91411



91412

- Made of stainless steel
- Clear calibration and wear-resistance

No.	Spec.			
91411	200	10	40	71
91412	300	10	40	10.1

▲ Excluded from lifetime warranty terms.

Vernier Height Gauge



- The ruler frame has high fitting accuracy and smooth pulling
- The base can be replaced, enhancing the service life
- The base material is solid and the measurement is more stable

No.	Range (mm)	Resolution(mm)	Accuracy (mm)			
91542	0-200	0.02	± 0.03	1	4	-
91543	0-300	0.02	± 0.04	1	4	-
91544	0-500	0.02	± 0.04	1	2	-

▲ Excluded from lifetime warranty terms.

Digital Height Gauge



- The ruler frame has high fitting accuracy and smooth pulling
- The base can be replaced, enhancing the service life.
- The base material is solid and the measurement is more stable

No.	Range (mm)	Resolution(mm)	Accuracy (mm)			
91545	0-200	0.01	± 0.03	1	4	-
91546	0-300	0.01	± 0.04	1	4	-
91547	0-500	0.01	± 0.04	1	2	-

▲ Excluded from lifetime warranty terms.



91501 Vernier Caliper 0-150mm



- Measurement range: 0-150mm
- Made of stainless steel, ensuring high measurement accuracy
- For measurement of inner hole, outer circle and depth

No.	Measuring Range (mm)	Indexing (mm)	Accuracy(mm)			
91501	0-150	0.02	+/-0.02	6	36	12.2

▲ Excluded from lifetime warranty terms.

91503 Vernier Caliper 0-300mm



- Measurement range: 0-300mm
- Made of stainless steel, ensuring high measurement accuracy
- For measurement of inner hole, outer circle and depth

No.	Measuring Range (mm)	Indexing (mm)	Accuracy(mm)			
91503	0-300	0.02	+/-0.03	4	24	22.9

▲ Excluded from lifetime warranty terms.

91502 Vernier Caliper 0-200mm



- Measurement range: 0-200mm
- Made of stainless steel, ensuring high measurement accuracy
- For measurement of inner hole, outer circle and depth

No.	Measuring Range (mm)	Indexing (mm)	Accuracy(mm)			
91502	0-200	0.02	+/-0.02	6	36	17

▲ Excluded from lifetime warranty terms.

91511 Digital Caliper 0-150mm



- Measurement range: 0-150mm and accurate reading Made of stainless steel, ensuring high measurement accuracy
- Reset at any position, and metric/inch conversion
- Relative/absolute value. With data output port RS232

No.	Measuring Range (mm)	Indexing (mm)	Accuracy(mm)			
91511	0-150	0.01	+/-0.03	6	36	13.9

▲ Excluded from lifetime warranty terms.

Power switch button, the reset key of the desired position, the conversion key of metric and SAE system at any position and the relative/absolute value key

Made of stainless steel with four-key measurement method for high measurement accuracy and accurate reading

Data output port RS232 available

91512 Digital Caliper 0-200mm



- Measurement range: 0-200mm and accurate reading Made of stainless steel, ensuring high measurement accuracy
- Reset at any position, and metric/inch conversion
- Relative/absolute value. With data output port RS232

No.	Measuring Range (mm)	Indexing (mm)	Accuracy(mm)			
91512	0-200	0.01	+/-0.03	6	36	18

▲ Excluded from lifetime warranty terms.

91513 Digital Caliper 0-300mm



- Measurement range: 0-300mm and accurate reading Made of stainless steel, ensuring high measurement accuracy
- Reset at any position, and metric/inch conversion
- Relative/absolute value. With data output port RS232

No.	Measuring Range (mm)	Indexing (mm)	Accuracy(mm)			
91513	0-300	0.02	+/-0.03	4	24	19.8

▲ Excluded from lifetime warranty terms.

91521 Dial Caliper 0-150mm



- Measurement range: 0-150mm
- Made of stainless steel, easy to read
- Indicator core upgraded to two-way shockproof performance
- With outer ring locking device

No.	Measuring Range (mm)	Indexing (mm)	Accuracy(mm)			
91521	0-150	0.02	+/-0.03	6	36	13.8

▲ Excluded from lifetime warranty terms.



Tool Knowledge Station

Measurement Applications



Outer diameter measurement



Inner diameter measurement



Difference measurement



Depth measurement



91522 Dial Caliper 0-200mm



- Measurement range: 0-200mm
- Made of stainless steel, easy to read
- Indicator core upgraded to two-way shockproof performance
- With outer ring locking device

No.	Measuring Range (mm)	Indexing (mm)	Accuracy(mm)			
91522	0-200	0.02	+/-0.03	6	36	194

▲ Excluded from lifetime warranty terms.

91523 Dial Caliper 0-300mm



- Measurement range: 0-300mm
- Made of stainless steel, easy to read
- Indicator core upgraded to two-way shockproof performance
- With outer ring locking device

No.	Measuring Range (mm)	Indexing (mm)	Accuracy(mm)			
91523	0-200	0.02	+/-0.03	4	24	23

▲ Excluded from lifetime warranty terms.



Common Sense for using SATA tools

Use tools correctly



Wrench size and nut type must be the same

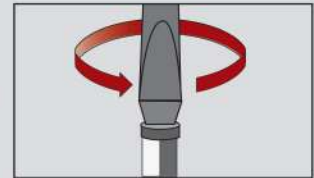

Make sure the tool is in normal use position

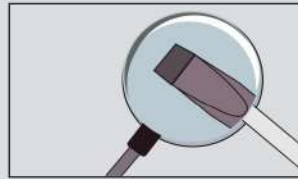

Repair frequently and replace rusty or damaged tools in time



When using with electric and pneumatic tools, please select special electric and pneumatic hand tools



Wear protective equipment if required by work environment



Make sure the cabinet is locked and pulley active before moving the toolbox



Digital Depthometer

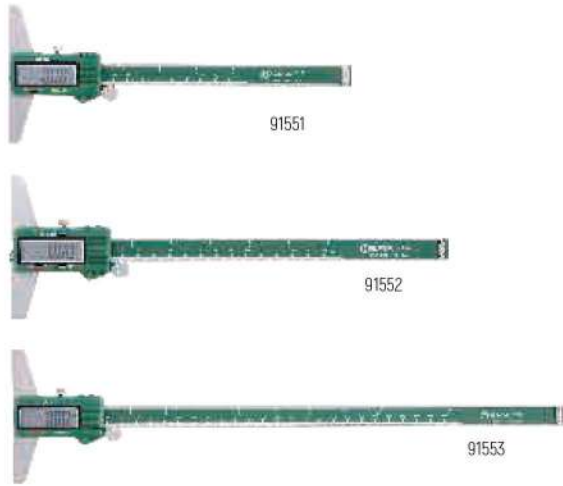

- Measuring base is polished twice to fit close to the measuring object
- Large digital display for quick reading

No.	Measuring Range (mm)			
91551	0-150	6	36	7
91552	0-200	6	36	8
91553	0-300	6	24	10

▲ Excluded from lifetime warranty terms.

91531 Outside Micrometer 0-25mm



- Measurement range: 0-25mm
- Hard alloy measuring surface, ensuring high wear resistance
- With micrometer screw locking device

No.	Measuring Range (mm)	Indexing (mm)	Accuracy(mm)			
91531	0-25	0.01	+/-0.004	6	36	12.3

▲ Excluded from lifetime warranty terms.

91532 Outside Micrometer 25-50mm



- Measurement range: 25-50mm
- Hard alloy measuring surface, ensuring high wear resistance
- With micrometer screw locking device

No.	Measuring Range (mm)	Indexing (mm)	Accuracy(mm)			
91532	25-50	0.01	+/-0.004	6	36	16

▲ Excluded from lifetime warranty terms.

91533 Outside Micrometer 50-75mm



- Measurement range: 50-75mm
- Hard alloy measuring surface, ensuring high wear resistance
- With micrometer screw locking device

No.	Measuring Range (mm)	Indexing (mm)	Accuracy(mm)			
91533	50-75	0.01	+/-0.005	6	36	23.3

▲ Excluded from lifetime warranty terms.

91539 Micrometer Base



No.			
91539	-	10	4

▲ Excluded from lifetime warranty terms.



IP65 Digital Micrometer



91534

91535

No.	Measuring Range (mm)	Indexing (mm)	Accuracy(mm)			
91534	0-25	0.001	0.002	6	36	7
91535	25-50	0.001	0.002	6	36	7

▲ Excluded from lifetime warranty terms.

Mechanical dial gauge



91561

91562

- Hat lift design
- Indication of value range, easy to read

No.	Measuring Range (mm)	Indexing (mm)			
91561	0-5	0.01	-	-	-
91562	0-10	0.01	-	-	-

▲ Excluded from lifetime warranty terms.

IP54 Digital display dial indicator



91563

91564

- Dust cap design with minimal environmental impact
- IP54 waterproof and dustproof design
- Zero at any position
- Metric to English conversion
- With data output interface

No.	Measuring Range (mm)	Indexing (mm)			
91563	0-12.7	0.01	-	-	-
91564	0-25.4	0.01	-	-	-

▲ Excluded from lifetime warranty terms.

91565 Lever dial indicator



- Gem bearing, high sensitivity, long service life
- Built in rubber pad for good shock resistance
- Hard alloy probe, more durable
- Anti magnetic pointer, measurement not affected by magnetic field

No.	Measuring Range (mm)	Indexing (mm)			
91565	0-0.8	0.01	-	-	-

▲ Excluded from lifetime warranty terms.

MMagnetic base



91566

91568

Universal magnetic base

- Universal shaft design for flexible rotation
- With fine tuning function
- The special structure of the locking nut prevents rotation when adjusting the upper/lower arms

Mechanical magnetic base

- Be able to lock the upper/lower arms separately
- The lower arm is fixed on the side of the base for greater stability

No.	Product Name	Measuring Range (KGF)	Clamping aperture(mm)			
91566	Universal magnetic base	60	8	-	-	-
91567	Universal magnetic base	80	8	-	-	-
91568	Mechanical magnetic base	60	8	-	-	-
91569	Mechanical magnetic base	80	8	-	-	-

▲ Excluded from lifetime warranty terms.

62709 Laser Distance Meter 30M



Maximum measuring range ¹	0.2-30m
Measurement accuracy ²	+/-3 mm
Measurement Unit	m/ft+in
Laser level	Class 2
Laser type	630-670nm, < 1mW
Single measurement	✓
Key	Soft rubber key
Operating temperature	0°C -40°C
Storage temperature	-10°C -60°C
Battery life	Up to 5000 measurements
Battery selection	AAA 2 x 1.5V
Automatic laser shutdown	30s
Automatic instrument shutdown	After 3 minutes

1 Range:
 • Use sighting board or a better reflecting surface if under sunlight or target is not reflecting well

2 Accuracy:
 • In good measuring conditions (good measuring surface, room temperature, indoor lighting, etc.), the rated range can be reached. In poor measurement conditions, such as too strong light, weak reflection on the surface of the measured object or too large temperature difference, the error will increase

- Typical accuracy +/-3mm
- Small size for easy carrying
- Single key for easy operation
- HD backlight display for clear data display
- Rugged case for durability
- 2 * AAA 1.5V batteries
- Automatic shutdown for saving power

No.	Spec.			
62709	30	8	20	13

Laser Distance Meter



62712



62713

Range ¹	0.2-60mm (62712) 0.2-100mm (62713)
Accuracy ²	+/- (2.0mm+5x10-5D)
Single measurement	✓
Continuous measurement	✓
Area measurement	✓
Volume measurement	✓
Simple Pythagorean	✓
Quadratic Pythagorean ^①	✓
Quadratic Pythagorean ^②	✓
Automatic level	✓
Automatic verticality	✓
Addition and Subtraction	✓
Angular Transducer	✓
Angle measurement accuracy ³	+/- (0.3° +0.1° +0.01 * D)
Measuring Basis	Front/rear benchmark
Measurement Unit	m /ft/ in /ft+in
Auto shutdown	Automatic shutdown after no operation for 3 minutes
Screen Type	20-inch screen
History measurement record	20 sets
Laser level	Class 2
Laser type	630-670nm, <1mW
Operating temperature	0--40 (32F--104F)
Size	115 × 49 × 26mm

1 Range:

• The range data is referenced against the default rear benchmark; the maximum range will be changed according to different models. For the actual range, see the outer packing of the machine.

2 Accuracy (refers to the measured distance):

• In good measuring conditions (good measuring surface, room temperature, indoor lighting, etc.), the rated range can be reached. In poor measurement conditions, such as too strong light, weak reflection on the surface of the measured object or too large temperature difference, the error will increase

3 Angle measurement accuracy

• 0.1° is the error caused by temperature, D is +/-45, for example: 0° error is +/-0.3° at normal temperature, and 45° error is +/-0.85° at abnormal temperature

• Tip: Use sighting board or a better reflecting surface if under sunlight or target is not reflecting well

- Typical accuracy +/-2mm
- Angle measurement function
- High-definition backlight display capable of displaying 5 lines of data at the same time, with data comparison at a glance
- Capable of storing 20 sets of history data
- Capable of single measurement, continuous measurement, maximum/minimum measurement, area and volume measurement, hook, automatic leveling, automatic verticality, as well as Pythagorean, addition and subtraction operation
- Prompt with beeper
- Charging with Micro USB
- Automatic shutdown for saving power

No.	Spec.			
62712	60	-	20	5.3
62713	100	-	20	5.3