

SPECIFICATIONS

Model	BX-80N (standard)
Coverage	24m (12m on each side)
Detection zones	4 zones (2 zones on each side)
Sensitivity	2.0°C at 0.6m/sec.
Detectable speed	0.3m - 1.5m/s
Power supply	10 - 28 VDC
Current consumption	38mA (max.)
Alarm period	2 ± 1 sec.
Alarm output	2 relay outputs N.O. and N.C. 28 V DC 0.2A (max.) each
Tamper switch	N.C. opens when cover removed
Warm-up period	Approx. 45 sec. (LED blinks)
Volume of audible alarm	Approx. 70dB (at 1 meter distance)
LED indicator	LED is blinking during warm-up period
Operating temperature	-20°C to +50°C
Environmental humidity	95% max.
RF interference	No Alarm 20V/m
Mounting height	0.8m - 1.2m
Mounting	Wall
Weight	400g
Weatherproof	IP55

Model	BX-80NR (battery operated)
Coverage	24m (12m on each side)
Detection zones	4 zones (2 zones on each side)
Sensitivity	2.0°C at 0.6m/sec.
Detectable speed	0.3m - 1.5m/s
Power supply	3 - 9VDC lithium or alkaline battery
Current consumption	3mA(Walktest, LED on) 15uA(Standby)
Alarm period	2 ± 1 sec.
Alarm output	Form C-Solid state switch: 10V DC 0.01A (max.)
Battery saving time	Approx. 120 sec. or 5 sec.
Tamper switch	Form C activates when cover removed
Warm-up period	Approx. 2 min.
LED indicator	Disable during normal operation Enable during walktest or LED switch on
Operating temperature	-20°C to +50°C
Environmental humidity	95% max.
RF interference	No Alarm 20V/m
Mounting height	0.8m - 1.2m
Mounting	Wall
Weight	520g
Weatherproof	IP55

COVERAGES

TOP VIEW

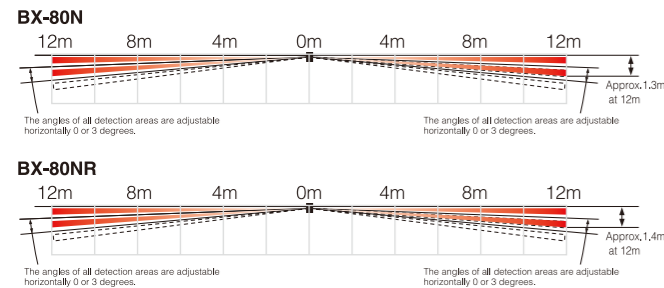

SIDE VIEW (BX-80N/80NR)

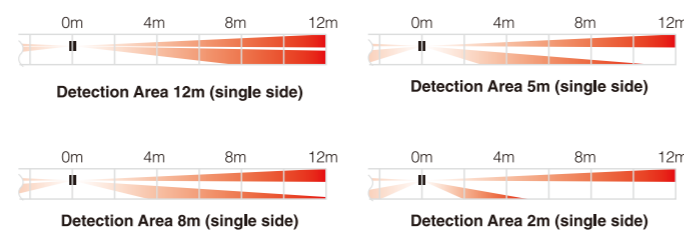

DIMENSIONS

BX-80N (standard)

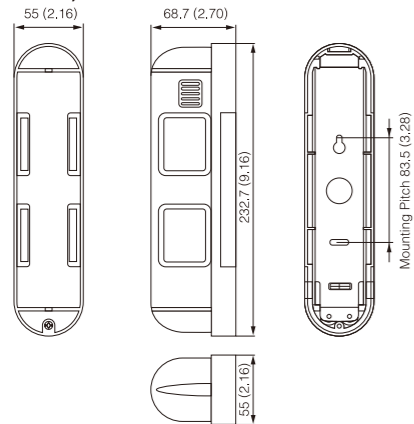

BX-80NR (battery operated)

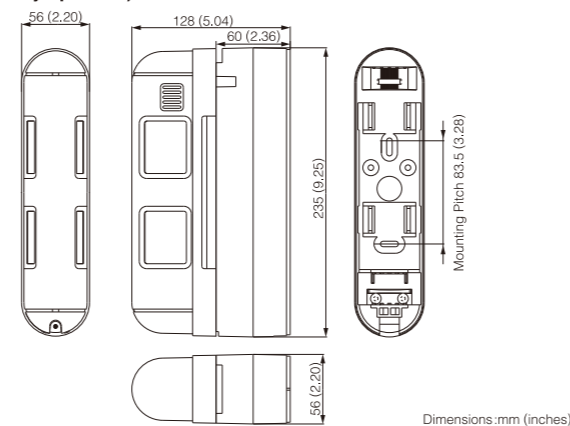

Dimensions :mm (inches)

OPTIONS

SP-2

Spacer unit For
• BX-80N

SP-2 can be used to prevent obstacles such as bay windows and troughs, etc. from being included in the detection area.

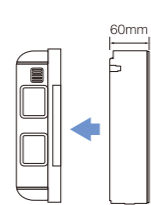

BA-1W

Multi angle wall mount bracket For
• BX-80N*
• BX-80NR

*SP-2 spacer is required when BA-1W is used.

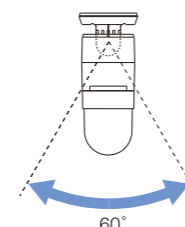

• BX-80N with SP-2 & BA-1W
• BX-80NR with BA-1W



OUTDOOR PIR DETECTOR FOR BOUNDARY OF THE BUILDING

BX-80N/80NR

(standard model) (battery operated model)

BX-80N/80NR is an advanced PIR detector which is designed to protect the immediate perimeter of the building. It is developed for the purpose of "EARLY WARNING" i.e. before an intruder breaks into the premises.



OPTEX CO.,LTD. (JAPAN)
www.optex.net

OPTEX INC. / AMERICAS HQ (U.S.)
www.optexamerica.com

OPTEX (EUROPE) LTD. / EMEA HQ (U.K.)
www.optex-europe.com

OPTEX TECHNOLOGIES B.V. (The Netherlands)
www.optex.eu

OPTEX SECURITY SAS (France)
www.optex-europe.com/fr

OPTEX SECURITY Sp.z o.o. (Poland)
www.optex.com.pl

OPTEX PINNACLE INDIA, PVT., LTD. (India)
www.optexpinnacle.com

OPTEX KOREA CO.,LTD. (Korea)
www.optexkorea.com

OPTEX (DONGGUAN) CO.,LTD. SHANGHAI OFFICE (China)
www.optexchina.com

OPTEX (Thailand) CO., LTD. (Thailand)
www.optex.co.th

BX-80N/80NR enhances protection capabilities

When a general-purpose mechanical security system is installed, detectors are usually located inside a building. In order to increase the effectiveness of such a security system, Optex recommends not only securing the inside of the building but also adding protection to the outside areas.

By adding BX-80N/80NR, it detects intruders before entry. This invisible barrier offers the first line of defense to a property's boundary.

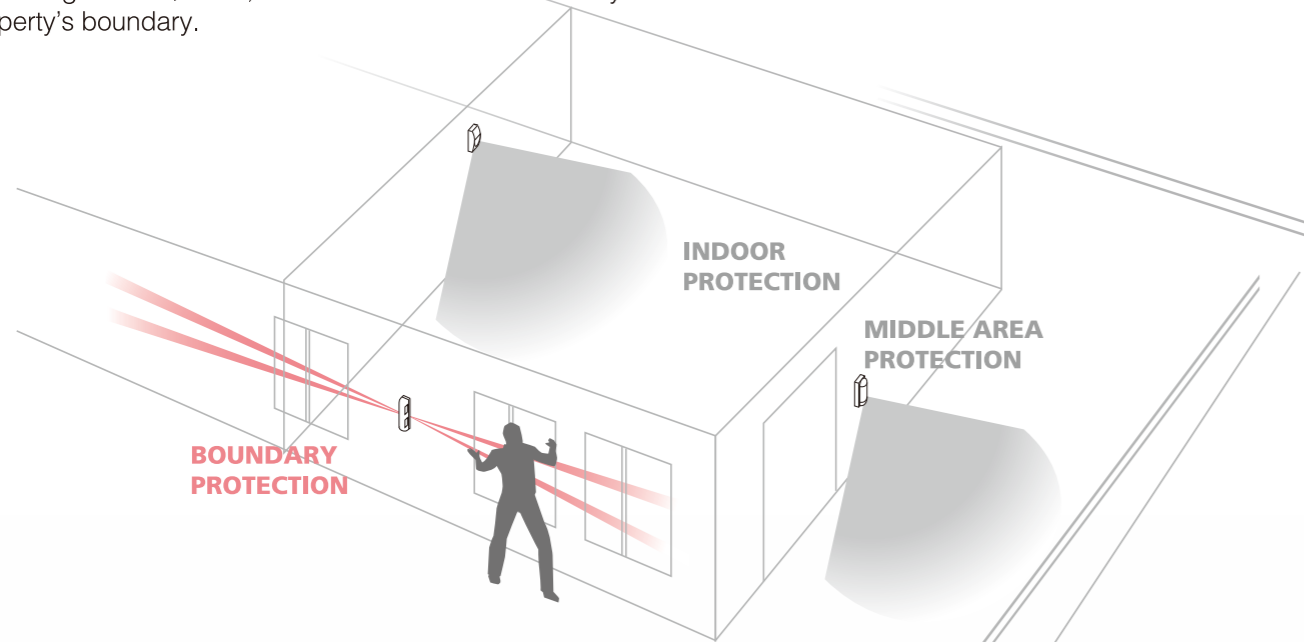

Unique detection range for immediate perimeter of the building

Optex's advanced PIR technology creates a narrow, 24m long detection area that protects wide horizontal areas, such as a building's perimeter.



Limited detection range function

The detection range of the BX-80N/80NR can be adjusted to avoid detecting unwanted objects.

Size judging function

The BX-80N/80NR only triggers alarms when both upper and lower detection layers detect movements.

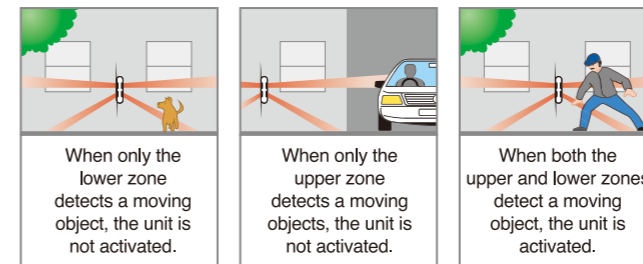

Reduce false alarms caused by unwanted light and RFI sources

Patented Double Conductive Shielding Technology helps to reduce false alarms caused by car headlights and reflected sunlight in particular.

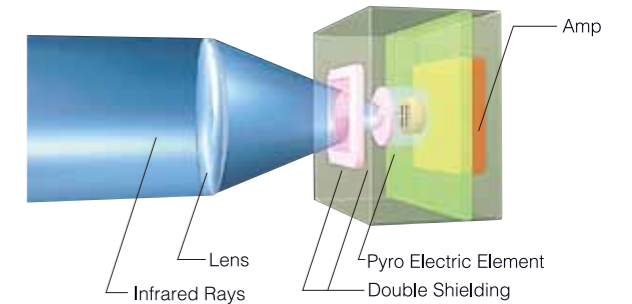

Advanced temperature compensation

The BX-80N/80NR uses advanced temperature compensation to automatically increase the detector's sensitivity under high temperature conditions, especially where the background temperature ranges from 35–37 degree C, close to that of the human body.

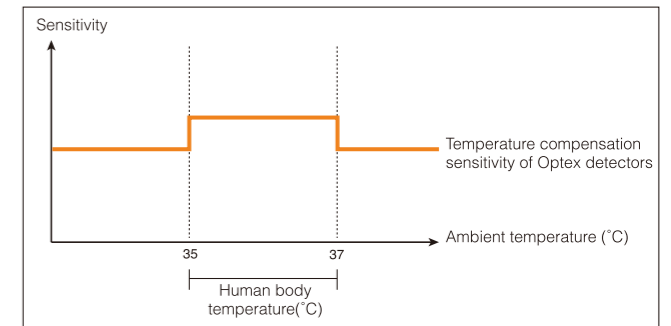

BX-80NR only



BX-80NR

Battery operated unit gives convenient & simple installation

Save installation time and cost
The BX-80NR is a battery operated model and therefore requires no complicated wiring. It saves installation time and cost.

Easily adds on to the existing wireless security system
The BX-80NR with flexible features can be added on to any wireless system which has already been installed. In addition, this unit is effective with transmitters and receivers from all manufactures.

Advanced battery lead aids shared battery power

The BX-80NR can be powered by battery of transmitter
By using for the attached battery lead, the battery power from transmitter can be shared with BX-80NR and also low battery signal can be monitored by control panel.

