

asustor

LOCKERSTOR 4 Gen2 AS6704T

The No-Compromises 2.5GbE NAS



- Quad-Core 10 nm Intel Celeron N5105 CPU - 31% more performance
- Superfast 2.5-Gigabit Ethernet ports
- Flexible PCIe slot for 10 GbE NICs or M.2 SSDs
- Supports PCIe 3.0 SSDs for up to twice the performance of PCIe 2.0.
- Uses DDR4-2933 - 40% more efficient
- USB 3.2 Gen 2x1 ports – 10Gbps speed
- Enjoy, download, upload and stream content with 4K transcoding
- Increased ventilation for SSDs
- Supports Wake on LAN and Wake on WAN

4 Intel Quad-Core

PCIe 3.0

4x M.2 slots
for NVMe SSDs

2.5G Ethernet
Dual 2.5-Gigabit
Ethernet

HDMI 2.0b

4 GB
DDR4-2933

Dual USB
3.2 Gen 2x1



Performance
King



Boundless
Functionality



Intuitive
UI



Incredible
Value



3 Year
Warranty

2.5 + 2.5 = Extreme Speeds

The LOCKERSTOR 4 Gen2 has two 2.5GbE ports which more than doubles the performance of Gigabit Ethernet devices. With the recent introduction of support for SMB Multichannel, your NAS will be able to combine the speed of multiple Ethernet ports for speeds way beyond 2.5-Gigabit Ethernet.

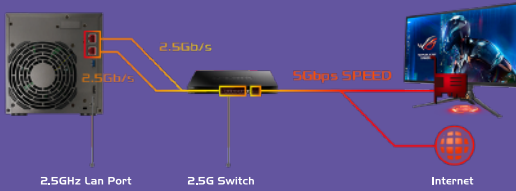

Powered by the latest Intel Celeron N5105 Quad-Core Processors

Intel's newest N5105 Quad-Core CPU comes with Intel 10 nm technology and up to 31% increased performance over Gemini Lake SoCs. The N5105 is clocked at 2.0 GHz with a boost of up to 2.9 GHz, enabling efficient content creation with the added flexibility of 10-Gigabit Ethernet upgrades.

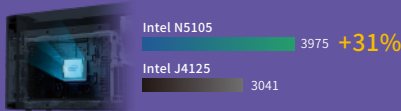

SMB Multichannel (RAID 5) Windows Sequential

590 MB/s

Read

555 MB/s

Write

Four M.2 Slots

The LOCKERSTOR Gen 2 series of NAS devices come with four M.2 slots for caching or storage or both. Either use all slots for one purpose or mix and match depending on your needs.



Also Supports 10-Gigabit Ethernet

The PCIe slot in the LOCKERSTOR Gen 2 series is no longer proprietary and now accepts 10-Gigabit Ethernet cards for maximum flexibility.



Data Protection Starts with Storage

ASUSTOR understands that your data is priceless, therefore ASUSTOR NAS provides different RAID Volume options, giving your data various levels of protection from the moment it is first stored on the NAS. We recommend you plan your storage protection based on your NAS model and number of hard disks. Data protection has never been so simple.



	Single	JBOD	RAID 0	RAID 1	RAID 5	RAID 6	RAID 10
Minimum number of disks	1	2	2	2	3	4	4
Faulty Disks Tolerated	X	X	X	1	1	2	1
Increased System performance	X	X	V	X	V	V	V
Maximum use of Storage space	V	V	V	🗄️ x 1/2	🗄️ -1	🗄️ -2	🗄️ x 1/2

Dr. ASUSTOR

ASUSTOR provides a holistic solution for protecting your data against a variety of threats using Dr. ASUSTOR. Dr. ASUSTOR helps protect your data from a variety of threats, including, but not limited to ransomware attacks.

Dr. ASUSTOR



Tool-Free M.2 SSD Installation

Uses latches instead of screws for easier installation.

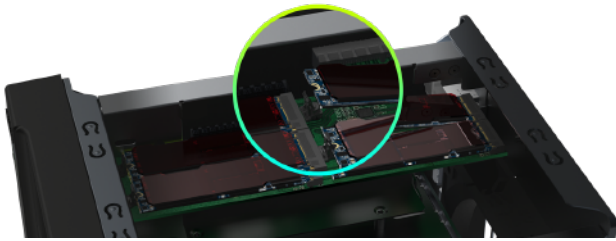

360° Backup and Virtualization Solution

- MyArchive cold storage backups
- Snapshot Center, Cloud Backup Center, DataSync Center
- Complete iSCSI/IP-SAN and NFS support
- VMware, Citrix and Hyper-V ready
- Supports Virtualization and Docker apps



Computer data to NAS



Transfer mobile data to NAS



NAS local backup



Public cloud and NAS data backup



NAS to NAS



NAS backup to external device

Security Upgrade

ADM 4.1 eliminates suspicious behaviour and is able to remove or isolate problematic files or viruses in real time. It also incorporates multiple new security measures. Every time you log into ADM and AiMaster, your NAS will also detect and provide real-time information for immediate optimization.

Keeping Cool

With up to four SSDs, a considerable amount of heat can be generated. With extra ventilation, the LOCKERSTOR 4 Gen2 ensures that all components in your NAS receive adequate cooling.

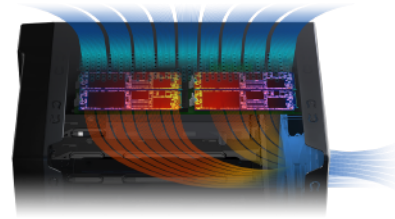

USB 3.2 Gen 2 - A First for ASUSTOR

The LOCKERSTOR Gen2 series now support USB 3.2 Gen 2 for the first time on an ASUSTOR NAS. Enjoy up to double the performance compared with USB 3.2 Gen 1 at up to 10 Gbps.



PCIe 3.0 – Doubled SSD Performance

PCIe 3.0 is supported by the LOCKERSTOR Gen 2 series of NAS devices which almost double the performance of M.2 SSDs installed in your NAS, ensuring a smoother SSD experience.



PCI EXPRESS 3.0

Protected from the Inside and Out

ASUSTOR NAS ensures data security by creating an in-depth data protection plan that protects your data from the outside in. Utilization of a multi-layered deployment scheme allows for the achievement of active network, system and data protection.

Network Attack Protection

- Firewall
- ADM Defender

Secured Data Transmission

- VPN connection
- SSL certificate connection
- Automatic logout

Access Control

- File/Folder/App Isolation
- 2-Step Verification
- Wake-on-LAN (WOL)
- Wake-on-WAN (WOW)

Internal Data

- MyArchive Offline Backup
- AES-256 folder encryption
- Antivirus software

Wake on LAN and Wake on WAN – Always on Standby

Save power and money with Wake on LAN and Wake on WAN. ASUSTOR NAS features Wake on LAN and Wake on WAN to allow your NAS to power off when not in use and be woken up with a command. Use Wake on LAN when on the same network as the NAS while Wake on WAN is for when you are away from the NAS. Wake on LAN and Wake on WAN also protects against attacks by only waking up to your commands. To an outsider, your NAS is off, protecting your data.



Portainer – Easy Docker Deployments

Even more possibilities for ADM with Portainer for Docker images. With thousands of images, Portainer can download and deploy more types of programs than ever before. Portainer is incredibly user friendly and employs a graphical interface to make Docker images easier to deploy than ever.

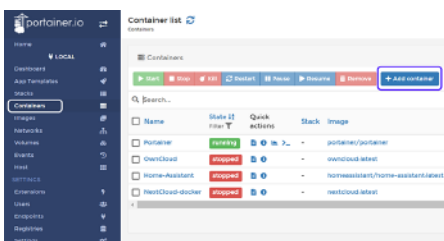

Automatically Synchronize Files Between a Computer and your NAS

ASUSTOR EZ Sync brings the magic of cloud sync services right to your home. With an ASUSTOR NAS and EZ Sync, data can be synchronized anywhere with an internet connection without a monthly bill or a data limit. If data is unintentionally modified, restoration is easy with EZ Sync's automatic file history management feature.



Integrate with a Variety of Enterprise Applications

Virtual Storage

The ASUSTOR NAS provides enterprise-class hardware and software and is compatible with VMware, Citrix, Hyper-V virtual storage environments. iSCSI/IP-SAN and NFS support allow it to seamlessly integrate with existing IT environments, providing an optimal and cost-effective storage solution.



Snapshot Center

Snapshot Center is a new feature for ASUSTOR NAS devices to utilize Btrfs and iSCSI volumes to take snapshots of the information inside a NAS. Snapshot Center supports up to 256 snapshots of a volume and can be done every five minutes, creating a backup that can be restored easily if data is damaged or lost. MyArchive now supports Btrfs and snapshots. Btrfs for MyArchive supports snapshots and version history to help protect against accidental deletions or modifications.



Created for the Digital Home

Your ASUSTOR NAS allows you to enjoy thrilling digital entertainment at any time. Pair the HDMI port on your ASUSTOR NAS with various multimedia apps NAS to an Ultra HDTV for maximum enjoyment or similarly use the UPnP multimedia server inside your NAS to stream your favorite media to compatible computers, phones, tablets or set top boxes.

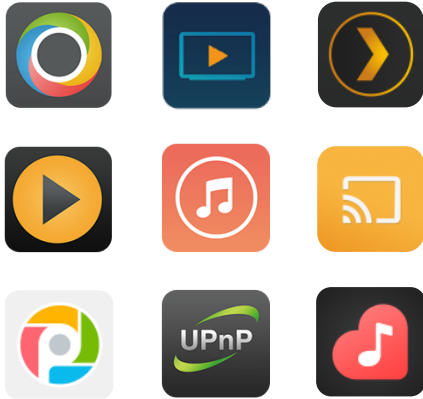

Comprehensive Surveillance System

The powerful ASUSTOR NAS provides optimal reliability for home and small businesses looking to set up a surveillance system. Four free camera channels are provided, making it an extremely cost-effective surveillance solution for users with smaller demands. The Lockerstor 2 Gen2 supports up to 44 cameras with licenses sold separately. View Surveillance feeds on Surveillance Center and its corresponding mobile app AiSecure. AiSecure also supports streams while on the go with an Internet connection.

5 Steps - 60 Seconds

- Quick installation wizard
- Automatic camera search
- Add cameras with just one click
- Configure video formats
- Configure recording schedules



PhotoGallery 3 + AiFoto 3

The all new Photo Gallery 3 and AiFoto 3 have been revamped and brings a variety of new features to make photo organization easier than ever. New features for Photo Gallery 3 include, but not are limited to custom folder selection, timelines, smart albums, and new photo modes. Easily blow up photos to up to twice their size, play songs on slideshows, performance enhancements and customized share links make for an even better photo viewing and sharing experience.



MyArchive Cold Backup Technology

MyArchive cold backup technology turns NAS hard drives into removable storage archives. Directly insert a MyArchive hard disk into the NAS to easily access, backup and share terabytes of content. When access is no longer needed, simply remove the drive for a safe offline backup or archival drive.

ASUSTOR Live

Your own streaming center. Stream your from a phone or tablet as well as a computer to multiple streaming platforms, including, but not limited to Twitch, YouTube, Facebook, Instagram, Restream or RTMP compatible platforms. Unlike services like restream.io, ASUSTOR Live doesn't require fees to operate to stream to multiple platforms and channels which saves you money and streaming resources. Recordings can be safely saved to your NAS for future use.



Mobile Apps

ASUSTOR's EZ Connect allows you to connect to your NAS from anywhere with your smartphone to access and share your files. ASUSTOR suite of mobile apps provide pass code locks to help protect your privacy and data. You can also make use of HTTPS connections for even more added security.

Hardware Specification

* Installation of 10GbE NIC requires removal of M.2 daughterboard.

LOCKERSTOR 4 Gen2 (AS6704T)

Processor	Quad-Core Intel Celeron N5105 2.0 Ghz - 2.9 Ghz turbo
Memory	4 GB DDR4-2933 SO-DIMM - Max. 16 GB
M.2 Support	4x M.2 NVMe slots - M.2 2280 Supported
Drive Bays	4x SATA III HDD/SSD - Supports 2½" & 3½" drives
Network	2x 2.5-Gigabit - Supports Wake On WAN
Internal Expansion	1x PCIe slot for 10GbE cards*
External Device Interface	2x USB 3.2 Gen 2x1 (1x Front ; 1x Rear)
Dimensions (HxWxD)	185.5(H) x 170(W) x 230(D) mm
Weight	2.94 kg/6.48 lb
Power	90W AC Adapter
Operation/Disk Hibernation/Sleep Mode(S3)	35W/17.3W/0.88W
Volume Types	Single, JBOD, RAID 0/1/5/6/10, RAID 1/5 + Hot Spare

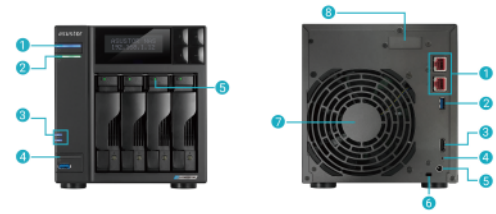

- | | |
|--------------------------------|-----------------------------------|
| 1. Power LED Indicator | 1. 2.5G RJ45 Ports |
| 2. System Status LED Indicator | 2. USB 3.2 Gen 2x1 Ports |
| 3. Network LED Indicator | 3. HDMI Port |
| 4. USB LED Indicator | 4. Reset Button |
| 5. Hard Drive LED Indicator | 5. DC Input |
| | 6. K-Lock |
| | 7. System Fan |
| | 8. PCI Express 3.0 Expansion Slot |

Software & Features

Operating System

- ADM 4.1 Onwards
- Supports Online Firmware Updates
- Built-in App Central for Various Apps

Supported OS

- Windows XP, Vista, 7, 8, 10, 11, Server 2003, Server 2008, Server 2012, Server 2016, Server 2019, Server 2022
- macOS 10.6 Onwards
- UNIX, Linux, BSD

Access Control

- Maximum Number of Users: 4096
- Maximum Number of Groups: 512
- Maximum Number of Shared Folders: 512
- Maximum Number of Concurrent Connections: 512
- Supports Windows Active Directory/LDAP

File Explorer

- Web-based File Management
- ISO File Mounting · Share Links
- Task Monitor · Browse Files on Local PC
- Thumbnail Previews
- Data Access via External Optical Drive
- Supports video playback

System Administration

- Log Types:
 - Log, Connection Log, File Access Log
- Real-time Online User Monitor
- Real-time System Monitor
- User Quota
- Virtual Drives (ISO Mounting, Maximum 16)
- UPS Support

Storage Management

- Supports Multiple Volumes with Spare Disks
- Volume Type: Single disk, JBOD, RAID 0, RAID 1, RAID 5, RAID 6, RAID 10
- Support for Online RAID Level Migration
- Support for Online RAID Capacity Expansion

Disk Management

- Scheduled Bad Block Scans
- Scheduled S.M.A.R.T Scans
- Seagate IronWolf Health Management

External Devices

- Supports USB External Storage Devices
- USB Wi-Fi Dongle Support
- Bluetooth Dongle/Speaker Support
- USB Printer Support
- USB DAC/IR Receiver/Keyboard/Mouse Support
- USB CD ROM Drives/DVD ROM Drives/BD-ROM Drives

Energy Control

- Configurable Disk Hibernation and Sleep Mode Wait Time
- Configurable Time Period for Sleep Mode Activation
- Automatic Sleep

Network

- TCP/IP (IPv4 & IPv6)
- Link Aggregation: Supports 802.3ad and Six Other Modes for Load Balancing and/or Network Failover
- Jumbo Frame (MTU)
- VLAN
- SMB Multichannel
- EZ Connect
- Wireless Network
- DDNS/EZ-Router
- Supports Wake-on-LAN (WOL)
- Supports Wake-on-WAN (WOW)

Network Protocols

- CIFS/SMB, SMB 2.0/3.0, AFP, NFS, FTP (Unicode Supported), TFTP, WebDAV, Rsync, SSH, SFTP, iSCSI/IP-SAN, HTTP, HTTPS, Proxy, SNMP, Syslog

Security

- AES 256-Bit Encryption
- Firewall: Prevent Unauthorized Access
- Alert Notifications: E-mail, SMS
- Encrypted Connections: HTTPS, FTP over SSL/TLS, SSH, SFTP, Rsync over SSH
- Built-in Hardware Encryption Engine: : AS63/64/Drivestor/ Drivestor Pro/Nimbustor/ Lockerstor (G1-G2)/Lockerstor Pro series

Dr. ASUSTOR

- Security advice and health records

Backup Solutions

- Rsync (Remote Sync) Backup
- Cloud Backup · FTP Backup
- External Backup · One Touch Backup
- EZ Sync

EZ Sync Manager

- Automatically synchronizes files between a PC and NAS
- Can restore previous versions of files
- Supports file sharing
- AiData now supports accessing EZ Sync files

Supported Browsers

- Firefox, Chrome, Safari, Microsoft Edge

Network Recycle Bin

- Share folder-based
- Maintains original directory structure and file permission
- On-click restore
- Supports scheduled emptying
- Filtering rules
 - 1.File size 2.File extension
- Deletion Settings
 - 1.File size 2.File date

Server

- VPN server, SNMP server, RADIUS server, Syslog server, Mail server, DHCP server, Web server, FTP server, Print server, Rsync server

M.2 Storage

- Supported Models: Lockerstor 2 (G1-G2)/4 (G1-G2)/6 (G2-G2)/8/10/10 Pro/12R Pro/16R Pro/

ACL

- Provides both Windows ACL and Linux ACL permission configuration methods
- Can enable Windows ACL for specific shared folders
- Comprehensive support for Windows' 13 types of advanced permission settings
- Can view Windows ACL permission settings from within ADM
- Supports local users and groups
- Exclusive permission reset function allows users to quickly restore default permissions

SSD Caching

- SSD-like performance with traditional hard drives
- Supports read-only access and read-write cache mode
- Supported Models: AS31/32/50/51/61/62/63/64/70/ Nimbustor/Lockerstor/ Lockerstor Pro series

Snapshot Center

- Btrfs Snapshots
- 256 snapshots
- iSCSI LUNs
- Supported Models: AS31/32/40/50/51/61/62/63/64/70/ Nimbustor/Lockerstor/ Lockerstor Pro series
- Snapshot Center will not display Volume snapshots information in other models.

Supported Languages

- Deutsch, English, Français, Italiano, Nederlands, Русский, 日本語, 한글, 简体中文, 繁体中文, Česká, Polski, Svenska, Dansk, Norsk, Suomi, Português, Türkçe, Español, Magyar, ไทย

iSCSI/IP-SAN

- Maximum Targets: 256
- Maximum LUNs: 256
- Maximum Snapshot Versions of a Single LUN: 256
- Target Masking
- LUN Mapping
- ISO File Mounting
- Supports MPIO
- Persistent (SCSI-3) Reservations

Featured Apps

- | | |
|-----------------------|-----------------------|
| · ClamAV Antivirus | · LooksGood |
| · Download Center | · Photo Gallery 3 |
| · FTP Explorer | · SoundsGood |
| · DataSync Center | · ASUSTOR Live |
| · Cloud Backup Center | · Linux Center |
| · VirtualBox | · Surveillance Center |
| · RADIUS Server | · UPnP Media Server |
| · Mail Server | · VPN Server |
| · DataSync Center | · VPN Client |

Mobile Apps

- | | | |
|------------|--------------|------------|
| · AiMaster | · AiVideo | · AiSecure |
| · AiFoto 3 | · AiData | · AiRemote |
| · AiMusic | · AiDownload | |



ASUSTOR Inc.

3F, No.136, Daye Rd., Beitou Dist., Taipei City 112, Taiwan Tel: +886 2 7737 0888 www.asustor.com

Designs and specifications are subject to change without notice. © ASUSTOR Inc. ASUSTOR and all other ASUSTOR product names are trademarks or registered trademarks of ASUSTOR Inc. All other product and company names mentioned herein are the trademarks of their respective owners.

Dealer Seal