

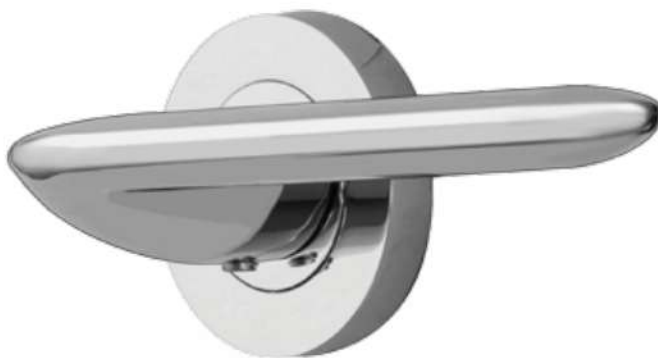













Kaadas

Access to your Future !

LEVER LOCK

M9



-  Bluetooth (Optional)
-  49 Fingerprint User
-  49 Card User
-  7 Password User
-  Mechanical Key Provided
-  Voice Guide (English & Chinese)
-  Emergency Power Supply (Micro USB)
-  High Security EN Mortise
-  Auto Locking Function
-  Double Authentication
-  Fake Pin Code
-  Defense Mode
-  Anti Panic Function
-  Double Locking



Kaadas

Access to your Future !



LEVER LOCK

M9

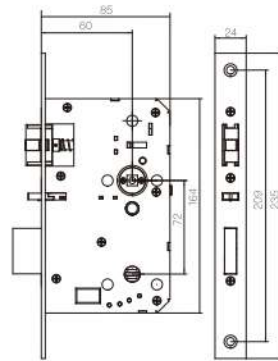

■ Product Dimension	: Front: 90mm*68mm*28mm : Back: 156mm*60mm*30mm
■ Finishing	: Polish Chrome
■ Material	: Zinc Alloy : Card Type: RFID, Mifare1, IC, S50, S70 : Fingerprint Sensor: Semiconductor (Sweden FPC Fingerprint Sensor) : Keypad Type: 5A level tempered glass
■ Lock Type	: EN Stainless Steel Mortise Lock (Hole to Hole: 72mm, Backset: 60mm)
■ Cylinder Type	: Super Grade B
■ Authentication	: Pin Number: 6-12 digit : No of Master Pin Code: 1 user only : No of Pin Code Registration: Up to 7 users : No of RFID Card Registration: Up to 49 users : No of Fingerprint Registration: Up to 49 users : No of Mechanical Key Combination: 2 keys
■ Installation	: Door Thickness: 35- 60mm (Default) : Door Type: Wooden Door
■ Power Supply	: Battery: AA Alkaline Battery : Battery Capacity: 4*AA Batteries : Working Voltage: DC 6V : Battery Life: 1 year* (*1 year: May be less depending on actual usage) : Emergency Power Supply: 5V Micro USB Power Bank : Low Battery Alert: YES

■ Included Accessories	Accessories			
	No	Item Name	Quantity	Remark
	1	Outside Escutcheon	1	
	2	Inside Escutcheon	1	
	3	EN Mortise	1	
	4	Screw Pack	1	
	5	User Manual	1	
	6	Warranty Card	1	
	7	Mechanical Keys	2	
	8	Strike Plate	1	
	9	Installation Template	1	
	10	RFID Card	2	
	11	Network Module	1	Optional

*Warranty: 2 years (*Must According to Kaadas's Terms & Conditions)