

# Cabinet Hinge Series

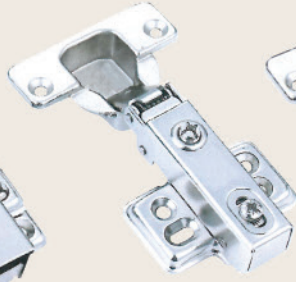

**IR-LDJ-70109**



**IR-LDJ-70209**

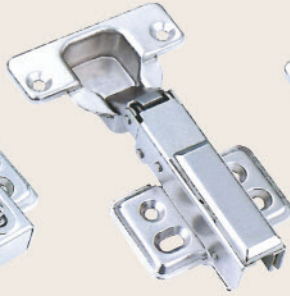

**IR-LDJ-70309**



**IR-LDJ-70409**

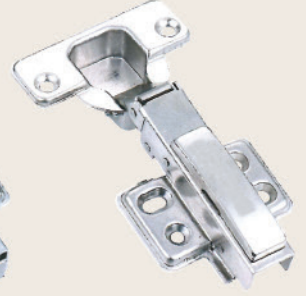

**IR-LDJ-30309**

Description: Full cover 110° hydraulic cabinet hinge  
 Material: Stainless steel / Cold-rolled steel  
 Finish: Glossy nickel  
 Hinge Thickness: 1.0mm / 1.2mm  
 Max Door Thickness: 18mm  
 Max Weight: 8kg/2pcs

Technical Parameters

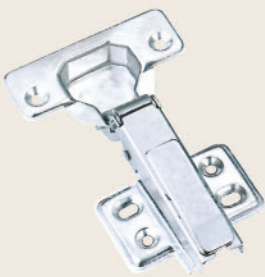
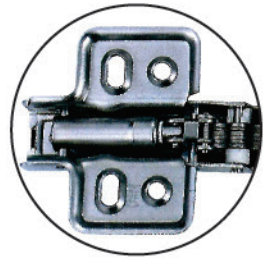
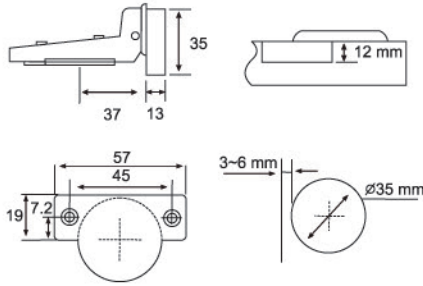
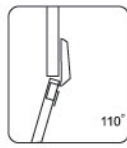

**IR-LDJ-03009**

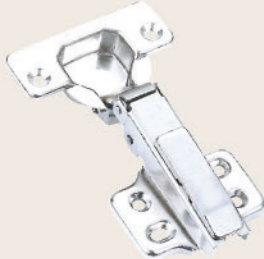

**IR-LDJ-04009**



**IR-LDJ-05009**

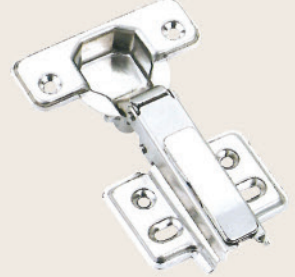

**IR-LDJ-10509**

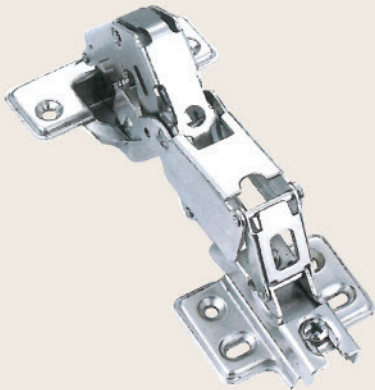

**IR-LDJ-16507**

Description: Full-cover 165° hidden hinge

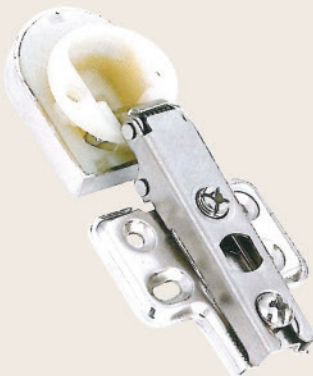
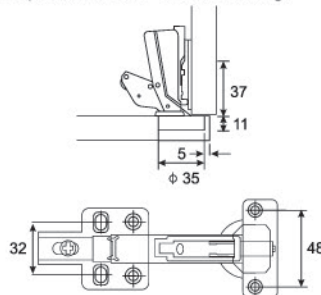

**IR-LDJ-120509**

Description: Full-cover 110° glass door hidden hinge

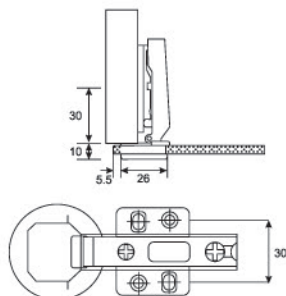

# Cabinet Hinge Series

## Installation procedure

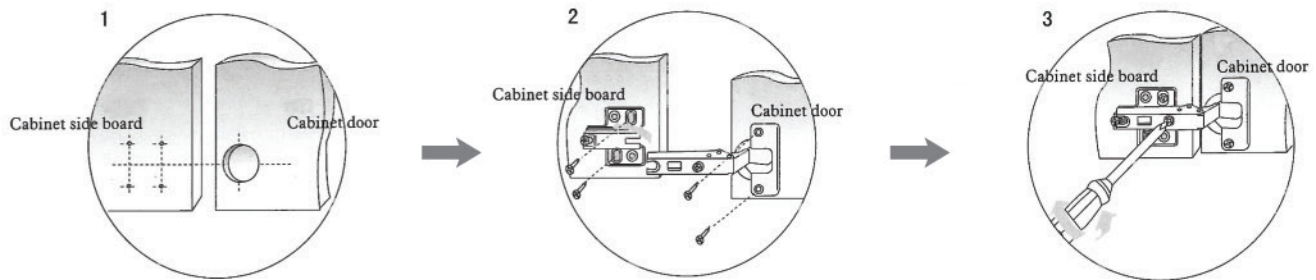

## Adjusting cabinet door in three dimensions

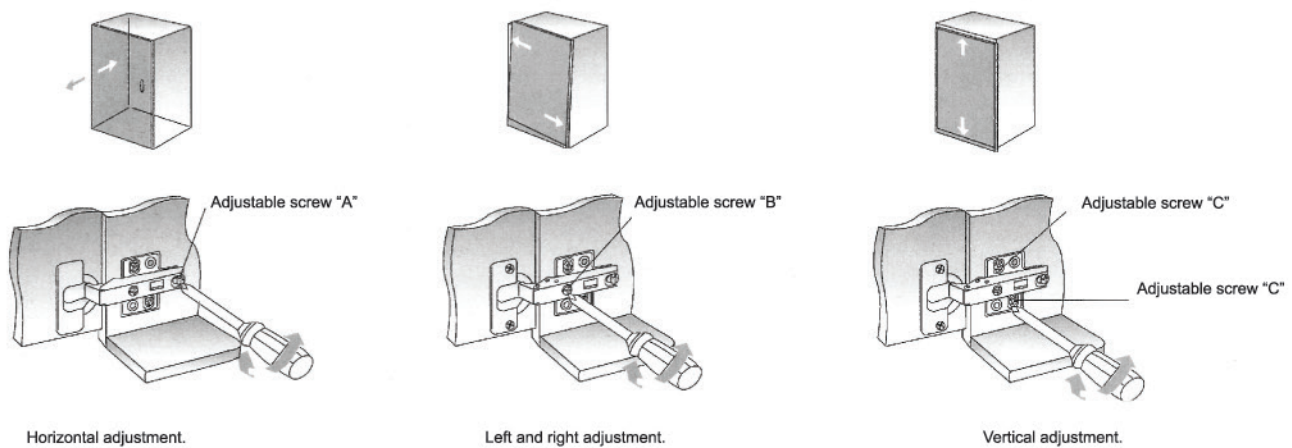

## Installation dimensions of concealed cabinet hinge (unit: mm)

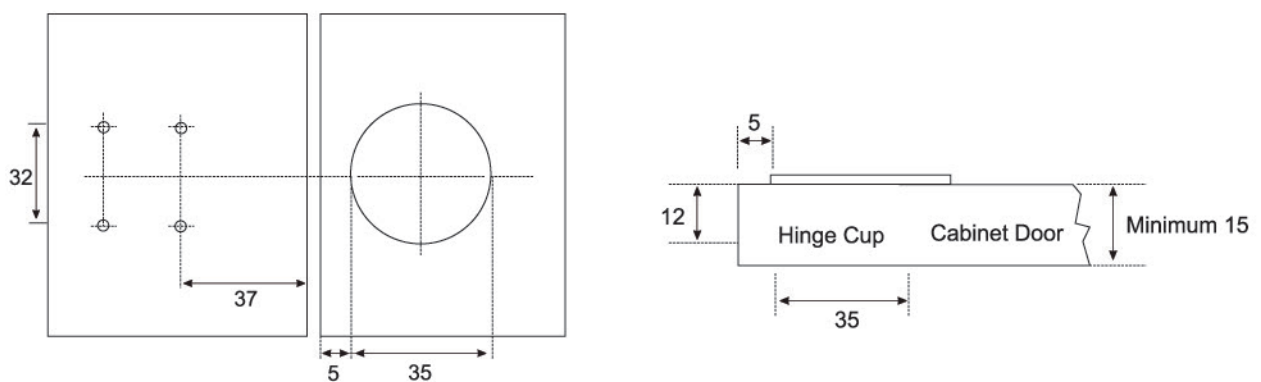

# Drawer Slider Series

## IR-LDJ-4501

Description: Three section ball bearing slides rail  
 Material: Iron  
 Finish: Chrome plated  
 Thickness: 1.0mm

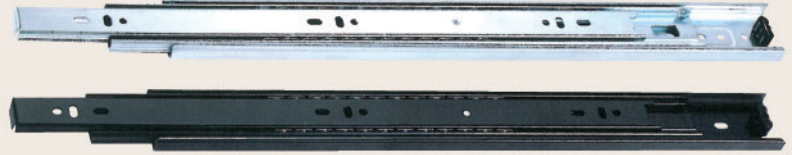

## IR-LDJ-4502

Description: Three section ball bearing slides rail  
 Material: Iron  
 Finish: Chrome plated  
 Thickness: 1.2mm

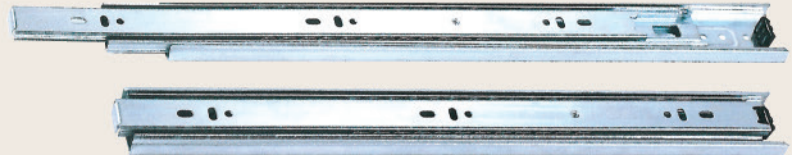

## IR-LDJ-4503

Description: Self closing three section ball bearing slides rail  
 Material: Iron  
 Finish: Chrome plated  
 Thickness: 1.0mm



### Installation Illustration

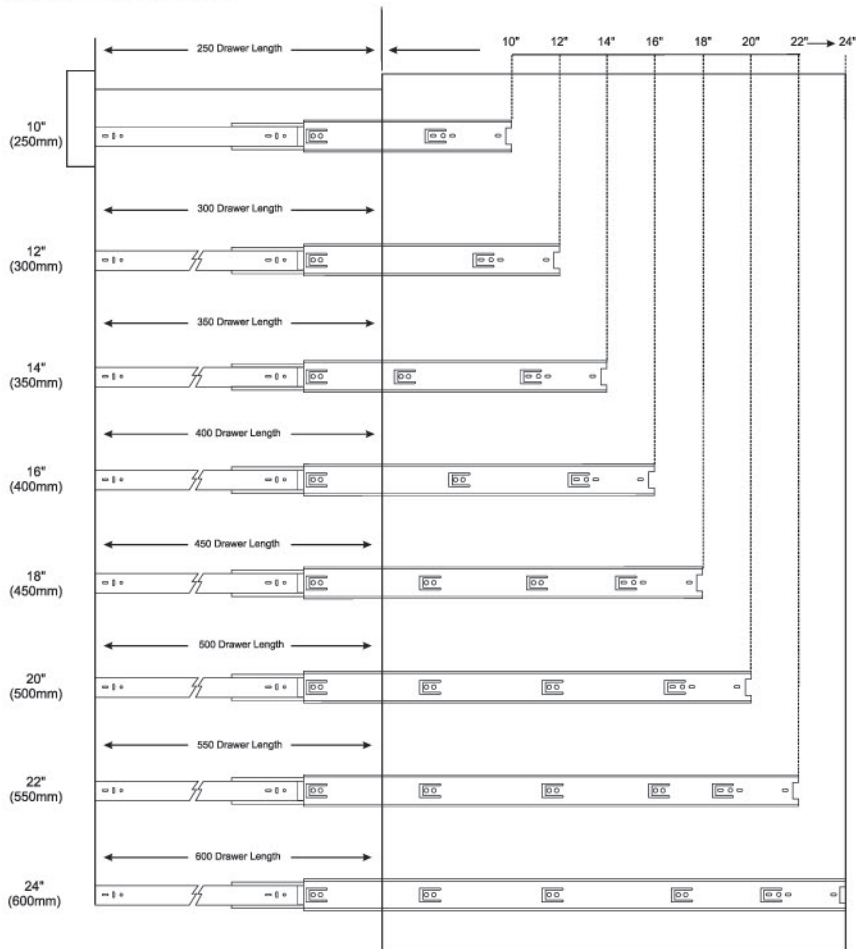

# Drawer Lock Series

## IR-LDJ-D13822N

Description: Drawer lock  
Materials: Zinc alloy  
Finish: Chrome plated

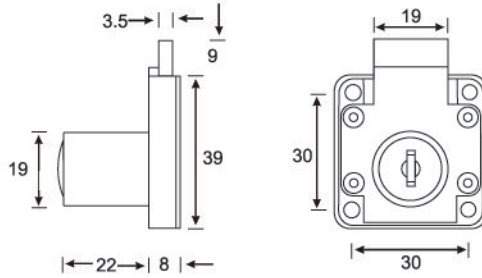

## IR-LDJ-D13832N

Description: Drawer lock  
Materials: Zinc alloy  
Finish: Chrome plated

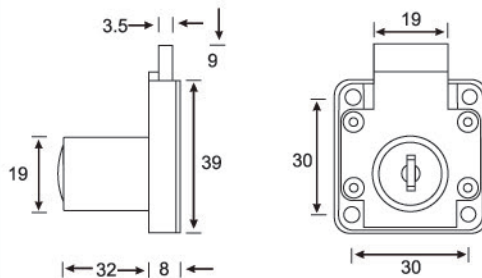

## IR-LDJ-D13822Y

Description: Drawer lock  
Materials: Zinc alloy  
Finish: Chrome plated

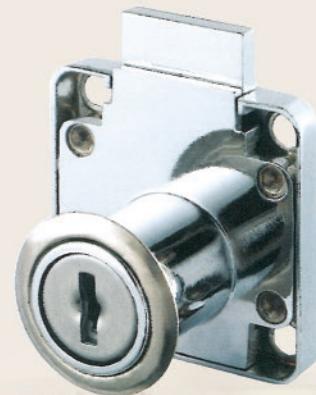
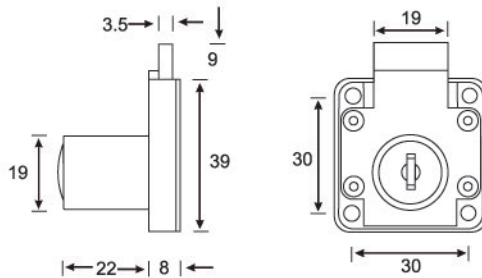

## IR-LDJ-D13832Y

Description: Drawer lock  
Materials: Zinc alloy  
Finish: Chrome plated

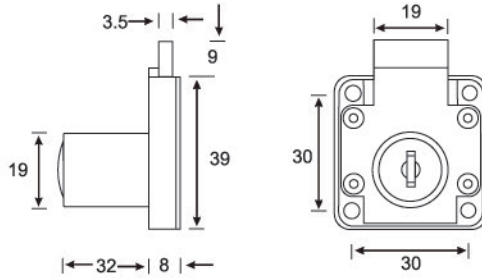

# Drawer Lock Series

## IR-LDJ-408

Description: Glass lock  
Materials: Zinc alloy  
Finish: Chrome plated

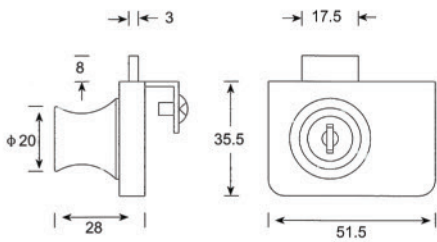

## IR-LDJ-409

Description: Glass lock  
Materials: Zinc alloy  
Finish: Chrome plated

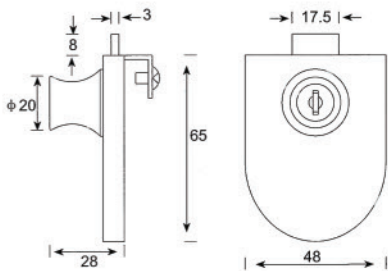

## IR-LDJ-19x20

Description: Hook lock  
Materials: Zinc alloy  
Finish: Chrome plated  
Length: 20mm

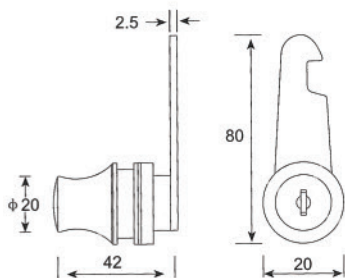

# Door Lock Series



IR-YG-1307

IR-YG-6917

IR-YG-5005-10

IR-YG-SD0504N

IR-YG-8618-16



IR-YG-8623-77

IR-YG-5807-026

IR-YG-X0717

IR-YG-10201

IR-YG-8811



Grade A 85 lockset  
(45x85SS)



Grade A 58 lockset  
(45x58SS)



Grade A 57 lockset  
(45x57SS)



70mm SS



70mm AB



70mm AC



5730 SS



5730 AB

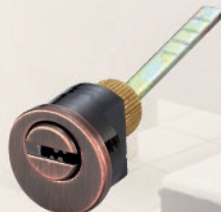

5730 AC



# Steam Dynamic Tension Bar Series

## IR-LDJ-604

Description: Steam dynamic tension bar  
 Materials: SPlastic/Zinc alloy  
 Finish: Satin silver  
 Suitable for 6kg-15kg cabinet door



## IR-LDJ-605

Description: Steam dynamic tension bar  
 Materials: Zinc alloy  
 Finish: Satin silver  
 Suitable for 6kg-15kg cabinet door

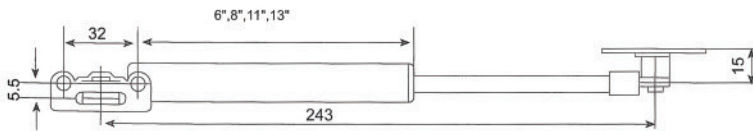
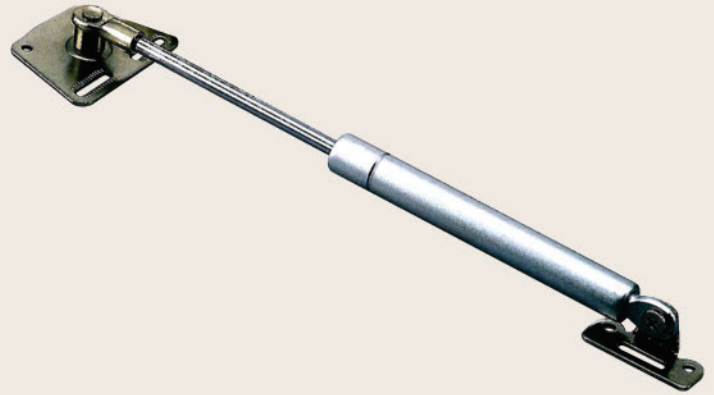

### Installation Illustration

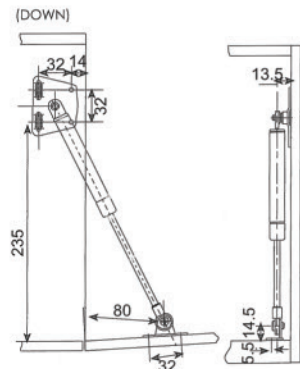
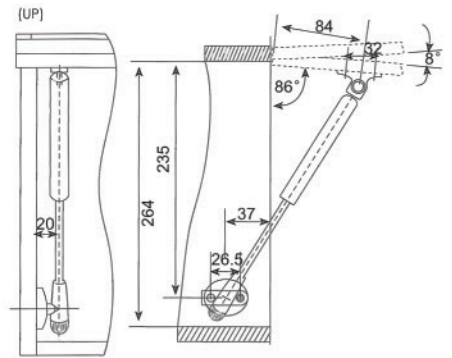
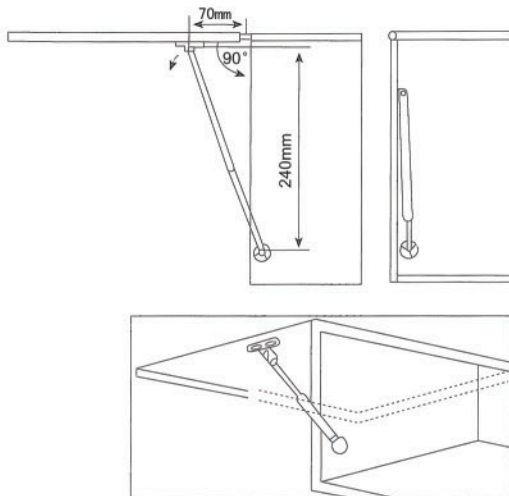



## Air Stapler

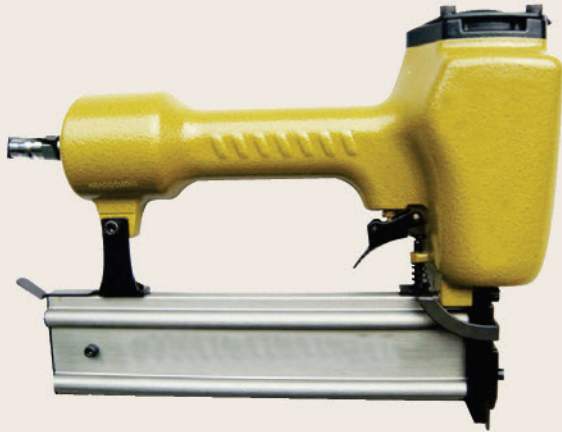

IR-AS-T50/J1013/F30

## Air Stapler Nails

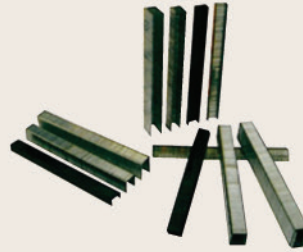

IR-LDJ-J1006, J1010, J1013, J1016, J1019, J1022

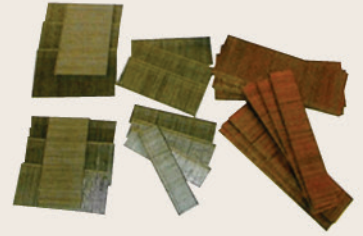

IR-LDJ-T32, T38, T45, T50



IR-LDJ-F10, F15, F20, F25, F30

## Trim Router



IR-FTR

## Trim Bit



IR-FTB

## PVC Edge Banding



IR-PEB

