

# GUARD TOUR MANAGEMENT SYSTEM USER'S MANUAL

SG-09N



# SG-09N Guard Tour System User's Manual

## 1. What is guard tour system?

A guard tour system is a system used to help companies and organizations to organize, log and execute guard tours and patrols in their assets ensuring that the officers will accomplish their tasks within the predefined time intervals. There is a wide variety of guard tour systems, which can be divided in two major categories: Wand guard tour systems based on handheld devices and cloud guard tour systems based on modern mobile and cloud technology. Guard tour systems provide a means to check and record the time that a guard executes his guard tour by scanning specific checkpoints assigned on the area he patrols.



## 2. Applications

warehouse systems  
improving rent a car systems  
monitoring proper service  
supervising personnel work time and place  
monitoring scheduled technical maintenance  
supervising guards  
supervising service producers  
supervising drivers  
monitoring rent systems  
airport protection and supervising workers  
hotel protection and supervising workers  
protection for other public institutions

## 3. Functional Diagram



## Working Prompts

Reading Successfully	1 vibration and the LED screen shows "Reading Successfully" and recording time
2.4G Searching	1 vibration and LED Screen shows "2.4G Searching"
2.4G Searching Failed	3 vibrations and LED Screen shows "2.4G Searching Failed, Please researching "
The data is almost full	2 vibrations and the LED screen shows "Reading Failed, please upload".
The data is already full	6 vibrations and the LED screen shows "Reading Failed, please upload".
Wrong Clock Data	3 vibrations and the LED screen shows "Reading Failed, please timing".
Wrong Storage Data	4 vibrations and the LED screen shows "Reading Failed, please read again".



## 4. Technical Information

Model	SG-09N
Physical	Metal body with silicon shell outside
Dimensions	148mm×42mm×34mm
Weight	243g
Tag reading	RFID
Frequency	125KHz and 2.4G
Reading Distance	125KHz : 3-5cm 2.4G ≥ 30m
Operating Temperature	-40°C to +85°C
Storage Capacity	60,000 pieces records
Memory	16Mb Flash ROM
IP rating	IP67
Charging time	2.5 hours
Battery	3.7V Lithium Recharge Battery
Standby Time	Reading checkpoint 500 times a day , can be used for 3.5 days, Reading checkpoint 500 times and flashlight 2 hours in a day be used for 26 days.
Communication	T8 Download Station
Humidity	10% to 90% non-condensing

## RFID Tags

Model	Checkpoint	Frequency	Dimensions	Weight
WM-28B		125kHz	6.6mm*27.7mm	1.7g
WM-226		125kHz	36mm*28mm*6mm	3.8g
WM-30A		125kHz	30mm*4mm	2.8g
WM-70A		125kHz	76mm*56mm*10mm	19g
WM-70Y		125kHz	76mm*56mm*10mm	19g

## 5. System Components

- 1) SG-09N reader
- 2) Standalone Software
- 3) Magnetic cable
- 4) Charger
- 5) Holster
- 6) Checkpoint Tags(optional purchase)
- 7) Guard Tags(optional purchase)
- 8) T8 Download Station(optional purchase)
- 9) Event wallet (optional purchase)
- 10) 2.4G Tags(optional purchase)

## Technical Specifications

### SG-09N

Communication Distance	≤10m
Reading Distance	1-3cm
Communication Speed	5000 records per minute
Communication	2.4G+USB (CH341H USB2.0 )
Frequency Range	2400MHz~2483.5MHz
Operating Temperature	-40°C to +85°C
Humidity	10% to 90% non-condensing

### WM-2.4GC

Card Number	8 hexadecimal number
Battery	CR123A-3.0V Disposable Lithium Battery
Reading Distance	≥30m
Frequency Range	2400MHz~2483.5MHz
Operating Temperature	-40°C to +85°C
Humidity	10% to 90% non-condensing
Standby time	3 Years

## Working Prompts

### SG-09N

Power on	The read light is always on
2.4G Connecting	The blue light flashes
2.4G data transferring ,delete data	The blue light quickly flashes
2.4G disconnecting	The blue light flashes 1 second and 1 beep
Searching tags	The yellow light flashes
Reading tags	The yellow light flashes and 1 beep

### WM-2.4GC

Power on	3 flashes
Power off	The light off
Standby	The light flashes 1 time during 5 seconds



## How to use 2.4G Card?

### 1) Start the 2.4G card

- 2.4G card is off usually when you receive it in case power consumption since there is battery inside. Battery will be used for about 2 years once it is on.
- Before installing it on the wall, we need start it --- using little wrench we provided together with the card to insert the hole, you will feel to touch a rubber button inside and once it is on, you will feel there is a little "click" feeling...
- Once the red light is blinking, and later it will be keep blinking every 5 seconds, that means the card is on.
- The hole is just like an on/off button.
- Please note: DO NOT use too sharp thing to poke the hole heavily to break it.

Please check below picture



## 2) Start 2.4G function for SG-09N reader

- SG-09N can read both 125Khz card and 2.4G card.
- reader will keep scanning 125K tag at any time since it is always in "on" situation because this will not take so much power...
- while once reading 2.4G, we need press the LCD screen and once the "CLICK" logo showing on the screen, do not move finger from the button, keep pressing it for 2 seconds, then 2.4G reading function is starting
- when reader scan 2.4G card successfully, it will show "read ok" on the screen with one vibration, then screen will shut down.



## 6. User Flow

- 1) Make a sketch of the checking places that the guard needs to check.
- 2) Install tags on each checking place.
  - \*The round shape tag can be stuck or screwed on the wall.
  - \*For the cylinder glass tag, make a hole in the wall, and then put it inside and cover it.
- 3) Install software and make settings in software
- 4) The guard uses the reader to starts to patrol, he needs go to each checking place and uses the reader to scan tags installed on the wall.
- 5) The guard will take the reader back to the control center and use T8 download station to upload data to software.

### Installation

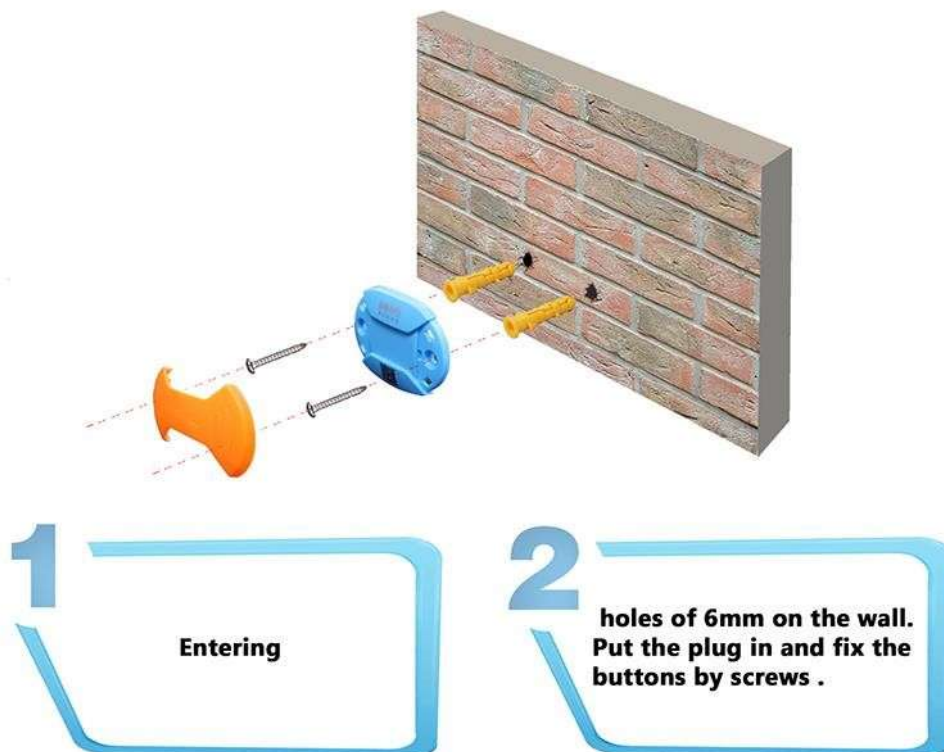

## 7. Warranty Policy

- (1) All products are strictly tested and qualified before sale.
- (2) Hardware devices sold by our company are covered by 1 Year parts warranty.
- (3) During 1 Year warranty period, we will replace or repair units without charge, subject to any problem coming from product itself under ordinary usage condition. The 1 Year warranty period begins when the new products are received by customer. We warrant its remanufactured products and non-warranty repair to hardware from defects in material and workmanship for a period of 60 days. The 60 days warranty period begins the date when repair or remanufactured product is shipped from us.
- (4) This warranty does not apply on batteries and extra parts. This warranty is invalid if the product has been damaged by accident, abuse, misuse, product end of life, or misapplication or has been dismantled or repaired without the written permission of our company.
- (5) In any condition, freight will be paid by customer.

Thank you so much for choosing our guard tour system! If you have any question on our product, please feel free to contact us or local dealer and we still try our best to help you!