

# GUARD TOUR MANAGEMENT SYSTEM USER'S MANUAL

SG-10N



# SG-10N Guard Tour System User's Manual

## 1. What is guard tour system?

A guard tour system is a system used to help companies and organizations to organize, log and execute guard tours and patrols in their assets ensuring that the officers will accomplish their tasks within the predefined time intervals. There is a wide variety of guard tour systems, which can be divided in two major categories: Wand guard tour systems based on handheld devices and cloud guard tour systems based on modern mobile and cloud technology. Guard tour systems provide a means to check and record the time that a guard executes his guard tour by scanning specific checkpoints assigned on the area he patrols.



## 2. Applications

warehouse systems  
improving rent a car systems  
monitoring proper service  
supervising personnel worktime and place  
monitoring scheduled technical maintenance  
supervising guards  
supervising service producers  
supervising drivers  
monitoring rentsystems  
airport protection and supervising workers  
hotel protection and supervising workers  
protection for other public institutions

## 3. Functional Diagram



## Working Prompts

Solid red light	Charging
Solid green light	Full charge
1 vibration with 1 flash of blue light	Reading is successful
2 vibrations with 2 flashes of blue light	The reader RAM is almost full
3 vibrations with 3 flashes of white light	The time of the reader is wrong
4 vibrations with 4 flashes of white indicator	The data storage is wrong
6 vibrations with 6 flashes of white indicator	Reader RAM is full
Red light once three seconds	The reader is low power



## 4. Technical Information

<b>Model</b>	<b>SG-10N</b>
Physical	Metal body with silicon shell outside
Dimensions	144mm*47mm*30mm
Weight	243g
Tag Reading	RFID
Frequency	125KHz
Reading Distance	3-5cm
Operating Temperature	-40°C to +85°C
Storage Capacity	60,000 pieces records
Memory	16Mb Flash ROM
IP Rating	IP67
Charging Time	2.5 hours
Battery	3.7V Lithium Recharge Battery
Standby Time	Reading checkpoint 500 times a day , can be used for 29 days.
Communication	USB magnetic cable
Humidity	10% to 90% non-condensing

## RFID Tags

Model	Checkpoint	Frequency	Dimensions	Weight
WM-28B		125kHz	6.6mm*27.7mm	1.7g
WM-226		125kHz	36mm*28mm*6mm	3.8g
WM-30A		125kHz	30mm*4mm	2.8g
WM-70A		125kHz	76mm*56mm*10mm	19g
WM-70Y		125kHz	76mm*56mm*10mm	19g

## 5. System Components

- 1) SG-10N reader
- 2) Magnetic cable
- 3) Software
- 4) Charger
- 5) RFID tags (optional purchase)
- 6) Guard ID cards (optional purchase)
- 7) Event wallet (optional purchase)

## 6. User Flow

- 1) Make a sketch of the checking places that the guard needs to check.
- 2) Install tags on each checking place.
  - \*The round shape tag can be stuck or screwed on the wall.
  - \*For the cylinder glass tag, make a hole in the wall, and then put it inside and cover it.
- 3) Install software and make settings in software
- 4) The guard uses the reader to verify his fingerprint first and starts to patrol (before read each checkpoint, need verify fingerprint); he need go to each checking place and use the reader to scan tags installed on the wall.
- 5) The guard will take the reader back to the control center and use USB cable to upload data to software.

### Installation

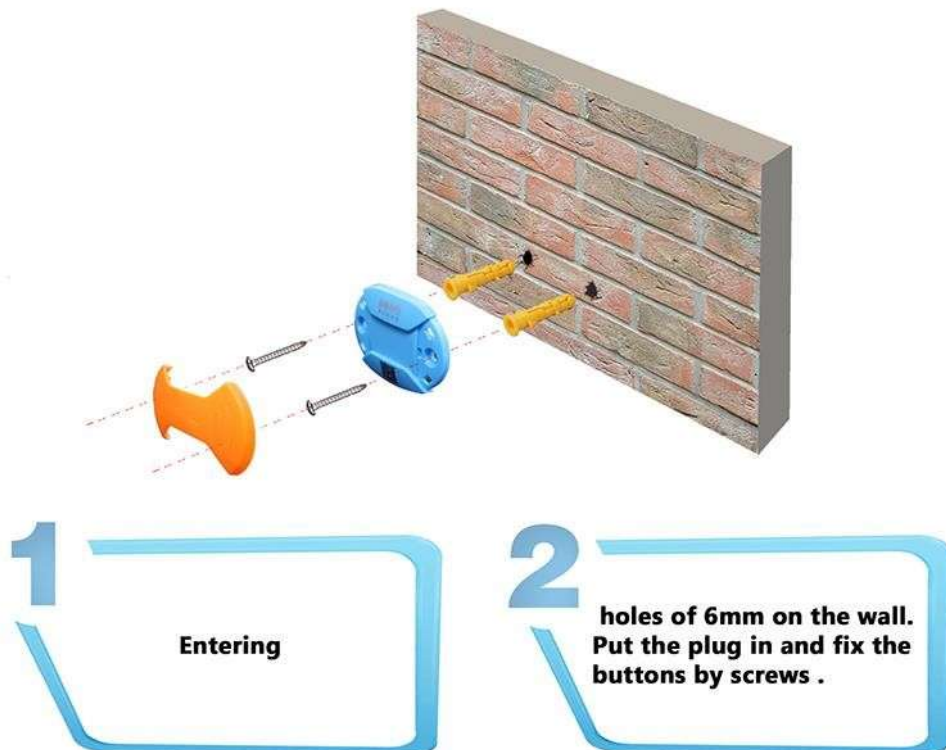

## 7. Warranty Policy

- (1) All products are strictly tested and qualified before sale.
- (2) Hardware devices sold by our company are covered by 1 year parts warranty.
- (3) During 1 year warranty period, we will replace or repair units without charge, subject to any problem coming from product itself under ordinary usage condition. The one year warranty period begins when the new products are received by customer. We warrant its remanufactured products and non-warranty repair to hardware from defects in material and workmanship for a period of 60 days. The 60 days warranty period begins the date when repair or remanufactured product is shipped from us.
- (4) This warranty does not apply on batteries and extra parts. This warranty is invalid if the product has been damaged by accident, abuse, misuse, product end of life, or misapplication or has been dismantled or repaired without the written permission of our company.
- (5) In any condition, freight will be paid by customer.

Thank you so much for choosing our guard tour system! If you have any question on our product, please feel free to contact us or local dealer and we still try our best to help you!