

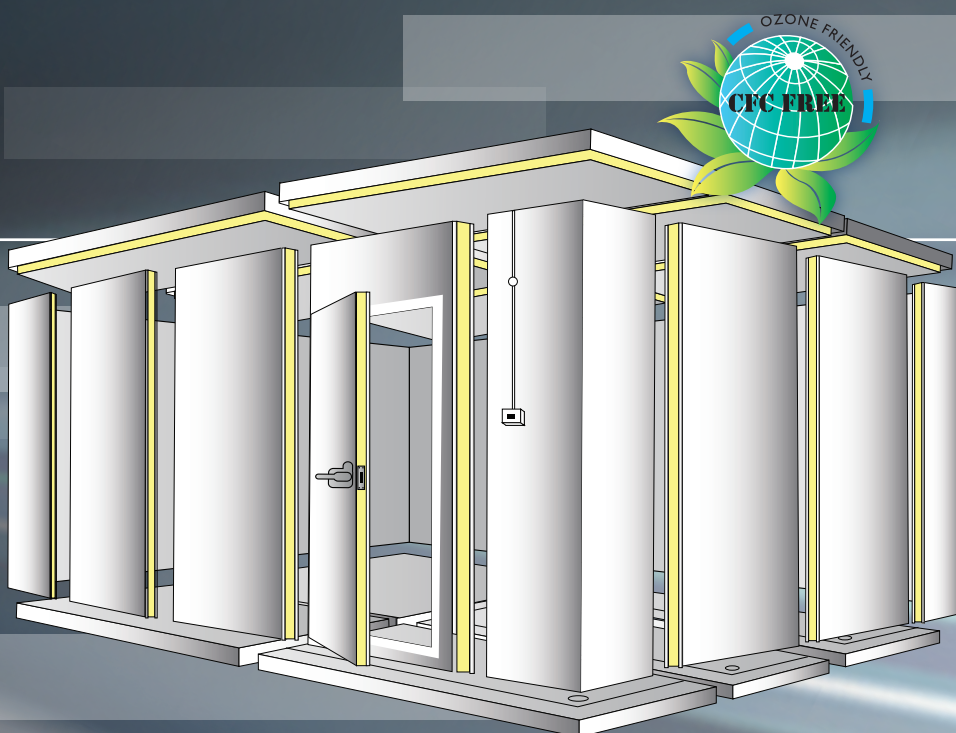

the NEW DEFINITION to
Green Refrigeration & Air-Conditioning

PUR & PIR Panels

- Light weight
- Fire Resistant
- Weather Resistant
- Chemically stable product
- Customized size & materials



MY-GP Series Panels

GREFAC specializes in manufacturing rigid insulation panels - POLYURETHANE (PUR) & POLYISOCYANURATE (PIR) foams. PUR Foams decompose approximately temperature of 200°C and carbonization combustion in 20% compare PIR Foams only decompose in temperature of 325°C and carbonization combustion reached up to 50%.

Advantages of GREFAC Polyurethane Panels

- Excellent ratio of Insulation Property-Weight
- Light weight with excellent Structural Strength
- Fire Resistant Complying to:
 - BS 476 : Part 7 – Class 1;
 - BS 476 : Part 6 – Class O
- Weather Resistant
- Chemically stable product
- Pre-fabricated to suit site condition, the panels can be customized to any size & different type of surface materials

MODEL NOMENCLATURE

MY	–	G	–	PIR	–	100	S
Made		Brand		Series		Panel Thickness	Joint Type
Product of Malaysia		GREFAC		Description Polyisocyanurate Foam Polyurethane Foam Code PIR PUR		Description 040 050 075 100 125 150 175 200 250	Description Standard Joint Fire Rated Joint Fire Rated 2 Joint Code S F F2

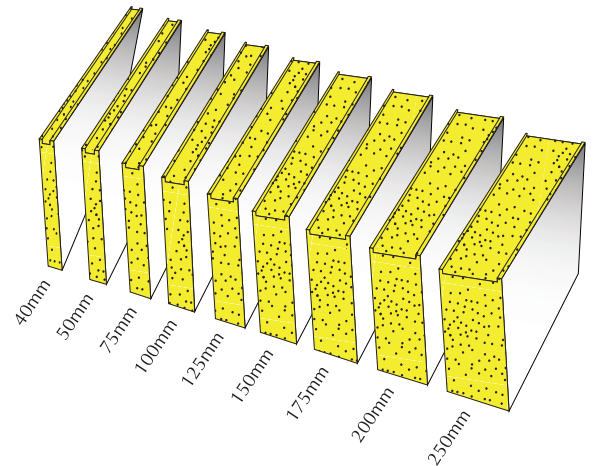

The panels in variable thickness from 40mm to 250mm. Please consult our sales team for recommendation of the panel thickness.

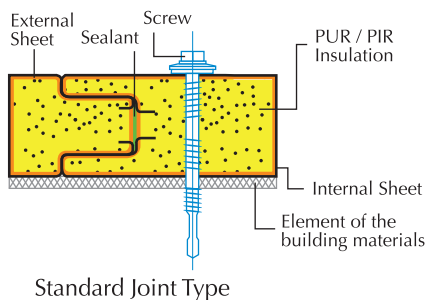

Standard Joint Type

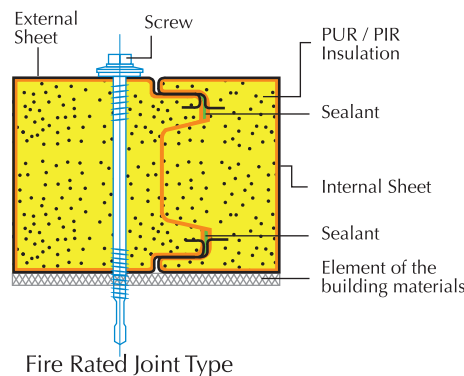

Fire Rated Joint Type

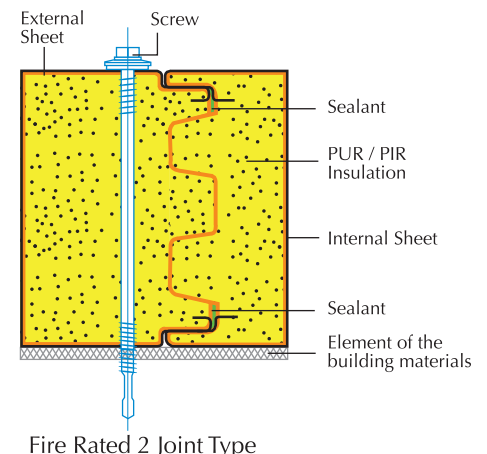

Fire Rated 2 Joint Type

SPECIFICATION

Model	Width	Panel Thickness (mm)	Standard Thickness of Facing*		Panel Weight (kg/m)	U Value (W/m²K)
			External (mm)	Internal (mm)		
MY-GPIR/PUR-040S	1150	40	0.5	0.5	11.52	0.600
MY-GPIR/PUR-050S	1150	50	0.5	0.5	12.00	0.480
MY-GPIR/PUR-075S	1150	75	0.5	0.5	12.96	0.320
MY-GPIR/PUR-100S	1150	100	0.5	0.5	14.28	0.240
MY-GPIR/PUR-100F	1000	100	0.5	0.5	12.52	0.240
MY-GPIR/PUR-125F	1000	125	0.5	0.5	13.48	0.192
MY-GPIR/PUR-150F	1000	150	0.5	0.5	14.52	0.160
MY-GPIR/PUR-175F2	1000	175	0.5	0.5	15.52	0.137
MY-GPIR/PUR-200F2	1000	200	0.5	0.5	16.52	0.120
MY-GPIR/PUR-250F2	1000	250	0.5	0.5	18.52	0.096

* Note :

- Facing thickness is available for 0.35mm, 0.45mm, 0.5mm, 0.6mm, 0.7mm (Other thickness may subject to minimum order quantity)
- Facing material are GI & PPGI (Aluminium & Stainless Steel is subject to minimum order quantity)
- Panel weight is calculated based on facing 0.5mm thickness and PIR/PUR density is minimum 40 kg/m3



Factory Continuous Lamination Double Belt Production Technology Machine

Insulated Doors & Accessories

Some of the strongest insulated doors in the industry are marketed by us.

Our Swing & Sliding Doors have been highly recommended for the most demanding clients.

SLIDING DOOR

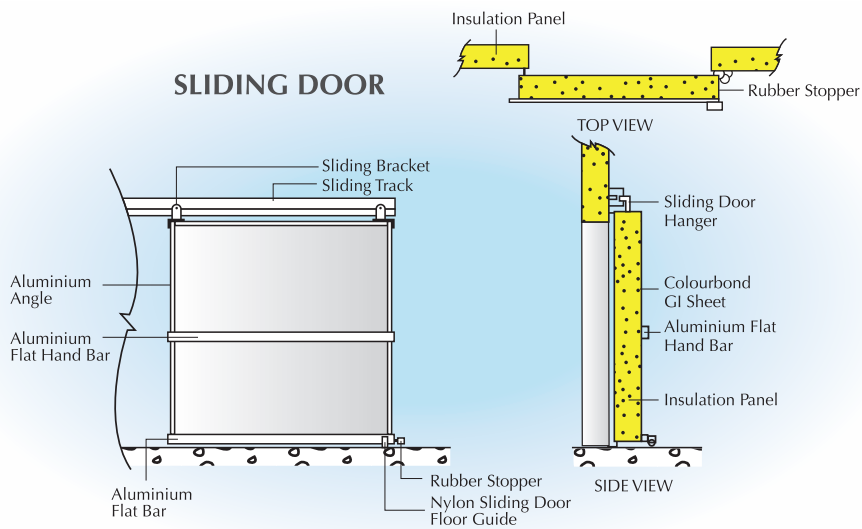

SWING DOOR

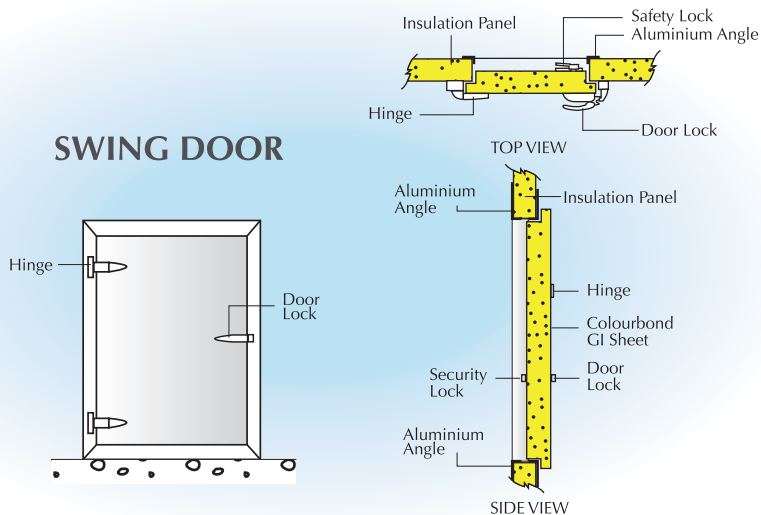

TYPICAL PHYSICAL PROPERTIES

PHYSICAL PROPERTIES	RESULTS
Injected Density	$\geq 40 \text{ kg / m}^3$
Thermal Conductivity	$\leq 24 \text{ mW / m.K}$
Compressive Stress	$\geq 0.08 \text{ MPa}$
Dimensional Stability	$\pm 3\%$
Water Absorption	$\leq 4\%$
Closed Cells Content	$\geq 90\%$
Flexural Strength	$\geq 0.08 \text{ MPa}$
Tensile Strength	$\geq 0.08 \text{ MPa}$
Water Vapor Transmission	1.8 - 3.8 Perm-in
Stable Operating Temperature	-40°C to $+80^\circ\text{C}$

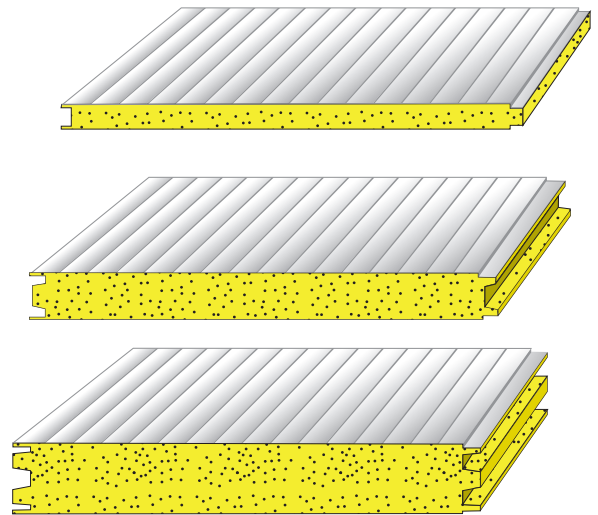

PANEL JOINT TYPE

We have a wide range of superior quality joints to speed up the installation of ceiling, floors & walls. Typical examples of these joints are illustrated below.

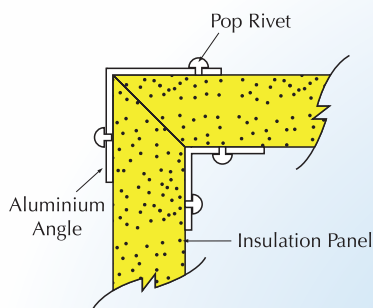

MITRE Joint

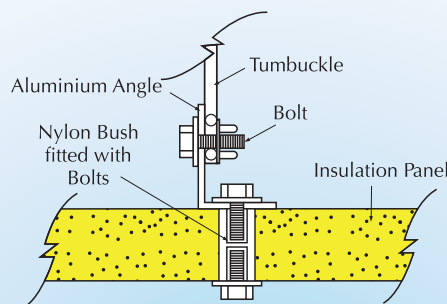

SUSPENSION Joint

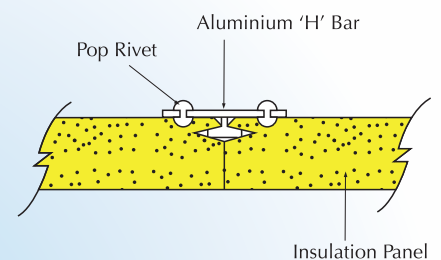

'H' BAR Joint

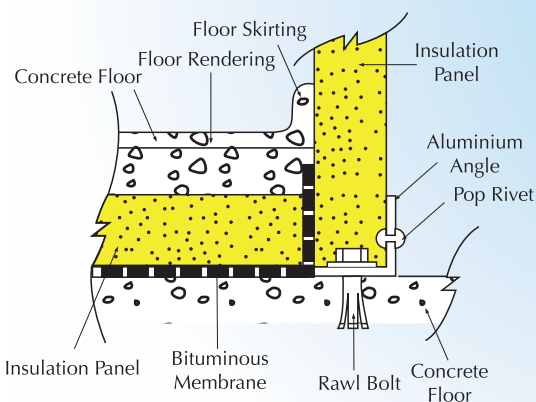

FLOOR Joint

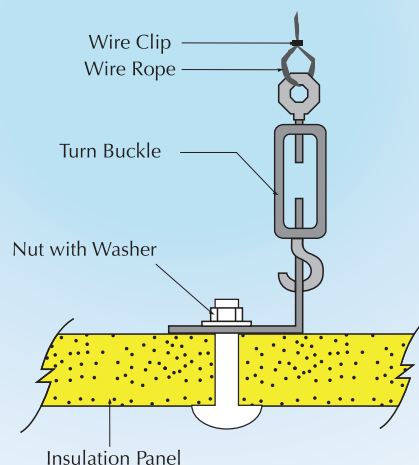

HANGING Profiles & Suspension

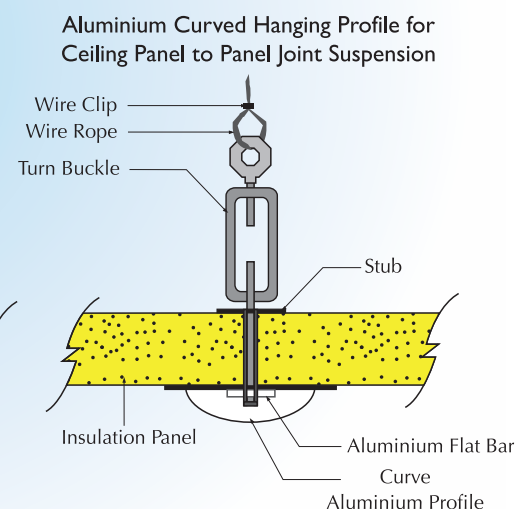

CONTACT :

grefac (M) SDN. BHD. (791843-H)

24, Jalan 6/91, Taman Shamelin Perkasa, 56100 Cheras, Kuala Lumpur. Tel : **603-9281 1323** Fax : **603-9282 4609**
email : chtan@lanhoe.com.my www.lanhoe.com.my