

SC15G

Universal Compressor

R134a

220-240V 50Hz

Data Sheet (Replaces CD.44.K5.02)

General

Compressor	SC15G
Code number	104G8520
Code number	104G8525
Code number compressor with oil cooler	104G8530

Application

Application		LBP/HBP
Evaporating temperature range	°C	-25 to 15
Voltage range	V/Hz	LBP: 187 - 254 /50
		LBP: 198 - 254 /60
		HBP: 198 - 254 /50
Motor type		CSIR
Max. ambient temperature	°C	43
Comp. cooling at ambient temp.	32°C	LBP: O/F ₁
		HBP: F ₂
	38°C	LBP: O/F ₁
		HBP: F ₂
43°C	LBP: O/F ₁	
	HBP: F ₂	

Design

Displacement	cm ³	15.28
Oil quantity	cm ³	550 (500 on comp. with oil cooler)
Maximum refrigerant charge	g	1300
Free gas vol. in compressor	cm ³	1410
Weight without electrical equipment	kg	13.1

Motor

Motor size	watt	385
LRA (rated after 4 sec. UL984) HST	A	14.8
Cut-in current HST	A	14.8
Resistance, main and start winding (25°C)	Ω	5.0/13.7
Approvals		EN 60335-2-34

Dimensions

		104G8530	104G8520	104G8525
Height	mm	A	209	
		B	203	
		B1	183	
		B2	100	
Suction connector	location/I.D. mm	C	10.2 ±0.09	10.2 ±0.09
Process connector	location/I.D. mm	D	6.2 ±0.09	6.5 ±0.09
Discharge connector	location/I.D. mm	E	6.2 ±0.09	6.5 ±0.09
Oil cooler	location/I.D. mm	F	6.2 ±0.09	
Compressors on a pallet	pcs.		80	

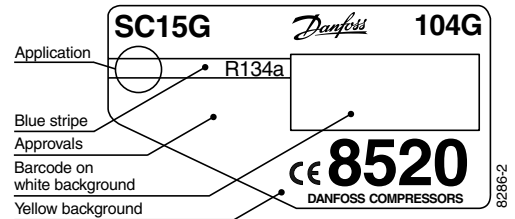

- S = Static cooling normally sufficient
- O = Oil cooling
- F₁ = Fan cooling 1.5 m/s
(compressor compartment temperature equal to ambient temperature)
- F₂ = Fan cooling 3.0 m/s necessary

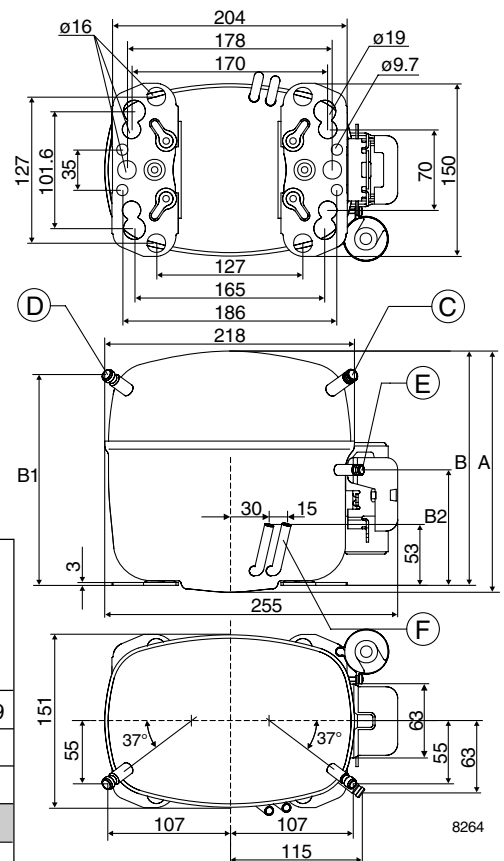

Capacity (EN 12900/CECOMAF)
watt

Comp.\°C	-25	-23.3	-20	-15	-10	-5	0	5	7.2	10	15
SC15G	164	206	290	424	568	728	908	1110	1207	1340	1600

Capacity (ASHRAE)
watt

Comp.\°C	-25	-23.3	-20	-15	-10	-5	0	5	7.2	10	15
SC15G	203	255	358	523	703	901	1124	1377	1499	1665	1993

Power consumption
watt

Comp.\°C	-25	-23.3	-20	-15	-10	-5	0	5	7.2	10	15
SC15G	233	259	307	376	440	497	549	595	613	634	667

Current consumption
A

Comp.\°C	-25	-23.3	-20	-15	-10	-5	0	5	7.2	10	15
SC15G	2.21	2.28	2.40	2.59	2.78	2.99	3.20	3.42	3.52	3.64	3.88

COP (EN 12900/CECOMAF)
W/W

Comp.\°C	-25	-23.3	-20	-15	-10	-5	0	5	7.2	10	15
SC15G	0.71	0.80	0.95	1.13	1.29	1.46	1.65	1.87	1.97	2.11	2.40

COP (ASHRAE)
W/W

Comp.\°C	-25	-23.3	-20	-15	-10	-5	0	5	7.2	10	15
SC15G	0.87	0.99	1.17	1.39	1.60	1.81	2.05	2.31	2.44	2.62	2.99

Test conditions	EN 12900/CECOMAF	ASHRAE
Condensing temperature	55°C	55°C
Ambient and suction gas temp.	32°C	32°C
Liquid temperature	55°C	32°C
Fan cooling F ₂ , 220V 50Hz		

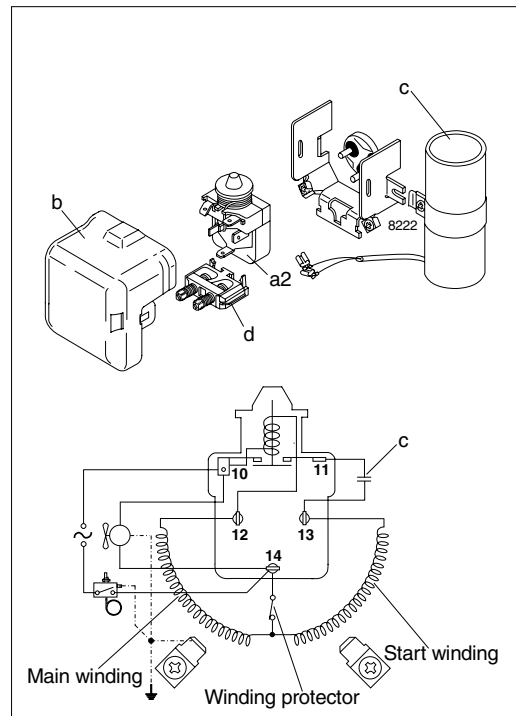
Accessories

Devices	Fig.	SC15G
Starting relay	a2	117U6005
Cover	b	103N2009
Starting capacitor 80 µF	c	117U5017
Cord relief	d	103N1004
Mounting accessories		
Bolt joint for one compressor		118-1917
Bolt joint in quantities		118-1918
Snap-on in quantities		118-1919