

Tag:

**Fan Selection**

Fan Type Axial Fan (Medium Casing)  
 Unit TDA 710/12AA/7-7/28° (186)  
 Operating Conditions Ducted  
 Required Volume 18000 m<sup>3</sup>/h  
 Required Pressure (Ps) 1.000 in. wg.  
 Air Volume 18465 m<sup>3</sup>/h (103%)  
 Static Pressure 1.052 in. wg. (105%)  
 Velocity Pressure 0.398 in. wg.  
 Total Pressure 1.450 in. wg.  
 Outlet Velocity 13.0 m/s  
 Fan Total Efficiency 65.2 %  
 Fan Static Efficiency 47.3 %  
 Fan Speed 1420 rpm  
 Air Temperature 20.0 °C  
 Altitude 0 m  
 Fan Absorbed Power 2.84 kW  
 FEG

**Motor Selection**

Recommended Motor 3.00kW(4P D100L)  
 Motor Speed 1420 rpm  
 Service Factor 6 %

**Operating Limits**

Max. Absorbed Power 20.00 kW  
 Max. Fan Speed 1800 rpm

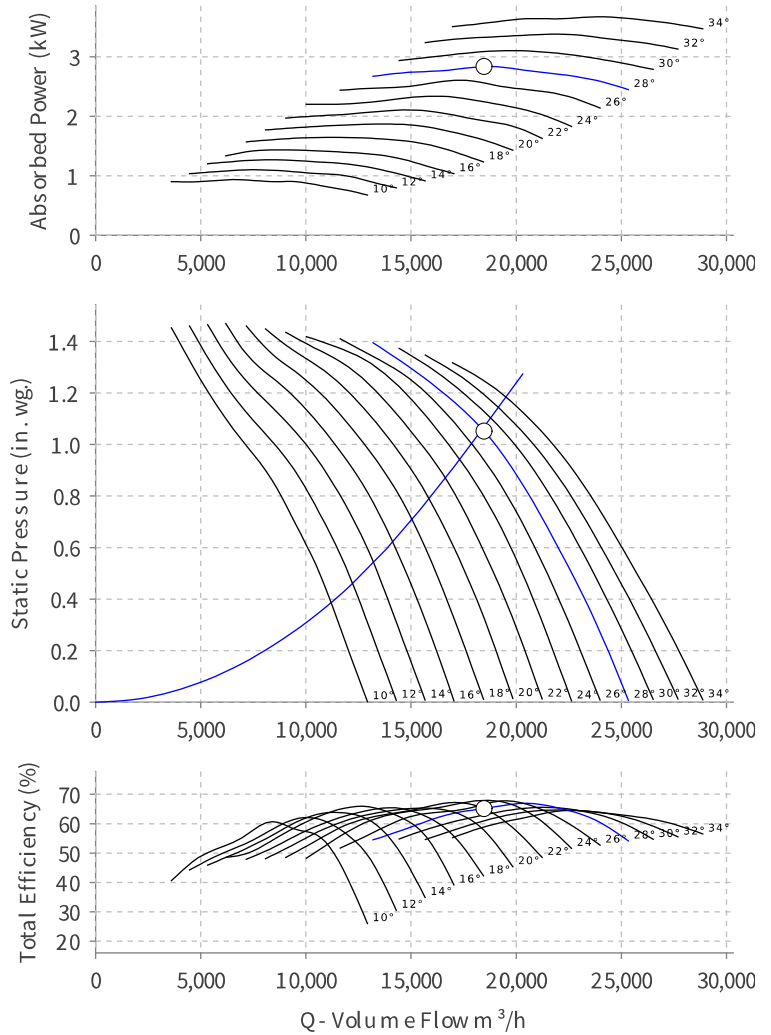

Hz	63	125	250	500	1k	2k	4k	8k	Overall
Lwi(Lin)	87	94	90	89	87	84	81	78	98 dB
Lwi(A)	61	78	82	86	87	85	82	77	92 dB(A)
Lpi(A)	41	58	61	65	67	65	62	56	72 dB(A)

\* Sound data is for the inlet side \* Sound Pressure Level 3.0 m, Free Field

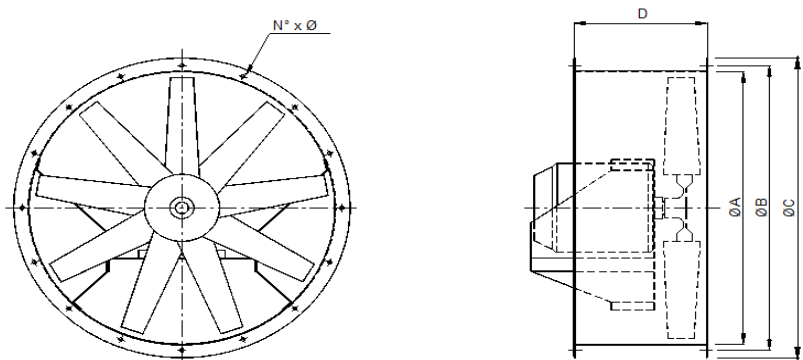

ØA	ØB	ØC	D	KG*	N°xØ
710	755	810	406	30	18x12

\*weight excludes motor and drive