

Tag:

Fan Selection

Fan Type Axial Fan (Medium Casing)
 Unit TDA 900/14AA/7-7/12° (186)
 Operating Conditions Ducted
 Required Volume 10000 m³/h
 Required Pressure (Ps) 500.0 Pa
 Air Volume 10077 m³/h (101%)
 Static Pressure 512.4 Pa (102%)
 Velocity Pressure 11.5 Pa
 Total Pressure 523.9 Pa
 Outlet Velocity 4.4 m/s
 Fan Total Efficiency 47.7 %
 Fan Static Efficiency 46.7 %
 Fan Speed 1440 rpm
 Air Temperature 20.0 °C
 Altitude 0 m
 Fan Absorbed Power 3.06 kW
 FEG

Motor Selection

Recommended Motor 4.00kW(4P D112M)
 Motor Speed 1440 rpm
 Service Factor 31 %

Operating Limits

Max. Absorbed Power 40.00 kW
 Max. Fan Speed 1800 rpm

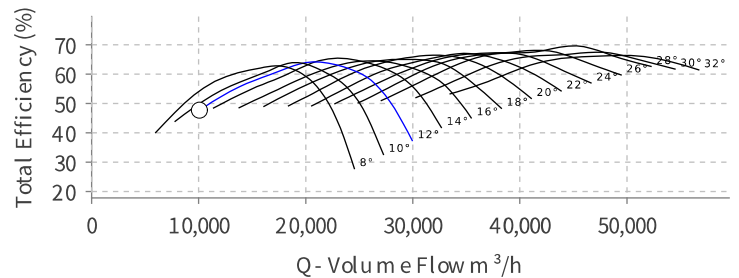
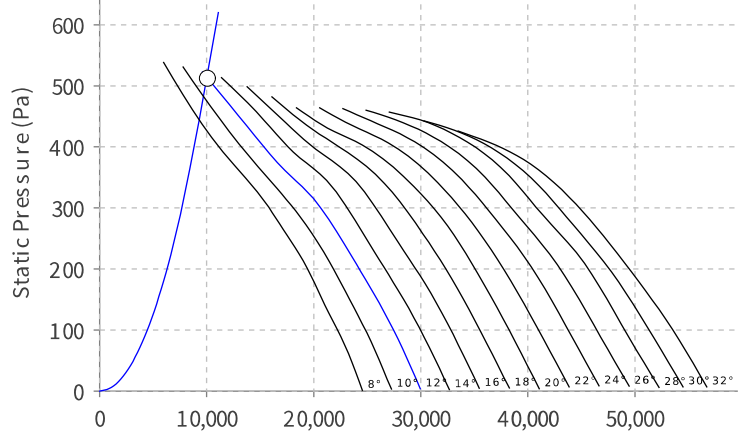
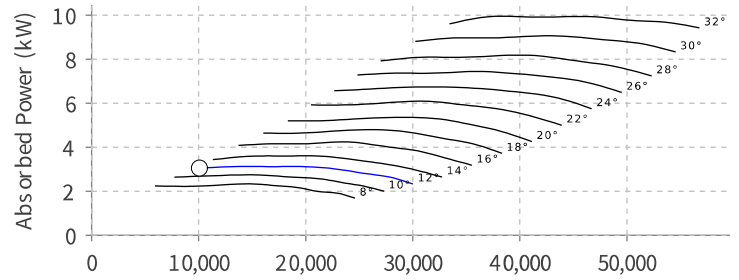

Hz	63	125	250	500	1k	2k	4k	8k	Overall
Lwi(Lin)	88	94	90	89	87	84	81	78	98 dB
Lwi(A)	61	78	82	86	87	86	82	77	93 dB(A)
Lpi(A)	41	58	61	66	67	65	62	57	72 dB(A)

* Sound data is for the inlet side * Sound Pressure Level 3.0 m, Free Field

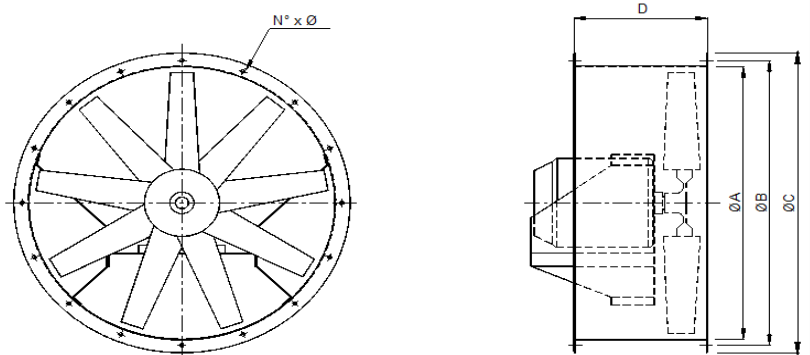

ØA	ØB	ØC	D	KG*	N°xØ
900	945	1000	495	51	18x12

*weight excludes motor and drive