

Tag:

Fan Selection

Fan Type	Axial Fan (Medium Casing)
Unit	TDA 630/12AA/9-9/34° (200)
Operating Conditions	Ducted
Required Volume	16500 m ³ /h
Required Pressure (Ps)	200.0 Pa
Air Volume	16544 m ³ /h (100%)
Static Pressure	201.1 Pa (101%)
Velocity Pressure	128.0 Pa
Total Pressure	329.1 Pa
Outlet Velocity	14.7 m/s
Fan Total Efficiency	64.5 %
Fan Static Efficiency	39.4 %
Fan Speed	1420 rpm
Air Temperature	20.0 °C
Altitude	0 m
Fan Absorbed Power	2.34 kW
FEG	

Motor Selection

Recommended Motor	3.00kW(4P D100L)
Motor Speed	1420 rpm
Service Factor	28 %

Operating Limits

Max. Absorbed Power	15.00 kW
Max. Fan Speed	1800 rpm

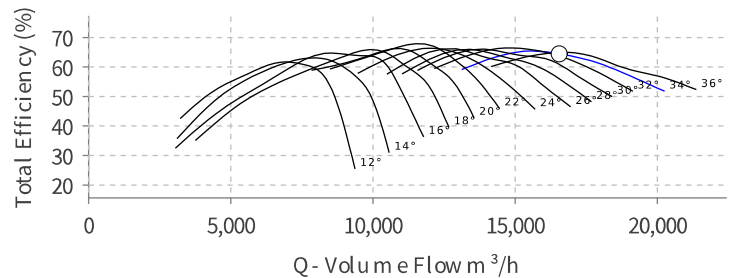
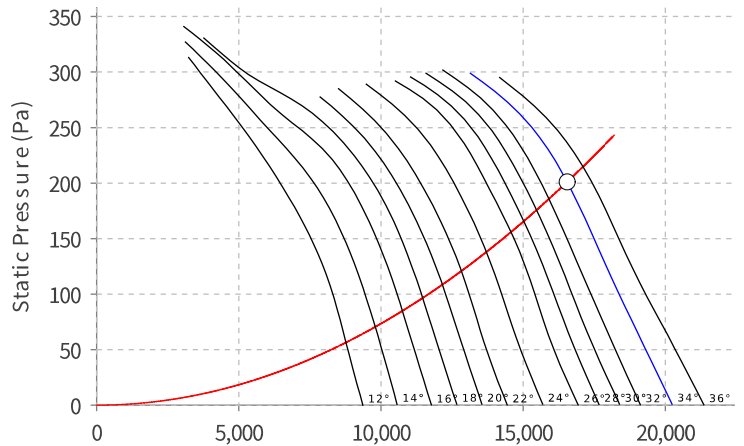
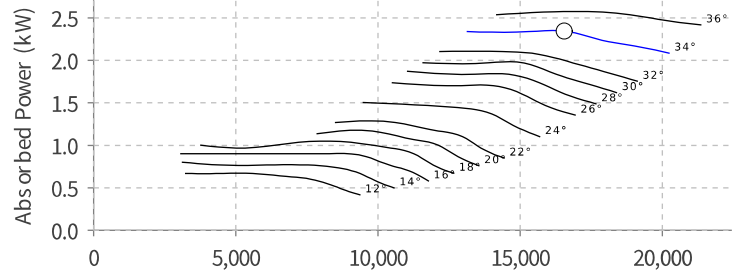

Hz	63	125	250	500	1k	2k	4k	8k	Overall
Lwi(Lin)	86	87	95	88	86	83	80	77	97 dB
Lwi(A)	60	71	86	85	86	84	81	76	92 dB(A)
Lpi(A)	39	50	66	64	65	63	60	55	71 dB(A)

* Sound data is for the inlet side * Sound Pressure Level 3.0 m, Free Field

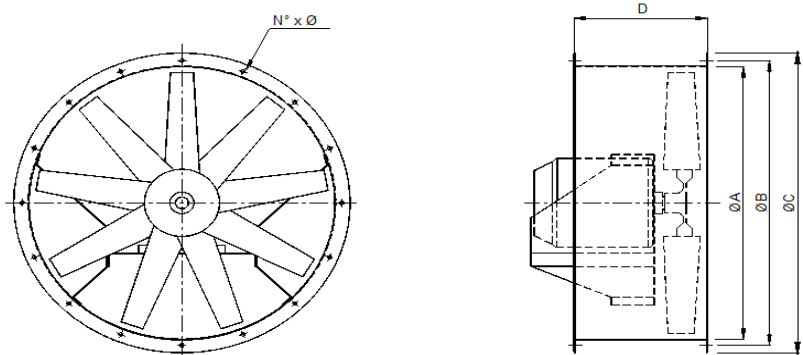

ØA	ØB	ØC	D	KG*	N°xØ
630	675	730	346	18	12x10

*weight excludes motor and drive