

WBL-20S / WBL-21S



FEATURES

- 1/3" IT CCD
- High Resolution : 600TV Lines
- Built-in Fixed (f=3.8mm or 6mm)
- A.I. IR Technology
- Built-in IR LED(12EA)
- Min Illumination : 0.00Lux (B/W, IR LED On)
- Auto White Balance
- Weather Proof Housing
- 50mm in Diameter
- IP66

DIMENSIONS

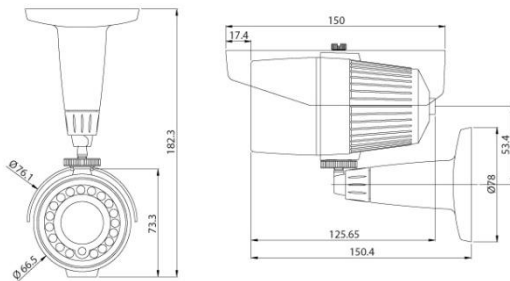

SPECIFICATIONS

	WBL-20S	WBL-21S
Signal System	NTSC	PAL
Scanning System	2:1 Interlace	
Scanning Frequency (H)	15.734 KHz	15.625 KHz
Scanning Frequency (V)	59.94 Hz	50 Hz
Image Sensor	1/3" IT CCD	
Total Pixels	811(H) x 508(V) 410K	795(H) x 596(V) 470K
Effective Pixels	768(H) x 494(V) 380K	752(H) x 582(V) 440K
Horizontal Resolution	600 TV Lines (BW 650TV Lines)	
Video Output	1.0V p-p (75Ω, Composite)	
S/N Ratio	More than 50dB(AGC Off)	
Lens	Built-in Fixed Lens (f=3.8mm or 6mm)	
Min.Illumination	0.05 Lux (Color), 0.00 Lux (IR LED On)	
IR LED and Sensor	Intelligent IR Technology, IR LED 12EA (850nm, 30')	
IR LED Visible Range	Max. 15m	
White Balance	Auto	
AGC	On/Off (Dip Switch)	
Shutter Speed	1/60~1/120,000 sec.	1/50~1/120,000 sec.
Supplied Voltage	DC 12V	
Power Consumption	Max. 6W/0.5A	
Dimensions	62.0 x 123.0mm	
Weight	Approx. 600g	