

Technical parameters:

Model/type	ILS-100N
Detection of objects	NPN output
Connection method	Non-transparent label
Power supply voltage	2 m power cord
Label width	12-24VDC
Label gap	2mm
Control the output	2mm
Sensitivity adjustment	Transistor collector opens the output
Maximum output current	Key adjustment + external control line
Current consumption	100mA
Response time	25mA
Switching frequency	50us
Source polarity reverse protection	10K
Short circuit and overload protection	Built-in
Bright/dark tong	Built-in
Ambient temperature/humidity	Bright/dark pass reversible
IP protection level	- 20 ~ 60 degrees Celsius
Size	Ip66
Shell material	80*12*24mm
	Aluminum alloy/anodizing

Dimensions

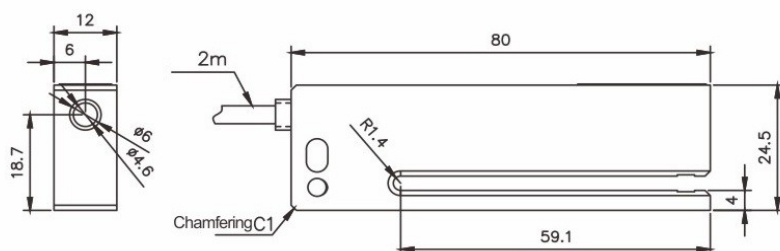

Sensor Configuration

Optimize the sensitivity:

- 1) Long press button "T" for 4sec, release it. Status indicator will keep blinking.
- 2) Pull the label in the forward and reverse direction while the status indicator is blinking.
- 3) Once blinking stops, optimization is completed.

Light/Dark-ON changeover:

- 1) Long press button "T" for 10s and release it.
- 2) After 10s, status indicator will blink once, setting is completed.