

# Spark Arrester

## Spark Arrester

**ISTIQ SPARK ARRESTER** remove sparks, soot and solid matter while preventing noise instead of muffling it. When exhaust gases enter the silencer, a special stationary impeller whirls the gases to throw out all solid matter, and at the same time, partially breaks up the exhaust slugs. Cleaning efficiency is high. Exhaust gases then enter the snubbing section in which the energy of the exhaust slug is further dissipated without interfering with the flow of low energy gases to the atmosphere. Model IXSA Provide Attenuation up to 30 dB.

## Applications

**ISTIQ SPARK ARRESTER** are designed to efficiently reduce inlet and discharge noise of diesel engines, blowers, vacuum pumps, compressors and all situations requiring control of intake or outlet equipment noise.

## Construction

silencers are constructed from heavy gauge controlled cold quenched sheet steel with all welded construction. Internal components are stiffened and braced to minimise resonances and vibration induced fatigue. Flanges are supplied to Table C or American National Standard Institute (ANSI) requirement. Threaded pipe ends are to BSP or metric threads. Drain plugs are fitted as standard for removal of condensate. All external surfaces are finished with high quality silicone based heat resistant aluminium paint which provides lasting protection at temperatures up to 600°C.

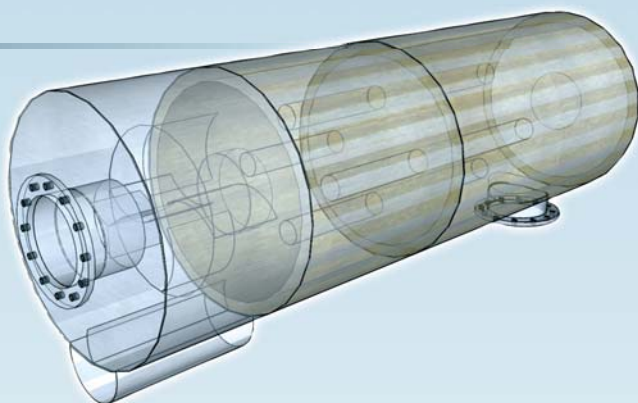

## Selection Guidelines



When designing an exhaust system there are a number of factors that should be considered to maximize the design in terms of performance and cost. A few of the items that should be taken into consideration include:

- Acoustic Environment into which exhaust is discharging
- Engine Rating, i.e.
- Exhaust flow
- Allowable engine back pressure - Engine exhaust outlet noise level
- Engine Exhaust Outlet Design, i.e. single or dual outlets
- Exhaust Piping Arrangement within engine room
- Exhaust Piping Support, Anchoring, and Guiding
- Exhaust Stack Height
- Configuration of Exhaust Silencers, i.e. single or dual inlet



## Model IXSA - Critical & Residential

### DESCRIPTION

**ISTIQ SPARK ARRESTER** is design to reduce noise for continuous running application such as generators and pumping set use for offshore where noise is of prime importance coupled with a spark free exhaust requirement. Where performance dictates, thicker wall and longer shell construction will be constructed. These silencers have internal erosion resistant acoustic material for high performance broadband attenuation, protected by heavy duty perforated sheet.

### APPLICATIONS

As already stated, these units can be used for noise control of gas or steam flows to atmosphere. In the event that you are tasked with the responsibility and designing and selecting an exhaust silencer and piping arrangement, **ISTIQ** can provide direct assistance. If all of the details are supplied, **ISTIQ** will input this information and provide you with our own computer print-out detailing specific recommendations for the exhaust system.

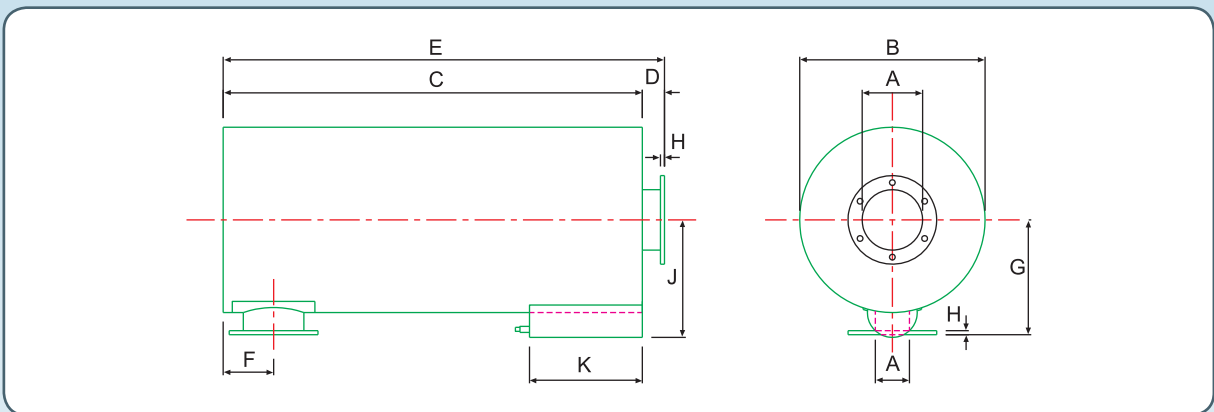

**Dimension in mm**

PIPE DIAMETER (A)	B	C	D	E	F	G	H	J	K	WEIGHT (Kg)
100	460	1250	75	1400	125	305	10	355	280	70
125	460	1450	75	1600	150	305	13	355	430	90
150	560	1650	75	1800	180	355	13	405	430	120
200	660	2000	75	2150	200	405	13	455	430	175
250	760	2420	90	2600	225	470	13	505	430	240
300	920	2820	90	3000	280	550	13	605	585	375
350	1020	3020	90	3200	305	600	16	655	585	590
400	1170	3220	90	3400	330	685	16	730	585	710
450	1270	3600	100	3800	355	735	16	810	735	850

**Attenuation**

Frequency Hz	63	125	250	500	1k	2k	4k	8k
dB	17	27	34	32	28	25	23	26