

Dimension mm:

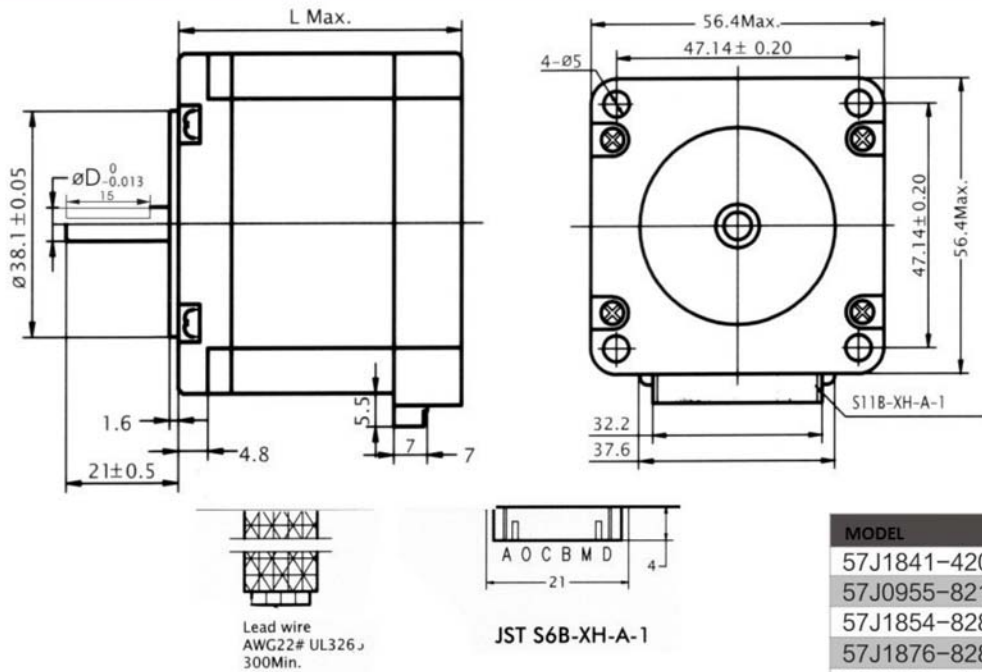

MODEL	D(mm)	F-CUT(mm)
57J1841-420	Φ6.35	平台0.8X15
57J0955-821	Φ6.35	平台0.8X15
57J1854-828	Φ6.35	平台0.8X15
57J1876-828	Φ6.35	平台0.8X15
57J1876-430	Φ8.00	平台0.8X15
57J1880-830	Φ8.00	平台0.8X15

Wiring

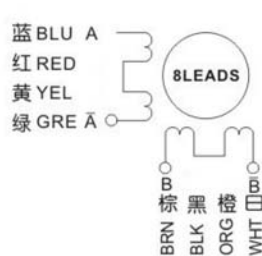

Series Connection (Low Speed)

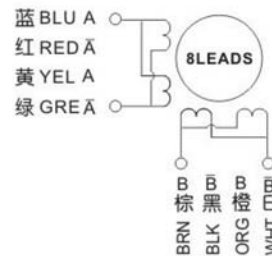

Parallel Connection (High Speed)

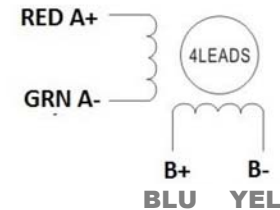

Bi-Polar Connection

Technical Specification

Model	Step Angle (deg)	Holding Torque (N · m)	Current (A)	Resistance (ohms)	Inductance (mH)	Detent Inertia (gcm)	Rotor Inertia (g·cm ²)	Isulation	No. of Lead	Weight (kg)	Length (mm)
57J1841-420	1.8	0.4	2.0	1.4	1.4	220	135	B	4	0.4	41