

Panel(Piping) Type Flowmeter



LZT-10 Series Panel type Flowmeter

Model	Measuring range	Medium	Remarks	
LZT-10005M	0.05~0.5GPM/0.2~2LPM	Water	Without valve	
LZT-1001M	0.1~1GPM/0.5~4LPM			
LZT-1002M	0.2~2GPM/1~7LPM			
LZT-1003M	0.3~3GPM/1~11LPM			
LZT-1005M	0.5~5GPM/2~18LPM			
LZT-1005M-V	0.05~0.5GPM/0.2~2LPM			With valve
LZT-1001M-V	0.1~1GPM/0.5~4LPM			
LZT-1002M-V	0.2~2GPM/1~8LPM			
LZT-1003M-V	0.3~3GPM/1~11LPM			
LZT-1005M-V	1.0~5GPM/2~18LPM			
LZT-10A04M-V	0.4~4SCFM/12~120LPM	Air	With valve	
LZT-10A08M-V	1~8SCFM/24~240LPM			
LZT-10A12M-V	1.2~12SCFM/36~360LPM			
LZT-10A16M-V	1.6~16SCFM/48~480LPM			
LZT-10A24M-V	2.4~24SCFM/72~720LPM			



LZT-1005M

LZT-1002M-V

Dimensions(mm)



LZT-10□□M

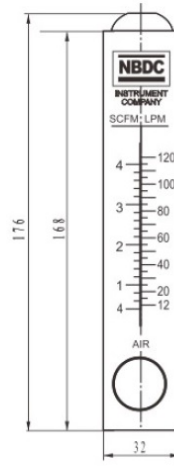
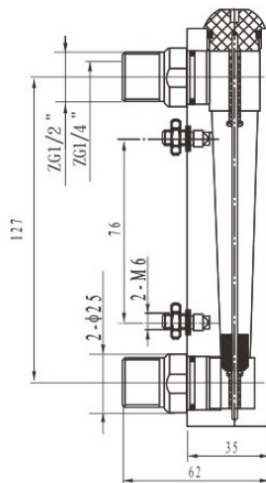

LZT-10□□M-V

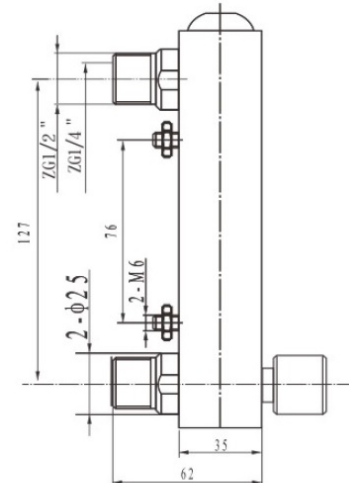

LZT-10A□□M-V LZT-10T□□M-V