

## AC velocity output via 2 Pin MS Connector

## Key Features

- For use with data collector
- AC velocity output
- Side entry for easy access

## Industries

Building services, Pulp and Paper,  
Mining, Metals, Utilities, Automotive,  
Water, Pharmaceutical

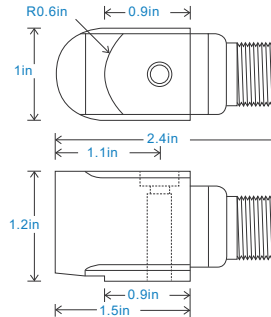

### Connection Details

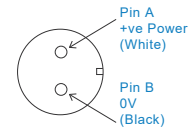

## Technical Performance

Mounted Base Resonance	see 'How To Order' table (nominal)
Sensitivity	see: 'How To Order' table $\pm 10\%$
	Nominal 80Hz at 72°F
Frequency Response	180cpm (3Hz) to 270kcpm (4.5kHz) $\pm 10\%$
	120cpm (2Hz) to 360kcpm (6kHz) $\pm 3\text{dB}$
Isolation	Base isolated
Range	see: 'How To Order' table
Transverse Sensitivity	Less than 5%

## Mechanical

Case Material	Stainless Steel
Sensing Element/Construction	PZT/Compression
Mounting Torque	5.9ft. lbs
Mounting Bolt Provided	see: 'How To Order' table x 1.2in long
Weight	6.5 oz. (nominal) body only
Shielded Cable Assembly	see: <a href="http://www.hansfordsensors.com">www.hansfordsensors.com</a> for options
Connector	HS-AA004 - non-booted
	HS-AA053 or HS-0054 - booted
Mounting Threads	see: 'How To Order' table

## Electrical

Excitation Voltage	18-30Volts DC
Electrical Noise	0.1mg max
Current Range	0.5mA to 8mA
Bias Voltage	10 - 12 Volts DC
Settling Time	2 seconds
Output Impedance	200 Ohms max.
Case Isolation	>10 <sup>8</sup> Ohms at 500 Volts

## Environmental

Operating Temperature Range	-67 to 284°F
Sealing	IP68
Maximum Shock	5000g
EMC	EN61326-1:2013

## Typical Frequency Response

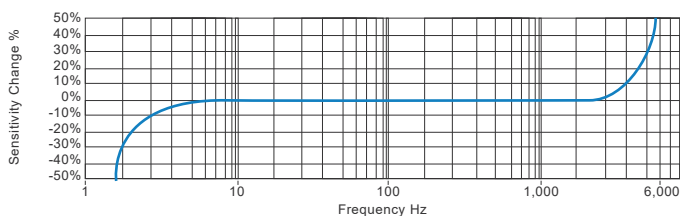

## Applications

Fans, Motors, Pumps, Compressors,  
Centrifuges, Conveyors, Air Handlers,  
Gearboxes, Rolls, Dryers, Presses,  
Cooling, VAC, Spindles, Machine Tooling,  
Process Equipment

Vibration sensor should be firmly fixed to a flat surface (spot face surface may be needed to be produced and cable anchored to sensor body.)

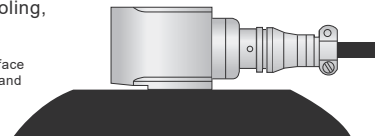

## How To Order

Character	Options
H	HS - Hansford Sensors
S	HS - Hansford Sensors
1	160 - Industrial Vibration Sensor
6	160 - Industrial Vibration Sensor
0	160 - Industrial Vibration Sensor
S	160 - Industrial Vibration Sensor
X	Extra Options (if required) F - Filtered L - 316L Stainless Steel RT - Temperature Output PT100 S - 90° Side Exit T - Temperature Output Y - 5% tolerance on sensitivity
X	Sensitivity 004 - 100mV/in/s 025 - 625mV/in/s (other sensitivities available on request)
X	Range (pk) 40 IPS 10 IPS
X	Resonant Frequency 1,320kcpm (22kHz) 1,320kcpm (22kHz)
X	Cable/Connector 01 - PUR 02 - Braided 07 - Silicon 08 - Flame Retardant 50 - 2 Pin MS 54 - M12
X	Mounting Threads 02 - ¼-28" UNF Male 06 - M6 x 1mm Male 08 - M8 x 1.25mm Male



www.hansfordsensors.com  
sales@hansfordsensors.com

We reserve the right to alter the specification of this product without prior notice

TS133U.7

