



PID HOT RUNNER CONTROL UNIT



Eco HR

Eco HR PID Hot Runner Control Unit

- 3 digit process (PV) and 4 digit set (SV) display
- Process input (TC, RTD)
- Programmable ON/OFF, P, PI, PD and PID control forms
- Adaptation of PID Coefficients to the system with Self-Tune and Auto-Tune
- Programmable Heating or Cooling Functions for Control Output
- Digital input for activate the 2nd set value (optional)
- Selectable Alarm Functions for Alarm Output
- Serial RS485 Communication (optional)

Eco series temperature controllers are designed for measuring and controlling a temperature value. They can be used in many applications with their TC and RTD temperature measurement input, multi-function control outputs, selectable alarm functions.

They are mainly used in glass, plastic, petro-chemistry, textile, automotive and machine production industries. Accurate and advanced controlling is performed with selectable ON-OFF, P, PI, PD, PID and Self Tune/Auto Tune PID functions.

SPECIFICATIONS

Process Input: Thermocouple (TC): J, K, R, S, T and L (IEC584.1) (ITS90)

Thermoresistance (RTD): Cu-50 and PT-100 (IEC751) (ITS90)

Measurement Range: Please refer to process input type selection in process menu parameters section.

Accuracy:

Thermocouple (TC): ($\pm 0.25\%$ of full scale or $\pm 3^\circ\text{C}$, which one is greater) ± 1 digit max.

Thermoresistance (RTD): ($\pm 0.25\%$ of full scale or $\pm 2^\circ\text{C}$, which one is greater) ± 1 digit max.

Cold Junction Compensation: Automatically $\pm 0.1^\circ\text{C}/1^\circ\text{C}$

Line Compensation: Maximum 10 Ohm

Sensor Break Protection: Upscale

Sampling Cycle: 0.1 second

Input Filter: Programmable

Control Form: ON/OFF, P, PI, PD or PID (It can be programmed by the user.)

OUTPUT

Process Output: Relay (5A@250V~ at resistive load) or SSR Driver Output (Maximum 10mA, Max. 12V=)

Alarm Output: Relay (5A@250V~ at resistive load)

SUPPLY VOLTAGE (It must be determined in order)

230V~ ($\pm 15\%$) 50/60Hz - 2VA

115V~ ($\pm 15\%$) 50/60Hz - 2VA

100-240V~ 50/60Hz - 2VA

24V~ ($\pm 15\%$) 50/60Hz - 2VA

24V~ ($\pm 15\%$) 50/60Hz - 2VA

10...30V= - 2W

DISPLAY

Process Display: 16 mm Red 3 digit LED Display

Set Value Display: 9 mm Orange 4 digit LED Display

Led Indicators: PO1 (SSR Process Output Status Led), PO2 (Relay Process Output Status Led), AL1, AL2 (Alarm Output Status Leds), °C, °F LEDs

ENVIRONMENTAL RATINGS AND PHYSICAL SPECIFICATIONS

Operating Temperature: 0...50°C

Humidity: 0-90%RH (none condensing)

Protection Class: IP65 at front, IP20 at rear

Weight: 150 gr.

Dimension: 48 x 48 mm, Depth: 86.5 mm

Panel CutOut: 46 x 46 mm



Electrical Wirings

The Device with One Relay:

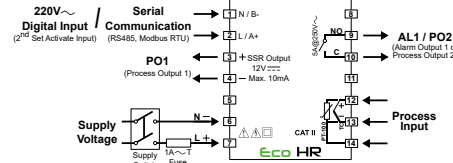

The Device with Two Relays:

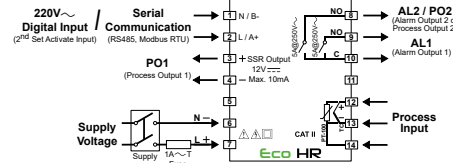

To reduce the effect of electrical noise on device, low voltage line (especially sensor input cable) wiring must be separately from high current and voltage line. If possible, use shielded cable and shield must be connected to ground only one side.

Dimensions

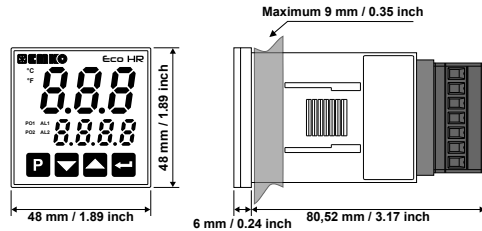

Panel Mounting

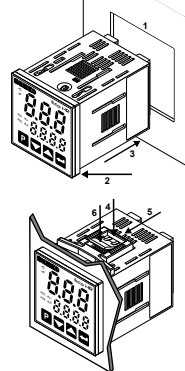

- 1- Before mounting the device in your panel, make sure that the cutout is of the right size.
- 2- Check front panel gasket position.
- 3- Insert the device through the cutout. If the mounting clamps are on the unit, put them before inserting the unit to the panel.

- 4- Insert the mounting clamps to the two of designated holes that located four sides of device.
- 5- Drag the mounting clamps in direction 5 until the device completely immobile within the panel.
- 6- In order to remove device push on the mounting clamp as shown with arrow 6 and pull back.

Access and Change Set Values

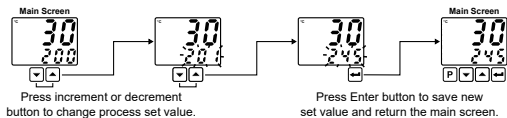

Temperature Set Value Parameter (Default: 200) MODBUS ADDRESS: 40000

Note-1: User can exit from set value section without saving the values by pressing [P] button. If no operation for 120 seconds, device automatically exits from Set Value section.

Note-2: Set value can be adjusted between Set Value Low and High Limit (SUL - SLL).

Easy Access Diagram For Program Parameters

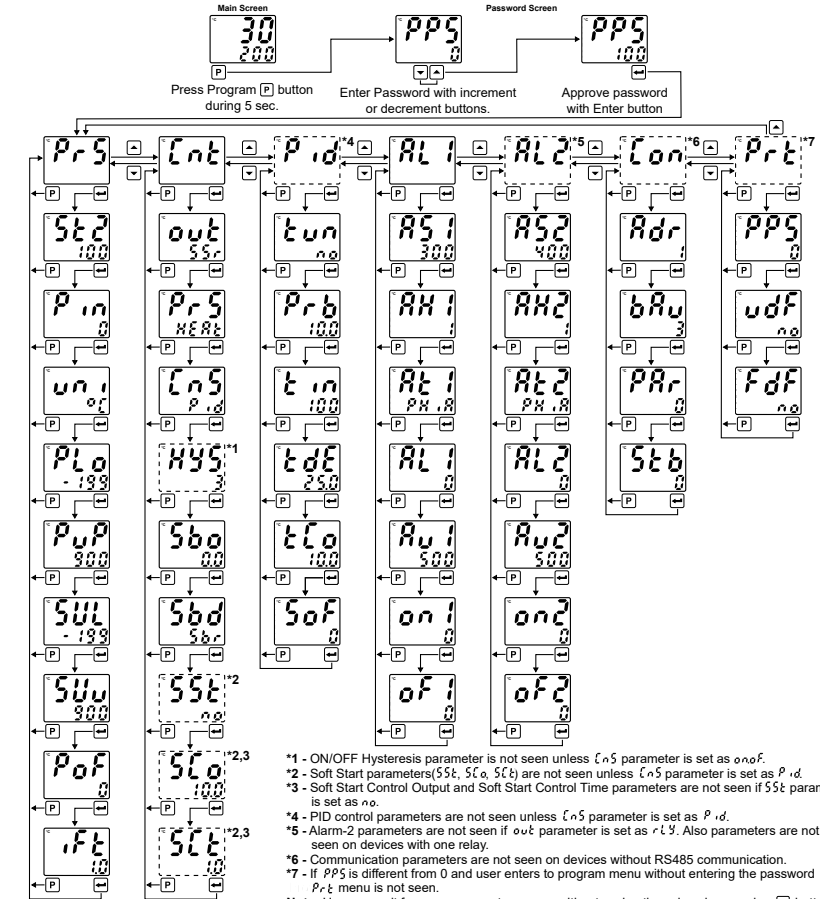

- *1 - ON/OFF Hysteresis parameter is not seen unless CnS parameter is set as onof.
 - *2 - Soft Start parameters (SSt, SCL, SCL) are not seen unless CnS parameter is set as P.d.
 - *3 - Soft Start Control Output and Soft Start Control Time parameters are not seen if SSt parameter is set as no.
 - *4 - PID control parameters are not seen unless CnS parameter is set as P.d.
 - *5 - Alarm-2 parameters are not seen if out parameter is set as rL3. Also parameters are not seen on devices with one relay.
 - *6 - Communication parameters are not seen on devices without RS485 communication.
 - *7 - If PPS is different from 0 and user enters to program menu without entering the password Prt menu is not seen.
- Note:** User can exit from any parameter screen without saving the values by pressing [P] button. If no operation for 120 seconds, device automatically return to main screen.

Easy Access Diagram For Sensor Break Output Value From Main Screen

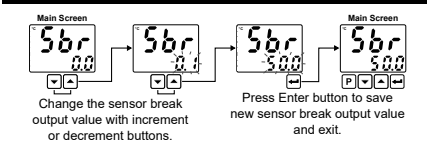

Note1: User can exit from parameter screen without saving the values by pressing [P] button. If no operation for 120 seconds, device automatically exits from parameter screen.

Note2: Sensor break output value can be adjusted on programming section too.

Activate Second Set

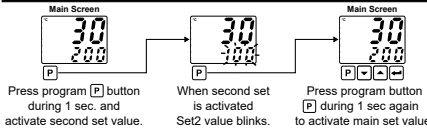

Tune Operation

Starting the Tune operation
 1- Enter to the tune parameter in P.d menu and select SELF or RUL, then press [P] button for saving parameter and turn to main screen. Or easily press [P] button for 3 seconds* in main screen.
 2- Observe that tune blinks in set display.
 *Only Auto tune can be started by this way.

Canceling Tune operation:
 1- If sensor breaks;
 2- If tune operation can not be completed in 8 hours;
 3- While heating self tune is running, if process value becomes greater than process set value;
 4- While cooling self tune is running, if process value becomes less than process set value;
 5- While tune operation is running, if user changes the process set value;
 6- While tune operation is running, if user changes the tune parameter in P.d menu;
 Then tune operation is canceled, device continues to run with former PID parameters without changing PID parameters.

Process Menu Parameters

522: 2nd Set value. As long as digital input of the device is active, 2nd set value is used as process set value. If digital input is passive, device use previous set value as process set value. (Default: 100) Modbus Address: 40004

P.n: Process input type selection; (Default: 0) Modbus Address: 40004

0: J type (Fe,Cu,Ni) Thermocouple, -199°C,900°C; -199°F,999°F

1: J type (Fe,Cu,Ni) Thermocouple, -19.9°C,99.9°C; -19.9°F,99.9°F

2: K type (Ni,Cr,Ni) Thermocouple, -19.9°C,99.9°C; -19.9°F,99.9°F

3: K type (Ni,Cr,Ni) Thermocouple, -19.9°C,99.9°C; -19.9°F,99.9°F

4: R type (Pt13%RhPt) Thermocouple, 0°C,999°C; 32°F,999°F

5: R type (Pt13%RhPt) Thermocouple, 0.0°C,99.9°C; 32.0°F,99.9°F

6: S type (Pt10%RhPt) Thermocouple, 0°C,999°C; 32°F,999°F

7: S type (Pt10%RhPt) Thermocouple, 0.0°C,99.9°C; 32.0°F,99.9°F

8: T type (Cu,Cu,Ni) Thermocouple, -199°C,400°C; -199°F,752°F

9: T type (Cu,Cu,Ni) Thermocouple, -19.9°C,99.9°C; -19.9°F,99.9°F

10: L type (Ni,Cr,Co / Ni,Fe,Mn,Cu) Thermocouple, -150°C,800°C; -199°F,999°F

11: L type (Ni,Cr,Co / Ni,Fe,Mn,Cu) Thermocouple, -19.9°C,99.9°C; -19.9°F,99.9°F

12: Cu-50, -199°C,200°C; -199°F,392°F

13: Cu-50, -19.9°C,99.9°C; -19.9°F,99.9°F

14: Pt-100, -199°C,650°C; -199°F,999°F

15: Pt-100, -19.9°C,99.9°C; -19.9°F,99.9°F

Unit Selection. **0** or **1** can be chosen. (Default: 0) Modbus Address: 40006

PLo: Operation Scale minimum (Low Limit) value. It changes according to the process input type and scale. (Default: -199) Modbus Address: 40007

PLoP: Operation Scale maximum (High Limit) value. It changes according to the process input type and scale. (Default: 900) Modbus Address: 40008

SL1: Process Set value Low Limit. Minimum set value is defined with this parameter. It can be adjusted between Operation Scale minimum and maximum (PLo - PLoP) values. (Default: -199) Modbus Address: 40009

SLu: Process Set value High Limit. Maximum set value is defined with this parameter. It can be adjusted between Operation Scale minimum and maximum (PLo - PLoP) values. (Default: 900) Modbus Address: 40010

POF: Display offset for process value. It can be adjusted from -10% of scale to 10% of scale. It is added to the process display value. (Default: 0) Modbus Address: 40011

fEt: Define filter time(sec) for displayed value. (Default: 1.0) Modbus Address: 40012

Control Menu Parameters

oUt: This parameter determines, which output will be Process control output. If **1** is chosen, process output is relay output, if **55r** is chosen, process output is SSR output. (Default: 55r) Modbus Address: 40017

P.S: Process Type Selection. It can be **HEt**(Heating) or **COoL**(Cooling). (Default: **HEt**) Modbus Address: 40018

LnS: Process Control Type Selection. It can be **oNoF** or **P.d**. (Default: **P.d**) Modbus Address: 40019

HP5: Hysteresis value. It can be adjusted from %0 to %50 of the Scale (PLoP - PLo). If **LnS** = **oNoF**, then this parameter can be seen. (Default: 3) Modbus Address: 40020

5b0: Sensor Break Output Value. It can be adjusted from %0 to %100. (Default: 0.0) Modbus Address: 40021

5b0d: The choice of displayed text on process value display when sensor is broken. It can be **5b0** or **oNo**. (Default: **5b0**) Modbus Address: 40022

55t: Soft Start Set value. Device operates in Soft Start mode, until the temperature reaches Soft Start set value. If **no** is selected, Soft Start mode is disabled. (Default: **no**) Modbus Address: 40023

55o: Soft Start Control Output. This parameter determines soft start mode control output percentage. It can be adjusted from %10 to %90. (Default: 10.0) Modbus Address: 40024

55t: Soft Start Control Time. This parameter determines soft start mode control time. (Default: 1.0) Modbus Address: 40025

PID Menu Parameters

PID menu parameters can be seen only if **LnS** parameter is **P.d**.

LnP: If time parameter is set to **55LF** or **RLnS**, device start to calculate PID parameters automatically. (Default: **no**) Modbus Address: 40029

P.b: Proportional band. It can be adjusted from %1.0 to %100.0. (Default: 10.0) Modbus Address: 40030

t.n: Integral Time. It can be adjusted from 0 to 3600 second. (Default: 100) Modbus Address: 40031

t.d: Derivative Time. It can be adjusted from 0.0 to 999.9 second. (Default: 25.0) Modbus Address: 40032

t.c: Output Control Period. It can be adjusted from 0.5 to 150 second. (Default: 1.0) Modbus Address: 40033

5oF: Set value offset. (Set + 5oF) is used as set value in PID calculations. This parameter is used for shifting the proportional band. It can be adjusted from (-P.b/2) to (P.b/2). (Default: 0) Modbus Address: 40034

Alarm-1 Menu Parameters

RS: Alarm-1 set value. (Default: 300) Modbus Address: 40038

hH: Alarm-1 hysteresis value. It can be adjusted from %0 to %50 of the scale (PLoP - PLo). (Default: 0) Modbus Address: 40039

Rt: Alarm-1 type selection. (Default: **PH.R**) Modbus Address: 40040

RL: Alarm-1 set low limit parameter. It can be adjusted from operation scale minimum to alarm-1 set high limit. (Default: 0) Modbus Address: 40041

RLu: Alarm-1 set high limit parameter. It can be adjusted from alarm-1 set low limit to operation scale maximum. (Default: 500) Modbus Address: 40042

on: Alarm-1 on Delay Time. It can be adjusted from 0 to 9999 seconds. (Default: 0) Modbus Address: 40043

oF: Alarm-1 off Delay Time. It can be adjusted from 0 to 9998 seconds. If it is higher than 9998, **tLH** is seen on the screen and alarm latching output is selected. In alarm latching output mode in order to make passive alarm outputs, press enter button at main screen. (Default: 0) Modbus Address: 40044

Alarm-2 Menu Parameters (Only for devices with two relays)

Alarm-2 menu parameters can be seen only if **oUt** parameter is **55r**.

RS2: Alarm-2 set value. (Default: 400) Modbus Address: 40048

hH2: Alarm-2 hysteresis value. It can be adjusted from %0 to %50 of the Scale (PLoP - PLo). (Default: 0) Modbus Address: 40049

Rt2: Alarm-2 type selection. (Default: **PH.R**) Modbus Address: 40050

RL2: Alarm-2 set low limit parameter. It can be adjusted from operation scale minimum to alarm-2 set high limit. (Default: 0) Modbus Address: 40051

RLu2: Alarm-2 set high limit parameter. It can be adjusted from alarm-2 set low limit to operation scale maximum. (Default: 500) Modbus Address: 40052

on2: Alarm-2 on delay time. It can be adjusted from 0 to 9999 seconds. (Default: 0) Modbus Address: 40053

oF2: Alarm-2 off delay time. It can be adjusted from 0 to 9998 seconds. If it is higher than 9998, **tLH** is seen on the screen and Alarm Latching Output is selected. In alarm latching output mode in order to make passive alarm outputs, press enter button at main screen. (Default: 0) Modbus Address: 40054

Communication Parameters (Only for devices with RS-485 com.)

Ad: Communication addressing address of device. (Default: 1) Modbus Address: 40058

BuR: Communication Baud Rate. (Default: 3) Modbus Address: 40059

1: 1200 Baud Rate.

2: 2400 Baud Rate.

3: 4800 Baud Rate.

4: 9600 Baud Rate.

5: 19200 Baud Rate.

6: 38400 Baud Rate.

PAR: Parity Selection for Communication. (Default: 0) Modbus Address: 40060

0: No Parity.

1: Odd Parity.

2: Even Parity.

5bT: Stop Bit Selection for Communication. (Default: 0) Modbus Address: 40061

0: 1 Stop Bit.

1: 2 Stop Bit.

Protection Menu Parameters

PPS: Password for accessing to the programming section. It can be adjusted from 0 to 9999. If **PPS** is 0, password screen is not seen. If **PPS** is different from 0 and user enters to the menu pages without entering the password, all the menus can be observed except protection menu **P.t**. But device does not allow to do any changes in parameters. (Default: 0) Modbus Address: 40065

uDF: User default parameters. This parameter is used for saving all parameters to restore later or restore all parameters saved before. If **55t** is chosen, all parameters saved before are restored. If **55t** is chosen, all parameters saved to restore later. If **no** is chosen, nothing is changed. (Default: **no**) Modbus Address: 40066

P.dF: This parameter is used for restore factory defaults. If **55t** is chosen, factory defaults parameters restored. If **no** is chosen, nothing is changed. (Default: **no**) Modbus Address: 40067

Remove all input/output connections on terminals before restoring parameters to user/factory defaults.

Modbus Addresses of Device Operation Info. (Read Input Register)

Modbus Address: 30000 Displayed Temperature Value

Modbus Address: 30001 Status of LEDs: bit.1 **ALR1**, bit.2 **ALR2**, bit.9 **FC**, bit.10 **FE**, bit.11 **PO2**, bit.12 **PO1**

Modbus Address: 30002 Status of Device: bit.0 Sensor Break Status

Alarm Types

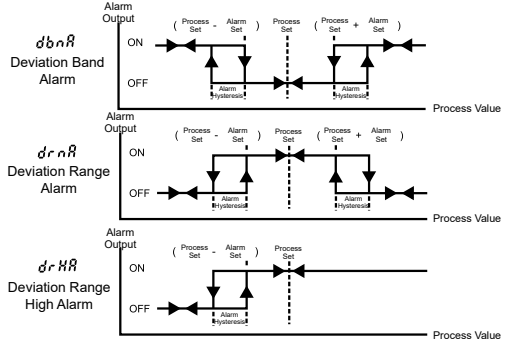
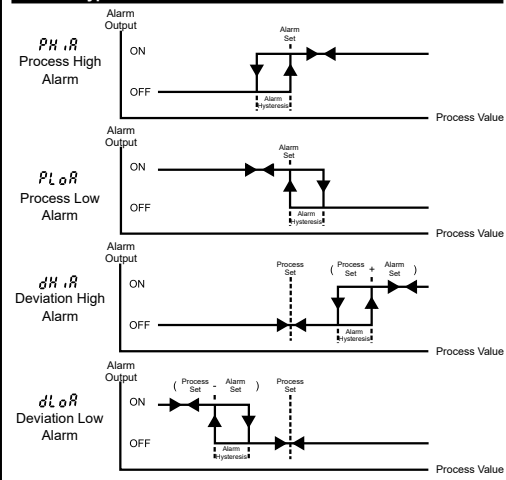

Error Messages

- 5b0**: 1-Sensor failure in analog inputs. Sensor connection is wrong or there is no sensor connection.
- 55t**: 2-If programming section entering password is different from "0" and user accesses to the parameter by enter button without entering the password and wants to change a parameter, the warning message is shown on the bottom display as shown on the left. Device does not allow to do any changes without entering the password correctly.
- PLL**: 3-If value that is read from the analog input is lower than process set low limit parameter value (PLo), value on the top display starts to blink as shown on the picture.
- PLH**: 4-If value that is read from the analog input is higher than process set high limit parameter value (PLoP), value on the top display starts to blink as shown on the picture.
- 55L**: 5-If value that is read from the analog input is lower than sensor scale low limit, value on the top display starts to blink as shown on the picture.
- 55H**: 6-If value that is read from the analog input is higher than sensor scale high limit, value on the top display starts to blink as shown on the picture.

Installation

Before beginning installation of this product, please read the instruction manual and warnings below carefully.

- In package,
- One piece unit
- Two pieces mounting clamp
- One piece instruction manual

A visual inspection of this product for possible damage occurred during shipment is recommended before installation. It is your responsibility to ensure that qualified mechanical and electrical technicians install this product. If there is danger of serious accident resulting from a failure or defect in this unit, power off the system and the electrical connection of the device from the system. The unit is normally supplied without a power switch or a fuse. Use power switch and fuse as required. Be sure to use the rated power supply voltage to protect the unit against damage and to prevent failure. Keep the power off until all of the wiring is completed so that electric shock and trouble with the unit can be prevented. Never attempt to disassemble, modify or repair this unit. Tampering with the unit may result in malfunction, electric shock or fire. Do not use the unit in combustible or explosive gaseous atmospheres. During the equipment is putted in hole on the metal panel while mechanical installation some metal burrs can cause injury on hands, you must be careful. Montage of the product on a system must be done with it's mounting clamp. Do not do the montage of the device with inappropriate mounting clamp. Be sure that device will not fall while doing the montage. It is your responsibility if this equipment is used in a manner not specified in this instruction manual.

Warranty

EMKO Elektronik warrants that the equipment delivered is free from defects in material and workmanship. This warranty is provided for a period of two years. The warranty period starts from the delivery date. This warranty is in force if duty and responsibilities which are determined in warranty document and instruction manual performs by the customer completely.

Maintenance

Repairs should only be performed by trained and specialized personnel. Cut power to the device before accessing internal parts. Do not clean the case with hydrocarbon-based solvents (Petrol, Trichlorethylene etc.). Use of these solvents can reduce the mechanical reliability of the device. Use a cloth dampened in ethyl alcohol or water to clean the external plastic case.

Other Informations

Manufacturer Information:
Emko Elektronik Sanayi ve Ticaret A.Ş.
Demirtaş Organize Sanayi Bölgesi Karanfil Sk. No:6 16369 BURSA/TURKEY
Phone: +90 224 261 1900
Fax: +90 224 261 1912

Repair and Maintenance Service Information:

Emko Elektronik Sanayi ve Ticaret A.Ş.
Demirtaş Organize Sanayi Bölgesi Karanfil Sk. No:6 16369 BURSA/TURKEY
Phone: +90 224 261 1900
Fax : +90 224 261 1912

Ordering Information

Eco HR (48x48 DIN 1/16)	A	B	C	D	E
	4	.	.	.	S

A Dimension

4 48x48 DIN 1/16

B Supply Voltage

1	100-240V~ 50/60Hz
2	24V~ (±%15) 50/60Hz
3	115V~ (±%15) 50/60Hz
5	230V~ (±%15) 50/60Hz
6	10...30V==
7	24V~ (±%15) 50/60Hz
9	Customer

C Outputs-1

- OR Not
- 1R 1 x Relay Output (5A@250V~ at Resistive Load) (NO,C)
- 2R 2 x Relay Output (5A@250V~ at Resistive Load) (NO,NO,C)

D Outputs-2

- S SSR Driver Output (Max. 10mA, Max. 12V==)

E Communication

0	None
485	RS-485 Communication
DI	220V~ Digital Input

Before commissioning the device, parameters must be set in accordance with desired use. Incomplete or incorrect configuration can cause dangerous situations.

Because of limited mechanical life of relay output contact, SSR output is recommended which the device use PID control algorithm. The device with ON/OFF control algorithm, hysteresis parameter must be set a suitable value for your system, to avoid too much relay switching.

~ ~ ~ Vac,
--- Vdc,
~ ~ ~ Vdc or Vac can be applied

Thank you very much for your preference to use Emko Elektronik products, please visit our Your Technology Partner web page to download detailed user manual. www.emkoelektronik.com.tr