

CP Series Pumps

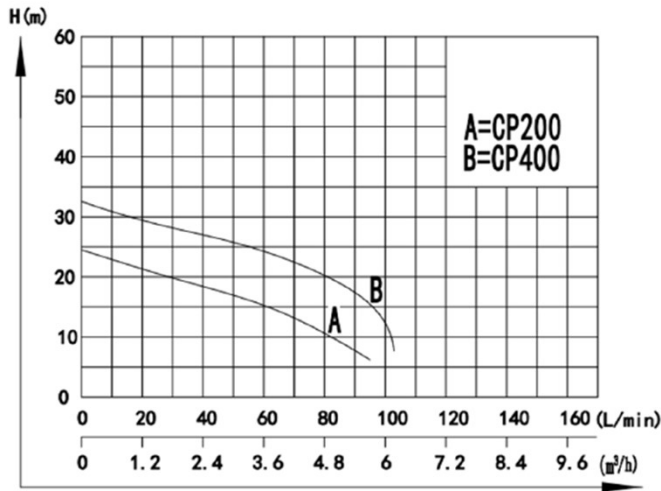

Pump Performance

Model	POWER		Voltage	Discharge head in metres (For kPa*10)							Pipe		
	HP	KW		5	10	15	20	25	30	35		40	
CP-200ES	0.75	0.55	230		90	66	38						1" *1"
CP-400ES	1.35	1	230		97	91	80	54	20				1" *1"

Model	Weight (Kg)	Dim (mm)											DN 1	DN 2
		A	B	C	E	F	G	L	H1	H2	H3	Inch		
CP-200ES	12	112	140	170	72	110	92	283	92	120	200	1	1	
CP-400ES	15	112	140	180	88	125	92	299	92	125	200	1	1	

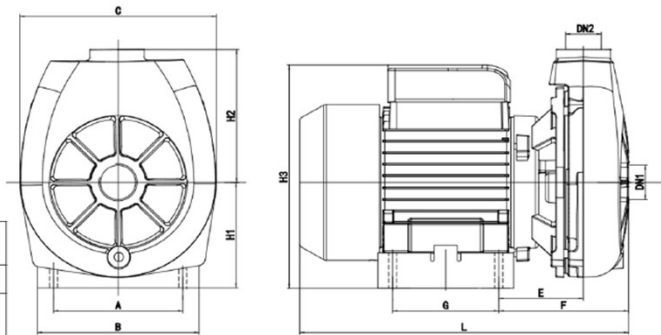

Key Design Features

Large laminated core

- 89.5mm (L) x 57.5mm (D) –CP-400ES
- 60mm (L) x 57.5mm (D) –CP-200ES

100% copper windings with thermal overload

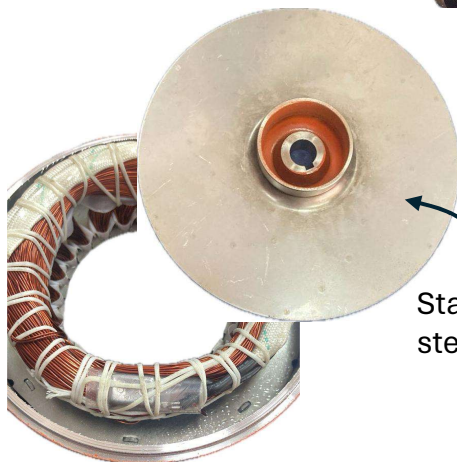

Stamped stainless steel impeller

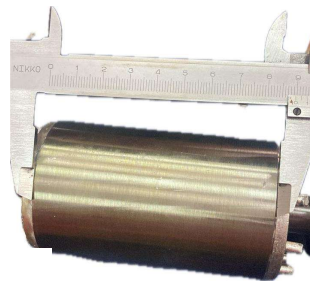

High precision cold rolled motor shaft with Shanghai C&U bearings for high efficiency