

GW768

Wireless network system receiving device

A device that receives data wirelessly in connection with a wireless signal information device



GW768(GATEWAY)

GW768(GATEWAY) Wireless network system receiving device

- A device that receives data from wireless signal information devices, suitable for large-scale business sites
- Control of wireless signal information devices through two-way communication
- Up to 32ea of wireless signal information devices can be connected per gateway
- Up to 24ea of device can be connected via LAN using Ethernet communication (Maximum 768ea of wireless signal information devices can be connected)
- Information transmission to administrators and controlling real-time using a mobile app
- Wireless communication standard: IEEE 802.15.4 Standard
- Certificates : KC
- Data rate: 250Kbps
- Material: ABS



Specification

Model number	Voltage	Current	Interface	Wireless standard	Radio frequency/ number of channels	Certificates	Weight
GW768	DC12 -24V	Max. 0.510A	USB2.0/ Ethernet	IEEE 802.15.4 Standard	2405MHz- 2480MHz(16ch)	 DC12V only	0.25kg
	AC110 -220V	Max. 0.115A					



Technical Diagram

(Units : mm)

GW758

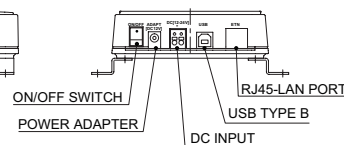
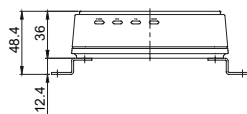
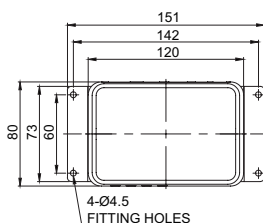

Ordering Specification

GW768	-	12/24
[Model number]		[Voltage]
• GW768		<ul style="list-style-type: none"> • 12/24-DC12V-24V • 110/220-AC110V-220V