

QWT series

Wall Mount LED Steady/Flashing Signal Towers



QWT series

Mounting Instructions

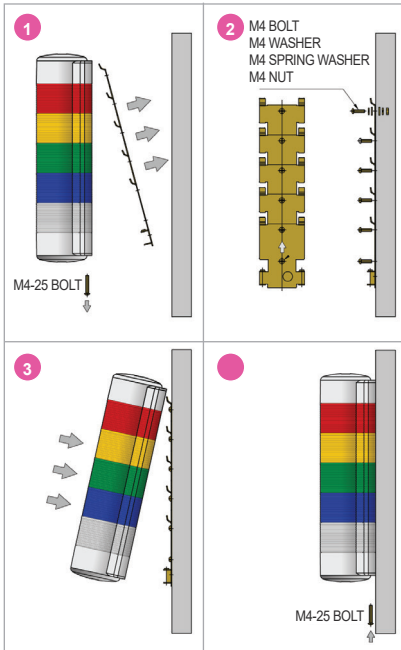

- 1 Loosen the two M4 bolts on the bottom of the bracket and remove the body
- 2 Attach the bracket to the wall with screws into the mounting holes
- 3 Hang the unit onto the bracket
- 4 After attaching the unit to the bracket, secure the two pieces together with the M4 bolts at the bottom of the product

Customization

- Available in customized color arrangements

QWT Wall Mount, LED Steady/Flashing

- Wall mount model that minimizes the chance of breakage from moving obstacles
- The use of a circular lens design for the product improves visibility at the sides
- LED light distribution structure that directly radiates light to the user provides excellent visibility
- Flashing rate : 60-80 flashes/min
- Built-in buzzer available (Volume : Max 85dB at 1m)
- Materials : Lens-PC, Housing-ABS
- Ambient operating temperature : -30°C to +50°C
- Protection rating : IP54
- Certificates : CE Compliant, UL Listed
- Compliant with RoHS directive

Model number	Layer	Voltage	Current	Certificates	Weight	Color
QWTL Steady QWTL-BZ Steady w/ built-in buzzer QWTLF Steady/Flashing QWTLF-BZ Steady/Flashing /w built-in buzzer	1	AC/DC12V AC/DC24V AC110V-220V	0.065A 0.050A Max 0.025A	CE DC24V only UL DC24V only	0.34kg 0.34kg 0.36kg	• R-Red
	2	AC/DC12V AC/DC24V AC110V-220V	0.130A 0.100A Max 0.050A		0.41kg 0.41kg 0.43kg	• R-Red • G-Green
	3	AC/DC12V AC/DC24V AC110V-220V	0.195A 0.150A Max 0.075A		0.48kg 0.48kg 0.50kg	• R-Red • A-Amber • G-Green
	4	AC/DC12V AC/DC24V AC110V-220V	0.260A 0.200A Max 0.100A		0.55kg 0.55kg 0.57kg	• R-Red • A-Amber • G-Green • B-Blue
	5	AC/DC12V AC/DC24V AC110V-220V	0.325A 0.250A Max 0.125A		0.62kg 0.62kg 0.64kg	• R-Red • A-Amber • G-Green • B-Blue • W-White

* AC type model has a free-voltage range of 100V-240V.

Signal/ Audible Line Current(per each layer)

Voltage	AC/DC12V	AC/DC24V	AC110V-220V
Signal line current	0.065A	0.050A	Max. 0.025A
Audible line current	0.050A	0.110A	Max. 0.020A

Technical Diagram

(Units : mm)

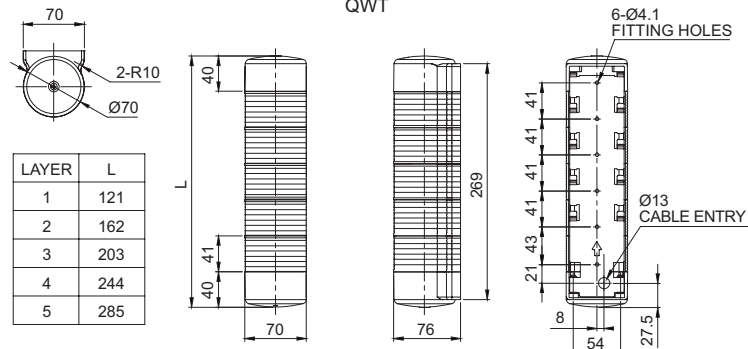

Ordering Specification

QWTL	-	3	-	110/220	-	RAG
[Model number]		[Layer]		[Voltage]		[Color]
<ul style="list-style-type: none"> • QWTL • QWTL-BZ • QWTLF • QWTLF-BZ 		<ul style="list-style-type: none"> • 1-1Layer • 2-2Layers • 3-3Layers • 4-4Layers • 5-5Layers 		<ul style="list-style-type: none"> • 12-DC12V • 24-DC24V • 110/220 • -AC110V-220V 		<ul style="list-style-type: none"> • R-Red • A-Amber • G-Green • B-Blue • W-White

QWT series

Wall Mount LED Steady/Flashing Signal Towers



Wiring Instructions

- QWT series can be wired by using both external contact and transistor.
- In case of wiring by transistor, please make sure if it is NPN type or PNP type. Please carefully follow wiring instructions below.
- Product can be wired regardless of polarity.

	External Contact	Transistor
DC Steady	<p>QWTL-DC EXTERNAL CONTACT</p>	<p>QWTL-DC EXTERNAL TRANSISTOR-NPN EXTERNAL TRANSISTOR-PNP</p>
DC Steady/Flashing	<p>QWTLF-DC EXTERNAL CONTACT</p>	<p>QWTLF-DC EXTERNAL TRANSISTOR-PNP</p>
AC Steady	<p>QWTL-AC EXTERNAL CONTACT</p>	<p>QWTL-AC EXTERNAL TRANSISTOR-PNP</p>
AC Steady/Flashing	<p>QWTLF-AC EXTERNAL CONTACT</p>	<p>QWTLF-AC EXTERNAL TRANSISTOR-PNP</p>

- DC steady type : External power line and External signal line : UL1007 AWG22(0.3sq) 400mm
- AC steady, AC/DC steady/flashing type : External power line : UL1015 AWG18(0.75sq)×2C 400mm
External signal line : UL1007 AWG22(0.3sq) 400mm