

QAP Series

Wall mount multifunctional electric horn which supports 30 built-in sounds and 30 user defined sounds(MP3)



- QAP100H / QAP125H (SD card(MP3) support)
- User defined 30 sounds, 30 built-in sounds
- QAP100H-N / QAP125H-N (standard unit)
- 30 built-in sounds

PRODUCT SPECIFICATION

QAP80H | QAP100H | QAP125H
QAP100H-N | QAP125H-N

Materials Housing-ABS, Resonance chamber-ABS
Ambient operating temperature -25°C to +50°C
Protection rating IP65
Compliant with RoHS directive

- Signal sound diffusing structure with wall mount supports 30 Built-in sounds and 30 user defined sounds
- Volume control and tone selector switches are installed inside the unit (Buzzer type is unsupported)
- User has the ability to enter voice tones directly into the unit via MP3 files from the SD card
- This product has 30 Built-in sounds via binary input mode or bit input mode
- Binary input mode allows the user to select from 30 different sound options with the tone selection switch
- Bit input mode is organized into 6 groups of 5 sound tones for a total of 30 sound tone options. Playback can be selected from one of the 5 tones in each group (MP3 file with bit input mode)
- Supports both SD card and MP3(QAP100H/QAP125H)
- Standard unit choose built-in sound only. It can choose 30 sounds in accordance with the customer's needs.

Function setting for multifunctional product

- Standard unit does not support either SD card or Play mode.

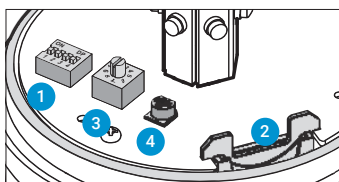

- 1 Sound setup switch
- 2 SD Card for MP3 play
- 3 Play mode set up switch
- 4 Volume

Sound Selection Instruction for SDCard Type

- SD card type unit
- It can choose both built-in sounds and user defined sounds(MP3) by controlling sound setup switch no. 1.
- Standard unit
- It can choose both Bit input mode and Binary input mode by controlling sound setup switch no. 1.

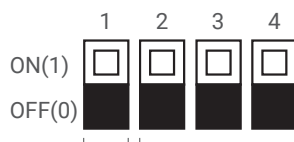

Sound Selection

- 0: Built-in sound
- 1: SD Card(MP3)

Standard unit(Built-in sound only)

- 0:Bit input(Can choose 5 channels per group)
- 1:Binary(Can choose 30 channels)

Bit input mode selection from 6 groups

- 001: WS(5 Warning sounds)
- 010: WP(5 Special warning sounds 1st group)
- 011: WM(5 Melodies)
- 100: WA(5 Alarms)
- 101: WO(5 Special warning sounds 2nd group)
- 110: WN(5 Special warning sounds 3rd group)

- 30 pre-recorded sounds offered(5 warning sounds, 5 special warning sounds 1st group, 5 melodies, 5 alarms, 5 special warning sounds 2nd group, 5 special warning sounds 3rd group)
- External MP3 sound support(SD card)
- Binary input: 30 channels
- Bit input: 5 channels(6 sound groups)
- A multi-functional product that can use an SD card for MP3 playback
- Please refer to [Sound pattern and combination for multifunctional product] on this catalogue for channel input setting.

Features per modelst

	QAP100H / QAP125H(MP3)	QAP80H / QAP100H-N QAP125H-N(standard unit)	Column
Support SD card(MP3)	O	X	
Support 30 built-in sounds	O	O	
Play mode	O	X	
Bit/Binary input	O	O	Please refer to sound setup switch manual parts

QAP Series



QAP80H

QAP80H Electric Horn, Wall Mount Type

Model number	Voltage	Current	Sound Pattern and volume	Certificates	Weight
QAP80H	DC12V-24V	Max.0.920A	·Bit Input: 5Ch ·Binary Input: 30Ch ·Built-in volume : Max.100dB (Based on WM-Ch4)	CE	0.51kg

※ DC type model has a free-voltage range of 10V-30V.

QAP100H Electric Horn, Wall Mount Type

Model number	Voltage	Current	Sound Pattern and volume	Certificates	Weight
QAP100H	DC12V-24V	Max.0.720A	·Bit Input: 5Ch ·Binary Input: 30Ch ·Built-in volume : Max.100dB (Based on WA-Ch4) ·MP3: Max.100dB	CE	0.60kg
	AC110-220V	Max.0.175A			0.63kg

※ DC type model has a free-voltage range of 10V-30V.

※ AC type model has a free-voltage range of 100V-240V.

※ Please refer to [Sound tone and combination for standard product] on this catalogue for detailed sound tone specification

※ When playing MP3 files, there may be difference of volume depending on user's audio file type.

QAP125H Electric Horn, Wall Mount Type

Model number	Voltage	Current	Sound Pattern and volume	Certificates	Weight
QAP125H	DC12V-24V	Max.1.800A	·Bit Input: 5Ch ·Binary Input: 30Ch ·Built-in volume : Max.115dB (Based on WA-Ch4) ·MP3: Max.105dB	CE	0.70kg
	AC110-220V	Max.0.380A			0.73kg

※ DC type model has a free-voltage range of 10V-30V.

※ AC type model has a free-voltage range of 100V-240V.

※ Please refer to [Sound tone and combination for standard product] on this catalogue for detailed sound tone specification

※ When playing MP3 files, there may be difference of volume depending on user's audio file type.

Ordering Specification

QAP80H	-	12/24	-	INSD
[Model number]		[Voltage]		[Including SD card]
QAP80H		12/24-DC12V-24V		
QAP100H		12/24-DC12V-24V		(None)-Without SD card
QAP125H		110/220-AC110V-220V		INSD-Including SD card

QAP Series

Technical Diagram

Units: mm

·QAP80H

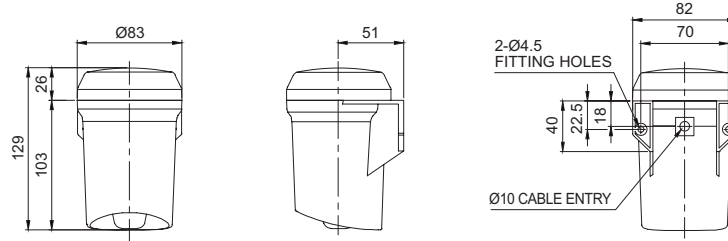

·QAP100H / QAP100H-N

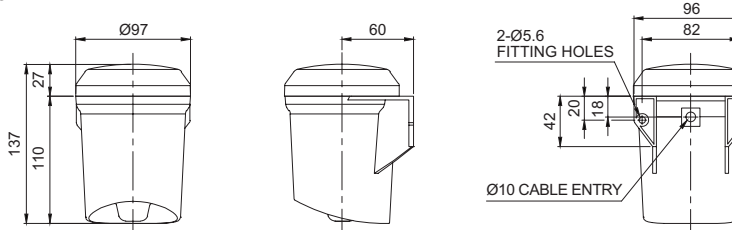

·QAP125H / QAP125H-N

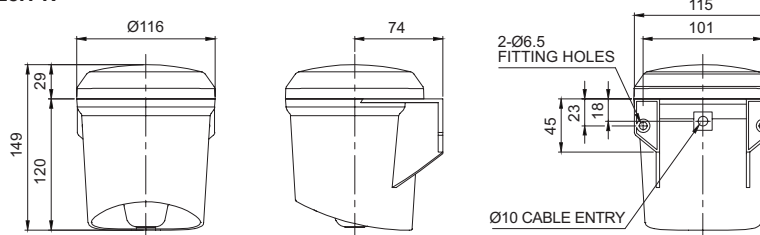

Wiring Instructions

·QAP80H-DC / QAP100H-DC/AC
·QAP100H-N-DC/AC

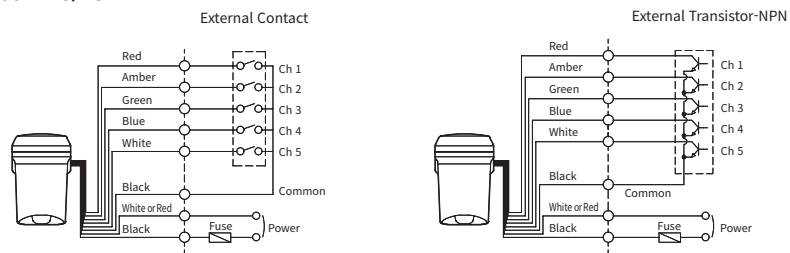

·QAP125H-DC/AC
·QAP125H-N-DC/AC

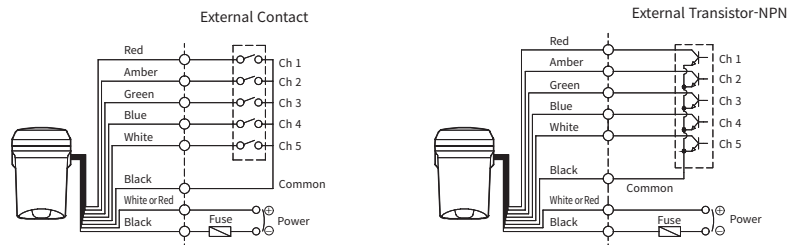

- External power line - UL1015 AWG18(0.75sq) x 2C 400mm
- External signal line - UL1007 AWG22(0.3sq) 400mm
- QAP80H / QAP100H - This product can be wired regardless of polarity.
- QAP125H - Black output line is negative(-).
- In case of Bit input, 5 sound tones can be played. For Binary input, 30 sound tones can be played.
- ※ Please refer to [Sound pattern and combination for multifunctional product] on this catalogue for channel input setting(Wiring instruction is replaced to channel selection switch)