

# QFL/ QFLC

Water and Vibration Resistant LED Light Bars with IP67 Protection



## Common Specifications(QFL/ QFLC)

- Excellent front and side light distribution with the use of a special light distributing structure on the surface of the oval lens
- An external power supply is not needed for the AC type product; AC voltage can be applied directly to the product
- Excellent heat dissipation by using a heat dissipative material connected to the outer cover
- Water and vibration proof model (IP67), suitable for outdoors and places with dust and moisture
- Can select between QFL model (Anti-glare type) and QFLC model (High luminance type) depending on your work conditions
- Tilt bracket provides wide luminance angle adjustment of 130°
- Superior durability with lens made of polycarbonate
- Can customize the product with the M12 connector if requested
- Certificates: CE Compliant



## QFL Translucent Lens Type



## Light Distribution and Illuminance

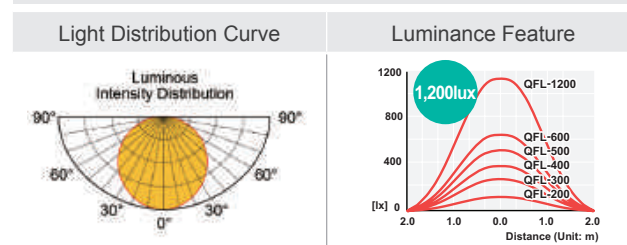

## Cable entry M12 connector attached type



Customized Cable entry M12 connector attached type available.

## Specifications on Luminance

Model	QFL-200	QFL-300	QFL-400	QFL-500	QFL-600	QFL-1200	
Lens color	Translucent	Translucent	Translucent	Translucent	Translucent	Translucent	
Light color	Cooldaylight						
Color temperature	6,000-7,000K						
Luminous flux	DC	395lm	828lm	1,087lm	1,474lm	1,815lm	3,338lm
	AC	-	-	1,172lm	1,602lm	1,862lm	3,545lm
Efficacy (lm/W)	DC	120lux	250lux	375lux	500lux	625lux	1,150lux
	AC	-	-	400lux	545lux	640lux	1,200lux

## General Specifications

Model	QFL-200	QFL-300	QFL-400	QFL-500	QFL-600	QFL-1200
Voltage	DC24V					
Range for operation voltage	AC220V(Except QFL-200/300)					
Power consumption	4.5W	9W	13W	17W	20W	44W
Insulation resistance	Min. 100MΩ(500V DC mega ohm meter)					
Withstanding voltage	DC : 500V AC, 60Hz, 1 minute / AC : 1,500V AC, 60Hz, 1 minute					
Operating temperature	-30°C to +50°C					
Protection rating	IP67					
Materials	Lens : PC, Cover : Al, Heat sink : Al					
Certifications	CE (Except QFL-1200 DC24V)					
Weight(Approx.)	0.40kg	0.49kg	0.58kg	0.73kg	0.82kg	1.28kg
	-	-	0.61kg	0.76kg	0.85kg	1.31kg

# QFL/ QFLC

Water and Vibration Resistant LED Light Bars with IP67 Protection

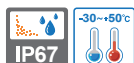

## QFLC Transparent Lens



### Light Distribution and Illuminance

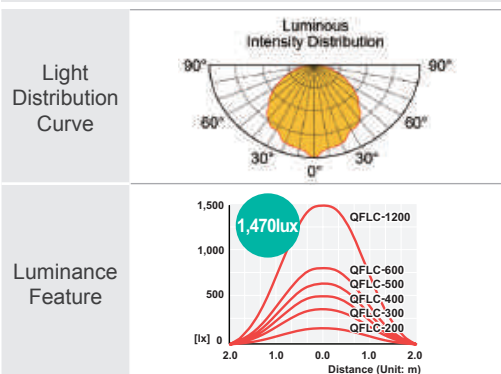

### Specifications on Luminance

Model	QFLC-200	QFLC-300	QFLC-400	QFLC-500	QFLC-600	QFLC-1200	
Lens color	Transparent	Transparent	Transparent	Transparent	Transparent	Transparent	
Light color	Cooldaylight						
Color temperature	6,000-7,000K						
Luminous flux	DC	462lm	975lm	1,282lm	1,739lm	2,084lm	3,970lm
	AC	-	-	1,384lm	1,893lm	2,198lm	4,221lm
Efficacy (lm/W)	DC	150lux	310lux	460lux	620lux	775lux	1,470lux
	AC	-	-	500lux	670lux	815lux	1,500lux

### General Specifications

Model	QFLC-200	QFLC-300	QFLC-400	QFLC-500	QFLC-600	QFLC-1200
Voltage	DC24V AC220V(Except QFLC-200/300)					
Range for operation voltage	DC21.5V-26.5V/ AC198V-245V					
Power consumption	4.5W	9.0W	13.0W	17W	20W	40W
	-	-	19W	24W	26W	53W
Insulation resistance	Min. 100MΩ(500V DC mega ohm meter)					
Withstanding voltage	DC : 500V AC, 60Hz, 1 minute / AC : 1,500V AC, 60Hz, 1 minute					
Operating temperature	-30°C to +50°C					
Protection rating	IP67					
Materials	Lens : PC, Side cover : Al, Heat sink : Al					
Certifications	CE (Except QFLC-1200 DC24V)					
Weight(Approx.)	0.47kg	0.57kg	0.67kg	0.77kg	0.86kg	1.32kg
	-	-	0.71kg	0.81kg	0.90kg	1.40kg



### Technical Diagram

(Units : mm)

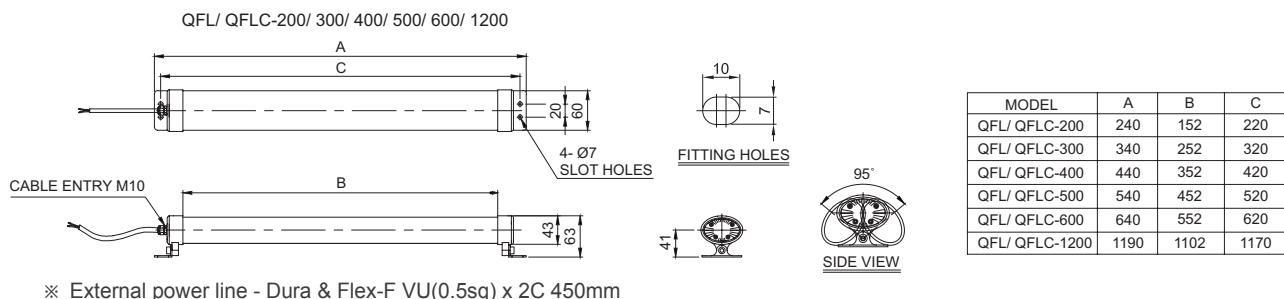

### Ordering Specification

<b>QFL</b>	-	<b>600</b>	-	<b>24</b>
[Model number]		[Product length]		[Voltage]
<ul style="list-style-type: none"> <li>• QFL : Translucent lens</li> <li>• QFLC : Transparent lens</li> </ul>		<ul style="list-style-type: none"> <li>• 200 : 240mm</li> <li>• 300 : 340mm</li> <li>• 400 : 440mm</li> <li>• 500 : 540mm</li> <li>• 600 : 640mm</li> <li>• 1200 : 1,190mm</li> </ul>		<ul style="list-style-type: none"> <li>• 24-DC24V</li> <li>• 220-AC220V (Except QFL(C)-200/300)</li> </ul>