

EMCL Series



EMCL30

EMCL50

PRODUCT SPECIFICATION

EMCL30 | EMCL50
EMCL70 | EMCL90

Materials Housing-Al, Lens-PC
Ambient operating temperature -25°C to +55°C
Volume Max. 85dB at 1m
Protection rating IP69K

- Small indicator light capable of transmitting three signal colors with one indicator light
- By applying a milky translucent lens, the unique color of the LED is emitted subtly when turned on
- Respond to customer needs with various outer diameters (30mm, 50mm, 70mm, 90mm) and designs
- Waterproof and dustproof model with fully sealed structure with IP69K degree of protection to cope with harsh environmental conditions
- Buzzer specifications can be selected for signal wire withdrawal type or M12 connector mounting type

EMCL Series Industrial LED beacon

Model number	Voltage	Current	Certificates	Weight	Color		
EMCL30 Steady	DC24V	0.040A	CE	0.05kg	● R-Red ● A-Amber ● G-Green		
EMCL30-BZ Steady w/built-in buzzer						0.061A	
EMCL50 Steady				0.09kg			
EMCL50-BZ Steady w/built-in buzzer							0.16kg
EMCL70 Steady				0.21kg			
EMCL70-BZ Steady w/built-in buzzer							
EMCL90 Steady							

Bracket

It can be installed on the wall by adopting wall mounting type bracket.

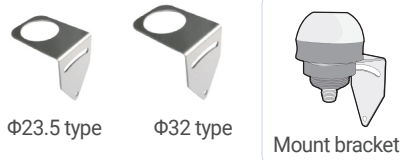

Wiring Instructions

• EMCL Series

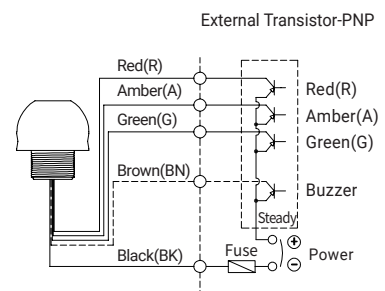
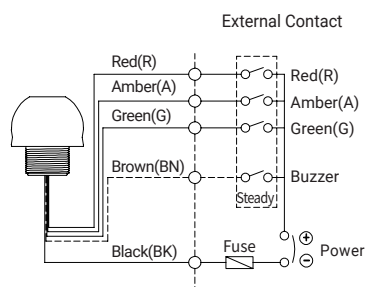

Technical Diagram

Units: mm

• EMCL30 / EMCL30-BZ

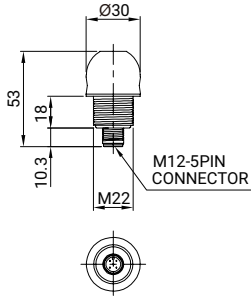

• EMCL50 / EMCL50-BZ

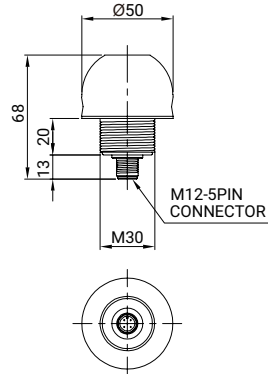

• EMCL70 / EMCL70-BZ

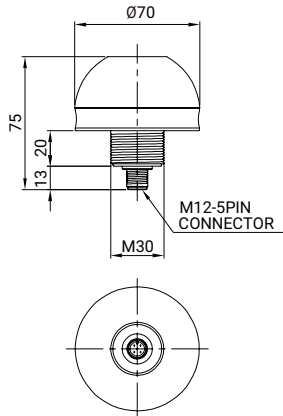

• EMCL90 / EMCL90-BZ

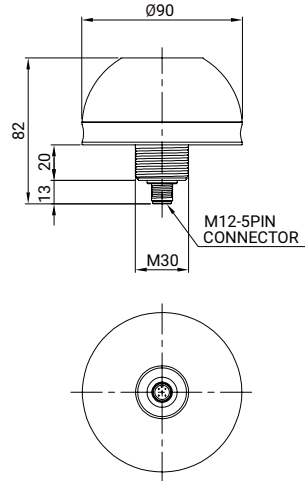

EMCL70



EMCL90

Customization

- M12 Five- Core Cable/1.5m
- NPN type

M12 connector type

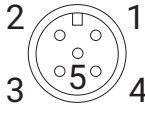
5PIN CONNECTOR	No.	Color	Wiring
	1	RED	Pin 1
	2	AMBER	Pin 2
	3	GREEN	Pin 3
	4	Common	Pin 4
	5	Buzzer	Pin 5

Ordering Specification

EMCL30	-	24	-	RAG	-	M12
[Model number]		[Voltage]		[Color]		[Cable]
EMCL30 EMCL30-BZ EMCL50 EMCL50-BZ EMCL70 EMCL70-BZ EMCL90 EMCL90-BZ		24-DC24V		● R-Red ● A-Amber ● G-Green		None-External contact M12-M12 connector type