

EXA-xxA0000A000

Explosion-proof enclosure

1068382, 1068383, 1068384

SICK AG – Industrial Safety Systems
 Erwin-Sick-Strasse 1
 D-79183 Waldkirch, Germany • www.sick.com
 8017161/2014-04-16 • SF
 Printed in Germany (2014-04) • All rights reserved • Subject to change without notice



Caution! Important information:
 The purchaser, installer and employer have the responsibility to meet all local, state and federal government laws, rules, codes or regulations relating to the proper use, installation, operating instructions and maintenance of this control and the guarded machine. See the installation and operating instructions deTec4 Core Ex (8017107), Addendum OI C4000 Select Ex (8017106) and Addendum OI C4000 Advanced Ex (8017105) for additional information.

1 Mounting

Caution! Risk of injury due to heavy weight!
 Lifting and moving heavy loads may cause injury. Unsecured heavy loads may, for example, fall over and cause bruising.

- Only lift the explosion-proof enclosure using equipment or two persons.
- Wear suitable protective clothing and safety shoes.

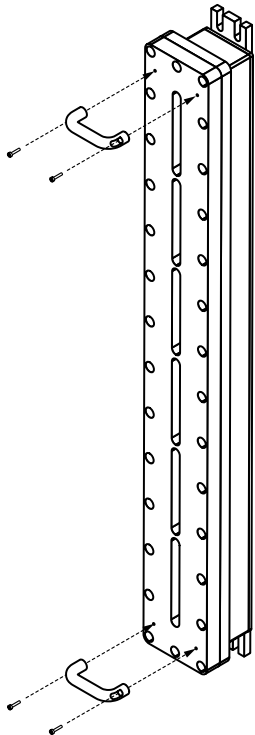

Scope of delivery

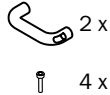

Required tool



1.1 Mounting without adjustable brackets

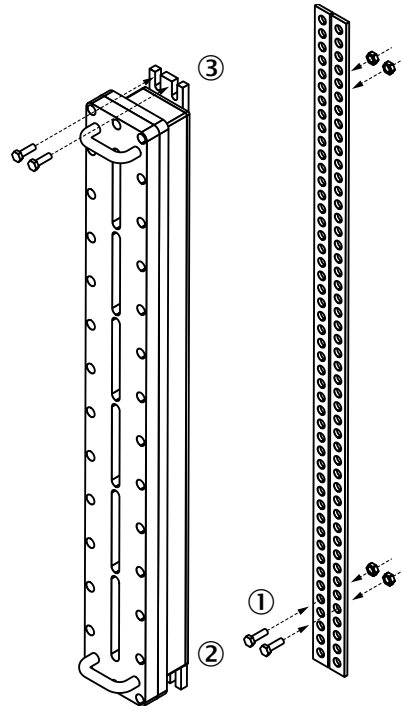

Scope of delivery



Required tools

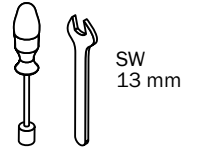

①.

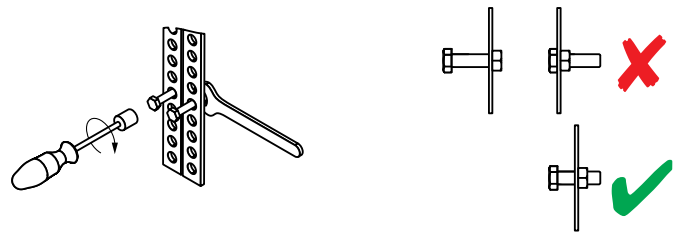

②.

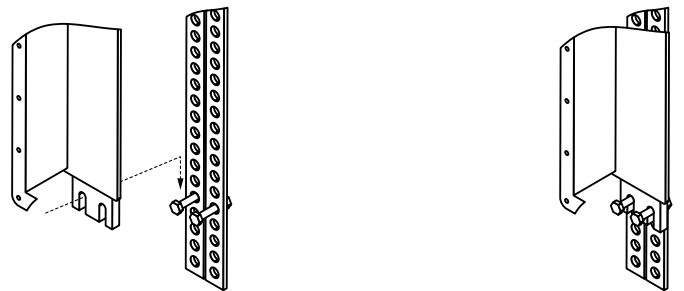

③.

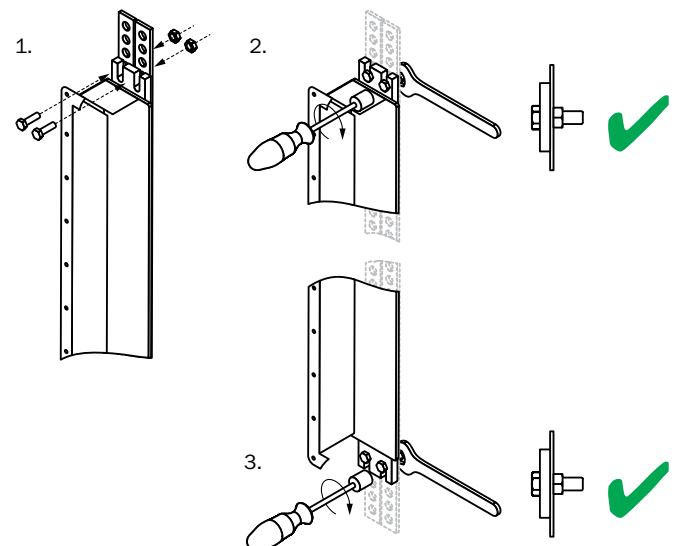

1.2 Mounting with adjustable brackets

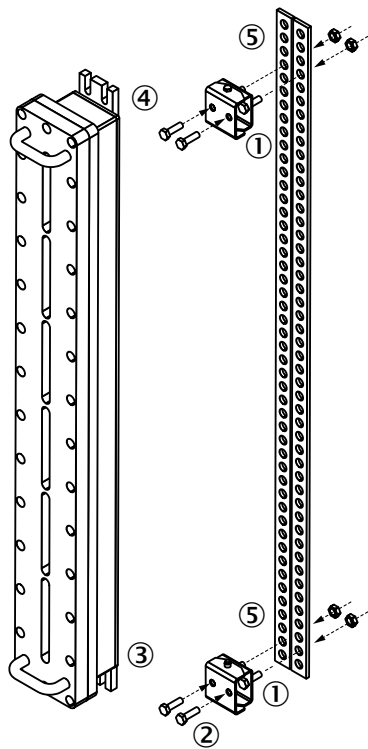

Scope of delivery

4 x

4 x

Part no. 2072525

2 x 4 x

Required tools

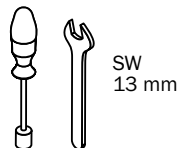

SW
13 mm

