



# how to use MD-33SE

MADIN BLENDICON  
THE QUIETEST BLENDER

Makes all kind of beverages easier  
is the most important factor for  
food and beverage business

Madin Blendicon is your answer.  
The programs are made for all  
different kinds of beverages



# madin how to use MD-33SE

MADIN BLENDICON



Identification of parts



How to operate



Safety Instructions



Troubleshooting

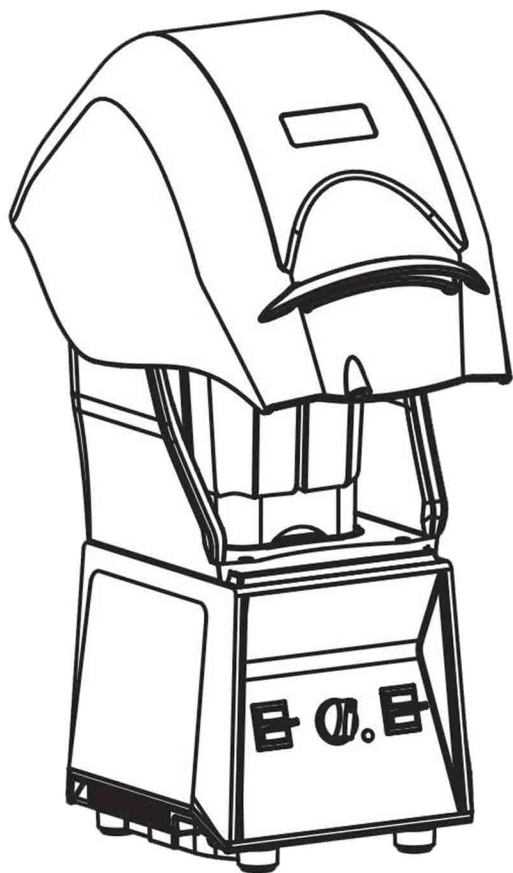

# Identification of parts MD-33SE

MADIN BLENDICON



Identification of parts



How to operate



Safety Instructions



Troubleshooting

Condiment  
Cover



Blender  
Jar Cover

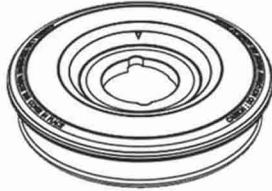

Blender  
Jar

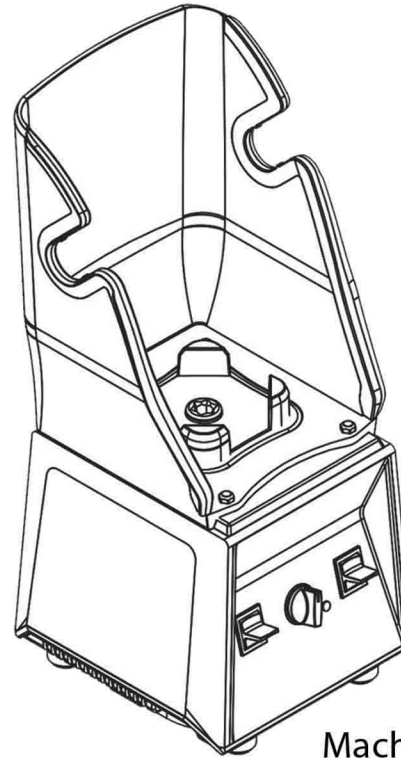
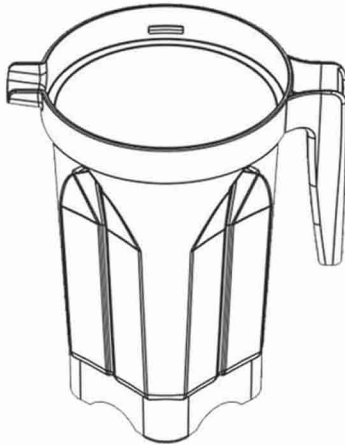

Machine Body

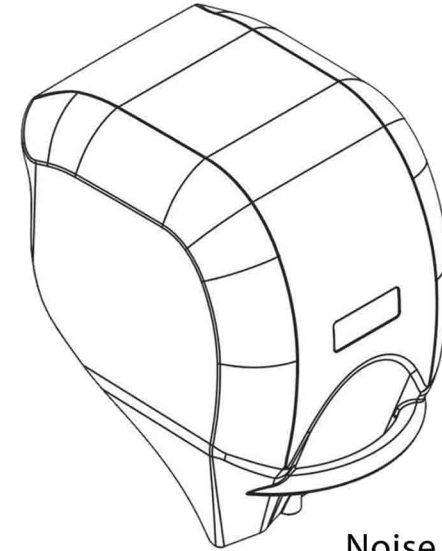

Noise Enclosure





## ICE CRUSHED

Ice crushed drinks has a rough texture of ice, you can feel the ice in your mouth. It is perfect for cocktails.



## ICE SLUSHY

Ice slush has more smooth texture than ice crushed. The shape of the ice is just like diamonds.



## ICE SMOOTHIE

Ice smoothie has a smooth texture with no more ice texture. It is smooth like a snow.



## FRESH JUICE

No need to filtrate the juice, all the fruits has become the juice. It is smooth and no ingredients wasted.



## HOT BEVERAGES/ SOUP/ SAUCE

Make grains, beans, and soup's ingredients in just short time.

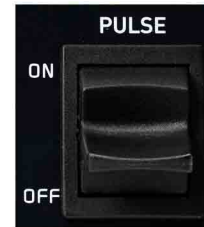

## PULSE

pull up the switch to start pulse function (max speed)  
It will stop automatically when the switch has released



## ON/ OFF

pull up the switch to turn on or turn off the machine



## LED light indicator

**No Shine**, means no electricity, has not unplugged yet or master switch has not switched on  
**Yellow**, machine in stand by status  
**Winking**, the operation will finish soon



# how to operate MD-33SE

MADIN BLENDICON



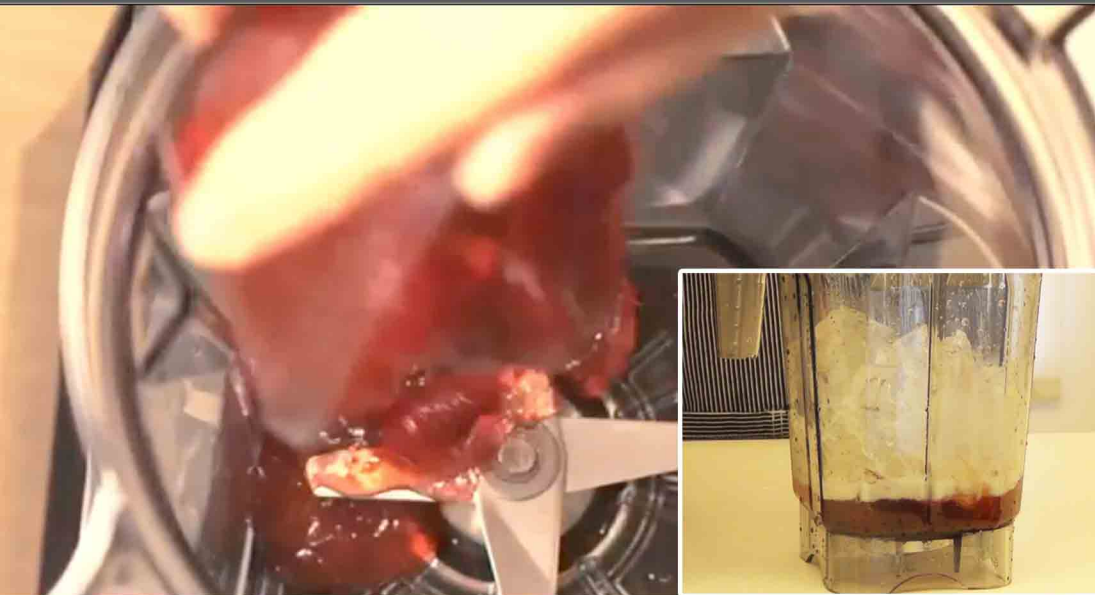

## **Step 1**

### **Put the ingredients**

1. Put ice cubes inside the blender jar.
2. Put the ingredients, such as:  
smoothie jam or powder, fruits, etc.
3. Put milk or smoothie base, etc.



## **Step 2**

### **Put the blender jar on to the machine properly**

close the blender jar with the jar cover and condiment lid





## Step 3

### Select the program

Choose the program that you need to suit your beverage, for smoothie program will be finished in just 30 seconds

## Step 4

### Pull up the power switch (ON)

Switch ON to start the blending operation. The program will be finished automatically.

**NOTE:**

**Close the noise enclosure properly**

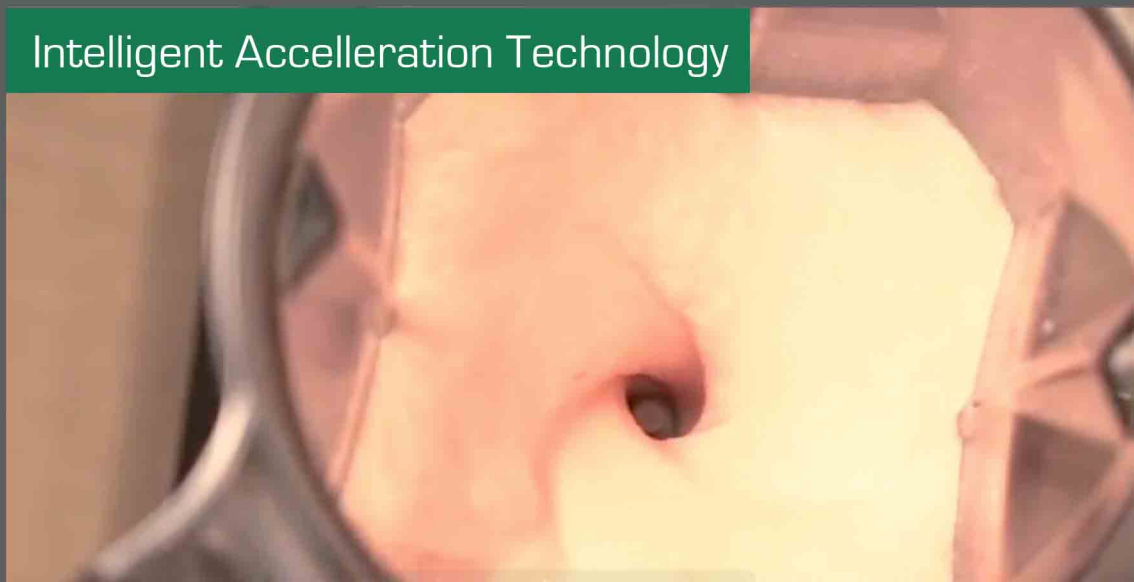

Intelligent Accelleration Technology

Put the JAR COVER and LID PROPERLY into the blender jar



When using the stirring rod, blender jar MUST be covered with jar cover

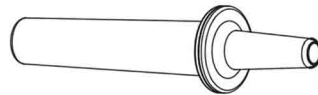

DO NOT put finger when the blender is in working process



Before cleaning the machine or blender jar, remember to UNPLUG the cord

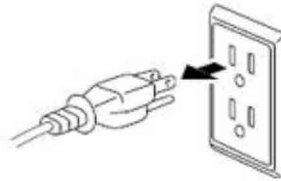

DO NOT use the machine for other purpose

DO NOT let any liquid reach inside the machine.

Ex: Water, milk, fructose, etc



DO NOT let any insects reach inside the machine



DO NOT put ice cube or ingredients until the whole jar





# Troubleshooting and Emergency Treatment

## 1. When motor does not move

Possible cause: Check the jar inserted correctly or not?

Press "recovery key" then unplug and re-plug the power cord. (Decoding automatically)

## 2. Operation suddenly stopped

Possible cause: Too much amount of ingredients (ice cubes). concentration of the ingredients is too high or the viscosity is too sticky

Situation above, the amount should be reduced by half or adding more. This machine is equipped with "safety off device". The machine will automatically power off when the electricity overloads, please unplug and re-plug, and then the machine will be able to use again.



1. The blender is provided with “Overload Protection Device”, when the temperature is over heat, the machine will turn off automatically.
2. Please unplug the power cord for 15 minutes. When the temperature back to normal, blender is ready to use again
3. If there is any sparkles or flames happened during operation. Please unplug it immediately and call nearest dealers or our company as soon as possible

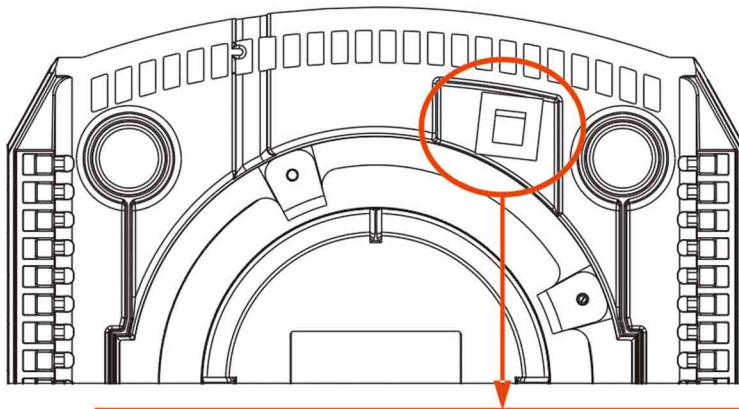

Temperature Protection Device

The blender will automatically shut off when the temperature is over from normal. Unplug the cord, let it rest for 15 minutes. When the temperature back to normal. The machines Is ready to use again.