

2

1

B

B

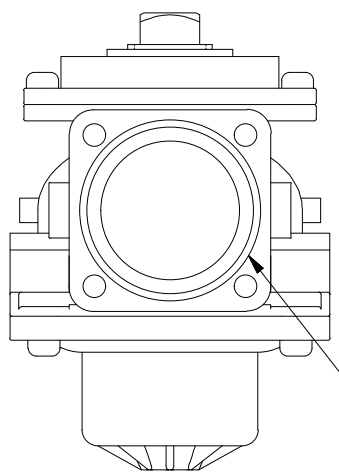
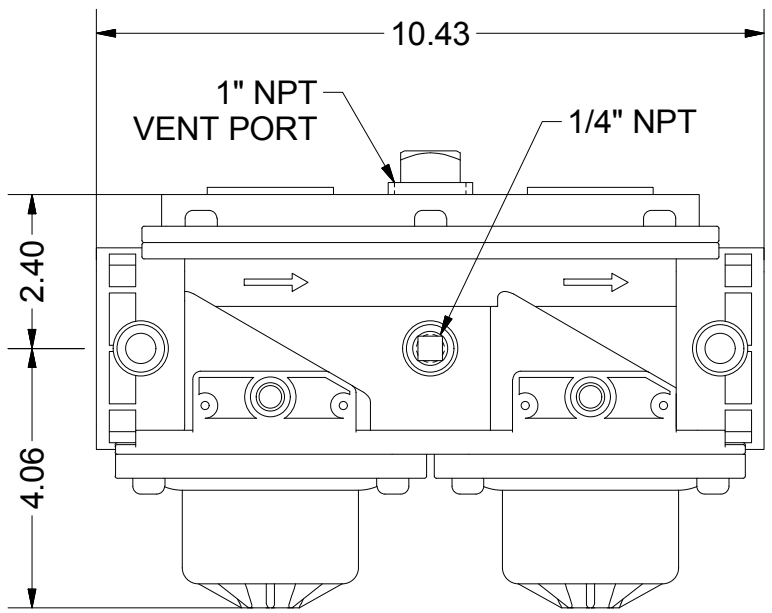
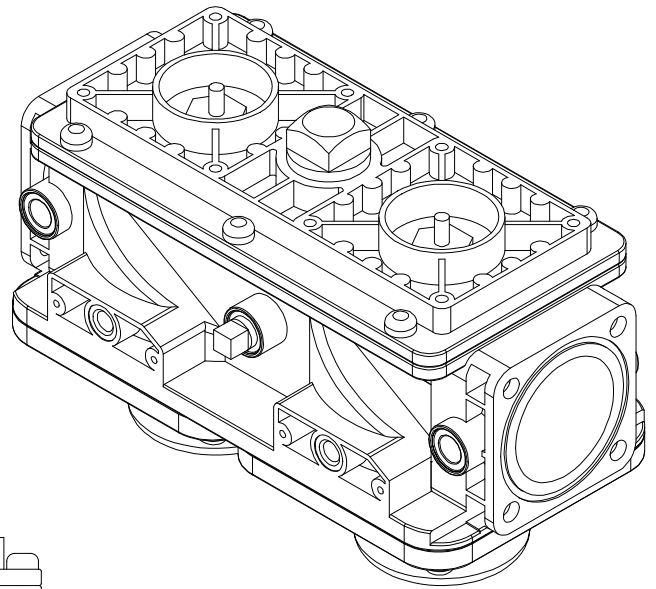

2" BODY
 (2) THREADED FLANGES (AGF10.xxU)
 ARE REQUIRED FOR INSTALLATION
 AND ARE AVAILABLE SEPARATELY

A

A

REV.

1

NOTE: DIMENSIONS FOR REFERENCE ONLY

| | | | | | | | |
|--|----------|--|-----------|---|----------|------------|-----------------|
| MATERIAL VALVE BODY: ALUMINUM | | SCC Inc. Elk Grove Village, IL 60007 PH# 224-366-8445 | | DESCRIPTION Double Gas Valve Body (2" NPT) | | | |
| FINISH | | | | ENGINEER | DRAWN BY | CHECKED BY | DATE ORIGINATED |
| TOLERANCES (UNLESS OTHERWISE SPECIFIED) | | ALL DIMENSIONS IN INCHES UNLESS NOTED | | | 1/7/2013 | 1 of 1 | 1/3 |
| FRACT. | .XX | .XXX | ANG. | | | | |
| | +/- 0/00 | +/- 0.01 | +/- 0.005 | +/- 0.5 | | | |
| This Drawing and all information contained in this Drawing is the Property of SCC Inc. | | | | PART / DRAWING # VGD20.503U | | | |

2

1