



WP-26 TIG TORCH PACKAGE

Air Cooled 200AMPS
Duty cycle:60%



- AC-26200 WP-26-12ft 2PC TORCH PACKAGE
- AC-26301 WP-26-25ft 2PC TORCH PACKAGE
- AC-26202 WP-26-12ft 1PC TORCH PACKAGE
- AC-26302 WP-26-25ft 1PC TORCH PACKAGE

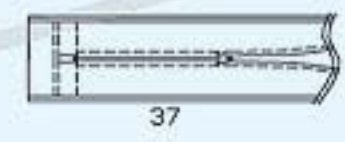
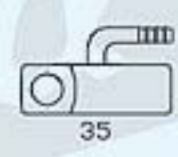
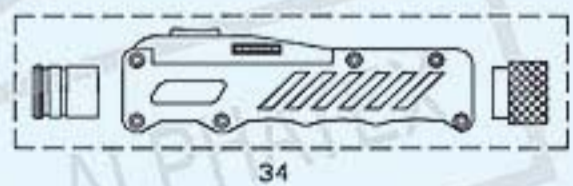
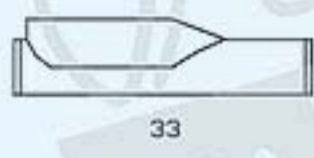
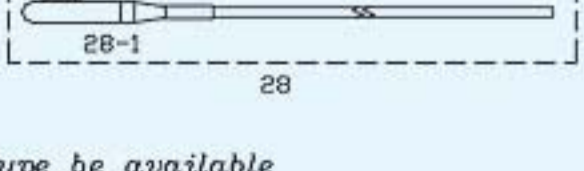
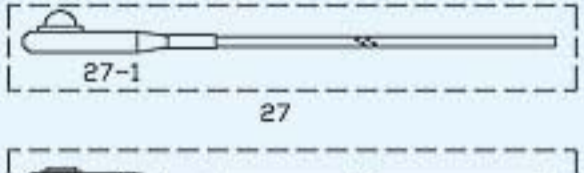
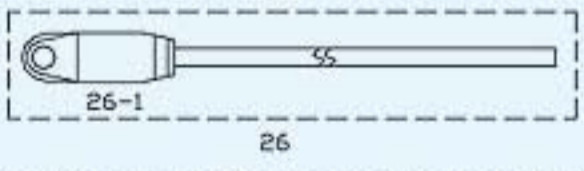
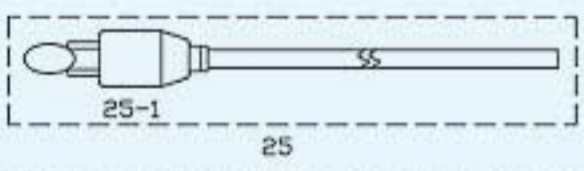
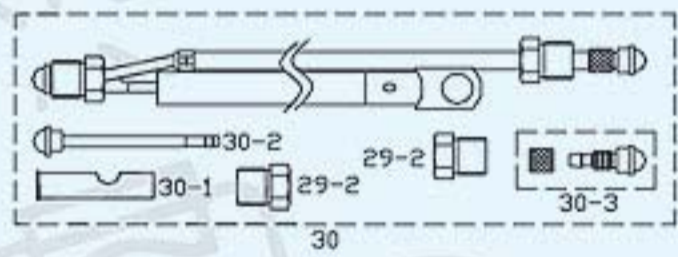
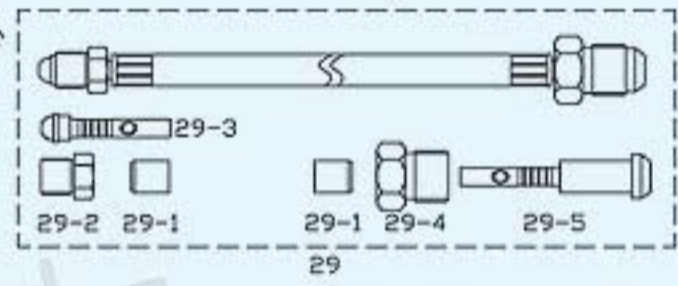
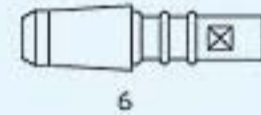
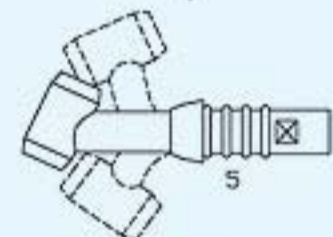
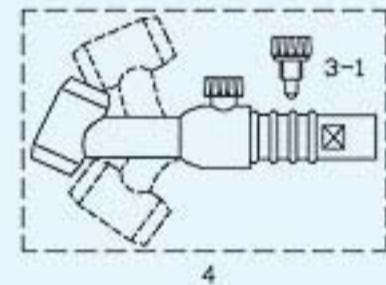
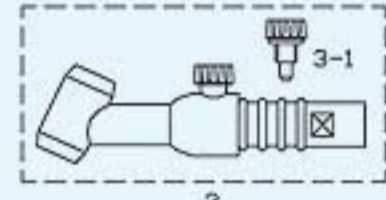
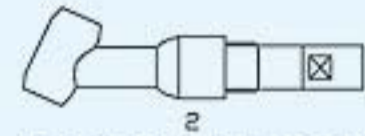
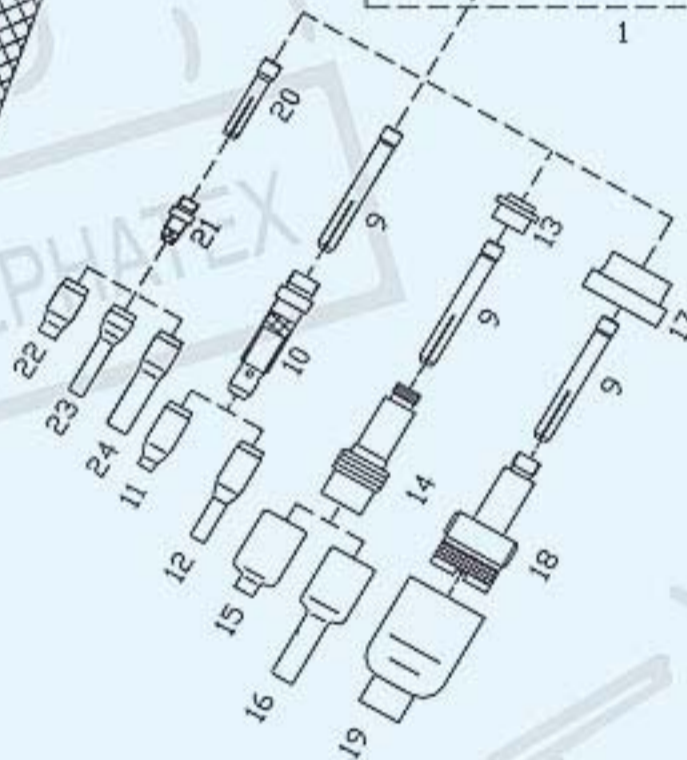
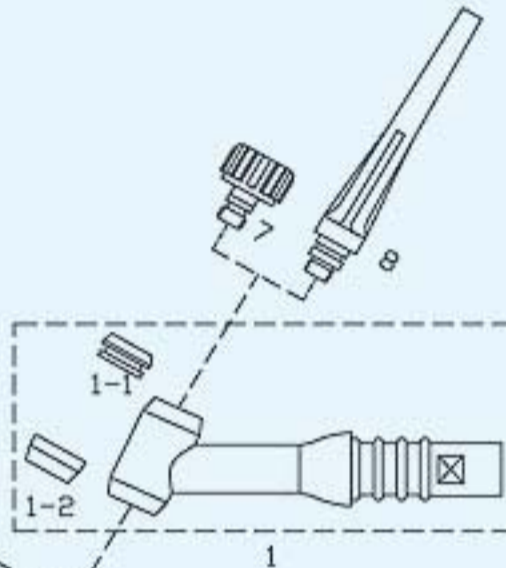
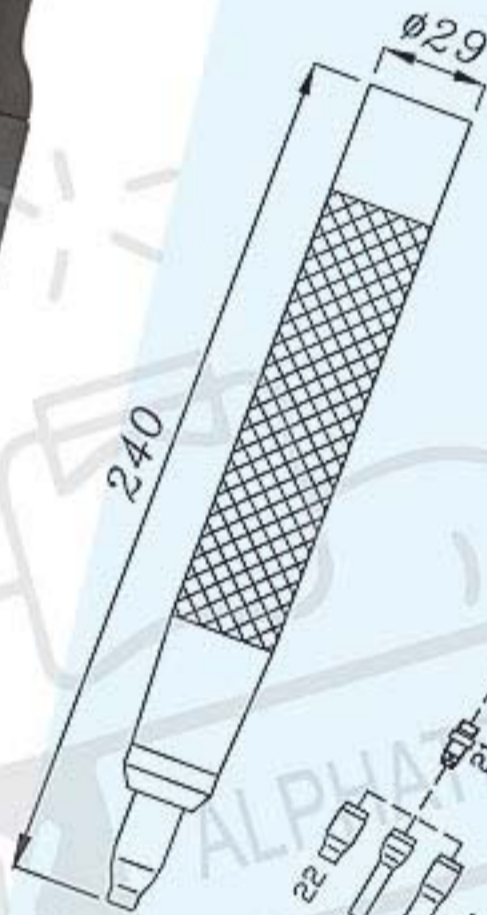

*Any type be available

WP-26 TIG TORCH PACKAGE

Air Cooled 200AMPS
Duty cycle:60%

ITEM	CODE	DESCRIPTION	ITEM	CODE	DESCRIPTION
1	AC-26100	WP-26 Torch Body		AP-18930	45V64 Larger Gaslens 2.4mm
1-1	AO-15100	18CC-1 Standard Heatshield-1		AP-18940	995795 Larger Gaslens 3.2mm
1-2	AO-15200	18CC Standard Heatshield Cup Gasket		AP-18950	45V63 Larger Gaslens 4.0mm
2	AC-26140	HP-26 Torch Body	19	AN-27110	57N75 Gaslens nozzle #6 9.6mm
3	AC-26120	WP-26V Torch Body Argon Valve		AN-27120	57N74 Gaslens nozzle #8 12.8mm
3-1	AO-10320	VS-1 Valve Stem		AN-27130	53N88 Gaslens nozzle #10 16mm
4	AC-26150	WP-26VF Torch Body w/ Argon Valve & Flexible		AN-27140	53N87 Gaslens nozzle #12 19.2mm
5	AC-26130	WP-26F Flexible Torch Body	20	AP-18210	10N22S Stubby Collet 1.0mm
6	AC-26160	WP-26P Pencil Torch Body		AP-18220	10N23S Stubby Collet 1.6mm
7	AC-10300	57Y04 Short Back Cap		AP-18230	10N24S Stubby Collet 2.4mm
8	AO-10100	57Y02 Long Back Cap		AP-18240	10N25S Stubby Collet 3.2mm
9	AP-18000	10N21 Collet 0.5mm	21	AP-18630	17CB20 Stubby Collet Body 3.2mm
	AP-18010	10N22 Collet 1.0mm	22	AN-20010	13N08 Standard nozzle #4 6.4mm
	AP-18020	10N23 Collet 1.6mm		AN-20020	13N09 Standard nozzle #5 8mm
	AP-18024	10N23-4 Collet 1.6mm		AN-20030	13N10 Standard nozzle #6 9.6mm
	AP-18021	10N23-2.0 Collet 2.0mm		AN-20040	13N11 Standard nozzle #7 11.2mm
	AP-18030	10N24 Collet 2.4mm		AN-20050	13N12 Standard nozzle #8 12.8mm
	AP-18034	10N24-4 Collet 2.4mm		AN-20060	13N13 Standard nozzle #10 16mm
	AP-18040	10N25 Collet 3.2mm	23	AN-20220	796F70 Long nozzle #3L 4.8mm
	AP-18044	10N25-4 Collet 3.2mm		AN-20240	796F71 Long nozzle #4L 6.4mm
	AP-18050	54N20 Collet 4.0mm		AN-20260	796F72 Long nozzle #5L 8mm
10	AP-18400	10N29 Collet Body 0.5mm		AN-20280	796F73 Long nozzle #6L 9.6mm
	AP-18410	10N30 Collet Body 1.0mm	24	AN-20230	796F74 X-Long nozzle #3XL 4.8mm
	AP-18420	10N31 Collet Body 1.6mm		AN-20250	796F75 X-Long nozzle #4XL 6.4mm
	AP-18430	10N32 Collet Body 2.4mm		AN-20270	796F76 X-Long nozzle #5XL 8mm
	AP-18440	10N28 Collet Body 3.2mm		AN-20290	796F77 X-Long nozzle #6XL 9.6mm
	AP-18450	406488 Collet Body 4.0mm	25	AO-19200	SW-4 Lever Microswitch w/ 12ft S.W. Cable
11	AN-18210	10N50 Standard nozzle #4 6.4mm		AO-19300	SW-4 Lever Microswitch w/ 25ft S.W. Cable
	AN-18220	10N49 Standard nozzle #5 8mm	25-1	AO-19100	SW-4 950/L Lever Microswitch
	AN-18230	10N48 Standard nozzle #6 9.6mm	26	AO-19210	SW-3 Microswitch w/ 12ft S.W. Cable
	AN-18240	10N47 Standard nozzle #7 11.2mm		AO-19310	SW-3 Microswitch w/ 25ft S.W. Cable
	AN-18250	10N46 Standard nozzle #8 12.8mm	26-1	AO-19110	SW-3 Microswitch Pana
	AN-18260	10N45 Standard nozzle #10 16mm	27	AO-19230	950/M switch w/ 12ft S.W. Cable
	AN-18270	10N44 Standard nozzle #12 19.2mm		AO-19330	950/M switch w/ 25ft S.W. Cable
12	AN-18400	10N50L Long nozzle #4L 6.4mm	27-1	AO-19000	950/M Bulb Buttom Switch
	AN-18410	10N49L Long nozzle #5L 8mm	28	AO-19220	950/F switch w/ 12ft S.W. Cable
	AN-18420	10N48L Long nozzle #6L 9.6mm		AO-19320	950/F switch w/ 25ft S.W. Cable
	AN-18430	10N47L Long nozzle #7L 11.2mm	28-1	AO-18900	950/F Flat Switch
13	AO-15000	54N01 Gaslens Insulator	29	AO-14282	46V28R Power Cable WP-26 12ft 1PC
14	AP-18801	45N29 Gaslens Collet Body 0.5mm		AO-14280	46V30R Power Cable WP-26 25ft 1PC
	AP-18811	45N24 Gaslens Collet Body 1.0mm	29-1	AO-42400	Hose Clamp
	AP-18821	45V25 Gaslens Collet Body 1.6mm	29-2	AO-24300	136Z08 Gas Nut
	AP-18831	45V26 Gaslens Collet Body 2.4mm	29-3	AO-12521	45V68 Current Nipple
	AP-18841	45V27 Gaslens Collet Body 3.2mm	29-4	AO-24420	Cable Nut
	AP-18851	45V28 Gaslens Collet Body 4.0mm	29-5	AO-12910	11N38 Current Nipple
15	AN-18310	54N18 Gaslens nozzle #4 6.4mm	30	AO-14530	46V28-2 Power Cable For WP-26 12ft 2PC
	AN-18320	54N17 Gaslens nozzle #5 6.4mm		AO-14540	46V30-2 Power Cable For WP-26 25ft 2PC
	AN-18330	54N16 Gaslens nozzle #6 9.6mm	30-1	AO-27600	Cable Connector
	AN-18340	54N15 Gaslens nozzle #7 11.2mm	30-2	AO-27700	Gas Nipple
	AN-18350	54N14 Gaslens nozzle #8 12.8mm	30-3	AO-26110	11N22 Nipple 12.5/5.0mm/28L
	AN-18360	54N19 Gaslens nozzle #10 16mm	31	AO-11120	H200 Handle
16	AN-18510	54N17L Long Gaslens nozzle #5L 8mm		AO-11700	54N84 Handle For HP26
	AN-18520	54N16L Long Gaslens nozzle #6L 9.6mm	32	AO-11130	H200R Handle
	AN-18530	54N15L Long Gaslens nozzle #7L 11.2mm	33	AO-11111	BL-1 Switch Boot-Ribbed
	AN-18540	54N14L Long Gaslens nozzle #8L 12.8mm	34	AO-11440	Current ADJ Handle
17	AO-15010	54N63 Gaslens Insulator	35	AO-27210	45V62 Power Cable Adapter Bent
18	AP-18900	45V0204 Larger Gaslens 0.5mm	36	AO-27211	45V62 Power Cable Adapter U.S. Type
	AP-18910	45V0204 Larger Gaslens 1.0mm	37	AO-18410	Zipper Cover 12ft
	AP-18920	45V116 Larger Gaslens 1.6mm		AO-18400	Zipper Cover 25ft

*Any type be available