

★ 本产品符合最新国标《电动汽车传导充电用连接装置》符合国标GB/T20234.2-2015要求

The product comply with the latest national standard GB/T20234.2-2015 "Electric Vehicle Charging Connection device"

供电端supply side
标贴The mark sticks

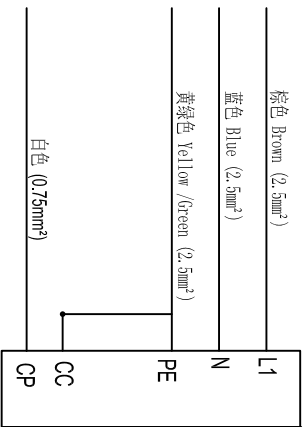
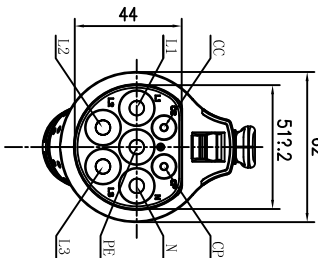
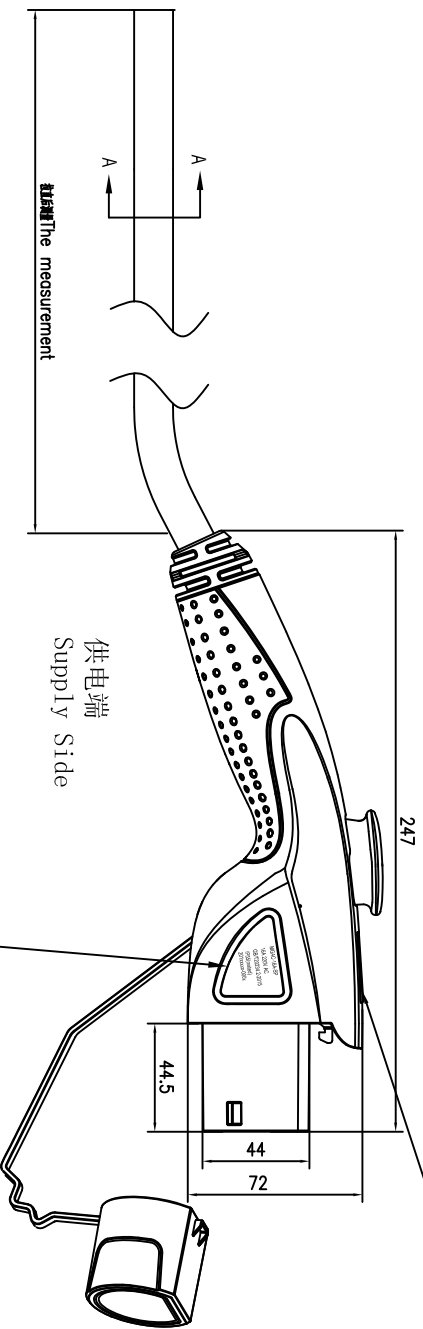

供电端是一组激光打标码(激光打标码)如下:
The laser marking content (laser) of supply side is the following:
MGAC-16A-SP
16A 250V AC
GB/T20234.2-2015
IP55(Inated)
201xxxxx-000x

供电端激光打标码的激光打标码的激光打标码如下:
The laser marking content (laser) of supply side is the following:
MGAC-16A-SP
16A 250V AC
GB/T20234.2-2015
IP55(Inated)
201xxxxx-000x

DEGSON

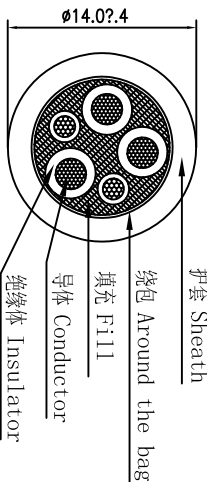

技术参数 Technical parameters

额定电压 Rated voltage	250V AC
额定电流 Rated current	16A
温度范围 Temperature range	-30℃~+50℃
绝缘电阻 Insulate resistance	>10MΩ, 1000V DC
耐压电压 Bear voltage	L、N与PE >2500V AC L与PE >2500V AC
防护等级 Ingress protection	IP55 (Mated)
插拔次数 The insertion/pullout times	10000 次
插拔力 Insertion/pullout force	<100N
标准 Standart	GB/T 20234.2-2015

国际供电端接线图
National standard of power supply wiring diagram

Customer Drawing

线性尺寸范围 . XX	. X	PLASTIC DRAWING FRAME	MATERIAL:	SURFACE FINISH:
0-6	±0.05	PART NO.:	DEGSON 宁波高松电子有限公司 NINGBO DEGSON ELECTRICAL CO.,LTD	
6-30	±0.1	APPD:	NAME: 国际交流供电端充电枪 (16A单相) National standard AC supply charging connection (16A single-phase)	
30-120	±0.15	CHKD:	TITLE: 接线图 Wiring diagram	
120-400	±0.2	DRFT:	DRAWING NO.:	REV
400-1000	±0.3		MM	SHEET
1000-2000	±0.5		INCH	SCALE
角度尺寸范围 . XX	. X	THIRD ANGLE PROJECTION		3/1
±0.5	±1°			