

DS-2CE55A2P(N)-VFIR3

700TVL Vari-focal IR Dome Camera

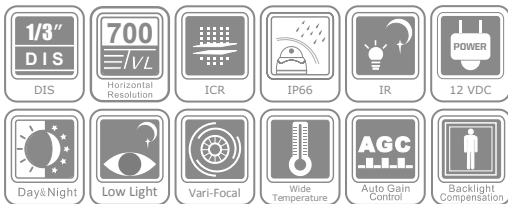

Key features

- 1/3" DIS
- True Day/Night
- 700 TVL horizontal resolution
- 2.8 ~ 12mm vari-focal lens
- 40m IR distance
- Wide operating temperature range

Dimensions

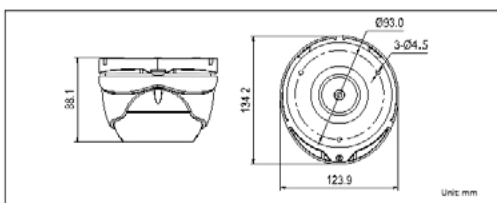

DS-2CE55A2P(N)-VFIR3	
Camera	
Image Sensor	1/3" DIS
Signal System	PAL/NTSC
Effective Pixels	976(H)×496(V)
Min. Illumination	0.1 Lux @ (F1.2,AGC ON),0 Lux with IR 0.14 Lux @ (F1.4,AGC ON),0 Lux with IR
Shutter speed	PAL: 1/50 s to 1/100,000 s NTSC: 1/60 s to 1/100,000 s
Lens	2.8-12mm @ F1.4
	Angle of view: 80° - 27.2°
Lens Mount	φ14
Angle Adjustment	Pan: 0 - 360°, Tilt: 0 - 75°, Rotation: 0 - 360°
Day & Night	IR cut filter with auto switch
Horizontal Resolution	700 TVL
Synchronization	Internal synchronization
Video Output	1Vp-p composite output (75 Ω/BNC)
S/N Ratio	More than 62 dB
BLC	On
General	
Working Temperature/ Humidity	-40 °C - 60 °C (-40 °F - 140 °F) Humidity 90% or less (non-condensing)
Power Supply	12 V DC ± 10%
Power Consumption	Max. 4 W (Max. 5 W with IR cut filter on)
Ingress Protection	IP66
IR Range	Approx. 30 to 40 meters
Dimensions	134.2×123.9×88.1mm(5.28"×4.88"×3.47")
Weight	800g (1.76l lbs)

Available models

PAL: DS-2CE55A2P-VFIR3
NTSC: DS-2CE55A2N-VFIR3