



## 8 Ports Industrial Full Gigabit PoE Managed Switch UTP7308GE-POE



UTP7308GE-POE is 8 Ports Industrial Full Gigabit PoE Managed Switch Provide 8\* 10/100/1000Base-T Ethernet ports(PoE), 4 \* 1000BASE-X SFP ports(Unlinks). The switch provides up to 4Mbit cache, Support 4K high-definition video transmission. Besides, the 8 downlink PoE ports support IEEE802.3af/at standard. PoE output power of single port is up to 60W , support high-speed dome; support Web-based network management, support VLAN, QoS, RSTP, SNMP etc. network function; Working temperature 40°C ~ 75°C, strong level of protection from lightning, anti-interference. It fully satisfies the needs of security video surveillance project.

# Hybrid Ports: RJ45 + SFP 1.

4 \* Gigabit SFP Optical slots (long distance transmission)  
8 \* Gigabit PoE ports (remote router or NVR access)



# 2 Speedy Loop Network

Recovery time < 20ms & Layer-2 management features

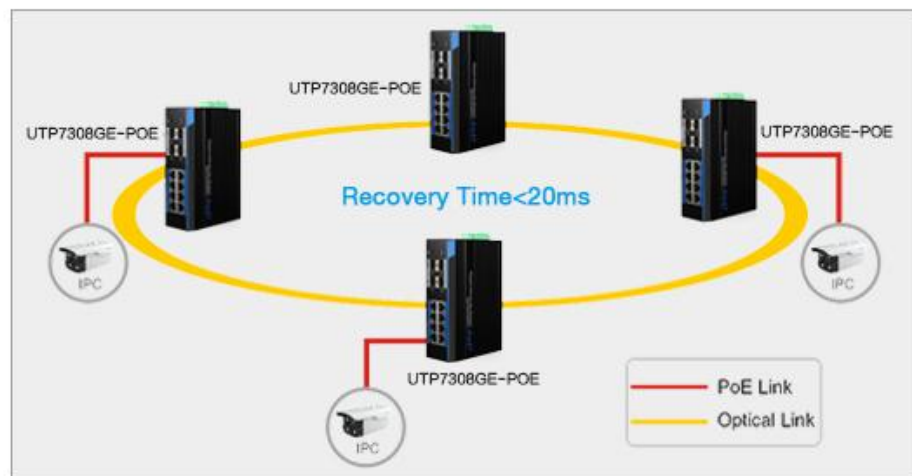

# 60W POE 3.

1-8 downlink ports support IEEE802.3 af/at standards;  
Max. 60W PoE of single port to satisfy power supply of dome cameras  
(Default PoE of port 1=60W, able to be configured on web-base management page)



# 4 Alarm Notification

Warnings of DC power failure, Cable link down & PoE link down.

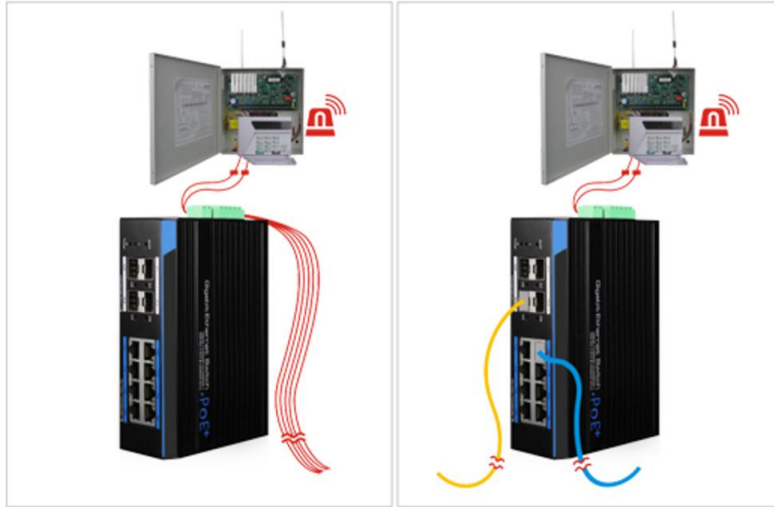

DC Power Failure Warning

Cable Link Down Warning  
PoE Link Down Warning

# Adapt to Complex Environment

Wavy metal shell features good heat dissipation;  
Industrial Level 4 protection (ESD, RS, CS, EFT, etc.)

# 5.



-40°C ~ +75°C  
6KV Surge Immunity  
Industrial Level 4 Protection





Model Number	UTP7308GE-POE
Downlink Ports	8* 10/100/1000Base-T PoE RJ45 ports
Uplink Ports	4*1000Base-X SFP ports
Network Standard	IEEE802.3 , IEEE802.3u , IEEE802.3ab , IEEE802.3Z , IEEE802.3X , IEEE 802.1Q , IEEE 802.1p , IEEE 802.3ad , IEEE 802.1D , IEEE 802.1X
Bandwidth	24Gbps
Packet Transfer Rate	18Mpps
Exchange Way	Storage& Transfer
Buffer	4M
MAC Address	8K
PoE Standard	802.3af/at
PoE Power Supply	End-span
PoE Line Pair	1/2(+), 3/6(-)
PoE Output	Single Port ≤ 30W PoE
alarm signal output by relay	Support relay alarm for power off , ports network link-off , ports PoE off ( Set by Web Software )
Surge Immunity	6kV Per: IEC61000-4-5
ESD Protection	ESD Level 4 Per: IEC61000-4-2 RS Level 4 Per: IEC61000-4-3 EFT Level 4 Per: IEC61000-4-4 CS Level 4 Per: IEC61000-4-6
Input Voltage	48-57V DC
Power Consumption	Self consumption<15W
Operation Temperature	-40°C~75°C
Storage Temperature	-40°C~85°C
Operation Humidity	5%-95% (no-condensation)
Dimension(LxWxH)	159mm×110mm×46.5mm
Weight	1kg
Authentication	CE , FCC , ROHS

Software Parameter

Port Management	Support Port Enable/Disable;
	Support Port Rate Settings;
	Support Port Full-duplex Mode;
	Support IEEE802.3x Flow Control;
VLAN	Support Port Name Change;
	Support 4K VLAN
	Support 802.1Q Protocol-Based VLAN; Support Port-Based VLAN;
QoS	Support QoS;
	Support 8-Level Priority management for switching;
	Support WRR;
	Support 820.1P and DSCP Priority;
Multicast Management	Support SNMP V1/V2/V3 Protocol;
	Support IGMP Snooping;
POE Management	Support Total Power Consumption Control;
	Support PoE ON/OFF; Support Single Port 60W/30W max. Power Change and Port Output Priority;
alarm signal output by relay	Support relay alarm for power off , ports network link-off , ports PoE off
Safety Character	Support IP , MAC , Port , VLAN Combination and Binding;
	Support MAC address auto-learning, aging& filter;
	Support Port Isolation, Port Speed-Limited;
	Support RSTP;
	Support Fast-Ring;
	Support 5 groups of 8-Port trunk;
System Management& Maintenance	Support RADIUS Authentication& 802.1X Authentication;
	Support WEB Management, CLR Settings and telnet Settings; Support CLR Settings;

	Support FTP/TFTP/HTTP Web Upgrading;
	Support Flow Calculate;
	Support MAC address Form Search;
	Support IP Address, DNS Server Change
	Support Username& Password Change;
	Support History Record, Journal management;
	Support System settings Backup;

## • Dimensions

