

65510
BS
Universal Center(Dividing Head)

Features :

- ▶ Designed for carrying out all types of gear cutting. Precision dividing and spiral work are more efficient than ever.
- ▶ The center face can be tilted from a horizontal position of 90° down to -10° from vertical with graduation reading in degrees.
- ▶ The ratio of worm to gear is 1:40.
- ▶ Fully inspected and tested to assure.
- ▶ Operation and service manual included with each package.

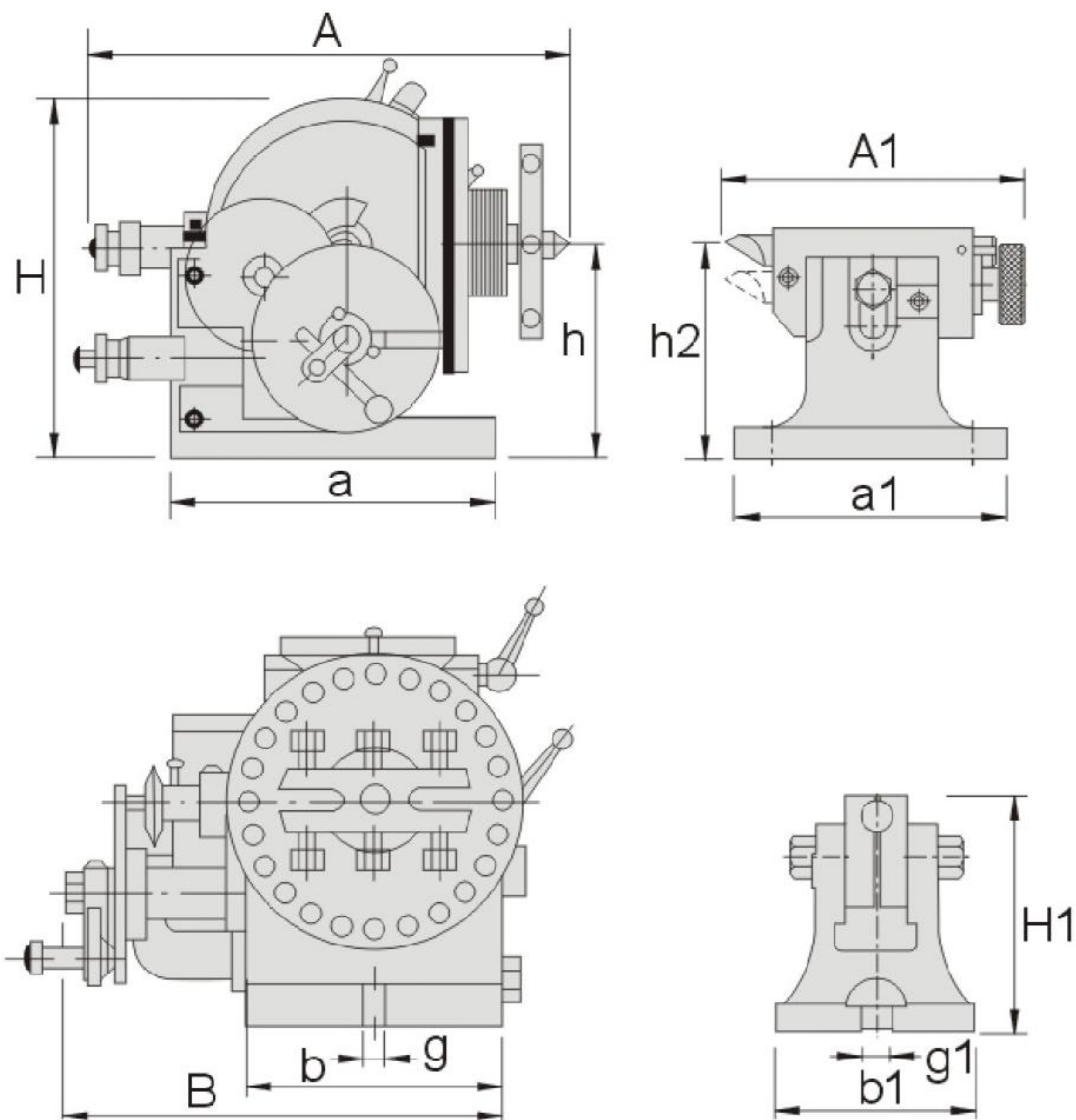

Application:

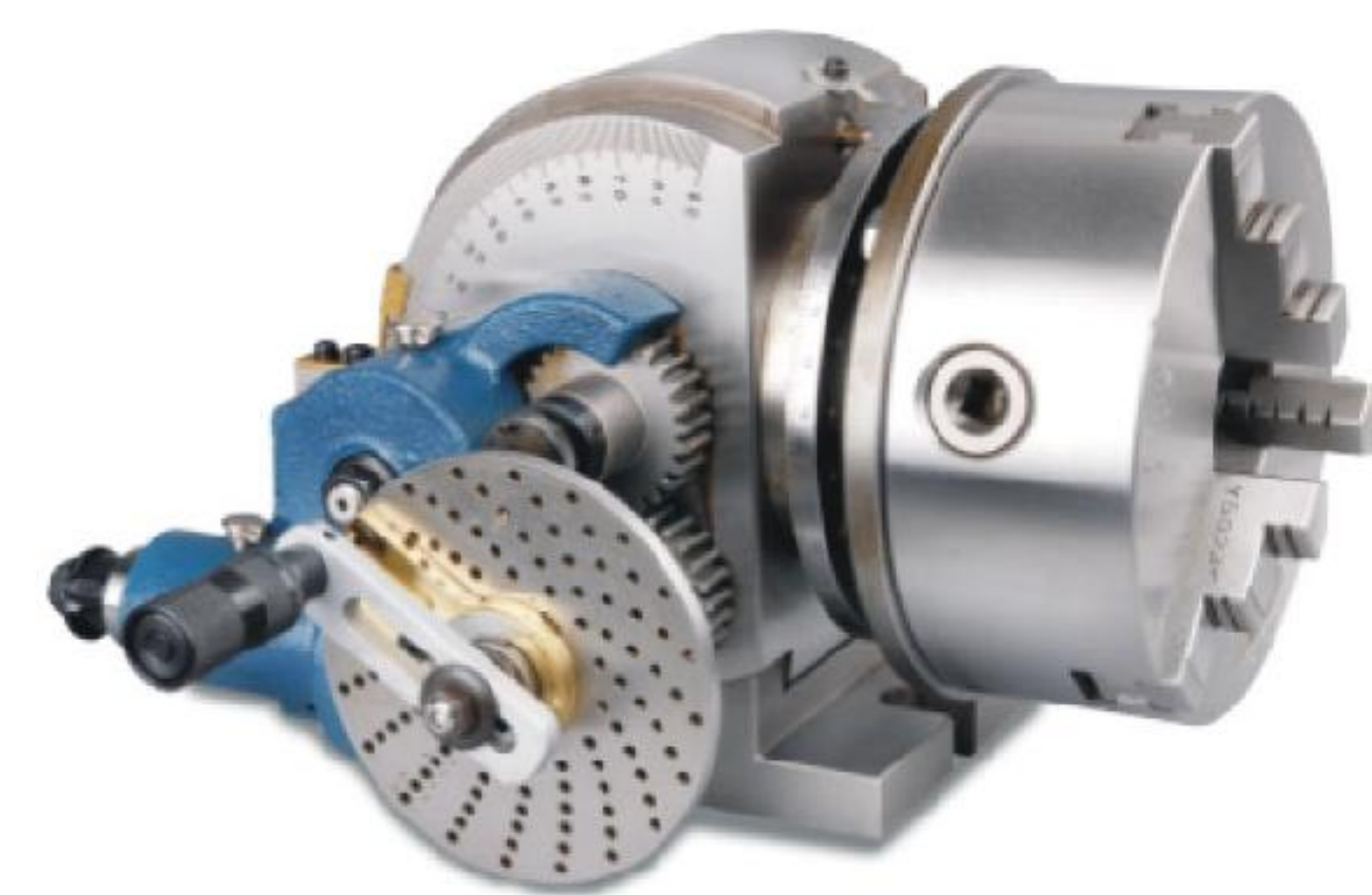

Optional Accessory:
6" or 7" or 8" 3-Jaw Chuck for BS-2

SEMI-UNIVERSAL INDEX CENTER (DIVIDING HEAD) SPECIFICATION

Unit:mm

Order No.	Model	A	B	H	h	a	b	g	Center Taper
65510	BS2	365	272	236	132.7	213	134	16	B&S NO 10

TAILSTOCK SPECIFICATON

Unit:mm

	A1	a1	b1	g1	H1	Center Height h2		N.W.
BS2	194	177	125	16	147	Max.	Min.	73kg
						138	115	

No. of holes of dividing plate (worm gear reduction ratio 1:40)

Unit:mm

No. of Holes	Plate A	15	16	17	18	19	20
	Plate B	21	23	27	29	31	33
	Plate C	37	39	41	43	47	49