

BT / NT
series

AMG

Double Power Chuck

超倍力夾頭刀桿

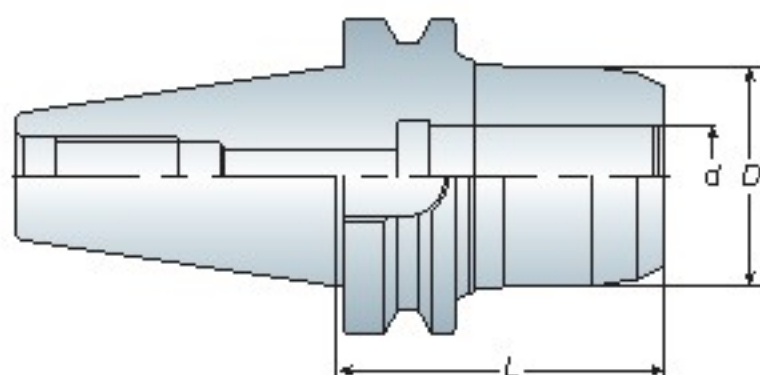

Jet through
端面出水

Features

- AMG tooling system is suitable for high speed and heavy cutting simultaneously.
- AMG tooling system is special designed for coolant type - JET THROUGH.
- High precision clamping because of the design of needle roller bearing.
- The spacer could make the flange & nut be tightened and provide exceptional rigidity.
- Wrench must be ordered separately.
- Max speed: 30,000 r.p.m G2.5
- AMG 刀桿系列可同時在高速切削及重切削上使用
- AMG 刀具系列為端面給油設計
- 刀桿採用針狀軸承設計，夾持度極佳
- 螺帽透過墊片與本體貼合使之提高剛性
- 扳手為另購品
- 最高轉速可達 30,000 r.p.m G2.5

Model No.	d	D	L	Wrench	Weight (kg)
BT30AMG12-080	12	46	80	WAMG12	1.10
AMG16-095	16	54	95	WAMG16	1.30
AMG20-095	20	58	95	WAMG20	1.60
AMG25-100	25	62	100	WAMG25	1.80
AMG32-095	32	70	95	WAMG32	2.00
BT40AMG12-080	12	46	80	WAMG12	1.60
-105	12	46	105	WAMG12	2.00
AMG16-080	16	54	80	WAMG16	1.80
-105	16	54	105	WAMG16	2.30
AMG20-090	20	58	90	WAMG20	2.00
-105	20	58	105	WAMG20	2.30
AMG25-095	25	62	95	WAMG25	2.20
AMG32-090	32	70	90	WAMG32	2.30
-105	32	70	105	WAMG32	2.60
BT50AMG12-105	12	46	105	WAMG12	4.60
-135	12	46	135	WAMG12	5.10
-165	12	46	165	WAMG12	5.80
AMG16-105	16	54	105	WAMG16	4.90
-135	16	54	135	WAMG16	5.50
-165	16	54	165	WAMG16	6.50
AMG20-105	20	58	105	WAMG20	4.90
-135	20	58	135	WAMG20	5.60
-165	20	58	165	WAMG20	6.50
AMG25-105	25	62	105	WAMG25	4.90
-135	25	62	135	WAMG25	5.70
-165	25	62	165	WAMG25	6.70
AMG32-105	32	70	105	WAMG32	5.00
-135	32	70	135	WAMG32	5.80
-165	32	70	165	WAMG32	6.70

Unit: mm



P6-Wrench



- **AMG Double Power Chuck** with nut for C-WRENCH is available.
- Please change name from AMG to AMC of each model no. when ordering.
- 螺帽部分為 C 型系列，訂購時，請更改品名為 AMC
- Example: BT40 AMC16-080

