

## Straight Collet

直束筒夾

Model No.	D	d	L	Weight (kg)
SC12	12	3,4,5,6,7,8,9,10	40	0.02
SC16	16	3,4,5,6,7,8,9,10,11,12	42	0.06
SC20	20	4,6,8,10,12,14,16	52	0.10
SC25	25	6,8,10,12,14,16,18,20	63	0.16
SC32 - Metric	32	6,8,10,12,14,16,18,20,25	71	0.30
SC32 - Inch	32	1/4,5/16,3/8,1/2,5/8,3/4,1	71	0.30
SC42	42	6,8,10,12,14,16,18,20,25,32	71	0.60

Unit: mm

## Straight Collet-Coolant Type

止水型直束筒夾

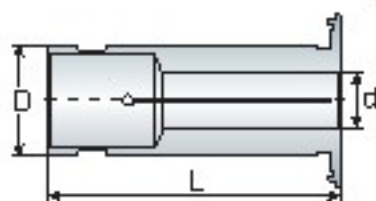

Model No.	D	d	L	Weight (kg)
SC12-CL	12	3,4,5,6,8	40	0.02
SC20-CL	20	4,6,8,10,12,14,16	52	0.10
SC32-CL	32	6,8,10,12,14,16,18,20,25	71	0.30

Unit: mm

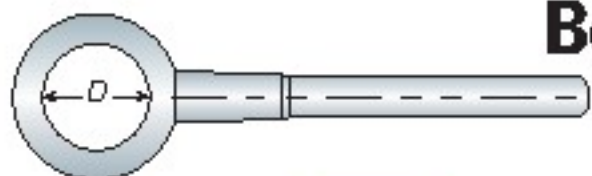

## Bearing Wrench

軸承扳手

Model No.	D	Suit for	Weight (kg)
WASG12	35	ASG12	0.70
WAMG12 / WASG16	46	AMG12 / ASG16	0.70
WAMG16 / WASG20	54	AMG16 / ASG20 (ASK25)	0.90
WAMG20 / WASG25	58	AMG20 / ASG25	1.10
WAMG25	62	AMG25	1.10
WASG32	68	ASG32	1.20
WAMG32	70	AMG32	1.20

Unit: mm

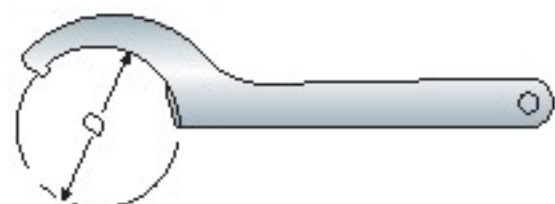

## C-type Wrench

C 型扳手

Model No.	D	Suit for	Weight (kg)
WASC16	46	ASC16	0.22
WASC20	53	ASC20	0.22
WASC25	55	ASC25 / OZ25	0.28
WASC32	68	BT30 / BT40 ASC32	0.35
WASC42	76	BT50 ASC32 / ASC42 / OZ32	0.40

Unit: mm

# SC

BT / NT  
series



# SC-CL



# AMG / ASG / ASC



# ASC



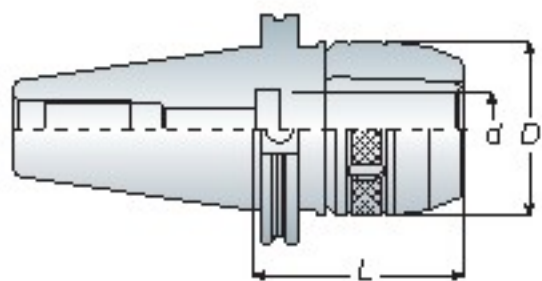

## Milling Chuck

強力銑刀夾頭刀桿

# ASC

# CAT

series

Model No.	Clamping Range	d	D	L	Collet Type	Weight (kg)
CAT40 ASC3/4"- 3.75"	1/4"~3/4"	3/4"	2.13"	3.75"	SC3/4"	2.10
CAT40 ASC1"- 3.15"	1/4"~1"	1"	2.28"	3.15"	SC1"	1.90
CAT40 ASC1-1/4"- 3.75"	1/4"~1-1/4"	1-1/4"	2.67"	3.75"	SC1-1/4"	2.20
CAT50 ASC1"- 3.55"	1/4"~1"	1"	2.28"	3.55"	SC1"	4.10
CAT50 ASC1-1/4"- 4.15"	1/4"~1-1/4"	1-1/4"	2.67"	4.15"	SC1-1/4"	4.70

Unit: mm



- C-type wrench is attached for each ASC milling chuck.
- 每支 ASC 刀桿均附 1 支 C 型扳手



- **ASC Milling Chuck** with nut for bearing wrench is available.
- Please change name from ASC to ASG of each model no. when ordering.
- 螺帽部分配合軸承扳手使用，訂購時，請更改品名為 ASG
- Example: CAT40 ASG1" -3.15"

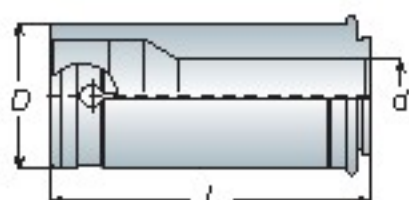

## Straight Collet

直束筒夾

# SC



Model No.	D	d	L	Weight (kg)
SC3/4"	3/4"	1/8, 3/16, 1/4, 5/16, 3/8, 7/16, 1/2, 9/16, 5/8	2.0"	0.10
SC1"	1"	1/4, 3/8, 7/16, 1/2, 5/8, 3/4	2.5"	0.20
SC1-1/4"	1-1/4"	1/4, 3/8, 7/16, 1/2, 5/8, 3/4, 1	2.8"	0.30

Unit: mm

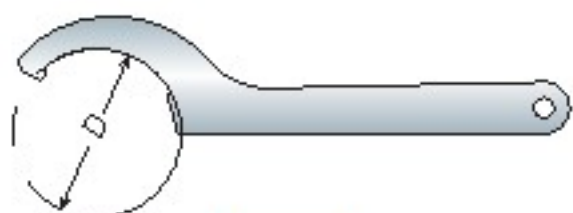

## C-Type Wrench

C 型扳手

# ASC



Model No.	D	Suit For	Weight (kg)
WASC3/4"	2.13"	ASC3/4"	0.20
WASC1"	2.28"	CAT40 ASC1"	0.30
WASC1-1/4"	2.67"	CAT40 ASC1-1/4" CAT50 ASC1"/ASC1-1/4"	0.35

Unit: mm