

SK
series
DIN 69871A

ASG



- ASG tooling system is suitable for high speed and high precision cutting.
- When using without collet, ASG tooling system is designed for coolant type - THROUGH TOOLS.
- Dust-proof design could extend tool holder lifetime.
- Wrench must be ordered separately.
- Max speed: 30,000 r.p.m G2.5
- ASG 刀具系列適用於高轉速、高精密切削加工，切削效果佳
- 在沒有搭配筒夾的情況下使用，ASG 刀具系列為刀尖給油設計
- 特殊防塵設計，提升刀桿壽命
- 扳手為另購品
- 最高轉速可達 30,000 r.p.m G2.5



P6- Wrench

P6- SC Collet

High Speed Milling Chuck

高轉速強力銑刀夾頭刀桿

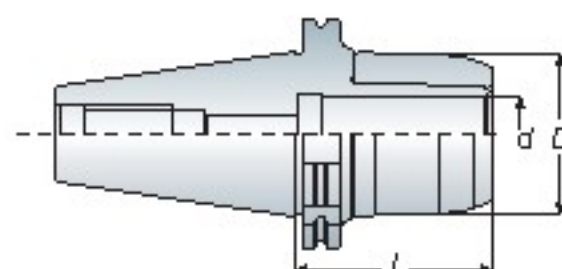

Model No.	Clamping Range	d	D	L	Collet Type	Weight (kg)
SK40 ASG12-095	3~12	12	35	95	SC 12	1.40
ASG16-090	3~16	16	46	90	SC 16	1.80
ASG20-090	4~20	20	54	90	SC 20	2.00
SK50 ASG12-075	3~12	12	35	75	SC 12	3.20
-105	3~12	12	35	105	SC 12	3.50
ASG16-105	3~16	16	46	105	SC 16	4.10
ASG20-105	4~20	20	54	105	SC 20	4.40

Unit: mm

ASC



- C-type wrench is attached for each ASC milling chuck.
- 每支 ASC 刀桿均附 1 支 C 型扳手



P6- Wrench

P6- SC Collet

Milling Chuck

強力銑刀夾頭刀桿

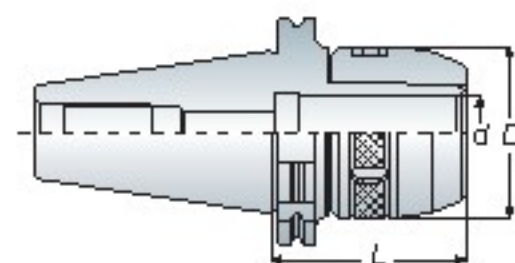

Model No.	Clamping Range	d	D	L	Collet Type	Weight (kg)
SK40 ASC16-090	3~16	16	46	90	SC 16	1.80
ASC20-090	4~20	20	53	90	SC 20	2.00
ASC25-095	6~25	25	58	95	SC 25	2.00
-130	6~25	25	58	130	SC 25	2.70
ASC32-095	6~32	32	68	95	SC 32	2.20
-130	6~32	32	68	130	SC 32	3.00
SK50 ASC16-105	3~16	16	46	105	SC 16	4.00
ASC20-105	4~20	20	53	105	SC 20	4.20
ASC25-095	6~25	25	58	95	SC 25	4.10
-150	6~25	25	58	150	SC 25	5.00
ASC32-105	6~32	32	68	105	SC 32	4.70
-150	6~32	32	68	150	SC 32	5.90
ASC42-110	6~42	42	84	110	SC 42	5.00
-160	6~42	42	84	160	SC 42	7.10

Unit: mm