

BT / NT
series

ASK

High Speed Collet Chuck

高轉速精密筒夾本體

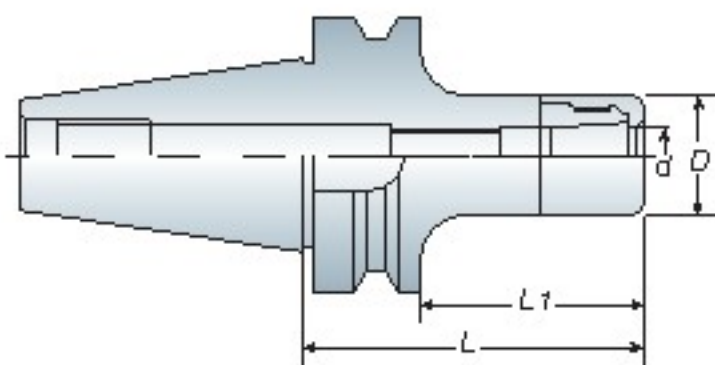

Through tools must use integer collet and coolant nut together. (refer to P.16)

需搭配使用整數筒夾及止水螺帽才有刀尖出水效果 (請參考 P.16)

Features

- ASK tooling systems are suitable for high speed and high precision cutting.
- Special nut design provides better cutting condition and reducing cutting vibration.
- ASK collet can be achieve the best cutting condition when using AA grade.
- Wrench must be ordered separately.
- Max speed: 30,000 r.p.m G2.5
- ASK 系列適用於高轉速、高精密切削加工，切削效果佳
- 螺帽獨特設計可降低高轉速切削時的風阻及噪音並提升工作效能
- 欲達到切削效果佳，可搭配使用 AA 級筒夾
- ASK 扳手為另購品
- 最高轉速可達 30,000 r.p.m G2.5

Model No.	Clamping Range (d)	D	L1	L	Weight (kg)
BT30ASK06-060	2~6	19.05	40	60	0.60
-090	2~6	19.05	70	90	0.60
ASK10-070	2~10	27	50	70	0.70
-090	2~10	27	70	90	0.80
ASK13-060	3~13	33	40	60	1.00
-075	3~13	33	55	75	1.10
-090	3~13	33	70	90	1.10
ASK16-060	3~16	40	40	60	0.70
-090	3~16	40	70	90	0.90
-120	3~16	40	100	120	1.10
ASK20-060	4~20	48	40	60	0.80
ASK25-085	6~25.4	54	65	85	1.20
BT40ASK06-060	2~6	19.05	35	60	1.10
-090	2~6	19.05	65	90	1.30
-120	2~6	19.05	95	120	1.50
ASK10-060	2~10	27	35	60	1.20
-080	2~10	27	55	80	1.30
-100	2~10	27	75	100	1.40
-120	2~10	27	95	120	1.50
-150	2~10	27	125	150	1.60
ASK13-060	3~13	33	35	60	1.20
-080	3~13	33	55	80	1.30
-100	3~13	33	75	100	1.50
-120	3~13	33	95	120	1.60
-150	3~13	33	125	150	1.80
ASK16-060	3~16	40	55	60	1.30
-080	3~16	40	55	80	1.50
-100	3~16	40	75	100	1.60
-120	3~16	40	95	120	1.90
-150	3~16	40	125	150	2.10
ASK20-060	4~20	48	35	60	1.30
-090	4~20	48	65	90	1.80
-120	4~20	48	95	120	2.40
ASK25-070	6~25.4	54	45	70	1.50
-090	6~25.4	54	65	90	1.90
-120	6~25.4	54	95	120	2.20

Unit: mm



P17- SK Collet

P18- Wrench

P19- ASK Nut

High Speed Collet Chuck

高轉速精密筒夾本體

ASK

BT / NT
series

Model No.	Clamping Range (d)	D	L1	L	Weight (kg)
BT50 ASK06-100	2~6	19.05	65	100	3.90
ASK10-100	2~10	27	65	100	4.00
-130	2~10	27	95	130	4.10
-150	2~10	27	115	150	4.20
ASK13-100	3~13	33	65	100	4.50
-130	3~13	33	95	130	4.70
-150	3~13	33	115	150	4.90
ASK16-100	3~16	40	65	100	4.20
-130	3~16	40	95	130	4.50
-150	3~16	40	115	150	5.00
ASK20-105	4~20	48	70	105	4.60
-135	4~20	48	100	135	5.00
-165	4~20	48	130	165	5.60
ASK25-100	6~25.4	54	65	100	4.50
-130	6~25.4	54	95	130	5.00
-150	6~25.4	54	115	150	5.30

Unit: mm



High Speed Collet Chuck - Rigidity Type

高轉速精密筒夾本體 - 高剛性型

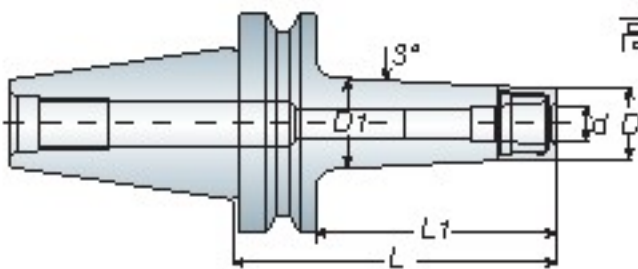

Model No.	Clamping Range (d)	D	D1	L1	L	Weight (kg)
BT40 ASK06-150T	2~6	19.05	29	125	150	1.50
ASK10-150T	2~10	27	36	125	150	1.60
ASK13-150T	3~13	33	43	125	150	1.80
ASK16-150T	3~16	40	49	125	150	1.90
BT50 ASK06-150T	2~6	19.05	28	115	150	4.00
ASK10-150T	2~10	27	35	115	150	4.60
-200T	2~10	27	40	165	150	4.80
ASK13-150T	3~13	33	42	115	150	4.90
-200T	3~13	33	47	165	200	5.20
ASK16-150T	3~16	40	47	115	150	5.10
-200T	3~16	40	53	165	200	5.50

Unit: mm

- ASK-T tooling system is designed by taper type and suitable for high speed, high precision and reducing cutting vibration.
- Wrench must be ordered separately.
- Max speed: 30,000 r.p.m G2.5
- ASK-T 系列為錐度柄之設計，適用於高轉速、高精密切削加工，切削剛性效果佳
- ASK 扳手為另購品
- 最高轉速可達 30,000 r.p.m G2.5

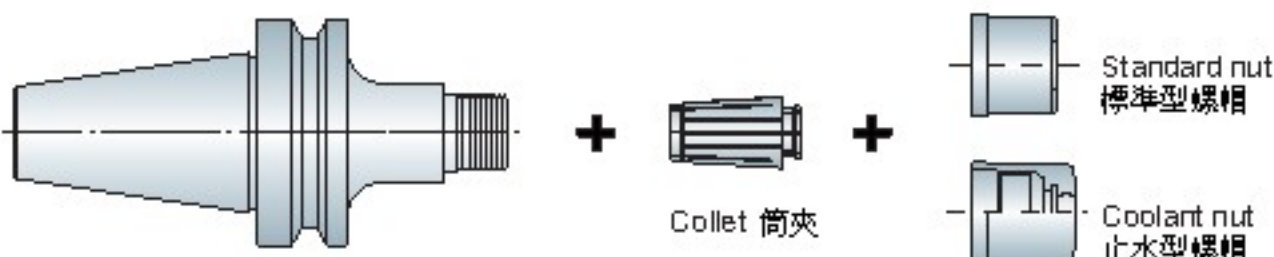

Tool Holder 刀桿

- Coolant Nut refer to P.19
- 出水螺帽請參考 P.19