

SK
series
DIN 69871A

ASK

High Speed Collet Chuck

高轉速精密筒夾本體

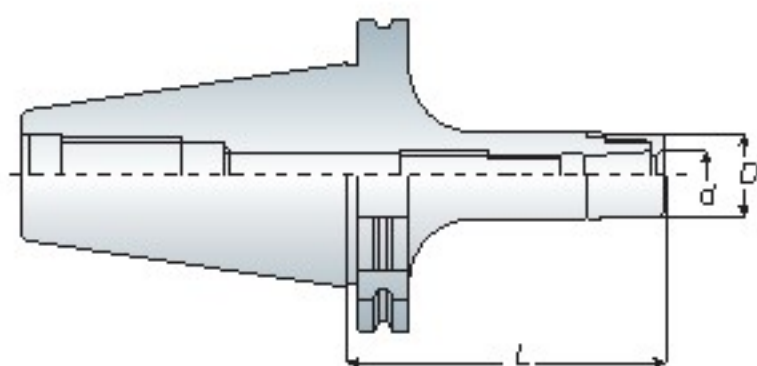

Features

- ASK tooling systems are suitable for high speed and high precision cutting.
- Special nut design provides better cutting condition and reducing cutting vibration.
- ASK collet can be achieve the best cutting condition when using AA grade.
- Wrench must be ordered separately.
- Max speed: 30,000 r.p.m G2.5
- ASK 系列適用於高轉速、高精密切削加工，切削效果佳
- 螺帽獨特設計可降低高轉速切削時的風阻及噪音並提升工作效能
- 欲達到切削效果佳，可搭配使用 AA 級筒夾
- ASK 扳手為另購品
- 最高轉速可達 30,000 r.p.m G2.5

Model No.	Clamping Range (d)	D	L	Weight (kg)
SK30 ASK06-055	2~6	20	55	0.60
ASK10-070	2~10	27	70	0.70
-095	2~10	27	95	0.80
ASK16-060	3~16	40	60	0.90
-085	3~16	40	85	1.00
-100	3~16	40	100	1.10
ASK25-085	6~25.4	54	85	1.20
SK40 ASK06-080	2~6	20	80	1.10
-100	2~6	20	100	1.30
ASK10-080	2~10	27	80	1.20
-100	2~10	27	100	1.40
ASK16-080	3~16	40	80	1.40
-100	3~16	40	100	1.50
ASK25-095	6~25.4	54	95	1.90
-110	6~25.4	54	110	2.00
SK50 ASK06-100	2~6	20	100	3.00
ASK10-100	2~10	27	100	3.30
-130	2~10	27	130	3.40
-150	2~10	27	150	3.50
ASK16-100	3~16	40	100	3.50
-130	3~16	40	130	3.70
-150	3~16	40	150	3.90
ASK25-100	6~25.4	54	100	3.80
-130	6~25.4	54	130	4.00
-150	6~25.4	54	150	4.20

Unit: mm



P17- SK Collet

P18- Wrench

P19- ASK Nut