

CAT
series

ER

Spring Collet Chuck

彈性筒夾本體

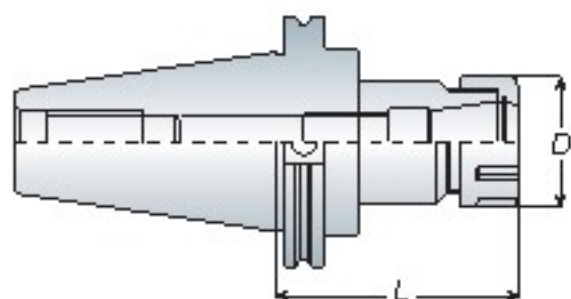

Features

- ER collet chuck with the flexibility that can clamp drill, reamers, end mills and taps.
- ER11 / ER16 / ER20 holder can make M type as your choice.
- ER16 / ER20 / ER25 / ER32 / ER40 are also suitable for ER bearing nut and wrench.
- Wrench must be ordered separately.
- ER 筒夾具有彈性，適合夾持鑽頭、銼刀、銑刀及絲攻刀具
- ER11 / ER16 / ER20 刀桿另有 M 型可供選擇
- ER16 / ER20 / ER25 / ER32 / ER40 刀桿可另外選配鋼珠螺帽及扳手
- ER 扳手為另購品



P14- ER Nut

P11- ER Collet

P14- Wrench

Model No.	Clamping Range	D	L	Collet Type	Wrench	Weight (kg)
CAT40 ER11-2 50*	1/32" ~1/4"	0.75"	2.50"	ER11	WER11	1.10
-4 00*	1/32" ~1/4"	0.75"	4.00"	ER11	WER11	1.10
ER16-2 50*	1/32" ~3/8"	1.10"	2.50"	ER16	WER16	1.20
-3 00*	1/32" ~3/8"	1.10"	3.00"	ER16	WER16	1.30
-5 00*	1/32" ~3/8"	1.10"	5.00"	ER16	WER16	1.50
ER20-3 00*	1/16" ~1/2"	1.34"	3.00"	ER20	WER20	1.30
-4 00*	1/16" ~1/2"	1.34"	4.00"	ER20	WER20	1.40
ER25-2 50*	1/16" ~5/8"	1.65"	2.50"	ER25	WER25	1.30
-4 00*	1/16" ~5/8"	1.65"	4.00"	ER25	WER25	1.70
ER32-3 00*	3/32" ~25/32"	2.00"	3.00"	ER32	WER32	1.40
-4 00*	3/32" ~25/32"	2.00"	4.00"	ER32	WER32	1.80
ER40-3 00*	1/8" ~1"	2.50"	3.00"	ER40	WER40	1.50
-4 00*	1/8" ~1"	2.50"	4.00"	ER40	WER40	1.90
CAT50 ER16-4 00*	1/32" ~3/8"	1.10"	4.00"	ER16	WER16	3.20
-6 00*	1/32" ~3/8"	1.10"	6.00"	ER16	WER16	3.50
ER20-4 00*	1/16" ~1/2"	1.34"	4.00"	ER20	WER20	3.30
-6 00*	1/16" ~1/2"	1.34"	6.00"	ER20	WER20	3.60
ER25-4 00*	1/16" ~5/8"	1.65"	4.00"	ER25	WER25	3.50
-6 00*	1/16" ~5/8"	1.65"	6.00"	ER25	WER25	3.70
ER32-4 00*	3/32" ~25/32"	2.00"	4.00"	ER32	WER32	3.70
-6 00*	3/32" ~25/32"	2.00"	6.00"	ER32	WER32	3.90
ER40-4 00*	1/8" ~1"	2.50"	4.00"	ER40	WER40	4.20
-6 00*	1/8" ~1"	2.50"	6.00"	ER40	WER40	6.60

Unit: mm

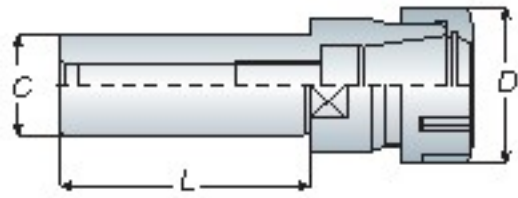

Straight Shank

直柄彈性筒夾本體

ER

CAT
series

Model No.	C	D	L	Collet Type	Weight (kg)
C3/4" ER16-2 00"	3/4"	28	2.00"	ER16	0.20
-4 00"	3/4"	28	4.00"	ER16	0.35
-6 00"	3/4"	28	6.00"	ER16	0.45
ER20-2 00"	3/4"	34	2.00"	ER20	0.25
-4 00"	3/4"	34	4.00"	ER20	0.40
-6 00"	3/4"	34	6.00"	ER20	0.50
ER25-2 00"	3/4"	42	2.00"	ER25	0.40
-4 00"	3/4"	42	4.00"	ER25	0.50
-6 00"	3/4"	42	6.00"	ER25	0.70
C1" ER16-4 00"	1"	28	4.00"	ER16	0.40
-6 00"	1"	28	6.00"	ER16	0.70
ER20-4 00"	1"	34	4.00"	ER20	0.50
-6 00"	1"	34	6.00"	ER20	0.75
ER25-4 00"	1"	42	4.00"	ER25	0.60
-6 00"	1"	42	6.00"	ER25	0.80
ER32-3 15"	1"	50	3.15"	ER32	0.80
ER40-4 00"	1"	63	4.00"	ER40	1.10
C1-1/4" ER25-2 00"	1-1/4"	42	2.00"	ER25	0.60
ER32-4 00"	1-1/4"	50	4.00"	ER32	1.10
ER40-4 00"	1-1/4"	63	4.00"	ER40	1.30

Unit: mm



- Wrench must be ordered separately.
- ER 扳手為另購品

Straight Shank - M Type

直柄彈性筒夾本體 - M 型

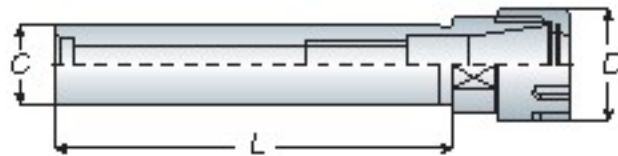

Model No.	C	D	L	Collet Type	Weight (kg)
C5/8" ER11-2 00"(M)	5/8"	16	2.00"	ER11	0.20
-4 00"(M)	5/8"	16	4.00"	ER11	0.30
C3/4" ER16-2 00"(M)	3/4"	22	2.00"	ER16	0.20
-4 00"(M)	3/4"	22	4.00"	ER16	0.30
-6 00"(M)	3/4"	22	6.00"	ER16	0.40
ER20-2 00"(M)	3/4"	28	2.00"	ER20	0.20
-4 00"(M)	3/4"	28	4.00"	ER20	0.35
-6 00"(M)	3/4"	28	6.00"	ER20	0.50
C1" ER20-2 00"(M)	1"	28	2.00"	ER20	0.30
-4 00"(M)	1"	28	4.00"	ER20	0.50
-6 00"(M)	1"	28	6.00"	ER20	0.60

Unit: mm



- Wrench must be ordered separately.
- ER 扳手為另購品



P14- ER Nut

P11- ER Collet

P14- Wrench