

BT / NT
series

FMA

Face Mill Holder - Inch

平面銑刀桿

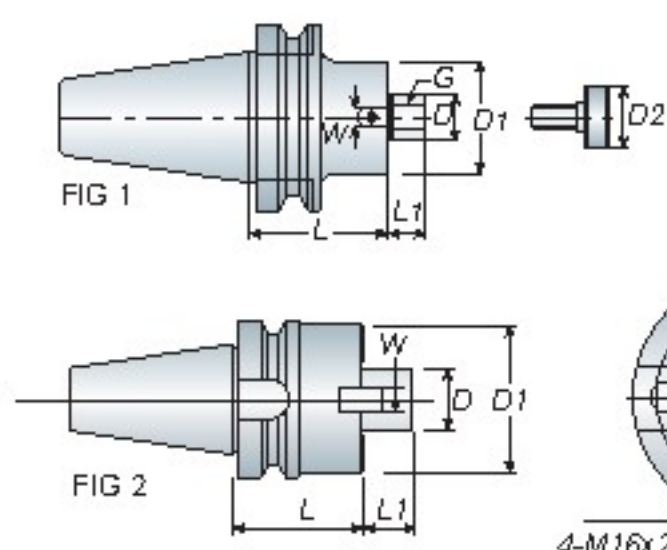

Features

- Face mill holder equips with screw and drive keys to assemble the face mill cutter to the holder.
- Face mill cutter must be ordered separately.
- 每支 FMA 面銑刀桿均附有螺絲及擋耳以裝配面銑刀盤使用
- 面銑刀盤為另購品



Model No.	FIG.	D	D1	D2	L	L1	W	G	Weight (kg)
BT30 FMA25.4-045	1	25.4	45	33	45	20	9.5	M12	0.90
-060	1	25.4	45	33	60	20	9.5	M12	1.20
FMA31.75-045	1	31.75	58	40	45	22	12.7	M12	1.30
BT40 FMA25.4-045/060	1	25.4	60	33	45/60	20	9.5	M12	1.70/2.00
-090/105	1	25.4	60	33	90/105	20	9.5	M12	2.60/2.90
-125/150	1	25.4	60	33	125/150	20	9.5	M12	3.20/3.80
FMA31.75-045/060	1	31.75	70	40	45/60	22	12.7	M12	1.80/2.30
-090/105	1	31.75	70	40	90/105	22	12.7	M12	3.20/3.30
FMA38.1-045	1	38.1	85	50	45	23	15.9	M16	2.60
-060/090	1	38.1	85	50	60/90	23	15.9	M16	2.80/3.40
BT50 FMA25.4-045/075	1	25.4	60	33	45/75	20	9.5	M12	4.20/4.90
-045S/075S	1	25.4	48	33	45/75	20	9.5	M12	4.00/4.50
-105/125	1	25.4	60	33	105/125	20	9.5	M12	5.30/5.60
-105S/125S	1	25.4	48	33	105/125	20	9.5	M12	4.80/5.20
-150/200	1	25.4	60	33	150/200	20	9.5	M12	6.10/7.30
-150S/200S	1	25.4	48	33	150/200	20	9.5	M12	5.60/6.00
-250/300	1	25.4	60	33	250/300	20	9.5	M12	8.20/9.30
-250S/300S	1	25.4	48	33	250/300	20	9.5	M12	6.90/7.20
-350/400	1	25.4	60	33	350/400	20	9.5	M12	10.20/11.20
FMA31.75-045/075	1	31.75	70	40	45/75	22	12.7	M12	4.40/5.30
-105/125	1	31.75	70	40	105/125	22	12.7	M12	6.20/6.50
-150/200	1	31.75	70	40	150/200	22	12.7	M12	7.30/8.60
-250/300	1	31.75	70	40	250/300	22	12.7	M12	10.30/11.40
FMA38.1-045	1	38.1	85	50	45	23	15.9	M16	4.50
-075/105	1	38.1	85	50	75/105	23	15.9	M16	5.90/7.10
-125/150	1	38.1	85	50	125/150	23	15.9	M16	8.30/9.50
-175/200	1	38.1	85	50	175/200	23	15.9	M16	10.30/10.90
FMA50.8-045	1	50.8	95	65	45	24	19.05	M16	5.00
-075/105	1	50.8	95	65	75/105	24	19.05	M16	6.60/8.60
-150/200	1	50.8	95	65	150/200	24	19.05	M16	11.20/13.40
FMA47.625-075	2	47.625	128.57	-	75	32	25.4	-	8.30
-105/200	2	47.625	128.57	-	105/200	32	25.4	-	10.30/15.00

Unit: mm

Face Mill Holder - Inch

平面銑刀桿

FMA

BT / NT

series

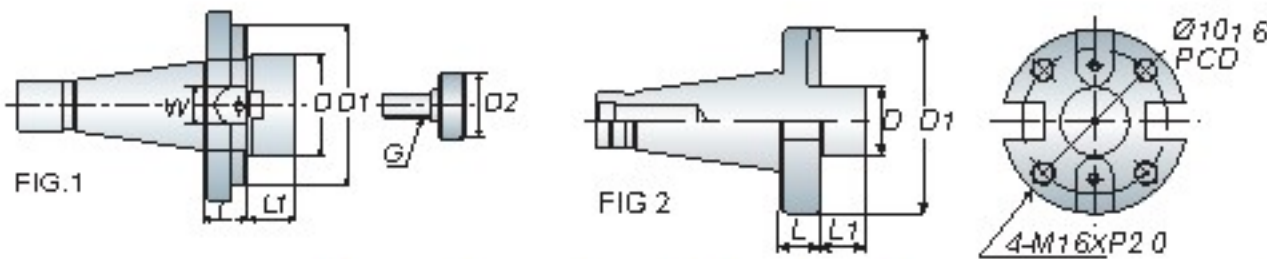

Model No.	FIG.	D	D1	D2	L	L1	W	G	Draw Bolt	Weight (kg)
NT30 FMA25 4-020	1	25.4	65	33	20	20	9.5	M12	1/2"-12 M12x1.75P	0.80
FMA31 75-020	1	31.75	73	40	20	22	12.7	M12		0.90
FMA38 1-020	1	38.1	82	50	20	23	15.9	M16		1.20
NT40 FMA25 4-020	1	25.4	65	33	20	20	9.5	M12	5/8"-11 M16x2.0P	1.40
FMA31 75-020	1	31.75	73	40	20	22	12.7	M12		1.50
FMA38 1-020	1	38.1	82	50	20	23	15.9	M16		2.10
FMA50 8-020	1	50.8	95	65	20	24	19.05	M16		2.50
FMA47 625-020	2	47.625	128.57	-	20	32	25.4	-		3.90
NT50 FMA25 4-020	1	25.4	65	33	20	20	9.5	M12		3.30
FMA31 75-020	1	31.75	73	40	20	22	12.7	M12	3.30	
FMA38 1-020	1	38.1	82	50	20	23	15.9	M16	1"-8 M24x3.0P	3.60
FMA50 8-020	1	50.8	95	65	20	24	19.05	M16		4.20
FMA47 625-024	2	47.625	128.57	-	24	32	25.4	-		5.30

Unit: mm

- Face mill holder equips with screw and drive keys to assemble the face mill cutter to the holder.
- When ordering, please specify the draw bolt with inch size or metric size.
- Face mill cutter must be ordered separately.
- 每支 FMA 面銑刀桿均附有螺絲及擋耳以裝配面銑刀盤使用
- 請於訂購時，確認刀桿為英制或公制
- 面銑刀盤為另購品

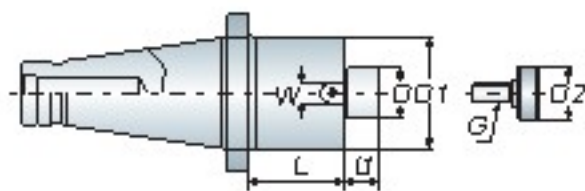

Long Type

加長型

Model No.	D	D1	D2	L	L1	W	G	Draw Bolt
NT40 FMA25 4-L	25.4	60	33		20	9.5	M12	5/8"-11 M16x2.0P
FMA31 75-L	31.75	70	40	50/75	22	12.7	M12	
FMA38 1-L	38.1	85	50	100	23	15.9	M16	
FMA50 8-L	50.8	95	65		24	19.05	M16	
NT50 FMA25 4-L	25.4	60	33		20	9.5	M12	1"-8 M24x3.0P
FMA31 75-L	31.75	70	40	50/75	22	12.7	M12	
FMA38 1-L	38.1	85	50	100/125	23	15.9	M16	
FMA50 8-L	50.8	95	65	150/200	24	19.05	M16	
FMA47 625-L	47.625	128.57	-	300	32	25.4	-	

Unit: mm



- Face mill holder equips with screw and drive keys to assemble the face mill cutter to the holder.
- When ordering, please specify the draw bolt with inch size or metric size.
- Face mill cutter must be ordered separately.
- 每支 FMA 面銑刀桿均附有螺絲及擋耳以裝配面銑刀盤使用
- 請於訂購時，確認刀桿為英制或公制
- 面銑刀盤為另購品



- Face mill holder equips with screw and drive keys to assemble the face mill cutter to the holder.
- Face mill cutter must be ordered separately.

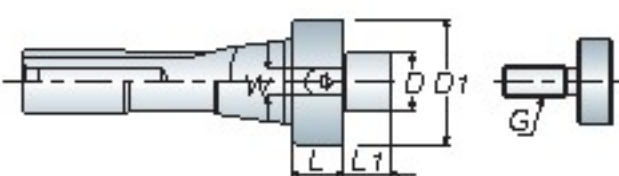

R8 Taper Shank

R8 平面銑刀桿

Model No.	D	D1	L	L1	W	G	Weight (kg)
R8 FMA25 4-020	25.4	48	20	20	9.5	M12	0.90
FMA31 75-020	31.75	54	20	22	12.7	M12	1.40

Unit: mm



- 每支 FMA 面銑刀桿均附有螺絲及擋耳以裝配面銑刀盤使用
- 面銑刀盤為另購品

P174/175
Face Mill Cutter

BT / NT
series

FMB

Face Mill Holder - Metric

平面銑刀桿

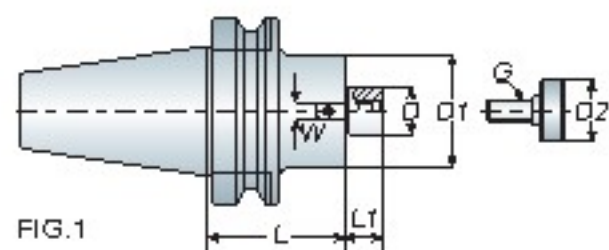

FIG. 1

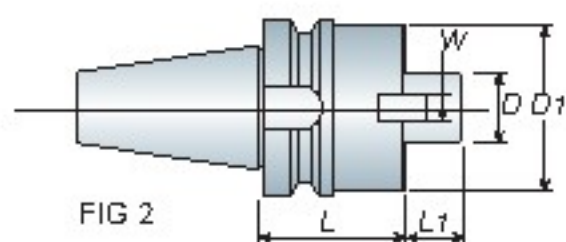
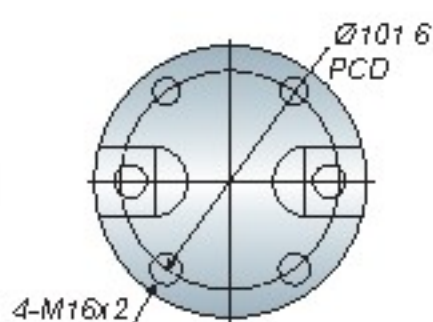

FIG. 2



Features

- Face mill holder equips with screw and drive keys to assemble the face mill cutter to the holder.
- Face mill cutter must be ordered separately.
- 每支 FMB 面銑刀桿均附有螺絲及擋耳以裝配面銑刀盤使用
- 面銑刀盤為另購品



Model No.	FIG.	D	D1	D2	L	L1	W	G	Weight (kg)
BT30 FMB22-045	1	22	56	-	45	18	10	M10	0.80
FMB27-045	1	27	64	32	45	20	12	M12	1.00
BT40 FMB16-045	1	16	38	-	45	17	10	M8	1.3
FMB22-045	1	22	48	-	45	18	10	M10	1.40
-060/090	1	22	48	-	60/90	18	10	M10	1.60/2.10
-105/125	1	22	48	-	105/125	18	10	M10	2.40/2.60
-150/200	1	22	48	-	150/200	18	10	M10	2.80/3.50
FMB27-045	1	27	60	32	45	20	12	M12	1.70
-060	1	27	60	32	60	20	12	M12	2.00
-090/105	1	27	60	32	90/105	20	12	M12	2.60/3.00
FMB32-045	1	32	63	41	45	21	14	M16	1.80
-060	1	32	63	41	60	21	14	M16	2.10
-090/105	1	32	63	41	90/105	21	14	M16	3.00/3.30
FMB40-045	1	40	68	47	45	23	16	M16	2.00
-060	1	40	68	47	60	23	16	M16	2.70
BT50 FMB16-045	1	16	38	-	45	17	10	M8	3.8
FMB22-045	1	22	48	-	45	18	10	M10	4.00
-075/105	1	22	48	-	75/105	18	10	M10	4.50/4.80
-125/150	1	22	48	-	125/150	18	10	M10	5.20/5.60
-175/200	1	22	48	-	175/200	18	10	M10	6.00/6.30
-250/300	1	22	48	-	250/300	18	10	M10	6.90/7.20
-350/400	1	22	48	-	350/400	18	10	M10	7.70/8.30
FMB27-045	1	27	65	32	45	20	12	M12	4.30
-075	1	27	65	32	75	20	12	M12	5.00
-090/105	1	27	65	32	90/105	20	12	M12	5.40/5.80
-150/200	1	27	65	32	150/200	20	12	M12	7.20/8.90
FMB32-045	1	32	73	41	45	21	14	M16	4.40
-075/105	1	32	73	41	75/105	21	14	M16	5.40/6.60
-150/200	1	32	73	41	150/200	21	14	M16	8.00/9.70
FMB40-045	1	40	85	47	45	23	16	M16	4.60
-075	1	40	85	47	75	23	16	M16	5.90
-105/150	1	40	85	47	105/150	23	16	M16	6.90/8.60
FMB60-075	2	60	128.57	-	75	32	25.4	-	7.30

Unit: mm

Face Mill Holder - Metric

平面銑刀桿

FMB

BT / NT

series

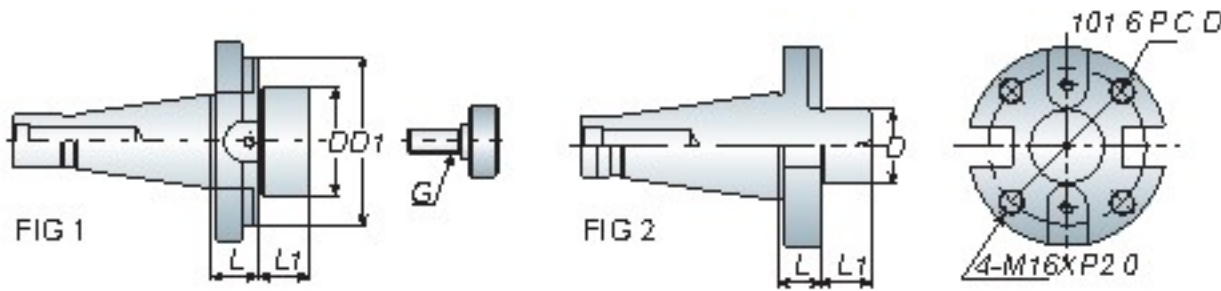

Model No.	FIG.	D	D1	L	L1	G	Draw Bolt	Weight (kg)
NT30 FMB 22-020	1	22	53	20	18	M10	1/2" -12 M12x1.75P	0.60
FMB 27-020	1	27	54	20	20	M12		0.80
FMB 32-020	1	32	59	20	21	M16		1.00
NT40 FMB 22-020	1	22	60	20	18	M10	5/8" -11 M16x2.0P	1.20
FMB 27-020	1	27	58	20	20	M12		1.40
FMB 32-020	1	32	69	20	21	M16		1.40
FMB 40-020	1	40	80	20	24	M16		1.80
FMB 60-024	2	60	128	24	32	-		4.00
NT50 FMB 22-020	1	22	40	20	18	M10	1" -8 M24x3.0P	3.10
FMB 27-020	1	27	70	20	20	M12		3.30
FMB 32-020	1	32	76	20	21	M16		3.40
FMB 40-020	1	40	88	20	24	M16		3.70
FMB 60-024	2	60	128	24	32	-		5.50

Unit: mm

- Face mill holder equips with screw and drive keys to assemble the face mill cutter to the holder.
- When ordering, please specify the draw bolt with inch size or metric size.
- Face mill cutter must be ordered separately.
- 每支 FMB 面銑刀桿均附有螺絲及擋耳以裝配面銑刀盤使用
- 請於訂購時，確認刀桿為英制或公制
- 面銑刀盤為另購品

R8 Taper Shank

R8 平面銑刀桿

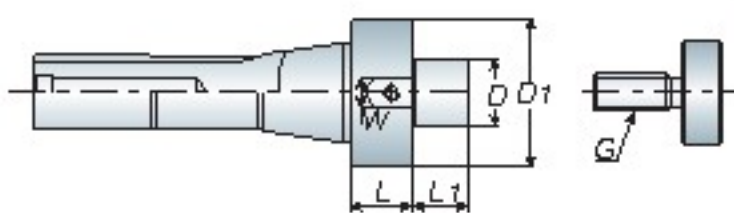

Model No.	D	D1	L	L1	W	G	Weight (kg)
R8 FMB22-020	22	48	20	18	10	M10	0.80
FMB27-020	27	54	20	20	12	M12	1.00

Unit: mm

- Face mill holder equips with screw and drive keys to assemble the face mill cutter to the holder.
- Face mill cutter must be ordered separately.
- 每支 FMB 面銑刀桿均附有螺絲及擋耳以裝配面銑刀盤使用
- 面銑刀盤為另購品



BT / NT
series

FMH

Face Mill Holder - Coolant Type

平面銑刀桿 - 出水型

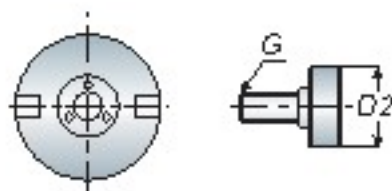
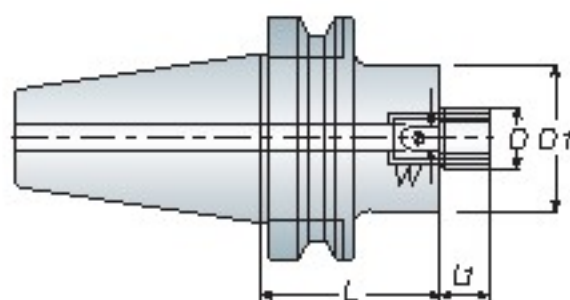

Features

- Face mill holder equips with screw and drive keys to assemble the face mill cutter to the holder.
- Face mill cutter must be ordered separately.
- FMH is produced by order.
- 每支 FMH 面銑刀桿均附有螺絲及擋耳以裝配面銑刀盤使用
- 面銑刀盤為另購品
- FMH 為訂單生產品

Model No.	D	D1	D2	L	L1	W	G	Weight (kg)
BT30 FMH25 4-045	25.4	45	33	45	20	9.5	M12	0.90
-060	25.4	45	33	60	20	9.5	M12	1.20
FMH31 75-045	31.75	58	40	45	22	12.7	M12	1.30
FMH22-045	22	56	-	45	18	10	M10	0.80
FMH27-045	27	64	32	45	20	12	M12	1.00
BT40 FMH25 4-045	25.4	60	33	45	20	9.5	M12	1.70
-060	25.4	60	33	60	20	9.5	M12	2.00
FMH31 75-045	31.75	70	40	45	22	12.7	M12	2.30
-060	31.75	70	40	60	22	12.7	M12	2.60
FMH38 1-045	38.1	85	50	45	23	15.9	M16	2.60
-060	38.1	85	50	60	23	15.9	M16	2.80
FMH16-045	16	38	-	45	17	10	M8	1.30
FMH22-045	22	48	-	45	18	10	M10	1.40
-060	22	48	-	60	18	10	M10	1.60
FMH27-045	27	60	32	45	20	12	M12	1.70
-060	27	60	32	60	20	12	M12	2.00
FMH32-045	32	63	41	45	21	14	M16	1.80
-060	32	63	41	60	21	14	M16	2.10
BT50 FMH25 4-045	25.4	60	33	45	20	9.5	M12	4.20
-075/105/150	25.4	60	33	75/105/150	20	9.5	M12	4.90/5.30/6.10
FMH31 75-045	31.75	70	40	45	22	12.7	M12	4.40
-075/105/150	31.75	70	40	75/105/150	22	12.7	M12	5.30/6.20/7.30
FMH38 1-045	38.1	85	50	45	23	15.9	M16	4.50
-075/105/150	38.1	85	50	75/105/150	23	15.9	M16	5.90/7.10/9.50
FMH16-045	16	38	-	45	17	10	M8	3.80
FMH22-045	22	48	-	45	18	10	M10	4.00
-075/105/150	22	48	-	75/105/150	18	10	M10	4.50/4.80/5.60
FMH27-045	27	65	32	45	20	12	M12	4.30
-075/105/150	27	65	32	75/105/150	20	12	M12	5.00/5.80/7.20
FMH32-045	32	73	41	45	21	14	M16	4.40
-075/105/150	32	73	41	75/105/150	21	14	M16	5.40/6.60/9.70
FMH40-045	40	85	47	45	23	16	M16	4.60
-075/105	40	85	47	75/105	23	16	M16	5.90/6.90

Unit: mm