

HSK-A series

APU



- The shank and keyless drill chuck are combined together so that to avoid the drill chuck slipping out for heavy-duty and high-speed cutting.
- Wrench is attached for each APU drill chuck holder.
- Max speed: 30,000 r.p.m G2.5
- APU 刀桿和鑽夾頭結為一體，可避免鑽頭於高速及重切削時掉落或鬆脫
- 每支 APU 刀桿均附 1 支扳手
- 最高轉速可達 30,000 r.p.m G2.5



- The tool holder for morse taper shank with internal tang.
- Max speed: 30,000 r.p.m G2.5
- 最高轉速可達 30,000 r.p.m G2.5



- Face mill holder equips with screw and drive keys to assemble the face mill cutter to the holder.
- Face mill cutter must be ordered separately.
- Face mill holder - long type upon your request.
- Max speed: 30,000 r.p.m G2.5
- 每支 FMA/FMB 面銑刀桿均附有螺絲及擋耳以裝配面銑刀盤使用
- 面銑刀盤為另購品
- 亦有生產平面銑刀桿 - 加長型，可另詢問
- 最高轉速可達 30,000 r.p.m G2.5

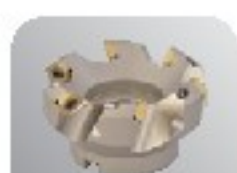

P174/175
Face Mill Cutter

Drill Chuck Holder

直截式鑽夾頭刀桿

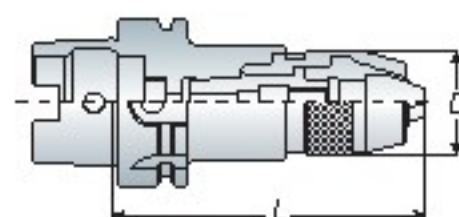

Model No.	Clamping Range	D	L	Weight (kg)
HSK40A APU 08-120	1~8	36.3	120	1.10
HSK50A APU 08-120	1~8	36.3	120	1.30
HSK63A APU 08-120	1~8	36.3	120	1.50
APU 13-150	1~13	51.5	150	2.60
APU 16-155	3~16	58	155	2.90
HSK100A APU 13-155	1~13	51.5	155	3.70
APU 16-160	3~16	58	160	4.00

Unit: mm

Morse Taper Holder

莫氏錐度刀桿 - A 型

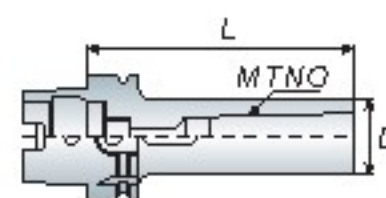

Model No.	MT. No.	D	L	Weight (kg)
HSK50A MTA1-100	MTA1	25	100	0.70
MTA2-120	MTA2	32	120	0.90
MTA3-140	MTA3	40	140	1.30
HSK63A MTA1-100	MTA1	25	100	1.00
MTA2-120	MTA2	32	120	1.20
MTA3-140	MTA3	40	140	1.60
MTA4-160	MTA4	48	160	2.00

Unit: mm

Face Mill Holder

平面銑刀桿

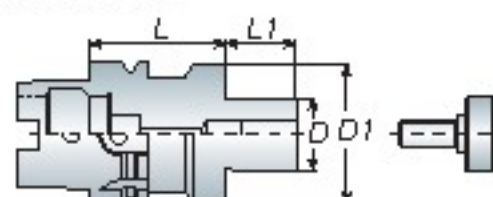

Model No.	D	D1	L	L1	Weight (kg)
HSK50A FMA25 4-055	25.4	50	55	20	1.00
HSK63A FMA25 4-055	25.4	60	55	20	1.40
FMA31 75-060	31.75	70	60	22	1.50
HSK100A FMA25 4-100	25.4	60	100	20	4.90
FMA31 75-100	31.75	70	100	22	5.20
HSK50A FMB 16-045	16	32	45	16	0.80
FMB 22-050	22	40	50	18	0.80
FMB 27-055	27	48	55	20	1.00
HSK63A FMB 16-050	16	40	50	16	1.00
FMB 22-055	22	40	55	18	1.10
FMB 27-055	27	48	55	20	1.60
FMB 32-055	32	58	55	21	1.70
HSK100A FMB 22-100	22	40	100	18	3.65
FMB 27-100	27	48	100	20	4.90
FMB 32-100	32	58	100	21	5.20

Unit: mm